

Gulf Oil Corporation

ROSWELL PRODUCTION DISTRICT

W. A. Shellishear
DISTRICT MANAGER
F. O. Mortlock
DISTRICT EXPLORATION
MANAGER
M. I. Taylor
DISTRICT PRODUCTION
MANAGER
H. C. Vivian
DISTRICT SERVICES MANAGER

July 19, 1961

P. O. Drawer 1938
Roswell, New Mexico

Aug 21

Oil Conservation Commission
State of New Mexico
Post Office Box 871
Santa Fe, New Mexico

Re: Application of Gulf Oil Corporation
for Approval of a Non-Standard 120-
Acre Gas Proration Unit, Blinebry
Gas Pool, Lea County, New Mexico

Gentlemen:

In compliance with Rule 30, Order No. R-1670 which prohibits the simultaneous dedication of acreage to an oil and to a gas well, Gulf Oil Corporation respectfully requests administrative approval of a Non-Standard 120-Acre Blinebry Gas Proration Unit covering the E/2 NE/4 and SW/4 NE/4 of Section 16, Township 21 South, Range 37 East, Lea County, New Mexico.

In support of this application, the following facts are submitted:

- (1) Gulf's Harry Leonard (NCT-E) Well No. 4, located 660 feet from the north and east lines of Section 16, Township 21 South, Range 37 East, is completed in the Blinebry Gas Pool and has been assigned a Standard 160-Acre Gas Proration Unit covering the NE/4 of this Section 16.
- (2) Gulf's Harry Leonard (NCT-E) Well No. 3, located 660 feet from the north line and 1980 feet from the east line of this Section 16, has been recompleted as a Blinebry oil well.
- (3) The Proposed Non-Standard Gas Proration Unit consists of contiguous quarter-quarter sections and lies wholly within a single governmental quarter section.
- (4) The entire Non-Standard Gas Proration Unit is reasonably presumed to be gas productive in the Blinebry Gas Pool.
- (5) The length or width does not exceed 2640 feet.



July 19, 1961

- (6) All operators in this quarter section and within 1500 feet of the unit well have been furnished a copy of this application.

Respectfully submitted,

GULF OIL CORPORATION

W. A. Shellshear
W. A. Shellshear

JHH:ers

cc: New Mexico Oil Conservation Commission
Post Office Box 2045
Hobbs, New Mexico

Continental Oil Company
Petroleum Building
Roswell, New Mexico

Humble Oil & Refining Company
Post Office Box 1600
Midland, Texas

Tidewater Oil Company
Post Office Box 1404
Houston, Texas

Cities Service Petroleum Company
Post Office Box 97
Hobbs, New Mexico

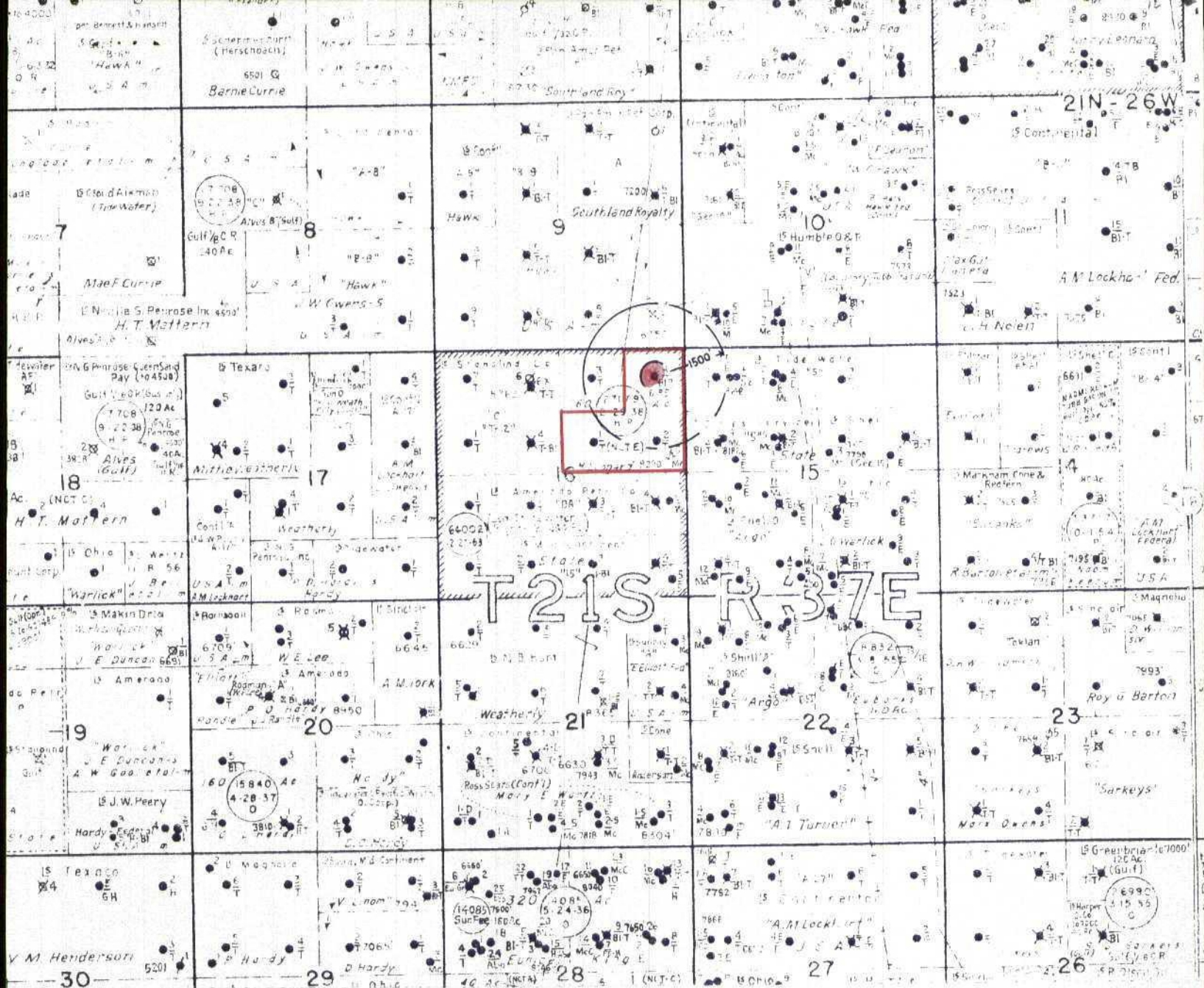

LEASE PLAT
H. LEONARD (NCT-E) LEASE
Blinebry Gas Pool
Lea County, New Mexico

- LEGEND -



Proposed Non-Standard Unit



Pertinent Well

Gulf Oil Corporation