

NSP-735
30 days
Due 1-24

GENERAL OFFICE
Box 2040
TULSA 2, OKLA.

AMERADA PETROLEUM CORPORATION

Box 668
HOBBS, NEW MEXICO
December 21, 1965

New Mexico Oil
Conservation Commission
P. O. Box 2088
Santa Fe, New Mexico

Gentlemen:

The J. G. Hare No. 5 located in Unit K, Section 33, T-21-S, R-~~33~~³⁷-E, will be reclassified as a gas well in the Blinebry Gas Pool effective January 1, 1966, due to a recently submitted gas-oil ratio test.

A standard gas unit in the Blinebry Gas Pool is 160 acres. The J. G. Hare Lease is a 160 acre lease but the J. G. Hare No. 4 is now producing oil as an oil well with a 40 acre assignment.

The remaining 120 acres is: 1. Less than a standard proration unit, 2. Contiguous, and 3. Lies wholly within a single governmental quarter section.

We, therefore, request administrative approval of this non-standard gas proration unit.

Attached are: Form C-102, Form C-104, and an area plat. Offset operators are receiving a copy of this application.

Yours very truly,

D. C. Capps

DCC/MCB/jh

cc: New Mexico O. C. C.
P. O. Box 1980
Hobbs, New Mexico (2)

Gulf Oil Corporation
P. O. Box 980
Hobbs, New Mexico

Messrs. J. O. Hathaway
O. C. McBryde
R. L. Hocker
T. E. Lynch
L. E. Thomas
A. J. Troop
B. A. Moore
Midland
File

Mobil Oil Company
P. O. Box 1800
Hobbs, New Mexico

Southern Petroleum Exploration, Inc.
P. O. Box 1434
Roswell, New Mexico

Shell Oil Company
P. O. Box 1509
Midland, Texas

**NEW MEXICO OIL CONSERVATION COMMISSION
WELL LOCATION AND ACREAGE DEDICATION PLAT**

Form C-102
Supersedes C-128
Effective 1-1-65

All distances must be from the outer boundaries of the Section.

Operator Amerada Petroleum Corporation			Lease J. G. Hare			Well No. 5		
Unit Letter K	Section 33	Township 21S	Range 37E	County Lea	13			
Actual Footage Location of Well: <div style="display: flex; justify-content: space-between;"> 1980 feet from the West line and 1980 feet from the South line </div>								
Ground Level Elev. 3456' DF		Producing Formation Blinebry		Pool Blinebry		Dedicated Acreage: 120 Acres		

1. Outline the acreage dedicated to the subject well by colored pencil or hachure marks on the plat below.
2. If more than one lease is dedicated to the well, outline each and identify the ownership thereof (both as to working interest and royalty).
3. If more than one lease of different ownership is dedicated to the well, have the interests of all owners been consolidated by communization, unitization, force-pooling, etc?

☐ Yes ☐ No If answer is "yes," type of consolidation _____

If answer is "no," list the owners and tract descriptions which have actually been consolidated. (Use reverse side of this form if necessary.) _____

No allowable will be assigned to the well until all interests have been consolidated (by communization, unitization, forced-pooling, or otherwise) or until a non-standard unit, eliminating such interests, has been approved by the Commission.

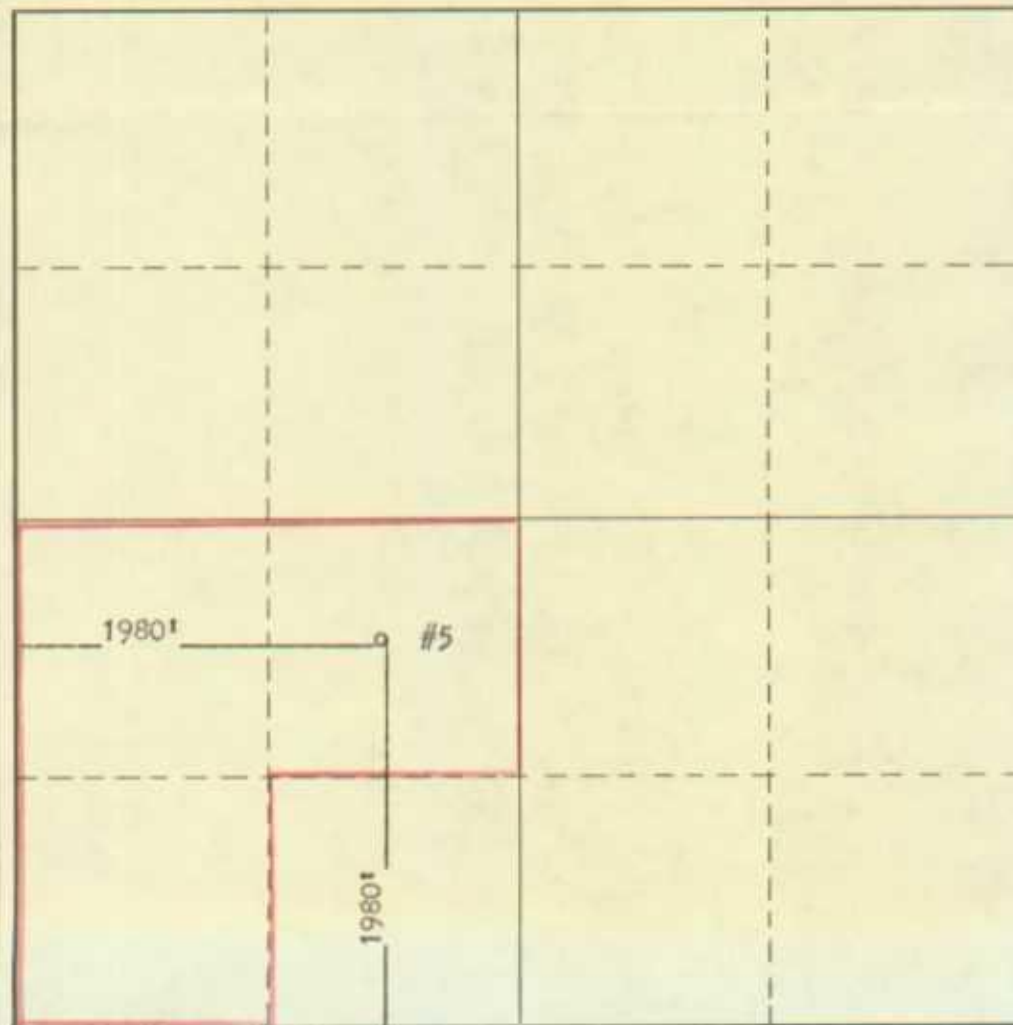

CERTIFICATION

I hereby certify that the information contained herein is true and complete to the best of my knowledge and belief.

Name *D. C. Caspe*
 Position _____
District Superintendent
 Company _____
Amerada Petroleum Corp.
 Date _____
12-21-65

I hereby certify that the well location shown on this plat was plotted from field notes of actual surveys made by me or under my supervision, and that the same is true and correct to the best of my knowledge and belief.

Date Surveyed _____
 Registered Professional Engineer and/or Land Surveyor _____

Certificate No. _____



NO. OF COPIES RECEIVED	
DISTRIBUTION	
SANTA FE	
FILE	
U.S.G.S.	
LAND OFFICE	
TRANSPORTER	OIL
	GAS
OPERATOR	
PRORATION OFFICE	

NEW MEXICO OIL CONSERVATION COMMISSION
REQUEST FOR ALLOWABLE
AND
AUTHORIZATION TO TRANSPORT OIL AND NATURAL GAS

Form C-104
Supersedes Old C-104 and C-110
Effective 1-1-65

DEC 22 PM 1 13

Operator Amerada Petroleum Corporation	
Address P. O. Box 668 - Hobbs, New Mexico	
Reason(s) for filing (Check proper box)	Other (Please explain)
New Well <input type="checkbox"/>	Change in Transporter of:
Recompletion <input type="checkbox"/>	Oil <input type="checkbox"/> Dry Gas <input checked="" type="checkbox"/>
Change in Ownership <input type="checkbox"/>	Casinghead Gas <input type="checkbox"/> Condensate <input type="checkbox"/>
Well to be reclassified 1-1-66 from Blinebry Oil to Blinebry Gas due to high GOR	
If change of ownership give name and address of previous owner	

I. DESCRIPTION OF WELL AND LEASE

Lease Name J. G. Hare	Lease No. 5	Well No. 5	Pool Name, Including Formation Blinebry Gas	Kind of Lease State, Federal or Fee	Fee
Location					
Unit Letter K	1980	Feet From The South	Line and 1980	Feet From The West	
Line of Section 33	Township 21S	Range 37E	NMPM, Lea	County	

II. DESIGNATION OF TRANSPORTER OF OIL AND NATURAL GAS

Name of Authorized Transporter of Oil <input checked="" type="checkbox"/> or Condensate <input type="checkbox"/>	Address (Give address to which approved copy of this form is to be sent)				
Shell Pipe Line Co.	Box 1598, Hobbs, New Mexico				
Name of Authorized Transporter of Casinghead Gas <input type="checkbox"/> or Dry Gas <input checked="" type="checkbox"/>	Address (Give address to which approved copy of this form is to be sent)				
Northern Natural Gas Co. Skelly Oil Co.	Hobbs, New Mexico Box 1135, Elmore, New Mexico				
If well produces oil or liquids, give location of tanks.	Unit N	Sec. 33	Twp. 21S	Rge. 37E	Is gas actually connected? when No

If this production is commingled with that from any other lease or pool, give commingling order number:

V. COMPLETION DATA

Designate Type of Completion - (X)	Oil Well	Gas Well	New Well	Workover	Deepen	Plug Back	Same Res'v.	Diff. Res'v.
		X						
Reclassify due to high GOR								
Date Spudded	Date Compl. Ready to Prod.		Total Depth			P.B.T.D.		
Elevations (DF, RKB, RT, GR, etc.)	Name of Producing Formation		Top Oil/Gas Pay			Tubing Depth		
Perforations						Depth Casing Shoe		

TUBING, CASING, AND CEMENTING RECORD

HOLE SIZE	CASING & TUBING SIZE	DEPTH SET	SACKS CEMENT

VI. TEST DATA AND REQUEST FOR ALLOWABLE OIL WELL

(Test must be after recovery of total volume of load oil and must be equal to or exceed top allowable for this depth or be for full 24 hours)

Date First New Oil Run To Tanks	Date of Test	Producing Method (Flow, pump, gas lift, etc.)	
Length of Test	Tubing Pressure	Casing Pressure	Choke Size
Actual Prod. During Test	Oil-Bbls.	Water-Bbls.	Gas-MCF

GAS WELL

Actual Prod. Test-MCF/D	Length of Test	Bbls. Condensate/MCF	Gravity of Condensate
2,021	24 Hrs.	37.22	40.3
Testing Method (pilot, back pr.)	Tubing Pressure	Casing Pressure	Choke Size
Deliverability	512#		1-1/2"

VII. CERTIFICATE OF COMPLIANCE

I hereby certify that the rules and regulations of the Oil Conservation Commission have been complied with and that the information given above is true and complete to the best of my knowledge and belief.

OIL CONSERVATION COMMISSION

APPROVED _____, 19 _____

BY _____

TITLE _____

This form is to be filed in compliance with RULE 1104.

If this is a request for allowable for a newly drilled or deepened well, this form must be accompanied by a tabulation of the deviation tests taken on the well in accordance with RULE 111.

All sections of this form must be filled out completely for allowable on new and recompleted wells.

Fill out only Sections I, II, III, and VI for changes of owner, well name or number, or transporter or other such change of condition.

Separate Forms C-104 must be filed for each pool in multiply completed wells.

District Superintendent

December 22, 1965

R-37-E

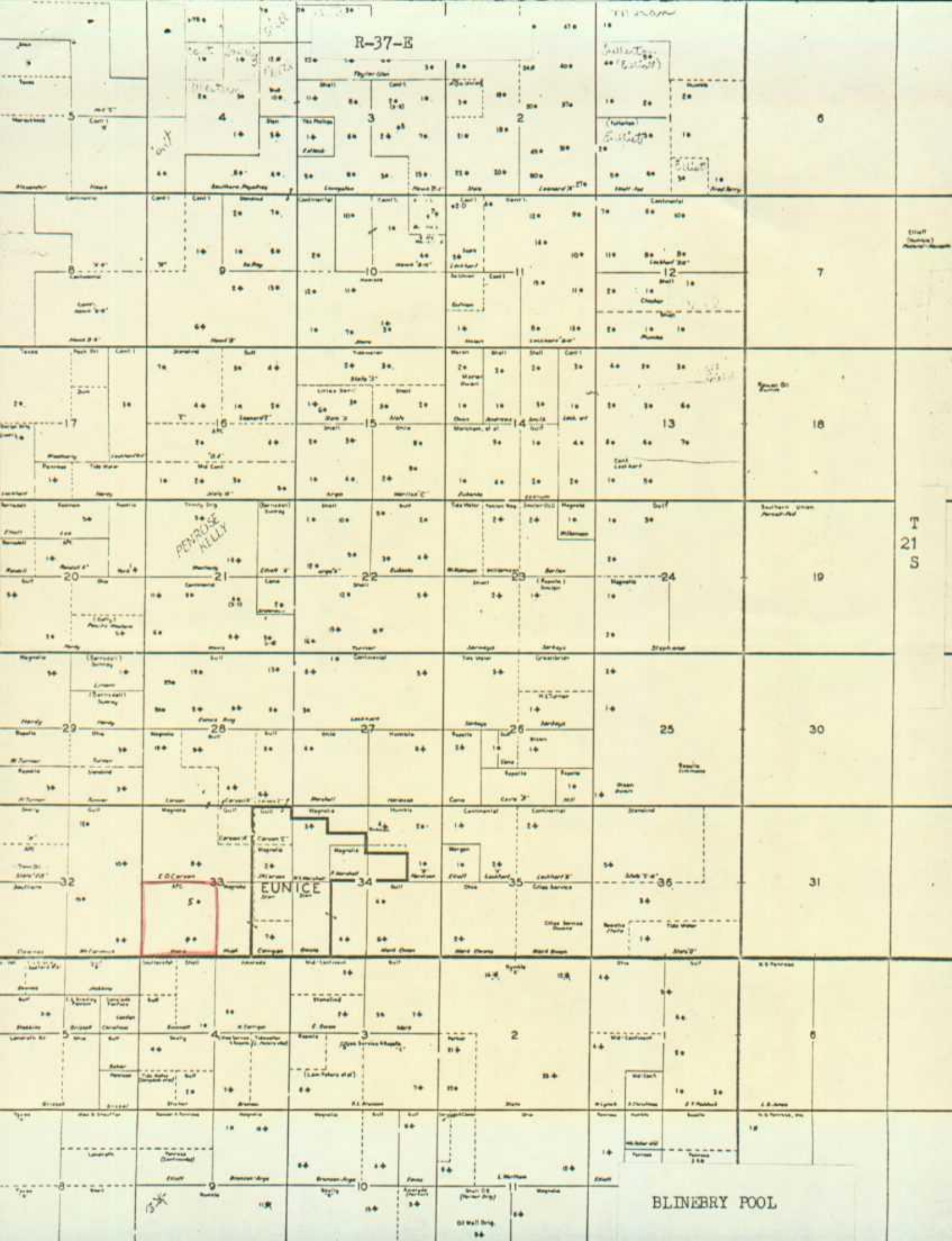



NEW MEXICO ENERGY, MINERALS
& NATURAL RESOURCES DEPARTMENT

OIL CONSERVATION DIVISION
2040 South Pacheco Street
Santa Fe, New Mexico 87505
(505) 827-7131

May 12, 1999

Collins & Ware, Inc.
508 West Wall Avenue – Suite 1200
Midland, Texas 79701-5076
Attention: Dianne Sumrall, Production Administrator

Telefax No. (915) 686-0302

Administrative Order NSP-735-A

Dear Ms. Sumrall:

Reference is made to the following: (i) your application dated April 20, 1999; and (ii) the records of the New Mexico Oil Conservation Division ("Division") in Santa Fe: all concerning Collins & Ware, Inc.'s request for an 80-acre non-standard gas spacing and proration unit ("GPU") consisting of the following acreage in the Blinebry Oil and Gas Pool:

LEA COUNTY, NEW MEXICO
TOWNSHIP 21 SOUTH, RANGE 37 EAST, NMPM
Section 33: N/2 SW/4.

It is our understanding that this unit is to be dedicated to Collins & Ware, Inc.'s existing J. G. Hare Well No. 6 (API No. 30-025-06966), located at a standard gas well location for the subject 80-acre GPU 1980 feet from the South line and 760 feet from the West line (Unit L) of Section 33.

By authority granted me under the provisions of **Rule 2(d)** of the "*General Rules for the Prorated Gas Pools of New Mexico/Special Rules and Regulations for the Blinebry Oil and Gas Pool*," as promulgated by Division Order No. R-8170, as amended, the above-described 80-acre non-standard gas spacing and proration unit is hereby approved. Also, you are hereby permitted to produce the allowable assigned the subject GPU, in accordance with Rule 5 of said pool rules

Administrative Order NSP-735-A
Collins & Ware, Inc.
May 12, 1999
Page 2

based upon a unit size of 80 acres.

Sincerely,

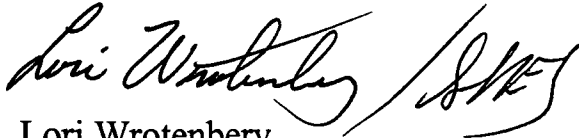
A handwritten signature in cursive script, appearing to read "Lori Wrotenbery", followed by a large, stylized flourish or mark.

Lori Wrotenbery
Director

LW/MES/kv

cc: New Mexico Oil Conservation Division - Hobbs
File: NSP-735 /

REMARKS:

A previously established 120-acre non-standard Blinbry gas spacing and proration unit comprising the N/2 SW/4 and SW/4 SW/4 of Section 33, which was approved by Division Administrative Order NSP-735, dated January 24, 1966 and was dedicated to Amerada Petroleum Corporation's J. G. Hare Well No. 5 (**API No. 30-025-06965**), located at a standard gas well location 1980 feet from the South and West lines (Unit K) of Section 33, from 1966 to 1974, shall be placed in abeyance until further notice.