



Amoco Production Company

Post Office Box 68
Hobbs, New Mexico 88240

V. E. Staley
District Superintendent

January 9, 1980

File: VES-986.51 X WF-25

Re: Application for Non-Standard
Proration Unit
State "C" Tract 13 Well No. 5
Blinebry Oil and Gas
1980' FNL and 660' FWL
Section 36, T-21-S, R-37-E
Lea County, New Mexico

*NSP - 1190
Rule 5C(3) B1620N
April 22 (really)
w/2 NW/4 SE/4 NW/4*

Oil Conservation Division of
The New Mexico Department of
Energy and Minerals
P. O. Box 2088
Santa Fe, NM 87501

Gentlemen:

Amoco Production Company requests administrative approval of a 120 acre non-standard proration unit for our State "C" Tract 13 Well No. 5. The well is located 1980' FNL and 660' FWL, Section 36, Township 21 South, Range 37 East, Blinebry Oil and Gas Pool, Lea County, New Mexico.

This non-standard proration unit was established by the completion of our State "C" Tract 13 Well No. 10 as an oil well in the Blinebry Oil and Gas Pool which required 40 acres to be dedicated out of the original 160 acre dedication. Well No. 10 is located 990' FNL and 1980' FWL, Section 36, Unit C Township 21 South, Range 37 East.

Attached is a copy of the C-102 showing the location of the State "C" Tract 13 Well No. 5.

Yours very truly,

Attachments

cc: NMOCB
Hobbs, NM 88240

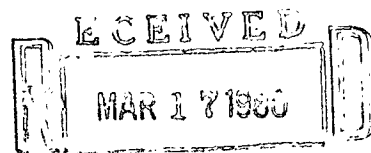

OIL CONSERVATION DIVISION
SANTA FE

**NEW MEXICO OIL CONSERVATION COMMISSION
WELL LOCATION AND ACREAGE DEDICATION AT**

Form C-102
Supersedes C-128
Effective 1-1-65

All distances must be from the section boundaries of the section.

Operator Amoco Production Co.		Lease State "C" Tract 13		Well No. 5
Unit Letter E	Section 36	Township 21 South	Range 37 East	County Lea
Actual Noted Location of Well: <div style="display: flex; justify-content: space-between; align-items: center;"> 1980' feet from the North 660' feet from the West </div>				
Ground Level Elev. 3371'	Producing Formation Blinebry	Field Blinebry Oil & Gas	Dedicated Acreage 120	

1. Outline the acreage dedicated to the subject well by colored pencil or hatchure marks on the plat below.
2. If more than one lease is dedicated to the well, outline each and identify the ownership thereof (both as to working interest and royalty).
3. If more than one lease of different ownership is dedicated to the well, have the interests of all owners been consolidated by communitization, unitization, force-pooling, etc?

☐ Yes ☐ No If answer is "yes," type of consolidation _____

If answer is "no," list the owners and tract descriptions which have actually been consolidated. (Use reverse side of this form if necessary.) _____

No allowable will be assigned to the well until all interests have been consolidated (by communitization, unitization, forced-pooling, or otherwise) or until a non-standard unit, eliminating such interests, has been approved by the Commission.

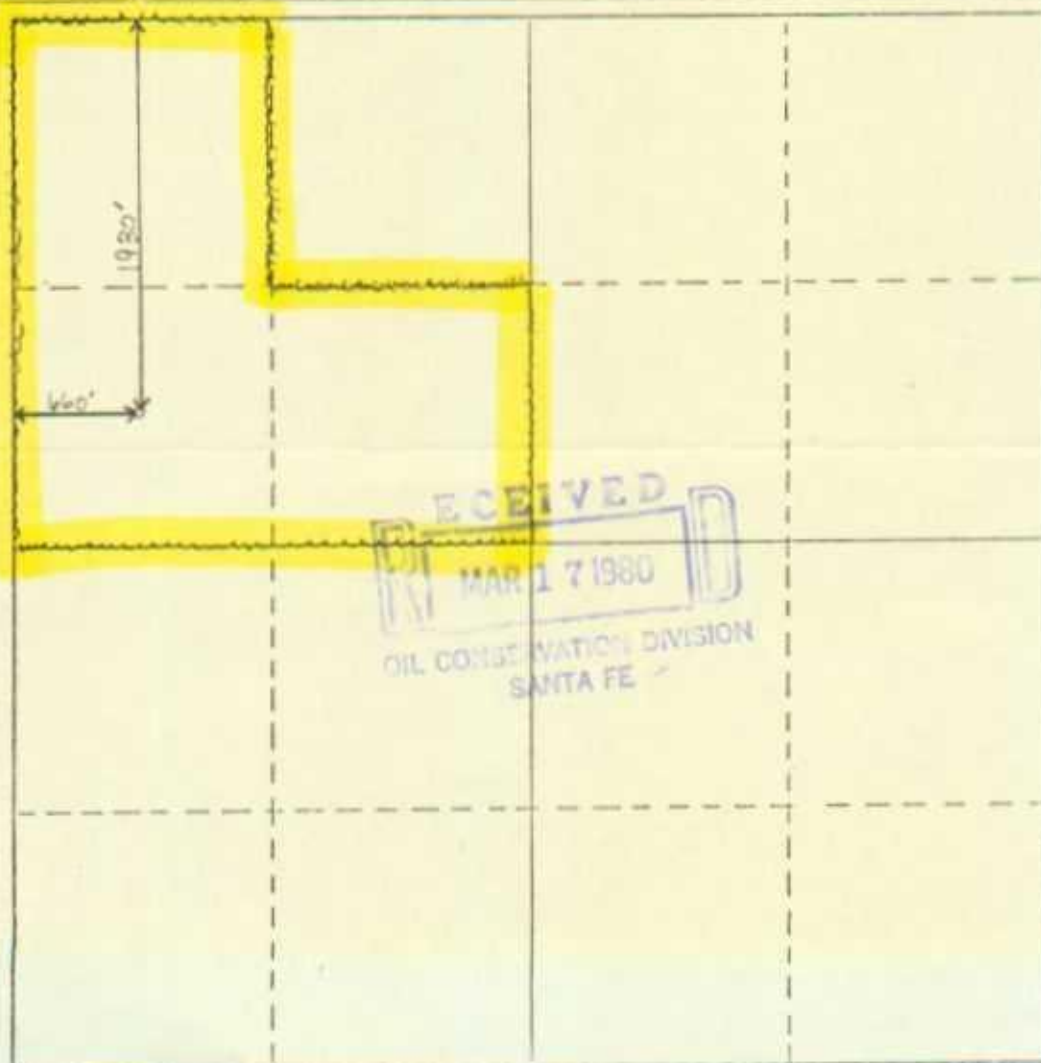

CERTIFICATION

I hereby certify that the information contained herein is true and complete to the best of my knowledge and belief.

Name: *Ray Cox*
 Position: Administrative Supervisor
 Company: Amoco Production Company
 Date: October 24, 1979

I hereby certify that the well location shown on this plat was plotted from field notes of actual surveys made by me or under my supervision, and that the same is true and correct to the best of my knowledge and belief.

Date Surveyed: _____
 Registered Professional Engineer and/or Land Surveyor

Certification No. _____





STATE OF NEW MEXICO
ENERGY AND MINERALS DEPARTMENT
OIL CONSERVATION DIVISION

BRUCE KING
GOVERNOR
LARRY KEHOE
SECRETARY

March 21, 1980

POST OFFICE BOX 2088
STATE LAND OFFICE BUILDING
SANTA FE, NEW MEXICO 87501
(505) 827-2434

Amoco Production Company
P. O. Box 68
Hobbs, New Mexico 88240

Re: Application for Non-Standard
Proration Unit: 120-acres for
State "C" Tr. 13 Well No. 5
Sec. 36, T-21-S, R-37-E, Blinebry
Oil and Gas Pool

We may not process the subject application for a non-standard proration unit until the required information or plats checked below (is)(are) submitted.

- ☒ A plat must be submitted clearly showing the ownership of the offsetting leases.
- ☒ A statement must be submitted that offset owners have been notified of the application by certified mail.
- ☐ A plat must be submitted identifying the requested non-standard proration unit and offsetting acreage.
- ☐ The pool(s) or formation(s) for which the non-standard proration unit is requested must be identified.
- ☐ Other:

Very truly yours,

R. L. STAMETS
Technical Support Chief

RLS/dr

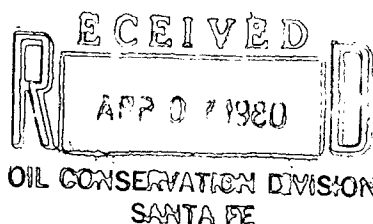

Amoco Production Company
P. O. Box 68
Hobbs, NM 88240

March 25, 1980

File: SJ0-986.51 X WF-397

Re: Waivers Consent Non-standard Proration Unit
State "C" Tract 13 Well No. 5
Blinebry Oil and Gas
Lea County, New Mexico

Atlantic Richfield Company
P. O. Box 1610
Midland, TX 79701

Gentlemen:

We are requesting your approval as an offset operator for a 120 acre non-standard proration unit on our State "C" Tract 13 Well No. 5. Subject well is located 1980' FNL and 660' FWL, Section 36, T-21-S, R-37-E, Lea County, New Mexico.

This non-standard proration unit is required due to the completion of our State "C" Tract 13 Well No. 10 as an oil well in the Blinebry Oil and Gas pool which requires 40 acres to be dedicated out of the original 160 acre dedication. Well No. 10 is located 990' FNL and 1980' FWL, Section 36, T-21-S, R-37-E, Lea County, New Mexico.

We have filed, with the NMOCD in Santa Fe, an application for the non-standard proration unit. Please approve and return a signed copy of this letter to this office and one to the NMOCD in Santa Fe. Self-addressed envelopes are enclosed.

Yours very truly,

Approved: ARCO Oil & Gas

By: Reese W. Lubeke

Date: 4-2-80

S. J. Okerson

S. J. OKERSON
District Superintendent

Enclosures

cc: NMOCD - Hobbs

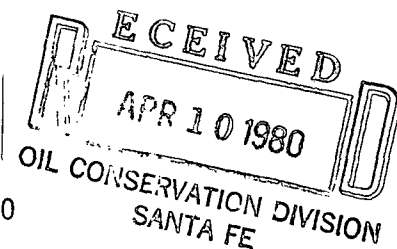

Amoco Production Company

P. O. Box 68
Hobbs, NM 88240

March 25, 1980

File: SJ0-986.51 X WF-400

Re: Waivers Consent Non-standard Proration Unit
State "C" Tract 13 Well No. 5
Blinebry Oil and Gas
Lea County, New Mexico

Petro-Lewis Corporation
P. O. Box 2250
Denver, CO 80201

Gentlemen:

We are requesting your approval as an offset operator for a 120 acre non-standard proration unit on our State "C" Tract 13 Well No. 5. Subject well is located 1980' FNL and 660' FWL, Section 36, T-21-S, R-37-E, Lea County, New Mexico.

This non-standard proration unit is required due to the completion of our State "C" Tract 13 Well No. 10 as an oil well in the Blinebry Oil and Gas pool which requires 40 acres to be dedicated out of the original 160 acre dedication. Well No. 10 is located 990' FNL and 1980' FWL, Section 36, T-21-S, R-37-E, Lea County, New Mexico.

We have filed, with the NMOCD in Santa Fe, an application for the non-standard proration unit. Please approve and return a signed copy of this letter to this office and one to the NMOCD in Santa Fe. Self-addressed envelopes are enclosed.

Yours very truly,

Original Signed By
S. J. OKERSON

Approved: PETRO- LEWIS
By: Don Dufota
Date: 4-7-80

S. J. OKERSON
District Superintendent

Enclosures

cc: NMOCD - Hobbs

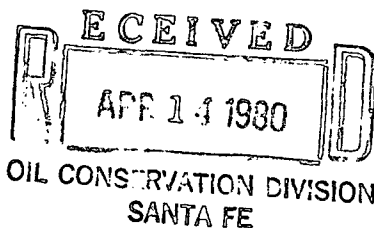

Amoco Production Company

P. O. Box 68
Hobbs, NM 88240

March 25, 1980

File: SJO-986.51 X WF-399

Re: Waivers Consent Non-standard Proration Unit
State "C" Tract 13 Well No. 5
Blinebry Oil and Gas
Lea County, New Mexico

Cities Service Company
P. O. Box 1919
Midland, TX 79702

Gentlemen:

We are requesting your approval as an offset operator for a 120 acre non-standard proration unit on our State "C" Tract 13 Well No. 5. Subject well is located 1980' FNL and 660' FWL, Section 36, T-21-S, R-37-E, Lea County, New Mexico.

This non-standard proration unit is required due to the completion of our State "C" Tract 13 Well No. 10 as an oil well in the Blinebry Oil and Gas pool which requires 40 acres to be dedicated out of the original 160 acre dedication. Well No. 10 is located 990' FNL and 1980' FWL, Section 36, T-21-S, R-37-E, Lea County, New Mexico.

We have filed, with the NMOCD in Santa Fe, an application for the non-standard proration unit. Please approve and return a signed copy of this letter to this office and one to the NMOCD in Santa Fe. Self-addressed envelopes are enclosed.

Yours very truly,

Original Signed By
S. J. OKERSON

CITIES SERVICE COMPANY.
Approved: _____
By: [Signature] MANAGER PRODUCTION
SOUTHWEST REGION
Date: 4/11/80

S. J. OKERSON
District Superintendent

Enclosures

cc: NMOCD - Hobbs



Amoco Production Company
P. O. Box 68
Hobbs, NM 88240

March 28, 1980

File: SJO-986.51 X WF-424

Re: Application for Non-Standard Proration Unit
State "C" Tract 13 Well No. 5
1980' FNL & 660' FWL
Section 36, T-21S, R37E
Lea County, New Mexico

State of New Mexico
Energy and Minerals Department
Oil Conservation Division
P. O. Box 2088
Santa Fe, NM 87501

Gentlemen:

In reply to your letter of March 21, 1980, the additional information required before the processing of our application can begin for a 120 acre non-standard proration unit on our State "C" Tract 13 Well No. 5 is furnished by attachment. Attached is a map showing offset operators, a copy of the letter sent to all offset operators and a copy of the certified mail receipt from each letter.

Yours very truly,

S. J. OKERSON
District Superintendent

Attachments

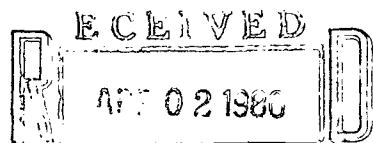

OIL CONSERVATION DIVISION
SANTA FE

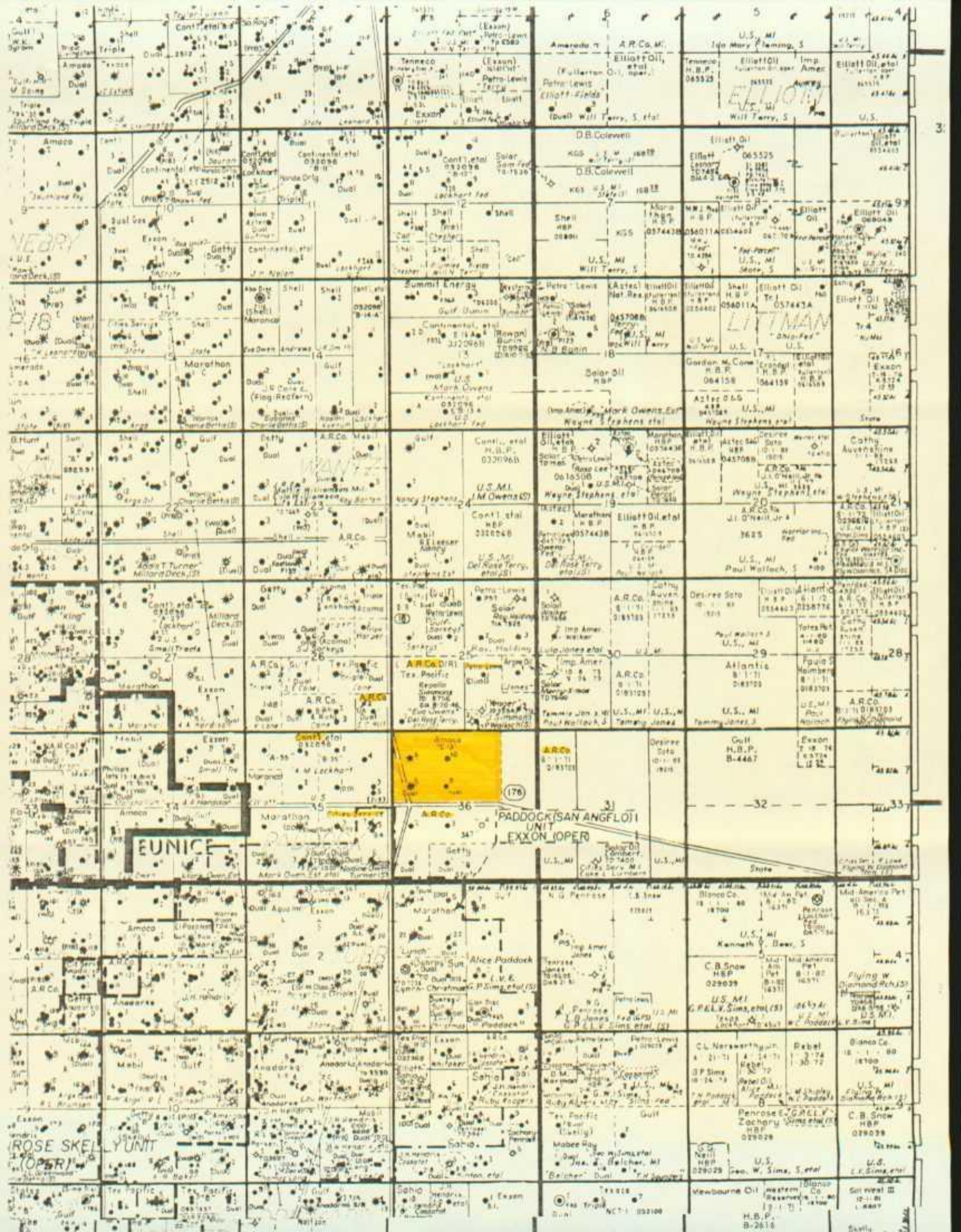

P. O. Box 68
Hobbs, NM 88240

Admin Open
4-25-80

March 25, 1980

File: SJ-986.51 X WF-397

Re: Waivers Consent Non-standard Proration Unit
State "C" Tract 13 Well No. 5
Blinbry Oil and Gas
Lea County, New Mexico

SEE ATTACHED ADDRESSEE LIST

Gentlemen:

We are requesting your approval as an offset operator for a 120 acre non-standard proration unit on our State "C" Tract 13 Well No. 5. Subject well is located 1980' FNL and 660' FNL, Section 36, T-21-S, R-37-E, Lea County, New Mexico.

This non-standard proration unit is required due to the completion of our State "C" Tract 13 Well No. 10 as an oil well in the Blinbry Oil and Gas pool which requires 40 acres to be dedicated out of the original 160 acre dedication. Well No. 10 is located 990' FNL and 1980' FNL, Section 36, T-21-S, R-37-E, Lea County, New Mexico.

We have filed, with the NMOCD in Santa Fe, an application for the non-standard proration unit. Please approve and return a signed copy of this letter to this office and one to the NMOCD in Santa Fe. Self-addressed envelopes are enclosed.

Yours very truly,

/s/ SJO
Original Signed By
S. J. OKERSON

Approved: _____

By: _____

Date: _____

S. J. OKERSON
District Superintendent

Enclosures

cc: NMOCD - Hobbs

OIL CONSERVATION DIVISION
SANTBDY/r1b

Atlantic Richfield Company
P. O. Box 1610
Midland, TX 79701

Conoco, Inc.
P. O. Box 460
Hobbs, NM 88240

Cities Service Company
P. O. Box 1919
Midland, TX 79702

Petro-Lewis Corporation
P. O. Box 2250
Denver, CO 80201

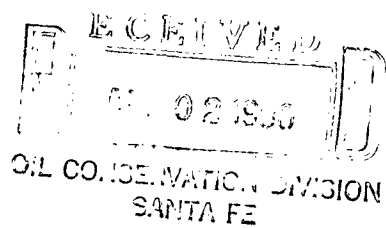

P00 2884544

RECEIPT FOR CERTIFIED MAIL

NO INSURANCE COVERAGE PROVIDED—
NOT FOR INTERNATIONAL MAIL
(See Reverse)

SENT TO		Atlantic Richfield Co.	
STREET AND NO.		P. O. Box 1610	
P.O. STATE AND ZIP CODE		Midland, TX 79701	
POSTAGE		\$ 28¢	
CERTIFIED FEE		80 ¢	
SPECIAL DELIVERY		c	
RESTRICTED DELIVERY		c	
RETURN RECEIPT SERVICE		c	
SHOW TO WHOM AND DATE DELIVERED		45 ¢	
SHOW TO WHOM, DATE AND ADDRESS OF DELIVERY WITH RESTRICTED DELIVERY		c	
TOTAL POSTAGE AND FEES		\$1.53	
POSTMARK OR DATE			

PS Form 3800, Apr. 1976

P08 3839504

RECEIPT FOR CERTIFIED MAIL

NO INSURANCE COVERAGE PROVIDED—
NOT FOR INTERNATIONAL MAIL
(See Reverse)

SENT TO		Petro-Lewis Corporation	
STREET AND NO.		P. O. Box 2250	
P.O. STATE AND ZIP CODE		Denver, CO 80201	
POSTAGE		\$ 28¢	
CERTIFIED FEE		80 ¢	
SPECIAL DELIVERY		c	
RESTRICTED DELIVERY		c	
RETURN RECEIPT SERVICE		c	
SHOW TO WHOM AND DATE DELIVERED		45 ¢	
SHOW TO WHOM, DATE AND ADDRESS OF DELIVERY WITH RESTRICTED DELIVERY		c	
TOTAL POSTAGE AND FEES		\$ 1.53	
POSTMARK OR DATE			

PS Form 3800, Apr. 1976

P00 2884547

RECEIPT FOR CERTIFIED MAIL

NO INSURANCE COVERAGE PROVIDED—
NOT FOR INTERNATIONAL MAIL
(See Reverse)

SENT TO		Cities Service Company	
STREET AND NO.		P. O. Box 1919	
P.O. STATE AND ZIP CODE		Midland, TX 79702	
POSTAGE		\$ 28¢	
CERTIFIED FEE		80 ¢	
SPECIAL DELIVERY		c	
RESTRICTED DELIVERY		c	
RETURN RECEIPT SERVICE		c	
SHOW TO WHOM AND DATE DELIVERED		45 ¢	
SHOW TO WHOM, DATE AND ADDRESS OF DELIVERY WITH RESTRICTED DELIVERY		c	
TOTAL POSTAGE AND FEES		\$ 1.53	
POSTMARK OR DATE			

PS Form 3800, Apr. 1976

P00 2884545

RECEIPT FOR CERTIFIED MAIL

NO INSURANCE COVERAGE PROVIDED—
NOT FOR INTERNATIONAL MAIL
(See Reverse)

SENT TO		Conoco, Inc.	
STREET AND NO.		P. O. Box 460	
P.O. STATE AND ZIP CODE		Hobbs, NM 88240	
POSTAGE		\$ 28¢	
CERTIFIED FEE		80 ¢	
SPECIAL DELIVERY		c	
RESTRICTED DELIVERY		c	
RETURN RECEIPT SERVICE		c	
SHOW TO WHOM AND DATE DELIVERED		45 ¢	
SHOW TO WHOM, DATE AND ADDRESS OF DELIVERY WITH RESTRICTED DELIVERY		c	
TOTAL POSTAGE AND FEES		\$1.53	
POSTMARK OR DATE			

OIL CONSERVATION DIVISION
SANTA FE



L. P. Thompson
Division Manager

John R. Kemp
Assistant Division Manager

Production Department
Hobbs Division
North American Production

Conoco Inc.
P. O. Box 460
1001 North Turner
Hobbs, NM 88240
(505) 393-4141

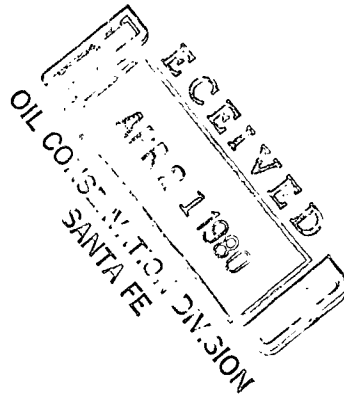

April 15, 1980

New Mexico Oil Conservation Division
Department of Energy and Minerals
P.O. Box 2088
Santa Fe, New Mexico 87501

Attention Mr. Dan Nutter

Gentlemen:

Waivers Consent Non-Standard Proration Unit - State "C" Tract 13
Well No. 5 - Blinebry Oil and Gas - Lea County, New Mexico

Attached is an approved waiver on behalf of Conoco Inc., as requested
by Amoco.

Very truly yours,

HAI:rej
Enc
CC
Amoco Production Company
P.O. Box 68
Hobbs, NM 88240



Amoco Production Company

P. O. Box 68
Hobbs, NM 88240

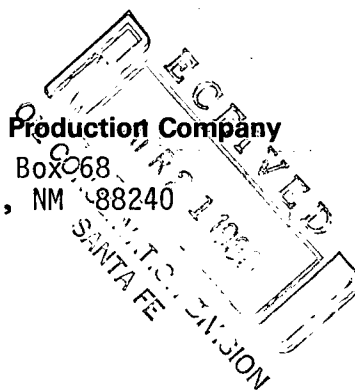

March 25, 1980

File: SJ0-986.51 X WF-398

Re: Waivers Consent Non-standard Proration Unit
State "C" Tract 13 Well No. 5
Blinebry Oil and Gas
Lea County, New Mexico

Conoco, Inc.
P. O. Box 460
Hobbs, NM 88240

Gentlemen:

We are requesting your approval as an offset operator for a 120 acre non-standard proration unit on our State "C" Tract 13 Well No. 5. Subject well is located 1980' FNL and 660' FWL, Section 36, T-21-S, R-37-E, Lea County, New Mexico.

This non-standard proration unit is required due to the completion of our State "C" Tract 13 Well No. 10 as an oil well in the Blinebry Oil and Gas pool which requires 40 acres to be dedicated out of the original 160 acre dedication. Well No. 10 is located 990' FNL and 1980' FWL, Section 36, T-21-S, R-37-E, Lea County, New Mexico.

We have filed, with the NMOCD in Santa Fe, an application for the non-standard proration unit. Please approve and return a signed copy of this letter to this office and one to the NMOCD in Santa Fe. Self-addressed envelopes are enclosed.

Yours very truly,

Original Signed By
S. J. OKERSON

Approved: CONOCO INC.

By:

John R. Kemp
John R. Kemp

Date:

4-15-80

S. J. OKERSON
District Superintendent

Enclosures

cc: NMOCD - Hobbs