

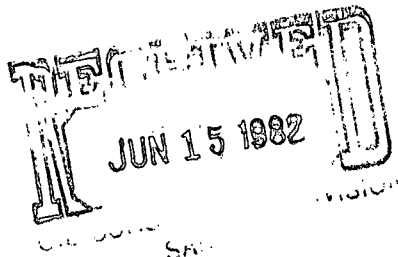

Sun Exploration and
Production Company
901 W Wall
Post Office Box 1861
Midland Texas 79702
915 685 0300

June 10, 1982

State of New Mexico
Energy and Minerals Department
Oil Conservation Division
P.O. Box 2088
State Land Office Building
Santa Fe, New Mexico 87501



Attn: R.L. Stamets
Technical Support Chief

Re: Sun Exploration & Production Co.
WOOLWORTH NO. 1
Jalmat Tansill Yates 7 Rvrs. Field
S/2 SE/4 of Sec. 26, T-24-S
R-36-E, Jalmat Gas Pool
Lea County, New Mexico

Dear Mr. Stamets:

Per your request of June 3, 1982, copy attached, we have notified all offset operators of our recent Tansill gas recompletion. Attached is copy of letter sent to offset operators by certified mail, plat and address of offset operators.

If you require any additional information, please call (915) 685-0452.

Yours truly,

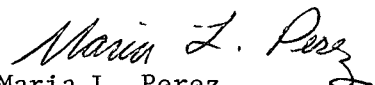
Maria L. Perez
Senior Accounting Assistant

MLP:js



STATE OF NEW MEXICO
ENERGY AND MINERALS DEPARTMENT
OIL CONSERVATION DIVISION

BRUCE KING
GOVERNOR

LARRY KEHOE
SECRETARY

June 3, 1982

POST OFFICE BOX 2088
STATE LAND OFFICE BUILDING
SANTA FE, NEW MEXICO 87501
(505) 827-2434

Sun Exploration and
Production Company
P. O. Box 1861
Midland, Texas 79702

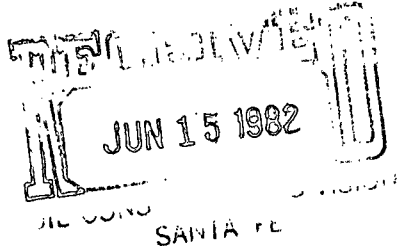

Re: Application for Non-Standard
Proration Unit: Woolworth No. 1,
S/2 SE/4 of Sec. 26, T-24-S,
R-36-E, Jalmat Gas Pool, Lea County

We may not process the subject application for a non-standard proration unit until the required information or plats checked below (is)(are) submitted.

- ☒ A plat must be submitted clearly showing the ownership of the offsetting leases including all leases in the same section.
- ☒ A statement must be submitted that offset owners have been notified of the application by certified mail including all operators in the same section.
- ☐ A plat must be submitted identifying the requested non-standard proration unit and offsetting acreage.
- ☐ The pool(s) or formation(s) for which the non-standard proration unit is requested must be identified.
- ☐ Other:

Very truly yours,

R. L. STAMETS
Technical Support Chief

RLS/dr

OIL CONSERVATION DIVISION

P. O. BOX 2088
SANTA FE, NEW MEXICO 87501

Form C-103
Revised 10-1-78

NO. OF COPIES RECEIVED	
DISTRIBUTION	
SANTA FE	
FILE	
U.S.O.S.	
LAND OFFICE	
OPERATOR	

5a. Indicate Type of Lease	
State <input type="checkbox"/>	Fee <input checked="" type="checkbox"/>
5. State Oil & Gas Lease No.	
Patented	

SUNDRY NOTICES AND REPORTS ON WELLS

(DO NOT USE THIS FORM FOR PROPOSALS TO DRILL OR TO DEEPEN OR PLUG BACK TO A DIFFERENT RESERVOIR.
USE "APPLICATION FOR PERMIT" (FORM C-101) FOR SUCH PROPOSALS.)

1. OIL WELL <input checked="" type="checkbox"/> GAS WELL <input type="checkbox"/> OTHER <input type="checkbox"/>	7. Unit Agreement Name
2. Name of Operator Sun Exploration & Production Co.	8. Farm or Lease Name Woolworth
3. Address of Operator P.O. Box 1861, Midland, Texas 79702	9. Well No. 1
4. Location of Well UNIT LETTER <u>P</u> <u>660</u> FEET FROM THE <u>South</u> LINE AND <u>330</u> FEET FROM THE <u>East</u> LINE, SECTION <u>26</u> TOWNSHIP <u>24-S</u> RANGE <u>36-E</u> N.M.P.M.	10. Field and Pool, or Wildcat Jalmat Tansill Yates 7 RVR
11. Elevation (Show whether DF, RT, GR, etc.) 3288 DF 3281 GR	12. County Lea

Check Appropriate Box To Indicate Nature of Notice, Report or Other Data
NOTICE OF INTENTION TO:

SUBSEQUENT REPORT OF:

PERFORM REMEDIAL WORK <input type="checkbox"/>	PLUG AND ABANDON <input type="checkbox"/>	REMEDIAL WORK <input type="checkbox"/>	ALTERING CASING <input type="checkbox"/>
TEMPORARILY ABANDON <input type="checkbox"/>	CHANGE PLANS <input type="checkbox"/>	COMMENCE DRILLING OPNS. <input type="checkbox"/>	PLUG AND ABANDONMENT <input type="checkbox"/>
PULL OR ALTER <input type="checkbox"/>	OTHER <input type="checkbox"/>	CASING TEST AND CEMENT JOB <input type="checkbox"/>	
OTHER <input type="checkbox"/>		OTHER <u>Recomplete to the Tansill formation</u>	

as a gas well.

17. Describe Proposed or Completed Operations (Clearly state all pertinent details, and give pertinent dates, including estimated date of starting any proposed work) SEE RULE 103.

This well was a Jalmat oil well. Have recompleted to the Tansill as a gas well.

5-19-82: POH w/ Rods & Pump (LD) NU BOP. POH w/ 2-3/8 tbg. w/ pumping setup, Dresser Atlas ran 5 1/2 Baker Gage ring & junk Basket 2680, 5-1/2 CS, Ran GR-CCL Log 2680-1800, Set 5 1/2 CIBP 2670, Pump 20' Cmt. Top CIBP Load CSG w/ 2% KCL. Test CSG 300#.

5-20-82: RIH w/ 2-7/8 to 2612 (Western test csg 600# 1/4 hr OK) Spot 100Gal 15% HCL 2612-2512 POH w/ 2-7/8 tbg/ Dresser Perf 2580-2612, 1JSPF, (DA Jambo Jet II) RIH w/ Otis 5 1/2 Perma-Latch PKR and OSTSD w/ 1.791 "N" Profile & 2-7/8 tbg. Set pkr 2394, SDFN.

5-21-82: Rlse PKR NU WH, Set PKR at 2394 (17 pt tension) Western (trap 400# on Annulus) Acdz perfs 2580-2612 w/ 3000 gal 15% HCL w/ additives and 56,600 SCF Nitrogen and 45 ball sealers, BD 1800, Max 2100 Min 1300 Avg 1600 FP 1500 1SIP 100. 10 min 800 AIR 5 BPM -87 BLAW BA 1300-2100 Balled out w/ 5600 gal in form. Flow 2 hrs end 3:30 pm, Rec no oil, 15 BLAW, 48/64 CK TP800-0 Swab 2 hrs (end 5:30 pm) Rec no oil. 10 BLAW, FL 0-2390 Wells started flowing LOON. Flow 11 1/2 hrs. Rec. good gas (225mcf est.) 40/64ck TP 0-38 PSI.

5-22-82: 12 hrs., F, 12 BLW, FARO 156 MCF/D.

5-25-82: SITP 360 Western frac Perfs 2580-2612 w/ 25,500 gal 70 quality form (5850 gal 2% KCL & 301,369 SCF N2) 28,750 # 20/40 SD. BD 2400 Max 3200 Min 2200 AVG 3000 FP 2850 ISIP 2100 15 min. 1500 AIR 16 BPM -169 BLAW. Flowed 17 hrs. Rec 0 oil, 73 BLW, TP 1500-200, Various cks on 22/64 This AM-96 BLAW.

18. I hereby certify that the information above is true and complete to the best of my knowledge and belief.

SIGNED Maria L. Perez TITLE Sr. Acctg. Assist DATE June 2, 1982

APPROVED BY _____ TITLE _____ DATE _____

CONDITIONS OF APPROVAL, IF ANY:

Woolworth
Workover, page two
6/2/82

- 5-26-82: Flowed 24 hrs. Rec. 20 BLW, Flowed gas rate 326 MCF/D TP 175 22/64 ck
-76 BLW
- 5-27-82: Otis set Blanking plug in OSTSD.(NUBOP) Rlse OSTSD POH & LN 2-7/8 WS.
RIH w/ 2-3/8 prod tbg and OS to 2393 circ hole w/ 50 bbls treat wtr
(Remove BOP) Latch Perma-Latch at 2394. Swab tbg to 1700'.
Otis pull Blanking plug, TP 140 PSI.
- 5-28-82: Flow 11 hrs. End 7:30 pm. Gas rate 435 MCF/D 24/64 ck, TP 160
- 5-29-82: RR 9 am. 5-27-82, 24 hrs. F, no fluid, 376 MCF, 24/64 CKR, TP 160
- 5-30-82: 24 hrs., F, no fluid, 341 MCF, 24/64 CKR, TP 160.
Potential test.



Sun Production Division
Southwestern District

Sun Exploration and
Production Company
901 W Wall
Post Office Box 1861
Midland Texas 79702
915 685 0300

May 27, 1982

Minerals Management Service
P.O. Box 2088
Santa Fe, New Mexico 87501

Re: Sun Exploration & Production Co.
Woolworth No. 1
Jalmat Tansill Yates 7 Rvrs
Lea County, New Mexico

Gentlemen:

Sun Exploration & Production Co. is requesting administrative approval for a non-standard location on our Woolworth No. 1, Unit letter 'P', 660' FSL & 330' FEL of Sec. 26, T-24-S, R-36-E, Lea County, New Mexico.

This well is presently classified as a Jalmat oil well. We are presently working over the well and will recomplete to the Tansill formation as a gas well. The surface contiguous acres are 80 and 80 acres has been dedicated to the well.

If you require additional information, please call (915) 685-0452.

Yours truly,
SUN EXPLORATION & PRODUCTION CO.

Maria L. Perez

Maria L. Perez
Senior Accounting Assistant

Attachment: C-102

cc: Minerals Management Service
P.O. Drawer 1980
Hobbs, New Mexico 88240

JUN 02 1982

OIL CONSERVATION
SANTA FE

NSP(L)-1319
Jalmat Gas Pool
Gas Well
Rule 5C3
Rule 3 (Lea)
7-15-82

**NEW MEXICO OIL CONSERVATION COMMISSION
WELL LOCATION AND ACREAGE DEDICATION PLAT**

Form C-102
Supersedes C-128
Effective 1-1-85

All distances must be from the outer boundaries of the Section.

Operator Sun Exploration & Production Co.			Lease Woolworth		Well No. 1
Unit Letter P	Section 26	Township 24-S	Range 36-E	County Lea	
Actual Footage Location of Wells: 600 feet from the South line and 330 feet from the East line					
Ground Level Elev. 3288 DF 3281 GR	Producing Formation Tansill	Pool Jalmat Tansill Yates 7 Rvrs		Dedicated Acreage 160 Acres	

1. Outline the acreage dedicated to the subject well by colored pencil or hachure marks on the plat below.
2. If more than one lease is dedicated to the well, outline each and identify the ownership thereof (both as to working interest and royalty).
3. If more than one lease of different ownership is dedicated to the well, have the interests of all owners been consolidated by communitization, unitization, force-pooling, etc?

☐ Yes ☐ No If answer is "yes," type of consolidation _____

If answer is "no," list the owners and tract descriptions which have actually been consolidated. (Use reverse side of this form if necessary.) _____

No allowable will be assigned to the well until all interests have been consolidated (by communitization, unitization, forced-pooling, or otherwise) or until a non-standard unit, eliminating such interests, has been approved by the Commission.

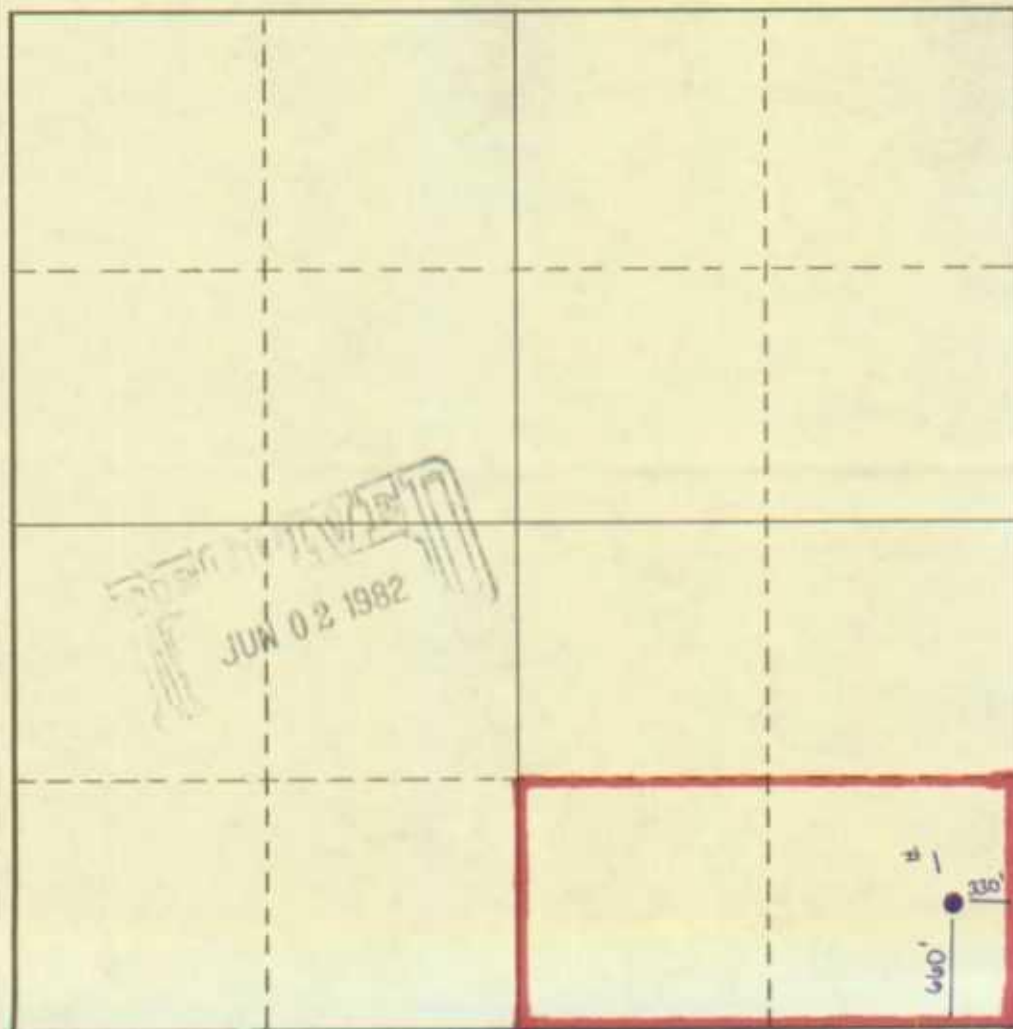

CERTIFICATION

I hereby certify that the information contained herein is true and complete to the best of my knowledge and belief.

Maria L. Perez

Name **Maria L. Perez**
Position **Sr. Acctg. Assist**

Sun Exploration & Production Co.
Company

May 27, 1982
Date

I hereby certify that the well location shown on this plat was plotted from field notes of actual surveys made by me or under my supervision, and that the same is true and correct to the best of my knowledge and belief.

Date Surveyed _____

Registered Professional Engineer
and/or Land Surveyor

Certificate No. _____

