

August 23, 1982

NSP 1332
Rule 5 (c) (3) R1670
9-23-82

Shell Oil Company



P.O. Box 991
Houston, Texas 77001

State of New Mexico
Energy and Minerals Department
Oil Conservation Division
P. O. Box 2088
Santa Fe, New Mexico 87501

Gentlemen:

SUBJECT: APPLICATION FOR NON-STANDARD
GAS PRORATION UNIT
SHELL - STATE 1-Y
JALMAT POOL *Gas Pool*
LEA COUNTY, NEW MEXICO

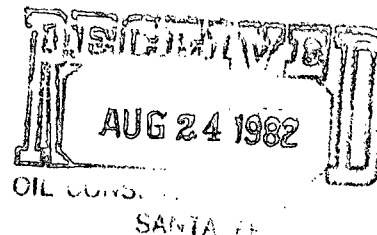

Shell Oil Company respectfully requests administrative approval to assign an 80-acre non-standard gas proration unit to Shell-State 1-Y. At the present time, the acreage is assigned as follows:

State No. 1-Y, 40 acres State No. 2, 40 acres (TA'd).

Due to a recent gas-oil ratio test, the well will be reclassified from an oil well to a gas well in the Jalmat pool effective September 1, 1982.

State 1-Y is located in Unit Letter D, 380 FNL and 380 FWL, Section 36, T-24-S, R-36-E, Lea County, New Mexico.

A copy of this application has been furnished to all offset operators by certified mail.

If additional information is required, please advise.

Yours very truly,

A. J. Fore
Supervisor Regulatory and Permitting
Mid-Continent Division

DMB:dmb

Attachments

cc: State of New Mexico
Energy and Minerals Department
Oil Conservation Division
P. O. Box 1980
Hobbs, New Mexico 88240

Offset Operators
(List Attached)

**NEW MEXICO OIL CONSERVATION COMMISSION
WELL LOCATION AND ACREAGE DEDICATION PLAT**

Form C-102
Supersedes C-128
Effective 1-4-81

All distances must be from the outer boundaries of the Section

Operator SHELL OIL COMPANY			Lease STATE		Well No. 1-Y
Unit Letter D	Section 36	Township 24-S	Range 36-E	County LEA	
Actual Footage Location of Well: 380 feet from the NORTH line and 380 feet from the WEST line					
Ground Level Elev. 3281' DF	Producing Formation YATES		Pool JALMAT	Dedicated Acreage: 80 Acres	

1. Outline the acreage dedicated to the subject well by colored pencil or hachure marks on the plat below.
2. If more than one lease is dedicated to the well, outline each and identify the ownership thereof (both as to working interest and royalty).
3. If more than one lease of different ownership is dedicated to the well, have the interests of all owners been consolidated by communitization, unitization, force-pooling, etc?

☐ Yes ☐ No If answer is "yes," type of consolidation _____

If answer is "no," list the owners and tract descriptions which have actually been consolidated. (Use reverse side of this form if necessary.) _____

No allowable will be assigned to the well until all interests have been consolidated (by communitization, unitization, forced-pooling, or otherwise) or until a non-standard unit, eliminating such interests, has been approved by the Commission.

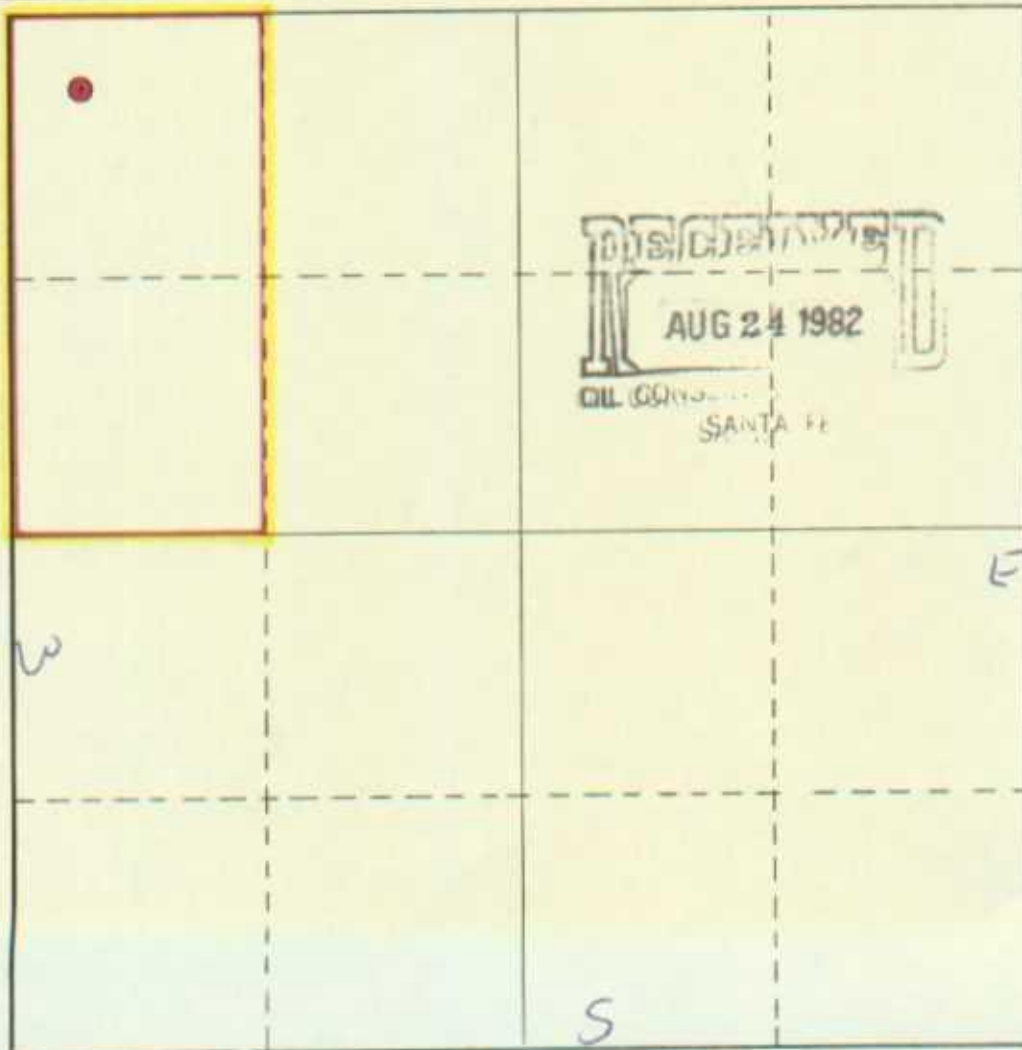

CERTIFICATION

I hereby certify that the information contained herein is true and complete to the best of my knowledge and belief.

Name A. J. FORE
Position SUPERVISOR
REGULATORY & PERMITTING

Company
SHELL OIL COMPANY

Date
AUGUST 23, 1982

I hereby certify that the well location shown on this plat was plotted from field notes of actual surveys made by me or under my supervision, and that the same is true and correct to the best of my knowledge and belief.

Date Surveyed

Registered Professional Engineer
and/or Land Surveyor

Certificate No.

OFFSET OPERATORS

SHELL - STATE LEASE

ARES PRODUCTION COMPANY
P. O. BOX 5317
MIDLAND, TEXAS 79701

EXXON COMPANY U.S.A.
P. O. BOX 6100
MIDLAND, TEXAS 79701

GETTY OIL COMPANY
P. O. BOX 730
HOBBS, NEW MEXICO 88240

MILLARD DECK OIL COMPANY
LOOP 18
EUNICE, NEW MEXICO 88231

TEXAS PACIFIC OIL COMPANY INC.
P. O. BOX 4067
MIDLAND, TEXAS 79701

WARRIOR INC.
C/O UNIQUE ENGINEERING
P. O. BOX 5315
HOBBS, NEW MEXICO 88240

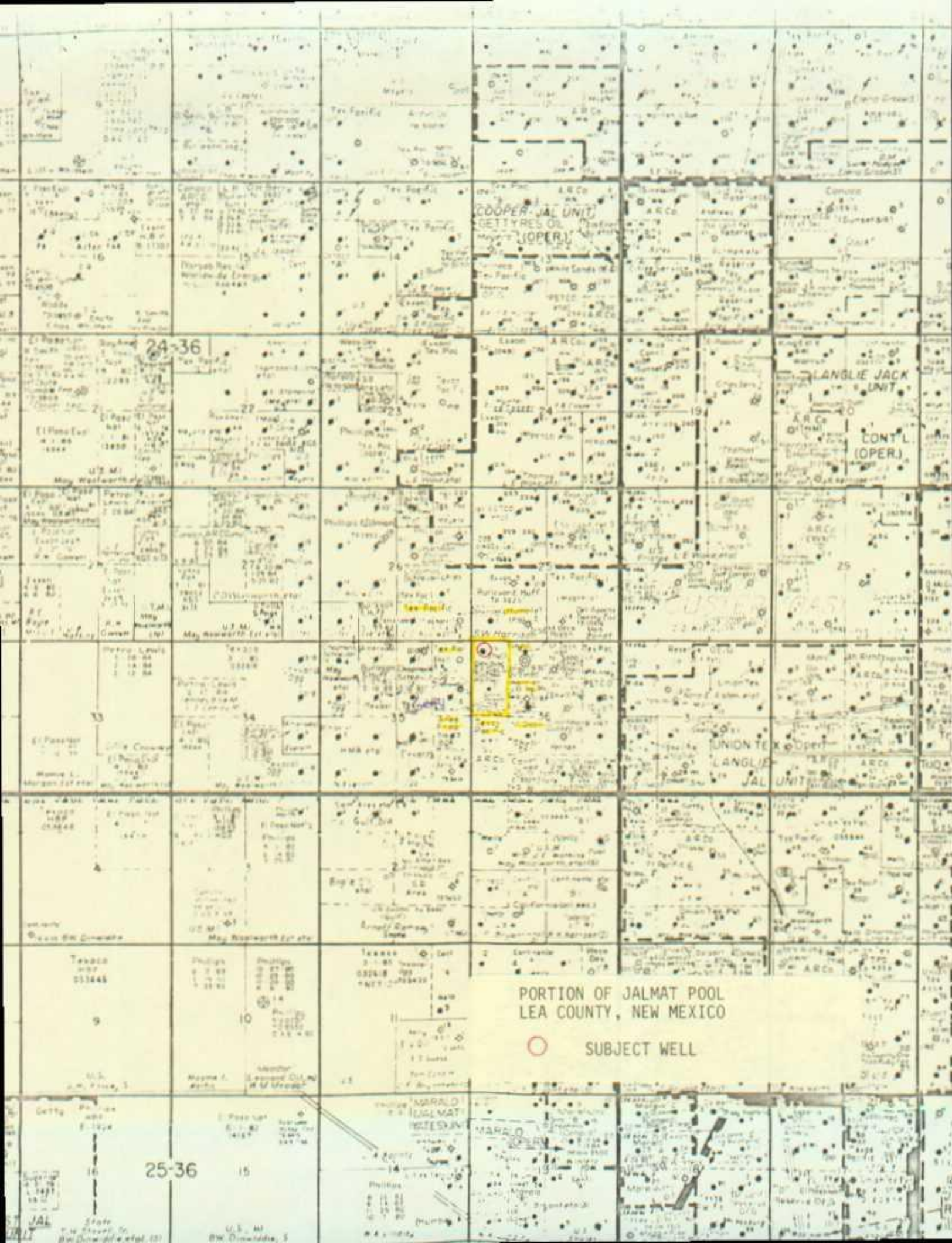

P 226 788 955

RECEIPT FOR CERTIFIED MAIL

NO INSURANCE COVERAGE PROVIDED—
NOT FOR INTERNATIONAL MAIL
(See Reverse)

SENT TO		ARES PRODUCTION COMPANY	
STREET AND NO.		P. O. BOX 5317	
P.O., STATE AND ZIP CODE		MIDLAND, TEXAS 79701	
POSTAGE		\$	
CONSULT POSTMASTER FOR FEES	OPTIONAL SERVICES	CERTIFIED FEE	¢
		SPECIAL DELIVERY	¢
		RESTRICTED DELIVERY	¢
	RETURN RECEIPT SERVICE	SHOW TO WHOM AND DATE DELIVERED	¢
		SHOW TO WHOM, DATE, AND ADDRESS OF DELIVERY	¢
		SHOW TO WHOM AND DATE DELIVERED WITH RESTRICTED DELIVERY	¢
		SHOW TO WHOM, DATE AND ADDRESS OF DELIVERY WITH RESTRICTED DELIVERY	¢
TOTAL POSTAGE AND FEES		\$	
POSTMARK OR DATE		D. M. BRANFORD WCK 4435 AUGUST 23, 1982	

PS Form 3800, Apr. 1976

P 226 788 956

RECEIPT FOR CERTIFIED MAIL

NO INSURANCE COVERAGE PROVIDED—
NOT FOR INTERNATIONAL MAIL
(See Reverse)

SENT TO		EXXON COMPANY U.S.A.	
STREET AND NO.		P. O. BOX 6100	
P.O., STATE AND ZIP CODE		MIDLAND, TEXAS 79701	
POSTAGE		\$	
CONSULT POSTMASTER FOR FEES	OPTIONAL SERVICES	CERTIFIED FEE	¢
		SPECIAL DELIVERY	¢
		RESTRICTED DELIVERY	¢
	RETURN RECEIPT SERVICE	SHOW TO WHOM AND DATE DELIVERED	¢
		SHOW TO WHOM, DATE, AND ADDRESS OF DELIVERY	¢
		SHOW TO WHOM AND DATE DELIVERED WITH RESTRICTED DELIVERY	¢
		SHOW TO WHOM, DATE AND ADDRESS OF DELIVERY WITH RESTRICTED DELIVERY	¢
TOTAL POSTAGE AND FEES		\$	
POSTMARK OR DATE		D. M. BRANFORD WCK 4435 AUGUST 23, 1982	

PS Form 3800, Apr. 1976

P 226 788 957

RECEIPT FOR CERTIFIED MAIL

NO INSURANCE COVERAGE PROVIDED—
NOT FOR INTERNATIONAL MAIL
(See Reverse)

SENT TO		GETTY OIL COMPANY	
STREET AND NO.		P. O. BOX 730	
P.O., STATE AND ZIP CODE		HOBBS, NEW MEXICO 88240	
POSTAGE		\$	
CONSULT POSTMASTER FOR FEES	OPTIONAL SERVICES	CERTIFIED FEE	¢
		SPECIAL DELIVERY	¢
		RESTRICTED DELIVERY	¢
	RETURN RECEIPT SERVICE	SHOW TO WHOM AND DATE DELIVERED	¢
		SHOW TO WHOM, DATE, AND ADDRESS OF DELIVERY	¢
		SHOW TO WHOM AND DATE DELIVERED WITH RESTRICTED DELIVERY	¢
		SHOW TO WHOM, DATE AND ADDRESS OF DELIVERY WITH RESTRICTED DELIVERY	¢
TOTAL POSTAGE AND FEES		\$	
POSTMARK OR DATE		D. M. BRANFORD WCK 4435 AUGUST 23, 1982	

PS Form 3800, Apr. 1976

CERTIFIED

P 226 788 955

MAIL

CERTIFIED

P 226 788 956

MAIL

CERTIFIED

P 226 788 957

MAIL

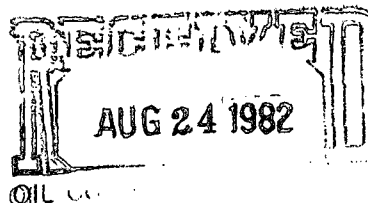

P 226 788 958

RECEIPT FOR CERTIFIED MAIL

NO INSURANCE COVERAGE PROVIDED—
NOT FOR INTERNATIONAL MAIL
(See Reverse)

SENT TO	
MILLARD DECK OIL COMPANY	
STREET AND NO.	
LOOP 18	
P.O., STATE AND ZIP CODE	
EUNICE, NEW MEXICO 88231	
POSTAGE	\$
CONSULT POSTMASTER FOR FEES	
CERTIFIED FEE	¢
OPTIONAL SERVICES	
SPECIAL DELIVERY	¢
RESTRICTED DELIVERY	¢
RETURN RECEIPT SERVICE	
SHOW TO WHOM AND DATE DELIVERED	¢
SHOW TO WHOM, DATE, AND ADDRESS OF DELIVERY	¢
SHOW TO WHOM AND DATE DELIVERED WITH RESTRICTED DELIVERY	¢
SHOW TO WHOM, DATE AND ADDRESS OF DELIVERY WITH RESTRICTED DELIVERY	¢
TOTAL POSTAGE AND FEES	\$
POSTMARK OR DATE	
D. M. BRANFORD WCK 4435 AUGUST 23, 1982	

PS Form 3800, Apr. 1976

CERTIFIED

P 226 788 958

MAIL

P 226 788 959

RECEIPT FOR CERTIFIED MAIL

NO INSURANCE COVERAGE PROVIDED—
NOT FOR INTERNATIONAL MAIL
(See Reverse)

SENT TO	
TEX. PACIFIC OIL CO. INC.	
STREET AND NO.	
P. O. BOX 4067	
P.O., STATE AND ZIP CODE	
MIDLAND, TEXAS 79701	
POSTAGE	\$
CONSULT POSTMASTER FOR FEES	
CERTIFIED FEE	¢
OPTIONAL SERVICES	
SPECIAL DELIVERY	¢
RESTRICTED DELIVERY	¢
RETURN RECEIPT SERVICE	
SHOW TO WHOM AND DATE DELIVERED	¢
SHOW TO WHOM, DATE, AND ADDRESS OF DELIVERY	¢
SHOW TO WHOM AND DATE DELIVERED WITH RESTRICTED DELIVERY	¢
SHOW TO WHOM, DATE AND ADDRESS OF DELIVERY WITH RESTRICTED DELIVERY	¢
TOTAL POSTAGE AND FEES	\$
POSTMARK OR DATE	
D. M. BRANFORD WCK 4435 AUGUST 23, 1982	

PS Form 3800, Apr. 1976

CERTIFIED

P 226 788 959

MAIL

P 226 788 960

RECEIPT FOR CERTIFIED MAIL

NO INSURANCE COVERAGE PROVIDED—
NOT FOR INTERNATIONAL MAIL
(See Reverse)

SENT TO	
WARRIOR INC.	
C/O UNIQUE ENGINEERING	
STREET AND NO.	
P. O. BOX 5315	
P.O., STATE AND ZIP CODE	
HOBBS, NEW MEXICO 88240	
POSTAGE	\$
CONSULT POSTMASTER FOR FEES	
CERTIFIED FEE	¢
OPTIONAL SERVICES	
SPECIAL DELIVERY	¢
RESTRICTED DELIVERY	¢
RETURN RECEIPT SERVICE	
SHOW TO WHOM AND DATE DELIVERED	¢
SHOW TO WHOM, DATE, AND ADDRESS OF DELIVERY	¢
SHOW TO WHOM AND DATE DELIVERED WITH RESTRICTED DELIVERY	¢
SHOW TO WHOM, DATE AND ADDRESS OF DELIVERY WITH RESTRICTED DELIVERY	¢
TOTAL POSTAGE AND FEES	\$
POSTMARK OR DATE	
D. M. BRANFORD WCK 4435 AUGUST 23, 1982	

PS Form 3800, Apr. 1976

CERTIFIED

P 226 788 960

MAIL

INSIDE
AUG 24 1982
OIL CO.