

DOYLE HARTMAN
Oil Operator
500 N. MAIN
P. O. BOX 10426
MIDLAND, TEXAS 79702
(915) 684-4011

NSP (2) 1336
Rule 5 (C) 3 and
Rule 3 R-1670
11-19-82 NSP

October 15, 1982

Mr. R. L. Stamets
State of New Mexico
Energy and Minerals Department
Oil Conservation Division
P. O. Box 2088
Santa Fe, New Mexico 87501

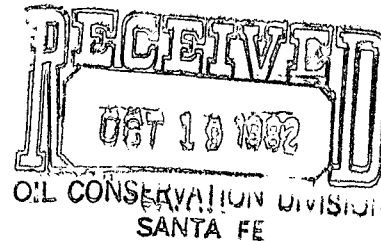

Re: State "28" No. 1
W/2 SE/4 and SW/4 NE/4
Sec. 28, T-19-S, R-37-E
Lea County, New Mexico
1. Request for Non-Standard
Proration Unit
2. Request for Unorthodox
Location
3. Notice of Sec. 103 Appli-
cation

Gentlemen:

In the near future, we plan to file a C-101 and C-102 with the New Mexico Oil Conservation Division District Office in Hobbs for permission to drill a new Eumont gas well as a Section 103 well at an unorthodox location consisting of 1880' FSL and 2180' FEL Section 28, T-19-S, R-37-E. The subject well will be drilled on a presently undedicated 120-acre non-standard proration unit comprised of the W/2 SE/4 and SW/4 NE/4 of Section 28, T-19-S, R-37-E, Lea County, New Mexico. A portion of the acreage to be dedicated to the proposed State "28" No. 1 was previously dedicated to Marathon's State A-3071 "D" No. 1 Eumont gas well located 1980' FSL and 1980' FEL of Section 28. The Marathon State A-3071 "D" No. 1 was plugged and abandoned on August 11, 1978.

Therefore, we hereby file for administrative approval to drill the newly proposed State "28" No. 1 at the unorthodox Eumont location of 1880' FSL and 2180' FEL of Section 28 and also for administrative approval to dedicate the well to a new 120-acre non-standard Eumont proration unit comprised of the W/2 SE/4 and SW/4 NE/4 of Section 28, T-19-S, R-37-E.

Furthermore, if the proposed well is completed as a commercial producer, and in compliance with the Natural Gas Policy of 1978, an application will also be submitted to the New Mexico Oil Conservation Division to obtain administrative approval for the well as a Section 103 well.

As to our application for an unorthodox location, the requested location is necessitated by a combination of the narrow shape of the proposed 120-acre proration unit and the location of existing topographic obstructions. Enclosed is a plat depicting the 120-acre proration unit and existing surface facilities.

Three copies of a plat showing the location of the original well on the proposed 120-acre proration unit plus the location of the proposed new well are also enclosed.

Copies of the enclosed application have also been sent by certified mail to all offsetting parties owning Eumont Gas Rights. The following is a list of the offsetting Eumont Gas owners:

Union Texas Petroleum Corp.
1300 Wilco Building
Midland, Texas 79701
Attention: Don Dow, Regional Land Manager

Arco Oil and Gas Company
P. O. Box 1610
Midland, Texas 79702
Attention: Huan Pham, Area Engineer

Great Western Drilling Company
P. O. Box 1659
Midland, Texas 79702
Attention: R. J. Artley, Chief Engineer

Southland Royalty Company
21 Desta Drive
Midland, Texas 79701
Attention: Kenneth W. Harbin, District Production Manager

Gulf Oil Exploration and Production Company
P. O. Box 1150
Midland, Texas 79702
Attention: D. H. Messer, Land Department

Thank you for your consideration.

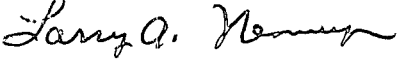
Very truly yours,
Doyle Hartman, Oil Operator

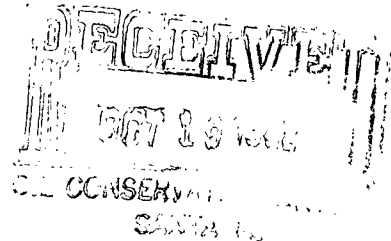
Larry A. Nermyr
Engineer



cc: New Mexico Oil Conservation Division
District I Office
P. O. Box 1980
Hobbs, New Mexico 88240
Attention: Jerry Sexton

William P. Aycock
308 Wall Towers West
Midland, Texas 79702

William F. Carr, Attorney
Campbell, Byrd and Black
P. O. Box 2208
Santa Fe, New Mexico 87501

Heasley J. Rook
P. O. Box 2535
Midland, Texas 79701

Northern Natural Gas Company
2223 Dodge Street
Omaha, Nebraska 68102
Attention: Mr. Dennis Brune

Northern Natural Gas Company
Suite 400, Commercial Bank Building
Midland, Texas 79701
Attention: Harold Barrett

Marathon Oil Company
P. O. Box 552
Midland, Texas 79702
Attention: Jackie Blackham, Land Department

LIST OF OFFSET EUMONT GAS OPERATORS
DOYLE HARTMAN
STATE "28" NO. 1
W/2 SE/4 and SE/4 NE/4
Sec. 28, T-19-S, R-37-E
LEA COUNTY, NEW MEXICO
(120 ACRES)

<u>TRACT</u>	<u>OPERATORS</u>	<u>LEASE AND WELL NAME(S)</u>	<u>GAS WELL LOCATION(S)</u>	<u>UNIT DESCRIPTION</u>	<u>NUMBER OF ACRES</u>
1	UNION TEXAS PETROLEUM	FEDERAL LEASE LC-063964	NO ACTIVE WELL	NW/4 NE/4 Sec. 28 T-19-S, R-37-E	40
2	SOUTHLAND ROYALTY	BURKE LEASE	NO ACTIVE WELL	E/2 E/2 Sec. 28 T-19-S, R-37-E	160
3	ARCO	J. H. WILLIAMS COM. NO. 1 J. H. WILLIAMS COM. NO. 2	E-34-19S-37E F-34-19S-37E	NE/4 NE/4 Sec. 33 and NW/4 and NW/4 NE/4 Sec. 34 T-19-S, R-37-E	240
4	DOYLE HARTMAN	BYROM-WILLIAMS NO. 1	G-33-19S-37E	W/2 NE/4 and SE/4 NE/4 Sec. 33, T-19-S, R-37-E	120
5	GREAT WESTERN DRILLING	N. B. BORDAGES NO. 1	D-33-19S-37E	E/2 NW/4 and NW/4 NW/4 Sec. 33 plus E/2 NE/4 Sec. 32, T-19-S, R-37-E	200
6	GULF	F. W. KUTTER "NCT-D" COM. NO. 4	F-28-19S-37E	W/2 Sec. 28 T-19-S, R-37-E	320

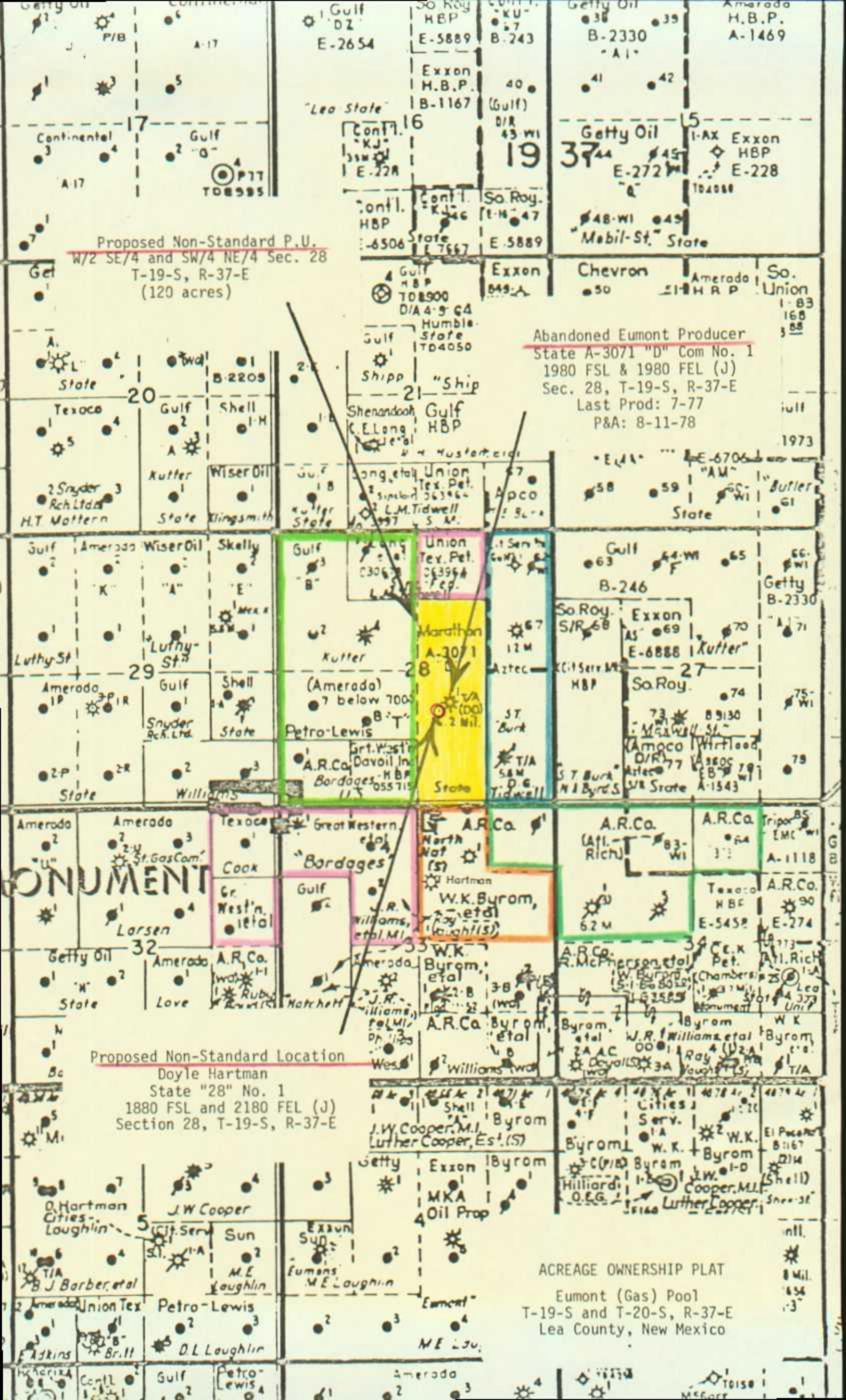

SKETCH OF SURFACE FACILITIES

Doyle Hartman
State "28" No. 1
Sec. 28, T-19-S, R-37-E

Proposed P.U.
W/2 SE/4 & SW/4 NE/4
Sec. 28, T-19-S, R-37-E
(120 acres)

Original Eumont Producer
State A-3071 "D" No. 1
1980 FSL & 1980 FEL (J)
Sec. 28, T-19-S, R-37-E
Last Prod.: 7-77
P&A: 8-11-78

Proposed Location
Doyle Hartman
State "28" No. 1
1880 FSL & 2180 FEL (J)
Sec. 28, T-19-S, R-37-E

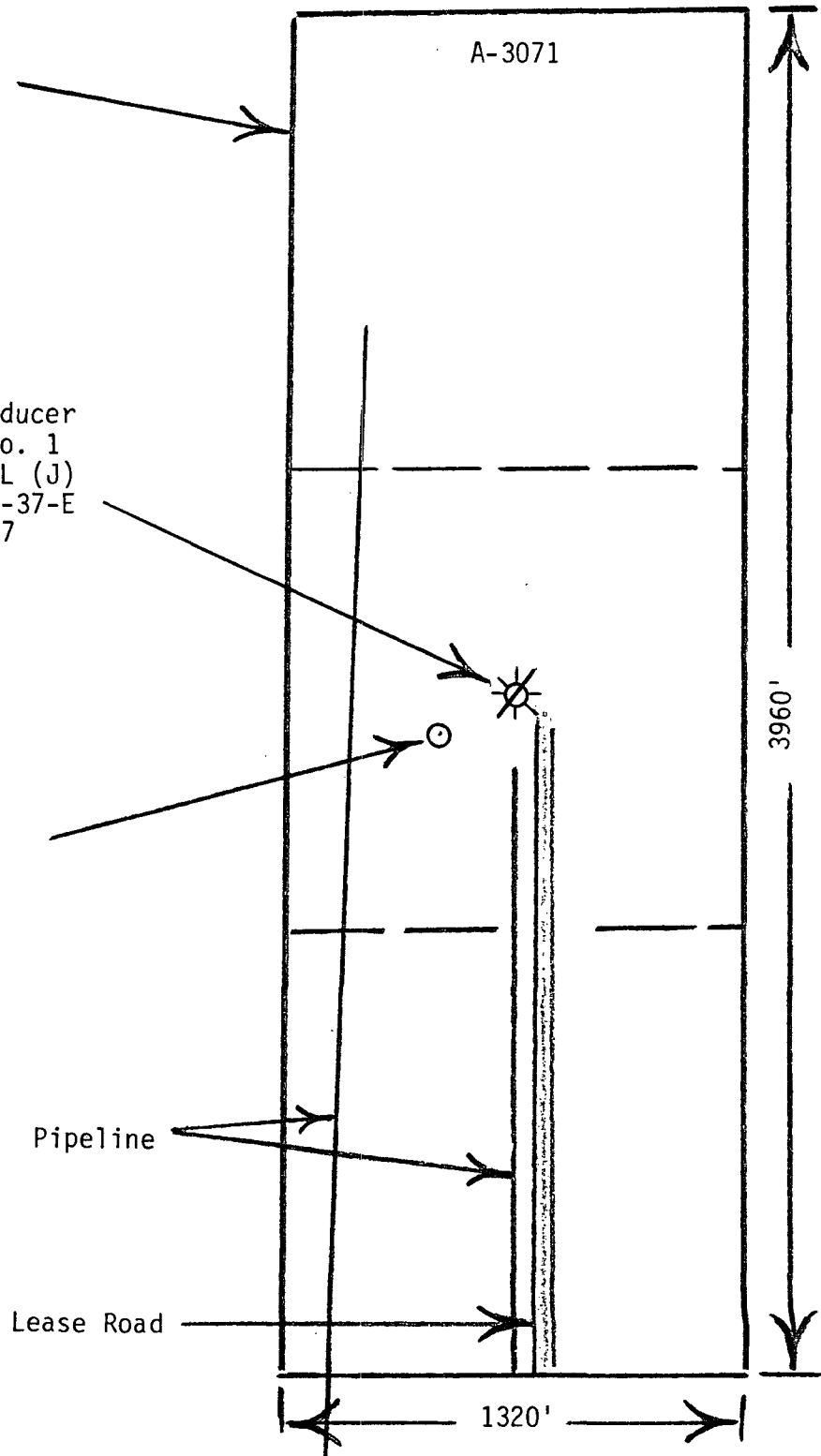

**NEW MEXICO OIL CONSERVATION COMMISSION
WELL LOCATION AND ACREAGE DEDICATION PLAT**

Form C-102
Supersedes C-128
Effective 1-1-65

All distances must be from the outer boundaries of the Section.

Operator Doyle Hartman			Lease State "28"		Well No. 1
Well Letter J	Section 28	Township 19-S	Range 37-E	County Lea	

Actual Footage Location of Well:					
1880	feet from the	South	line and	2180	feet from the
line	East	line	line	line	line
Ground Level Elev. 3578 est.	Producing Formation Queen (Penrose)		Pool Eumont (Gas)		Dedicated Acreage 120

1. Outline the acreage dedicated to the subject well by colored pencil or hachure marks on the plat below.
2. If more than one lease is dedicated to the well, outline each and identify the ownership thereof (both as to working interest and royalty).
3. If more than one lease of different ownership is dedicated to the well, have the interests of all owners been consolidated by communitization, unitization, force-pooling, etc?

☐ Yes ☐ No If answer is "yes," type of consolidation _____

If answer is "no," list the owners and tract descriptions which have actually been consolidated. (Use reverse side of this form if necessary.) _____

No allowable will be assigned to the well until all interests have been consolidated (by communitization, unitization, forced-pooling, or otherwise) or until a non-standard unit, eliminating such interests, has been approved by the Commission.

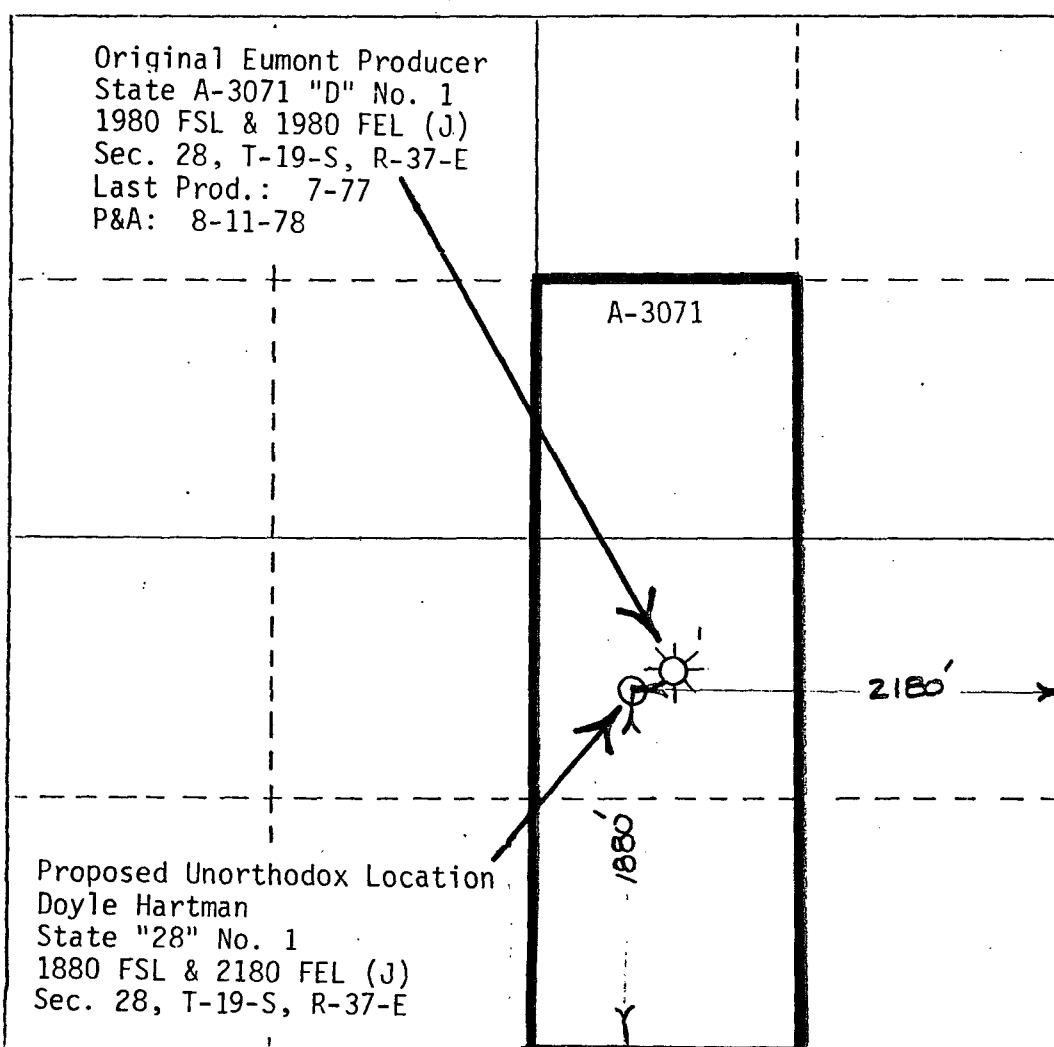

CERTIFICATION
*(see reverse side)

I hereby certify that the information contained herein is true and complete to the best of my knowledge and belief.

Larry G. Henry

Name _____

Position
Engineer

Company
Doyle Hartman

Date
10-14-82

I hereby certify that the well location shown on this plat was plotted from field notes of actual surveys made by me or under my supervision, and that the same is true and correct to the best of my knowledge and belief.

Date Surveyed _____

Registered Professional Engineer and/or Land Surveyor

Certificate No. _____

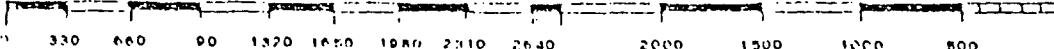

* Note: Requested location currently being surveyed by John West Engineering Company and certified plat will be submitted with C-101.

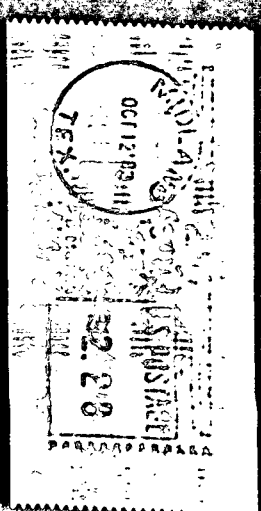

P 265 337 861

RECEIPT FOR CERTIFIED MAIL

NO INSURANCE COVERAGE PROVIDED—
NOT FOR INTERNATIONAL MAIL
(See Reverse)

SENT TO
Union Texas Petroleum Corp.
STREET AND NO.
1300 Wilco Building
P.O. STATE AND ZIP CODE
Midland, Texas 79701

POSTAGE		\$ 88
CERTIFIED FEE		75¢
SPECIAL DELIVERY		¢
RESTRICTED DELIVERY		¢
SHOW TO WHOM AND DATE DELIVERED		60¢
SHOW TO WHOM, DATE, AND ADDRESS OF DELIVERY		¢
SHOW TO WHOM AND DATE DELIVERED WITH RESTRICTED DELIVERY		¢
SHOW TO WHOM, DATE AND ADDRESS OF DELIVERY WITH RESTRICTED DELIVERY		¢
TOTAL POSTAGE AND FEES		\$2.23

CONSULT POSTMASTER FOR FEES

OPTIONAL SERVICES

RETURN RECEIPT SERVICE

POSTMARK OR DATE
10-15-82
Don Dow
State "28" No. 1/ph

CERTIFIED

P 265 337 861

MAIL

TO:
Union Texas Petroleum Corp.
1300 Wilco Building
Midland, Texas 79701

Attention: Mr. Don Dow
Regional Land Manager

DOYLE HARTMAN
P. O. BOX 10426
MIDLAND, TEXAS 79702

PS Form 3800, Apr. 1976

1. THE FOLLOWING SERVICE IS REQUESTED (check one):

☒ Show to whom and date delivered

☐ Show to whom, date, and address of delivery

☐ RESTRICTED DELIVERY
(The restricted delivery fee is charged in addition to the return receipt fee.)

TOTAL \$

2. ARTICLE ADDRESSED TO:
Union Texas Petroleum Corp./Do
1300 Wilco Building
Midland, Texas 79701

3. TYPE OF SERVICE:

<input type="checkbox"/> REGISTERED	<input type="checkbox"/> INSURED	ARTICLE NUMBER P265337861
<input type="checkbox"/> CERTIFIED	<input type="checkbox"/> COO	
<input type="checkbox"/> EXPRESS MAIL		

(Always obtain signature of addressee or agent)

I have received the article described above.

SIGNATURE ☐ Addressee ☐ Authorized agent

4. DATE OF DELIVERY	POSTAL
5. ADDRESSEE'S ADDRESS (Only if requested)	
7. UNABLE TO DELIVER BECAUSE:	7a. EMPLOYEE'S INITIALS

State "28" No. 1/ph

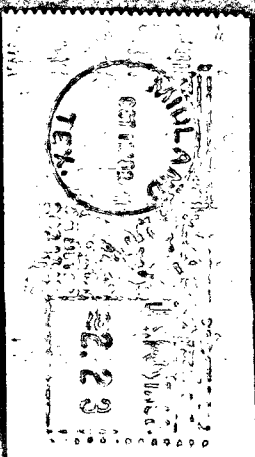

PS Form 3800, Apr. 1976

● **SENDER:** Complete items 1, 2, 3, and 4. Add your address in the "RETURN TO" on reverse.

(CONSULT POSTMASTER FOR FEES)

1. The following service is requested (check one):

☒ Show to whom and date delivered

☐ Show to whom, date, and address of delivery

2. ☐ **RESTRICTED DELIVERY**
(The restricted delivery fee is charged in addition to the return receipt fee.)

TOTAL

3. **ARTICLE ADDRESSED TO:**

Arco Oil and Gas Company/Huan
Post Office Box 1610
Midland, Texas 79702

4. **TYPE OF SERVICE:**

☐ REGISTERED ☐ INSURED

☒ CERTIFIED ☐ COD

☐ EXPRESS MAIL

(Always obtain signature of addressee or agent)

I have received the article described above.

SIGNATURE ☐ Addressee ☐ Authorized

5. **DATE OF DELIVERY**

POST

6. **ADDRESSEE'S ADDRESS (Only if requested)**

7. **UNABLE TO DELIVER REASON:**

7a. **EMPLOYEE INITIALS**

State "28" No. 1/Ph

PS Form 3800, Apr. 1976

P 265 337 862

RECEIPT FOR CERTIFIED MAIL

NO INSURANCE COVERAGE PROVIDED—
NOT FOR INTERNATIONAL MAIL
(See Reverse)

SENT TO

Arco Oil and Gas Company

STREET AND NO.

Post Office Box 1610

P.O. STATE AND ZIP CODE

Midland, Texas 79702

POSTAGE

\$ 88

CERTIFIED FEE

75 ¢

SPECIAL DELIVERY

RESTRICTED DELIVERY

SHOW TO WHOM AND DATE DELIVERED

DATE DELIVERED

60 ¢

SHOW TO WHOM, DATE, AND ADDRESS OF DELIVERY

DELIVERY

SHOW TO WHOM AND DATE DELIVERED WITH RESTRICTED DELIVERY

ADDRESS OF DELIVERY WITH RESTRICTED DELIVERY

SHOW TO WHOM, DATE AND ADDRESS OF DELIVERY WITH RESTRICTED DELIVERY

RESTRICTED DELIVERY

RESTRICTED DELIVERY

\$ 223

TOTAL POSTAGE AND FEES

POSTMARK OR DATE

10-15-82

Huan Pham

State "28" No. 1/ph

CERTIFIED

P 265 337 862

MAIL

DOYLE HARTMAN
P. O. BOX 10426
MIDLAND, TEXAS 79702

TO:

Arco Oil and Gas Company
Post Office Box 1610
Midland, Texas 79702

Attention: Mr. Haun Pham
Area Engineer

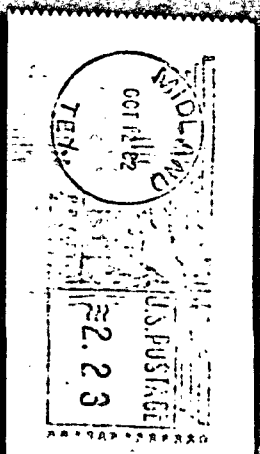

P 265 337 863

RECEIPT FOR CERTIFIED MAIL

NO INSURANCE COVERAGE PROVIDED—
NOT FOR INTERNATIONAL MAIL

(See Reverse)

SENT TO
Great Western Drilling Co.
STREET AND NO.
Post Office Box 1659
P.O. STATE AND ZIP CODE
Midland, Texas 79702

POSTAGE	\$ 88
CERTIFIED FEE	75 ¢
SPECIAL DELIVERY	¢
RESTRICTED DELIVERY	¢
SHOW TO WHOM AND DATE DELIVERED	60 ¢
SHOW TO WHOM, DATE, AND ADDRESS OF DELIVERY	¢
SHOW TO WHOM AND DATE DELIVERED WITH RESTRICTED DELIVERY	¢
SHOW TO WHOM, DATE AND ADDRESS OF DELIVERY WITH RESTRICTED DELIVERY	¢
TOTAL POSTAGE AND FEES	\$ 223

CONSULT POSTMASTER FOR FEES

OPTIONAL SERVICES

RETURN RECEIPT SERVICE

POSTMARK OR DATE
10-15-82
R. J. Artley
State "28" No. 1/ph

P 265 337 863

CERTIFIED

MAIL

DOYLE HARTMAN
P. O. BOX 10426
MIDLAND, TEXAS 79702

TO:
Great Western Drilling Company
Post Office Box 1659
Midland, Texas 79702

Attention: Mr. R. J. Artley
Chief Engineer

SENDER: Complete items 1, 2, 3, and 4.
Add your address in the "RETURN TO" space on reverse.

(CONSULT POSTMASTER FOR FEES)

1. The following service is requested (check one). 60 ¢
☒ Show to whom and date delivered
☐ Show to whom, date, and address of delivery - ¢
2. RESTRICTED DELIVERY ¢
(The restricted delivery fee is charged in addition to the return receipt fee.)

TOTAL \$ 60

3. ARTICLE ADDRESSED TO:
Great Western Drilling Company/Article
Post Office Box 1659
Midland, Texas 79702

4. TYPE OF SERVICE:	ARTICLE NUMBER
<input type="checkbox"/> REGISTERED <input type="checkbox"/> INSURED	P 265337863
<input checked="" type="checkbox"/> CERTIFIED <input type="checkbox"/> COD	
<input type="checkbox"/> EXPRESS MAIL	

(Always obtain signature of addressee or agent)

I have received the article described above.

SIGNATURE ☐ Addressee ☐ Authorized agent

5. DATE OF DELIVERY POSTMARK

6. ADDRESSEE'S ADDRESS (Only if requested)

7. UNABLE TO DELIVER BECAUSE: 7c. EMPLOYER'S INITIALS

State "28" No. 1/ph

RETURN RECEIPT, REGISTERED, INSURED AND CERTIFIED MAIL

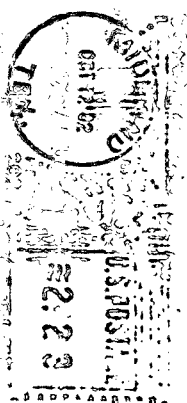

P 265 337 864

RECEIPT FOR CERTIFIED MAIL

NO INSURANCE COVERAGE PROVIDED—
NOT FOR INTERNATIONAL MAIL
(See Reverse)

SENT TO	Southland Royalty Company
STREET AND NO.	21 Desta Drive
P.O., STATE AND ZIP CODE	Midland, Texas 79701
POSTAGE	\$ 88

CONSULT POSTMASTER FOR FEES	
CERTIFIED FEE	75 ¢
SPECIAL DELIVERY	¢
RESTRICTED DELIVERY	¢
SHOW TO WHOM AND DATE DELIVERED	60 ¢
SHOW TO WHOM, DATE, AND ADDRESS OF DELIVERY	¢
SHOW TO WHOM AND DATE DELIVERED WITH RESTRICTED DELIVERY	¢
SHOW TO WHOM, DATE AND ADDRESS OF DELIVERY WITH RESTRICTED DELIVERY	¢
TOTAL POSTAGE AND FEES	\$2.23

POSTMARK OR DATE	10-15-82
Kenneth W. Harbin	
State "28" No. 1/ph	

PS Form 3800, Apr. 1976

CERTIFIED

P 265 337 864

MAIL

DOYLE HARTMAN
P. O. BOX 10426
MIDLAND, TEXAS 79702

TO: Southland Royalty Company
21 Desta Drive
Midland, Texas 79701

Attention: Mr. Kenneth W. Harbin
District Production Manager

1. ARTICLE ADDRESSED TO:
Southland Royalty Company/Harbin
21 Desta Drive
Midland, Texas 79701

2. TYPE OF SERVICE:
☐ REGISTERED ☐ INSURED
☒ CERTIFIED ☐ COD P 265337864
☐ EXPRESS MAIL

3. ARTICLE NUMBER

4. DATE OF DELIVERY

5. ADDRESSEE'S ADDRESS (Only if required)

6. UNABLE TO DELIVER REASON

7. EMPLOYER'S INITIALS

State "28" No. 1/ph

NOV 12 1976
TEXAS
22.23

P 265 337 865
RECEIPT FOR CERTIFIED MAIL

NO INSURANCE COVERAGE PROVIDED—
NOT FOR INTERNATIONAL MAIL
(See Reverse)

SENT TO
Gulf Oil Exploration
STREET AND NO.
Post Office Box 1150
P.O. STATE AND ZIP CODE
Midland, Texas 79702

POSTAGE		\$ 88
CERTIFIED FEE		75¢
OPTIONAL SERVICES		
RETURN RECEIPT SERVICE		
SHOW TO WHOM AND DATE DELIVERED		60¢
SHOW TO WHOM, DATE, AND ADDRESS OF DELIVERY		¢
SHOW TO WHOM, DATE AND ADDRESS OF DELIVERY WITH RESTRICTED DELIVERY		¢
SHOW TO WHOM, DATE AND ADDRESS OF DELIVERY WITH RESTRICTED DELIVERY		¢
TOTAL POSTAGE AND FEES		\$ 2.23

POSTMARK OR DATE
10-15-82
D. H. Messer
State "28" No. 1/ph

CERTIFIED

P 265 337 865

MAIL

TO:

Gulf Oil Exploration and Production
Company
Post Office Box 1150
Midland, Texas 79702
Attention: Mr. D. H. Messer
Land Department

DOYLE HARTMAN
P. O. BOX 10426
MIDLAND, TEXAS 79702

PS Form 3811, Dec. 1980

● **SENDER:** Complete items 1, 2, 3, and 4.
Add your address in the "RETURN TO" space on reverse.

(CONSULT POSTMASTER FOR FEES)

1. The following service is requested (check one).
☒ Show to whom and date delivered 60¢
☐ Show to whom, date, and address of delivery ..
☐ **RESTRICTED DELIVERY**
(The restricted delivery fee is charged in addition to the return receipt fee.)

TOTAL \$ 60

2. **ARTICLE ADDRESSED TO:**
Gulf Oil Exploration & Production
Post Office Box 1150
Midland, Texas 79702

3. **TYPE OF SERVICE:**
☐ REGISTERED ☐ INSURED
☒ CERTIFIED ☐ COO P 265337865
☐ EXPRESS MAIL

(Always obtain signature of addressee or agent)
SIGNATURE ☐ Addressee ☐ Authorized agent

I have received the article described above.

4. **DATE OF DELIVERY** POSTMARK

5. **ADDRESSEE'S ADDRESS (Only if requested)**

7. **UNABLE TO DELIVER REASON:** 7a. **EMPLOYEE'S INITIALS**

State "28" No. 1/ph

DOYLE HARTMAN

Oil Operator

500 N. MAIN

P. O. BOX 10426

MIDLAND, TEXAS 79702

(915) 684-4011

June 22, 1983

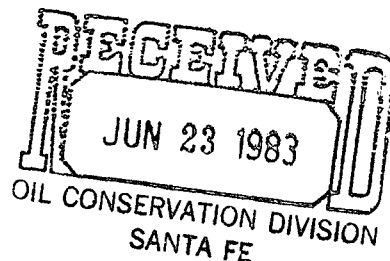

Mr. R. L. Stamets
State of New Mexico
Energy and Minerals Department
Oil Conservation Division
Post Office Box 2088
Santa Fe, New Mexico 87501

Re: Revised Eumont Location
State "28" No. 1
W/2 SE/4 & SW/4 NE/4
Section 28, T-19-S, R-37-E
Lea County, New Mexico

Gentlemen:

Please find enclosed a copy of our letter to the New Mexico Oil Conservation Division dated October 15, 1982, requesting a non-standard Eumont proration unit and unorthodox Eumont location for Doyle Hartman's proposed State "28" No. 1, and a copy of the NMOCD's Administrative Order NSP-1336 (L) dated November 1, 1982, approving both the proposed 120-acre non-standard Eumont (Gas) proration unit consisting of W/2 SE/4 and SW/4 NE/4 Section 28, and the requested non-standard Eumont location of 1880 feet from the South line and 2180 feet from the East line of Section 28, T-19-S, R-37-E, Lea County, New Mexico.

After recently having an opportunity to review Marathon's internal well file pertaining to its now plugged and abandoned State A-3071-D No. 1 Eumont gas well located 1980 FSL & 1980 FEL Section 28 (the original Eumont [Gas] producer on this proration unit), it was discovered that Marathon had encountered a major water flow (with a 1400-psi surface pressure) from the Upper Eumont interval at the time a workover was performed on the State A-3071-D No. 1 well in 1977 and because of the water flow, the well was subsequently plugged and abandoned in August of 1978.

In view of the extreme likelihood that the originally proposed twin location of 1880 FSL & 2180 FEL for our State "28" No. 1 would encounter the same water flow Marathon found in its State A-3071-D No. 1, and because of various surface obstructions situated on our 120-acre Eumont proration unit, including a Northern Natural Gas Company high pressure pipeline that runs north and south down the middle of the lease, it is necessary that we move the proposed location for our State "28" No. 1 due south a distance of 1,220' to a new unorthodox location consisting of 660 FSL and 2180 FEL Section 28, T-19-S, R-37-E, Lea County, New Mexico. We are enclosing an amended C-102 showing both the amended location and the existing surface obstructions situated on the lease.

New Mexico Oil Conservation Division
June 22, 1983
Page 2

Although we are forwarding a copy of this letter by certified mail to all offsetting operators owning Eumont gas rights surrounding our proration unit in order to inform them of the necessary location change, it should be noted that our new location of 660 FSL and 2180 FEL Section 28 will not fall any closer to the closest offsetting lease line than the unorthodox location of 1880 FSL and 2180 FEL Section 28 which was originally approved by NSP-1336(L). We are also at this time filing a C-103 to amend our pipe program so that we might have greater drilling control in the event the same high pressure water flow is encountered in our State "28" No. 1.

Please let us know if we can answer any further questions in this regard.

Very truly yours,

DOYLE HARTMAN

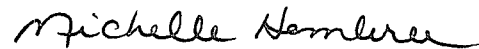

Michelle Hembree
Administrative Assistant

/mh

Enclosures

cc: Union Texas Petroleum Corporation
1300 Wilco Building
Midland, Texas 79701

Attention: Knox E. Davis
Division Operations Manager

ARCo Oil and Gas Company
Post Office Box 1610
Midland, Texas 79702

Attention: Mr. Craig Payken
Area Engineer

Great Western Drilling Company
Post Office Box 1659
Midland, Texas 79702

Attention: B. C. Mahany
General Superintendent

Southland Royalty Company
21 Desta Drive
Midland, Texas 79701

Attention: Mr. Kenneth W. Harbin
District Production Manager

New Mexico Oil Conservation Division
June 22, 1983
Page 3

Gulf Oil Exploration and Production Company
Post Office Box 1150
Midland, Texas 79702

Attention: Mr. Charles F. Kalteyer

New Mexico Oil Conservation Division
District I Office
Post Office Box 1980
Hobbs, New Mexico 88240

Attention: Mr. Jerry Sexton

Northern Natural Gas Company
2223 Dodge Street
Omaha, Nebraska 68102

Attention: Mr. Dennis Brune

Northern Natural Gas Company
Commercial Bank Building
Suite 400
Midland, Texas 79701

Attention: Mr. G. R. Feiner
Well Connect Coordinator

Marathon Oil Company
Post Office Box 552
Midland, Texas 79702

Attention: Mr. R. P. Scott

Mr. William F. Carr
Campbell, Byrd and Black, P.A.
Post Office Box 2208
Santa Fe, New Mexico 87501

Mr. William P. Aycock
308 Wall Towers West
Midland, Texas 79701

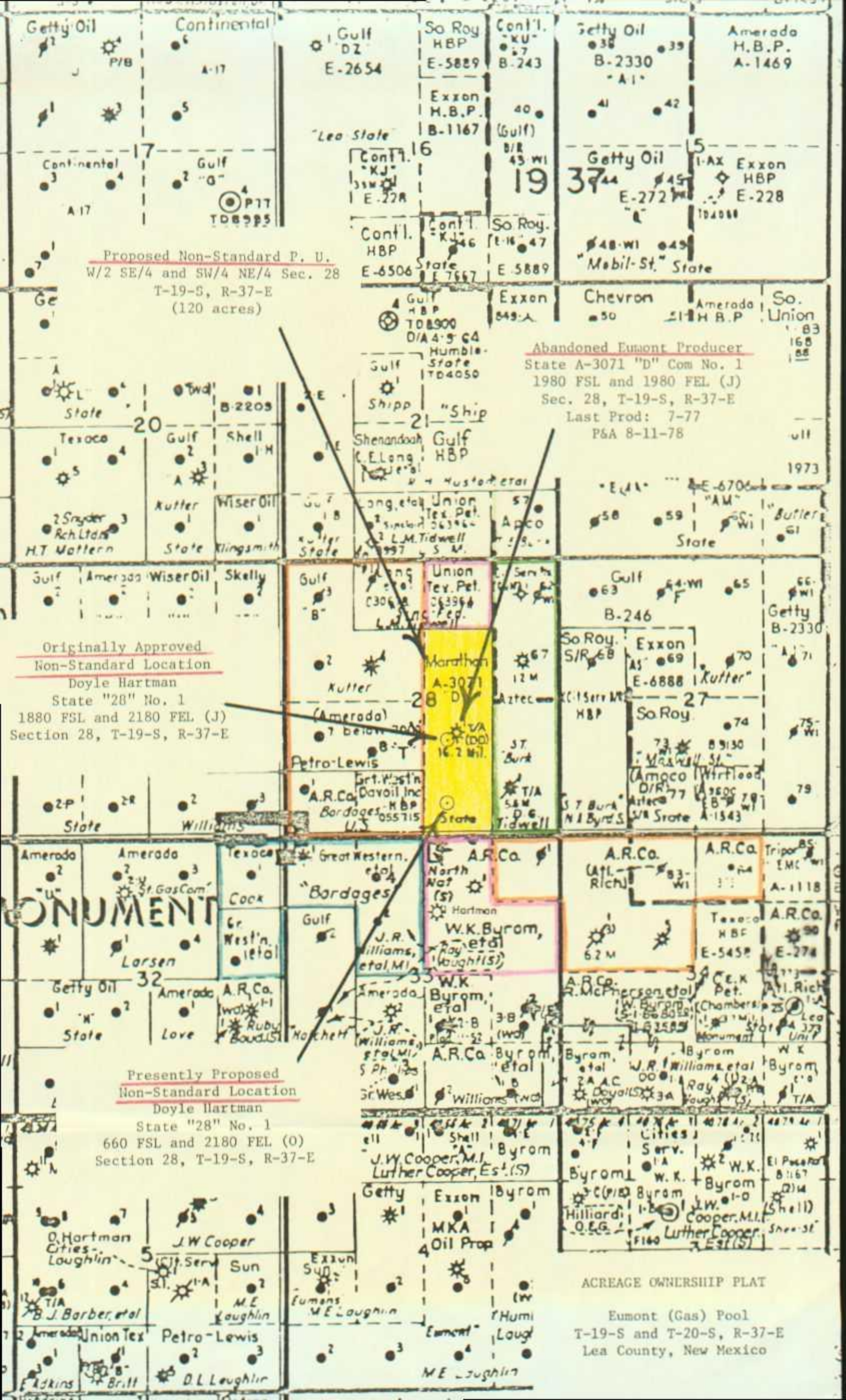

LIST OF OFFSET EUMONT GAS OPERATORS
DOYLE HARTMAN
STATE "28" NO. 1
W/2 SE/4 and SE/4 NE/4
Sec. 28, T-19-S, R-37-E
LEA COUNTY, NEW MEXICO
(120 ACRES)

<u>TRACT</u>	<u>OPERATORS</u>	<u>LEASE AND WELL NAME(S)</u>	<u>GAS WELL LOCATION(S)</u>	<u>UNIT DESCRIPTION</u>	<u>NUMBER OF ACRES</u>
1	UNION TEXAS PETROLEUM	FEDERAL LEASE LC-063964	NO ACTIVE WELL	NW/4 NE/4 Sec. 28 T-19-S, R-37-E	40
2	SOUTHLAND ROYALTY	BURKE LEASE	NO ACTIVE WELL	E/2 E/2 Sec. 28 T-19-S, R-37-E	160
3	ARCO	J. H. WILLIAMS COM. NO. 1 J. H. WILLIAMS COM. NO. 2	E-34-19S-37E F-34-19S-37E	NE/4 NE/4 Sec. 33 and NW/4 and NW/4 NE/4 Sec. 34 T-19-S, R-37-E	240
4	DOYLE HARTMAN	BYROM-WILLIAMS NO. 1	G-33-19S-37E	W/2 NE/4 and SE/4 NE/4 Sec. 33, T-19-S, R-37-E	120
5	GREAT WESTERN DRILLING	N. B. BORDAGES NO. 1	D-33-19S-37E	E/2 NW/4 and NW/4 NW/4 Sec. 33 plus E/2 NE/4 Sec. 32, T-19-S, R-37-E	200
6	GULF	F. W. KUTTER "NCT-D" COM. NO. 4	F-28-19S-37E	W/2 Sec. 28 T-19-S, R-37-E	320

SKETCH OF SURFACE FACILITIES

Doyle Hartman
State "28" No. 1
Sec. 28, T-19-S, R-37-E

Proposed P.U.
W/2 SE/4 & SW/4 NE/4
Sec. 28, T-19-S, R-37-E
(120 acres)

Original Eumont Producer
State A-3071 "D" No. 1
1980 FSL & 1980 FEL (J)
Sec. 28, T-19-S, R-37-E
Last Prod.: 7-77
P&A: 8-11-78

Originally Approved
Non-Standard Location
Doyle Hartman
State "28" No. 1
1880 FSL and 2180 FEL (J)
Section 28, T-19-S, R-37-E

Presently Proposed
Non-Standard Location
Doyle Hartman
State "28" No. 1
660 FSL and 2180 FEL (O)
Section 28, T-19-S, R-37-E

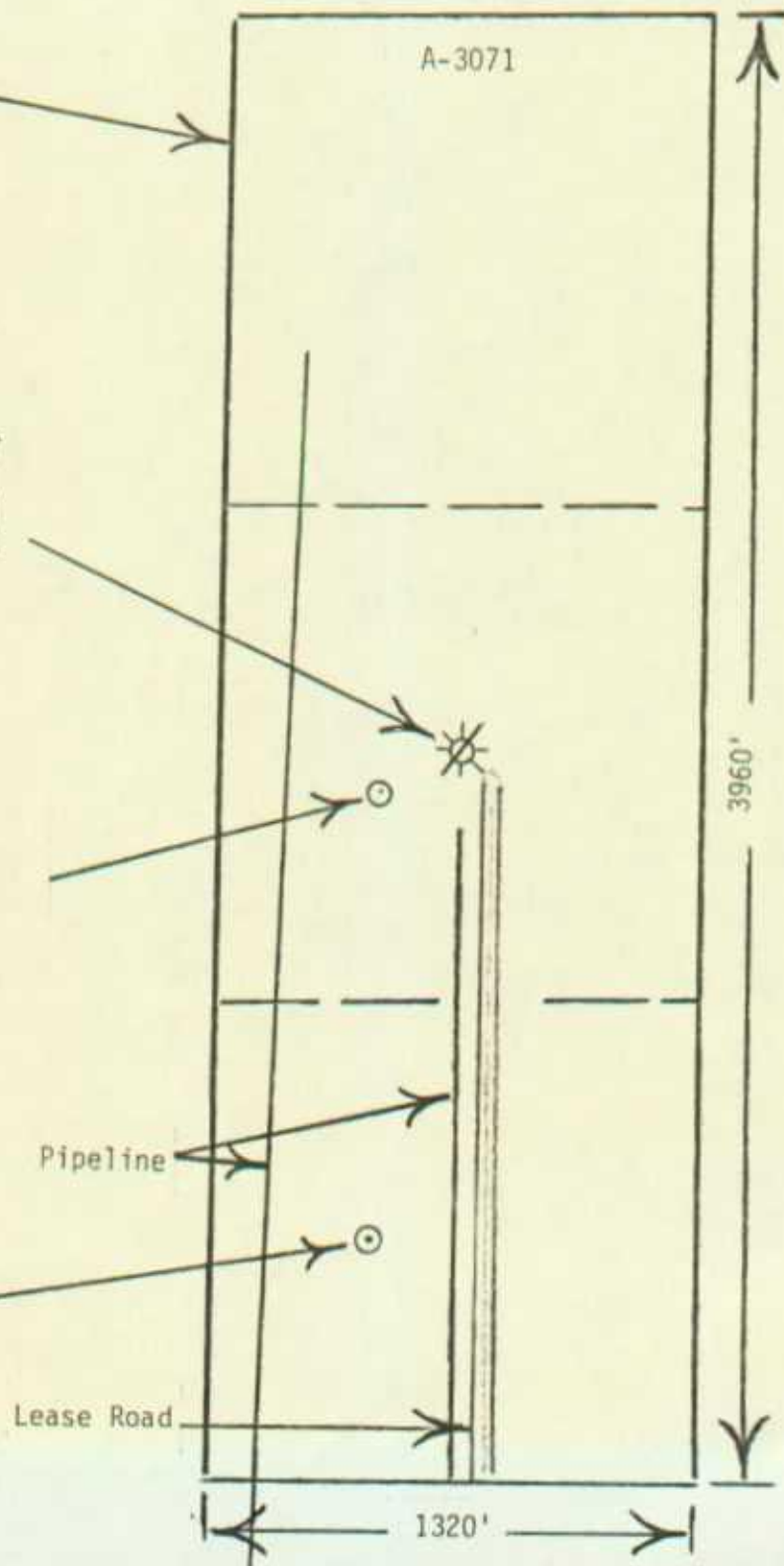

**NEW MEXICO OIL CONSERVATION COMMISSION
WELL LOCATION AND ACREAGE DEDICATION PLAT**

Form C-102
Supersedes C-128
Effective 1-1-65

All distances must be from the outer boundaries of the Section.

Operator Doyle Hartman			Lease State 28		Well No. #1
Unit Letter 0	Section 28	Township 19 South	Range 37 East	County Lea	
Actual Footage Location of Well: 660 feet from the South line and 2180 feet from the East line					
Ground Level Elev. 3579.5	Producing Formation Queen (Penrose)		Pool Eumont (Gas)	Dedicated Acreage: 120 Acres	

1. Outline the acreage dedicated to the subject well by colored pencil or hachure marks on the plat below.
2. If more than one lease is dedicated to the well, outline each and identify the ownership thereof (both as to working interest and royalty).
3. If more than one lease of different ownership is dedicated to the well, have the interests of all owners been consolidated by communitization, unitization, force-pooling, etc?

☐ Yes ☐ No If answer is "yes," type of consolidation _____

If answer is "no," list the owners and tract descriptions which have actually been consolidated. (Use reverse side of this form if necessary.) _____

No allowable will be assigned to the well until all interests have been consolidated (by communitization, unitization, forced-pooling, or otherwise) or until a non-standard unit, eliminating such interests, has been approved by the Commission.

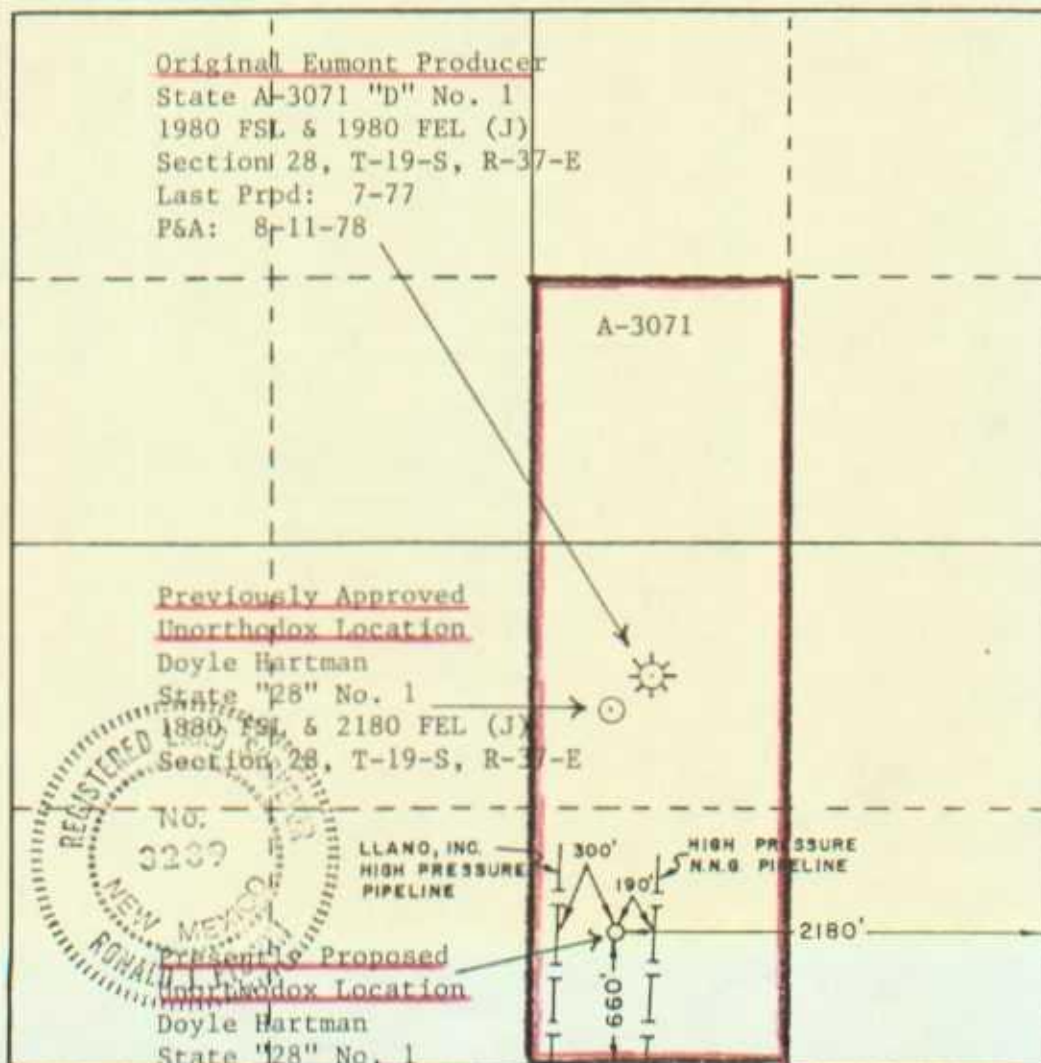

CERTIFICATION

I hereby certify that the information contained herein is true and complete to the best of my knowledge and belief.

Name
Larry Nermyr
Position
Engineer
Company
Doyle Hartman
Date
June 22, 1983

I hereby certify that the well location shown on this plat was plotted from field notes of actual surveys made by me or under my supervision, and that the same is true and correct to the best of my knowledge and belief.

Date Surveyed
June 17, 1983
Registered Professional Engineer and/or Land Surveyor

Ronald J. Eidson
Certificate No. JOHN W. WEST 678
PATRICK A. ROMERO 6663
Ronald J. Eidson 3239

DOYLE HARTMAN

Oil Operator

P. O. BOX 10426

MIDLAND, TEXAS 79702

Great Western Drilling Company

Post Office Box 1659

Midland, Texas 79702

Attention: B. C. Mahany

General Superintendent

P 265 337 990

RECEIPT FOR CERTIFIED MAIL

NO INSURANCE COVERAGE PROVIDED—
NOT FOR INTERNATIONAL MAIL

(See Reverse)

SENT TO		Great Western Drilling	
STREET AND NO.		P.O. Box 1659	
P.O. STATE AND ZIP CODE		Midland, TX 79702	
POSTAGE		\$ 88	
CERTIFIED FEE		75	
SPECIAL DELIVERY			
RESTRICTED DELIVERY			
SHOW TO WHOM AND DATE DELIVERED		60	
SHOW TO WHOM, DATE AND ADDRESS OF DELIVERY			
SHOW TO WHOM AND DATE DELIVERED WITH RESTRICTED DELIVERY			
SHOW TO WHOM, DATE AND ADDRESS OF DELIVERY WITH RESTRICTED DELIVERY			
RETURN RECEIPT SERVICE			
OPTIONAL SERVICES			
CONSULT POSTMASTER FOR FEES			
TOTAL POSTAGE AND FEES		\$ 2.23	
POSTMARK OR DATE		6-22-83	
NSL State "28" #1/mn			

PS Form 3800, Apr. 1976

CERTIFIED

P 265 337 990

MAIL

PS Form 3811, Dec. 1980

- **SENDER:** Complete items 1, 2, 3, and 4.
Add your address in the "RETURN TO" space
on reverse.

(CONSULT POSTMASTER FOR FEES)

1. The following service is requested (check one).
- ☒ Show to whom and date delivered **60¢**
- ☐ Show to whom, date, and address of delivery .. **—¢**
2. ☐ **RESTRICTED DELIVERY**
(The restricted delivery fee is charged in addition to
the return receipt fee.) **—¢**

TOTAL \$ 60

3. **ARTICLE ADDRESSED TO:**
Great Western Drilling
P.O. Box 1659
Midland, Tx 79702

4. **TYPE OF SERVICE:**
- ☐ REGISTERED ☐ INSURED
- ☒ CERTIFIED ☐ COD
- ☐ EXPRESS MAIL

ARTICLE NUMBER
P 265 337 990

(Always obtain signature of addressee or agent)

I have received the article described above.

SIGNATURE ☐ Addressee ☐ Authorized agent

5. **DATE OF DELIVERY**

POSTMARK

6. **ADDRESSEE'S ADDRESS (Only if requested)**

7. **UNABLE TO DELIVER BECAUSE:**

7a. **EMPLOYEE'S
INITIALS**

NSL State "28" #1 / MH

1. If you want this receipt for
the return receipt fee, please
hand it to your rural carrier
or post office. If you want this re-
ceipt for the return receipt fee,
please hand it to the carrier.
2. If you want a return receipt,
please check the "RETURN RECEIPT"
period. Otherwise, check
adjacent to the number.
3. If you want delivery restricted
to the addressee only, check
"RESTRICTED DELIVERY".
4. Check the box for the service
desired. If you want a return
receipt, check the box for the
return receipt fee.

RETURN RECEIPT, REGISTERED, INSURED AND CERTIFIED MAIL

(CONSULT POSTMASTER FOR FEES)

- TOTAL \$ 60**

ARTICLE ADDRESSED TO:
Gulf Oil
P.O. Box 1150
Midland, Tx 79702

☐ REGISTERED ☐ INSURED
☒ CERTIFIED ☐ COD
☐ EXPRESS MAIL

P 265 337 912

(Always obtain signature of addressee or agent)

SIGNATURE ☒ Addressee ☐ Authorized agent

POSTMARK

8. ADDRESSEE'S ADDRESS (Only if requested)

7. UNABLE TO DELIVER BECAUSE:

7a. EMPLOYEE'S INITIALS

NSL State "28" #1 / KMH

1. If you want this receipt for the activity, insert it in the hand it to your rural carrier.
2. If you do not want this receipt on the article, date it.
3. If you want a return receipt, attach it to the receipt, insert it in the hand it to your rural carrier.
4. If you do not want a return receipt, insert it in the hand it to your rural carrier.
5. If you want the receipt for the activity, insert it in the hand it to your rural carrier.
6. If you want the receipt for the activity, insert it in the hand it to your rural carrier.

P 265 337 992

RECEIPT FOR CERTIFIED MAIL

NO INSURANCE COVERAGE PROVIDED—
NOT FOR INTERNATIONAL MAIL

(See Reverse)

DOYLE HARTMAN
Oil Operator
P. O. BOX 10426
MIDLAND, TEXAS 79702

Gulf Oil Exploration and Production Company
Post Office Box 1150
Midland, Texas 79702

Attention: Mr. Charles F. Kalteyer

PS Form 3800, Apr. 1976

SENT TO		Gulf Oil	
STREET AND NO.		P.O. Box 1150	
P.O. STATE AND ZIP CODE		Midland Tx 79702	
POSTAGE		\$	
CERTIFIED FEE		75	
SPECIAL DELIVERY			
RESTRICTED DELIVERY			
RETURN RECEIPT SERVICE			
SHOW TO WHOM AND DATE DELIVERED		60	
AND ADDRESS OF DELIVERY			
SHOW TO WHOM AND DATE DELIVERED WITH RESTRICTED DELIVERY			
SHOW TO WHOM, DATE AND ADDRESS OF DELIVERY WITH RESTRICTED DELIVERY			
TOTAL POSTAGE AND FEES		\$	
POSTMARK OR DATE		6-22-83	

NSL State "28" #1/Km

CERTIFIED

P 265 337 992

MAIL

P 265 337 991

RECEIPT FOR CERTIFIED MAIL

NO INSURANCE COVERAGE PROVIDED—
NOT FOR INTERNATIONAL MAIL

(See Reverse)

SENT TO	
Southland Royalty	
STREET AND NO.	
21 Dasta Drive	
P.O., STATE AND ZIP CODE	
Midland, TX 79701	
POSTAGE	\$ 88
CERTIFIED FEE	75
CONSULT POSTMASTER FOR FEES	
OPTIONAL SERVICES	
RETURN RECEIPT SERVICE	
SPECIAL DELIVERY	
RESTRICTED DELIVERY	
SHOW TO WHOM AND DATE DELIVERED	60
SHOW TO WHOM, DATE, AND ADDRESS OF DELIVERY	
SHOW TO WHOM AND DATE DELIVERED WITH RESTRICTED DELIVERY	
SHOW TO WHOM, DATE AND ADDRESS OF DELIVERY WITH RESTRICTED DELIVERY	
TOTAL POSTAGE AND FEES	\$ 2.22
POSTMARK OR DATE	
6-22-83	
NSL State "28" #1/Km	
CERTIFIED	
P 265 337 991	
MAIL	

PS Form 3800, Apr. 1976

DOYLE HARTMAN
On Operator
P. O. BOX 10426
MIDLAND, TEXAS 79702

Southland Royalty Company
21 Dasta Drive
Midland, Texas 79701

Attention: Mr. Kenneth W. Harbin
District Production Manager

PS Form 3811, Dec. 1980

RETURN RECEIPT, REGISTERED, INSURED AND CERTIFIED MAIL

● **SENDER:** Complete items 1, 2, 3, and 4.
Add your address in the "RETURN TO" space
on reverse.

(CONSULT POSTMASTER FOR FEES)

1. The following service is requested (check one).

- ☒ Show to whom and date delivered 60¢
☐ Show to whom, date, and address of delivery.. —¢

2. ☐ **RESTRICTED DELIVERY** —¢

(The restricted delivery fee is charged in addition to
the return receipt fee.)

TOTAL \$ 60

3. **ARTICLE ADDRESSED TO:**

Southland Royalty
21 Desta Drive
Midland, Tx 79701

4. **TYPE OF SERVICE:**

- ☐ REGISTERED ☐ INSURED
☒ CERTIFIED ☐ COD
☐ EXPRESS MAIL

ARTICLE NUMBER

P 265 337 991

(Always obtain signature of addressee or agent)

I have received the article described above.

SIGNATURE ☐ Addressee ☐ Authorized agent

5. **DATE OF DELIVERY**

POSTMARK

6. **ADDRESSEE'S ADDRESS** (Only if requested)

7. **UNABLE TO DELIVER BECAUSE:**

7a. **EMPLOYEE'S
INITIALS**

NSL State "28" #1 / KMH

1. If you want this receipt po-
the article, leaving the re-
hand it to your rural carrier.
2. If you do not want this receipt
side of the article, date, or
3. If you want a return receipt
receipt and return receipt
4. If you want a return receipt
5. If you want a return receipt
6. If you want a return receipt
7. If you want a return receipt
8. If you want a return receipt
9. If you want a return receipt

PS Form 3811, Dec. 1980

RETURN RECEIPT, REGISTERED, INSURED AND CERTIFIED MAIL

● **SENDER:** Complete items 1, 2, 3, and 4.
Add your address in the "RETURN TO" space
on reverse.

(CONSULT POSTMASTER FOR FEES)

1. The following service is requested (check one).

☒ Show to whom and date delivered 60¢

☐ Show to whom, date, and address of delivery .. —¢

2. ☐ **RESTRICTED DELIVERY**
(The restricted delivery fee is charged in addition to
the return receipt fee.)

TOTAL \$ 0.60

3. **ARTICLE ADDRESSED TO:**

Union Texas Petroleum
1300 Wilco Building
Midland, Texas 79701

4. **TYPE OF SERVICE:**

☐ REGISTERED ☐ INSURED
☒ CERTIFIED ☐ COD
☐ EXPRESS MAIL

ARTICLE NUMBER
P 265 337 988

(Always obtain signature of addressee or agent)

I have received the article described above.

SIGNATURE ☐ Addressee ☐ Authorized agent

5. **DATE OF DELIVERY**

POSTMARK

6. **ADDRESSEE'S ADDRESS** (Only if requested)

7. **UNABLE TO DELIVER BECAUSE:**

7a. **EMPLOYEE'S
INITIALS**

NSL-State 28 #1/mh

1. If you want this receipt post-
marked, attach this receipt
and mail it in the return
envelope to your carrier.
2. If you do not want this receipt
side of the article, detach the
receipt and return it to the
post office. (Form 3811, at
post offices.) Otherwise, affix to
the return envelope.
3. If you want delivery restricted
to a certain address, check the
"RESTRICTED DELIVERY" box.
4. Enter fees for the services re-
quested in the "FEES" box.
5. If this receipt and piece

P 265 337 988

RECEIPT FOR CERTIFIED MAIL

NO INSURANCE COVERAGE PROVIDED —
NOT FOR INTERNATIONAL MAIL

(See Reverse)

PS Form 3800, Apr. 1976

SENT TO		Union Texas Petroleum
STREET AND NO.		1300 Wilco Building
P.O., STATE AND ZIP CODE		Midland, TX 79701
POSTAGE		\$ 82 75 ¢
CERTIFIED FEE		75 ¢
CONSULT POSTMASTER FOR FEES		
OPTIONAL SERVICES		
RETURN RECEIPT SERVICE		
SHOW TO WHOM, DATE AND ADDRESS OF DELIVERY	DATE DELIVERED	60 ¢
SHOW TO WHOM, DATE AND ADDRESS OF DELIVERY WITH RESTRICTED DELIVERY		
TOTAL POSTAGE AND FEES		\$ 2.23
POSTMARK OR DATE		6-22-83
NSL-State 28 #1/mh		

CERTIFIED MAIL

P 265 337 988

DOYLE HARTMAN
Oil Operator
P. O. BOX 10426
MIDLAND, TEXAS 79702

Union Texas Petroleum Corporation
1300 Wilco Building
Midland, Texas 79701

Attention: Knox E. Davis
Division Operations Manager

P 265 337 989

RECEIPT FOR CERTIFIED MAIL

NO INSURANCE COVERAGE PROVIDED—
NOT FOR INTERNATIONAL MAIL

(See Reverse)

SENT TO	
ARCO Oil and Gas Co.	
STREET AND NO.	
P. O. Box 1610	
P.O., STATE AND ZIP CODE	
Midland, Texas 79702	
POSTAGE	
CERTIFIED FEE	\$ 75
OPTIONAL SERVICES	
RETURN RECEIPT SERVICE	
SPECIAL DELIVERY	
RESTRICTED DELIVERY	
SHOW TO WHOM AND DATE DELIVERED	60
SHOW TO WHOM, DATE, AND ADDRESS OF DELIVERY	
SHOW TO WHOM AND DATE DELIVERED WITH RESTRICTED DELIVERY	
SHOW TO WHOM, DATE AND ADDRESS OF DELIVERY WITH RESTRICTED DELIVERY	
TOTAL POSTAGE AND FEES	\$ 2.23
POSTMARK OR DATE	
6-22-83	
NSL State 28 #1/mh	
P 265 337 989	
MAIL	

PS Form 3800, Apr. 1976

DOYLE HARTMAN
Oil Operator
P. O. Box 10426
MIDLAND, TEXAS 79702

ARCO Oil and Gas Company
Post Office Box 1610
Midland, Texas 79702

Attention: Mr. Craig Payken
Area Engineer

PS Form 3811, Dec. 1980

RETURN RECEIPT, REGISTERED, INSURED AND CERTIFIED MAIL

● **SENDER:** Complete items 1, 2, 3, and 4.
Add your address in the "RETURN TO" space
on reverse.

(CONSULT POSTMASTER FOR FEES)

1. The following service is requested (check one).

- ☒ Show to whom and date delivered 60¢
☐ Show to whom, date, and address of delivery

2. ☐ **RESTRICTED DELIVERY**

(The restricted delivery fee is charged in addition to
the return receipt fee.)

TOTAL \$ 0.60

3. **ARTICLE ADDRESSED TO:**

ARCo Oil and Gas Co.
P. O. Box 1610
Midland, Texas 79702

4. **TYPE OF SERVICE:**

- ☐ REGISTERED ☐ INSURED
☒ CERTIFIED ☐ COD
☐ EXPRESS MAIL

ARTICLE NUMBER

P 265 337 989

(Always obtain signature of addressee or agent)

I have received the article described above.

SIGNATURE ☐ Addressee ☐ Authorized agent

5. **DATE OF DELIVERY**

POSTMARK

6. **ADDRESSEE'S ADDRESS (Only if requested)**

7. **UNABLE TO DELIVER BECAUSE:**

7a. **EMPLOYEE'S
INITIALS**

NSL State 28 #1/mh

1. If you want this receipt to
be valid, you must sign it
and hand it to your rural carrier
or mailman. Otherwise, it is
not valid. (See Form 3811,
"Return Receipt," for more
information.)
2. If you do not want this receipt,
you may refuse it. If you
refuse it, the carrier or mailman
will not deliver the article.
3. If you want a return receipt,
you must pay the fee.
4. If you want delivery restricted
to a certain person, you must
pay the fee.
5. If you want delivery restricted
to a certain place, you must
pay the fee.
6. If you want delivery restricted
to a certain time, you must
pay the fee.

POSTMASTER: DO NOT WRITE IN THESE SPACES