



## ALPHA TWENTY-ONE PRODUCTION COMPANY

POST OFFICE BOX 1206  
JAL, NEW MEXICO 88252

December 3, 1982

Oil Conservation Commission  
P. O. Box 2088  
Santa Fe, New Mexico 87501

Attention: Joe D. Ramey, Director

RE: Application for a <sup>160</sup>~~640~~ acre non-standard gas proration unit,  
Eumont Gas Pool, comprising the SW 1/4 of Section 6, T-19-S,  
R-37-E, of Lea County, New Mexico.

Mr. Ramey:

Alpha Twenty-One Production Company hereby makes application for approval of a 640 acre non-standard gas proration unit in the Eumont Gas Pool comprising the SW 1/4 of Section 6, T-19-S, R-37-E, Lea County, New Mexico, and in support thereof states the following facts:

1. The proposed non-standard gas proration unit was acquired from Conoco, incorporated in the form of a farm out, the SW 1/4 of Section 6, T-19-S, R-37-E, Lea County, New Mexico. (160 acres)
2. The proposed non-standard gas proration unit will meet the requirements of Rule 5 (C) of the Oil Conservation Commission Order No. R-1670 as follows:
  - a. The proposed non-standard gas proration unit consists of less acreage than a standard proration unit and is unorthodox in size of the tract due to a variation in legal subdivision of the U. S. Public Land Surveys.
  - b. The non-standard gas proration unit consists of contiguous quarter-quarter sections.

-Continued-

OIL CONSERVATION DIVISION

DEC 13 1982

RECEIVED

505/395-3056

1342  
NSP  
R-1670  
1-2-82  
5(C)(3)

- c. The non-standard gas proration unit lies wholly within a single governmental section in the Eumont Gas Pool for 640 acre standard proration unit.
- d. The entire non-standard gas proration unit may reasonably be presumed to be productive of gas from the applicable gas pool.
- e. The length and width of the non-standard gas proration unit does not exceed 5,280 feet in Eumont Gas Pool 640 acre standard proration units.
- f. By copy of this letter of application, all operators owning interest in the section in which the proposed non-standard proration is located and all operators within 1,500 feet of the proposed unit well are notified by registered mail of the intent of Alpha Twenty-One Production Company to form the non-standard gas proration unit.

In view of the existence of the facts herein stated and compliance with the provisions of Rule 5 (C) of the Oil Conservation Commission's Order No. R-1670, Alpha Twenty-One Production Company requests that the Director of the Commission approve the above described non-standard gas proration unit.

Respectfully submitted,

ALPHA TWENTY-ONE PRODUCTION COMPANY

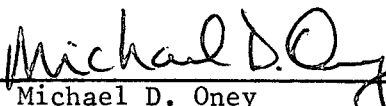
By:   
Michael D. Oney  
Drilling Superintendent

Registered Mail - Return Receipt Requested:

Amoco Producing and Exploration Company  
P. O. Box 68  
Hobbs, New Mexico 88240  
Attn: Pete McRae

Conoco, Incorporated  
P. O. Box 460  
Hobbs, New Mexico 88240  
Attn: Mark Mosley

-Continued-

Apollo Energy, Incorporated  
P. O. Box 5315  
Hobbs, New Mexico 88241  
Attn: My Merchant

Lonnie J. Buck  
P. O. Box 129  
Hobbs, New Mexico 88240  
Attn: Joe Buck

Carbon Energy  
P. O. Box 129  
Hobbs, New Mexico 88240  
Attn: Joe Buck

Gulf Oil Corporation  
P. O. Box 670  
Hobbs, New Mexico 88240  
Attn: R. D. Pitre

Herman J. Ledbetter  
P. O. Box 5879  
Abilene, Texas 79608  
Attn: Herman J. Ledbetter

Texaco, Incorporated  
P. O. Box 728  
Hobbs, New Mexico 88240  
Attn: John V. Gannon

cc: Oil Conservation Commission  
P. O. Box 1980  
Hobbs, New Mexico

Bob Lansford  
Alpha Twenty-One Production Company

Alpha Twenty-One Production Company  
P. O. Box 1206  
Jal, New Mexxico

MDO/bfm

NO. OF COPIES RECEIVED	
DISTRIBUTION	
SANTA FE	
FILE	
U.S.G.S.	
LAND OFFICE	
OPERATOR	

DEC 13 1982

## APPLICATION FOR PERMIT TO DRILL, DEEPEN, OR PLUG BACK

Type of Work

Type of Well DRILL ☒ DEEPEN ☐ PLUG BACK ☐  
OIL WELL ☐ GAS WELL ☒ OTHER ☐ SINGLE ZONE ☐ MULTIPLE ZONE ☐

Name of Operator

Alpha Twenty-One Production Company

Address of Operator

P.O. Box 1206 Jal, New Mexico 88252

Location of Well

UNIT LETTER N LOCATED 1944 FEET FROM THE West LINE

660 FEET FROM THE South LINE OF SEC. 6 TWP. 19-S RGE. 37-E NMPM

5A. Indicate Type of Lease

STATE ☒ FEDERAL ☐

5. State Oil &amp; Gas Lease No.

7. Unit Agreement Name

8. Farm or Lease Name

Jo

9. Well No.

1

10. Field and Pool, or Wildcat

Eumont Gas Pool

12. County

Lea

19. Proposed Depth

3900

19A. Formation

Queen

20. Rotary or C.T.

Rotary

Elevations (Show whether Dr, RT, etc.)

3717.4 GL

21A. Kind &amp; Status Plug. Bond

State Wide

21B. Drilling Contractor

22. Approx. Date Work will start

1-1-83

## PROPOSED CASING AND CEMENT PROGRAM

SIZE OF HOLE	SIZE OF CASING	WEIGHT PER FOOT	SETTING DEPTH	SACKS OF CEMENT	EST. TOP
12-1/4"	8-5/8"	24#	400'	250	Circulate
7-7/8"	5-1/2"	14#	3900'	1200	Circulate

The proposed well is being requested for a Non-Standard Proration Gas Unit in the Eumont Gas Pool. (See Attachments)

The proposed well will be equipped with a 3000 PSI Double Ram BOP System from the base of surface casing through the running of production casing.

OVER SPACE DESCRIBE PROPOSED PROGRAM: IF PROPOSAL IS TO DEEPEN OR PLUG BACK, GIVE DATA ON PRESENT PRODUCTIVE ZONE AND PROPOSED NEW PRODUCTION. GIVE BLOWOUT PREVENTER PROGRAM, IF ANY.

I hereby certify that the information above is true and complete to the best of my knowledge and belief.

Michael D. Ory  
(This space for State Use)

Title Drilling Superintendent

Date 12-3-82

APPROVED BY \_\_\_\_\_ TITLE \_\_\_\_\_ DATE \_\_\_\_\_

REMARKS OR APPROVAL, IF ANY:

NEW MEXICO OIL CONSERVATION COMMISSION  
WELL LOCATION AND ACREAGE DEDICATION PLAT

Form C-122  
Supersedes C-128  
Effective 1-1-85

All distances must be from the outer boundaries of the Section

Operator <b>ALPHA 21 PRODUCTION CO.</b>		Lease <b>Jd</b>		Well No. <b>1</b>
Unit Letter <b>N</b>	Section <b>6</b>	Township <b>19 SOUTH</b>	Range <b>37 EAST</b>	County <b>LEA</b>
Actual Footage Location of Well <b>1944</b> feet from the <b>WEST</b> line and <b>660</b> feet from the <b>SOUTH</b> line				
Ground Level Elev. <b>3717.4</b>	Producing Formation <b>Queen</b>	Pool <b>Eumont Gas</b>	Dedicated Acreage <b>160</b> Acres	

1. Outline the acreage dedicated to the subject well by colored pencil or hachure marks on the plat below.
2. If more than one lease is dedicated to the well, outline each and identify the ownership thereof (both as to working interest and royalty).
3. If more than one lease of different ownership is dedicated to the well, have the interests of all owners been consolidated by communitization, unitization, force-pooling, etc?

☐ Yes ☐ No If answer is "yes," type of consolidation \_\_\_\_\_

If answer is "no," list the owners and tract descriptions which have actually been consolidated (Use reverse side of this form if necessary.) \_\_\_\_\_

No allowable will be assigned to the well until all interests have been consolidated (by communitization, unitization, forced-pooling, or otherwise) or until a non-standard unit, eliminating such interests, has been approved by the Commission.

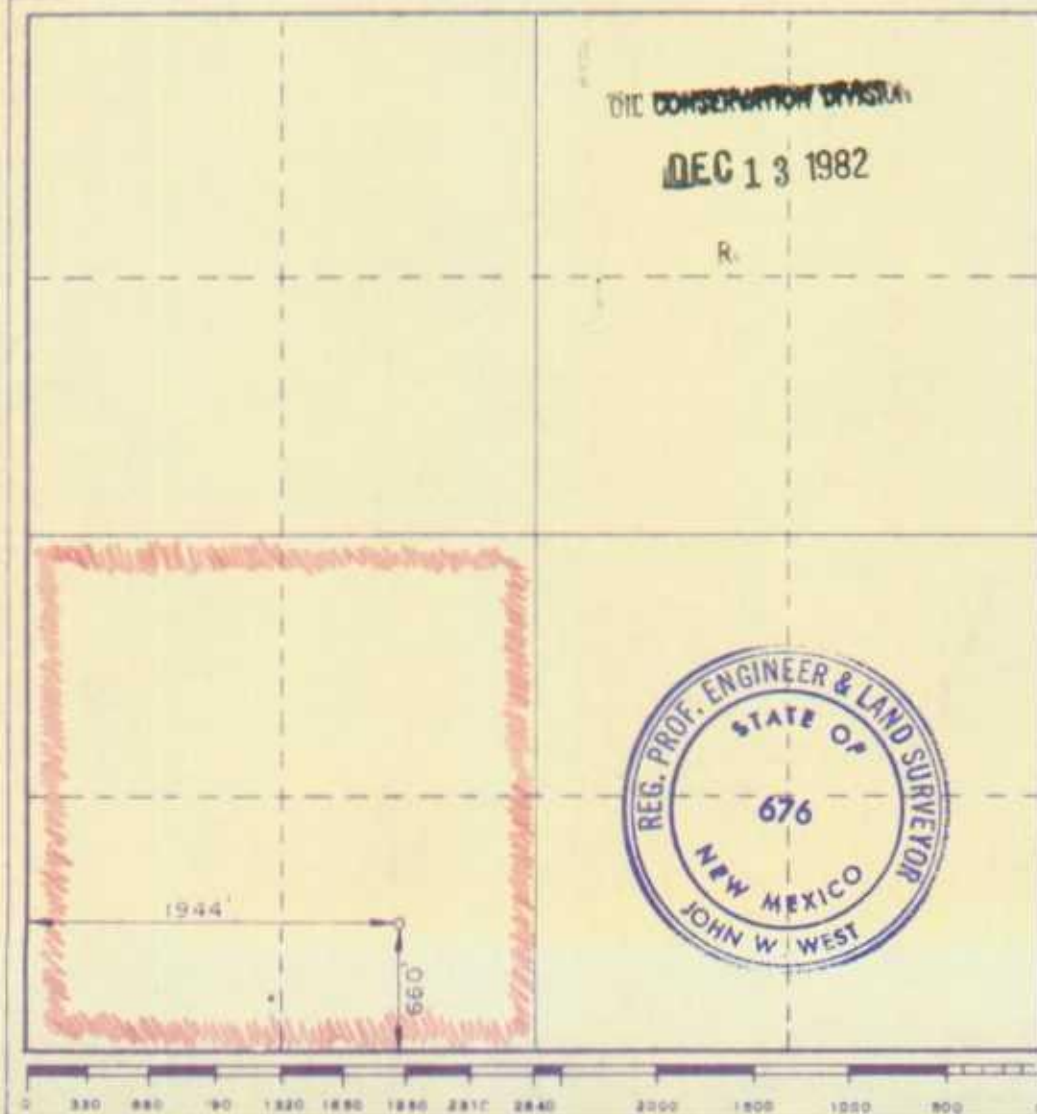

CERTIFICATION

I hereby certify that the information contained herein is true and complete to the best of my knowledge and belief.

*Michael D. Oney*  
Name  
**Michael D. Oney**

Position  
**Drilling Superintendent**

Company  
**Alpha 21 Production Co.**

Date  
**12-3-82**

I hereby certify that the well location shown on this plat was plotted from field notes of actual surveys made by me or under my supervision, and that the same is true and correct to the best of my knowledge and belief.

**12-1-82**

Date Surveyed

Registered Professional Engineer and/or Land Surveyor

*John W. West*

Certificate No.  
**JOHN W. WEST NO 676**

Township 19-South Range 37-East

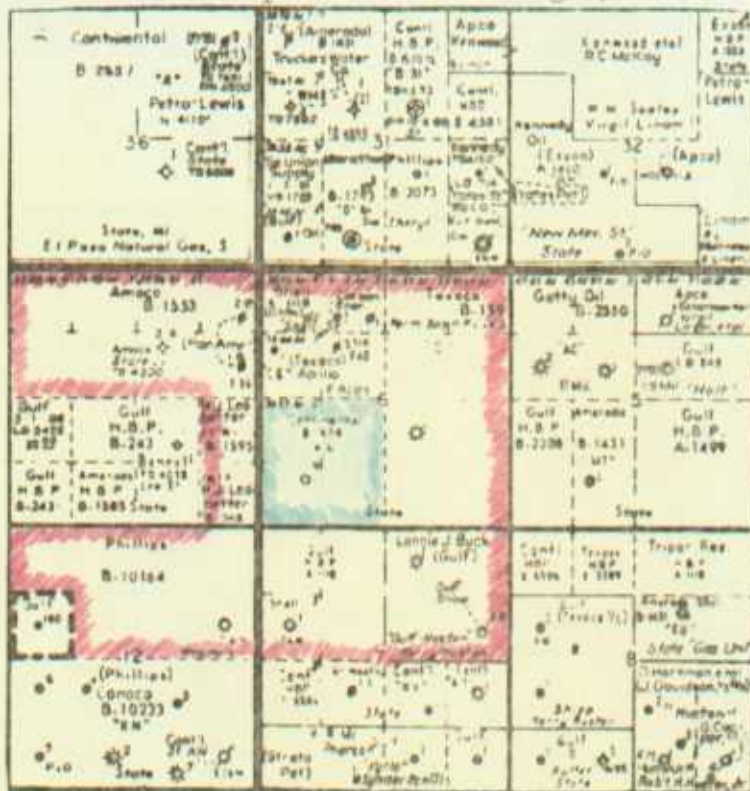

ALPHA TWENTY-ONE PRODUCTION COMPANY  
JAL OFFICE  
Scale 1"=4000'

Plat accompanying application for  
640-acre Non-Standard Gas Unit  
(Eumont Gas Pool)

Alpha 21-Conoco Farm Out-160 acres

Blue-Alpha 21 Lease acreage  
Red-Offset Operators notified

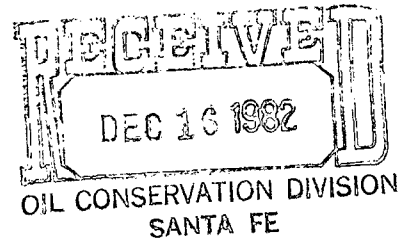
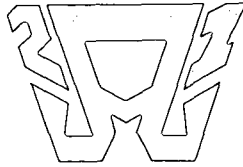

## ALPHA TWENTY-ONE PRODUCTION COMPANY

POST OFFICE BOX 1206  
JAL, NEW MEXICO 88252

505/395-3056

December 13, 1982

Oil Conservation Commission  
P. O. Box 2088  
Santa Fe, New Mexico 87501

Mr. Ramey:

An offset operators to our acreage in Section 6, T-19-S, R-37-E, in Lea County, New Mexico was accidentally left off the application for a non-standard gas proration unit.

Please be advised that Phillips Petroleum was notified of our application to the Oil Conservation Commission. The information was sent to:

Phillips Petroleum  
4001 Penbrook  
Odessa, Texas 79762  
Attn: Harold McLemore

Please excuse the oversight of this matter. Thank you very much.

Sincerely yours,

Michael D. Oney  
Drilling Superintendent

MDO/bfm

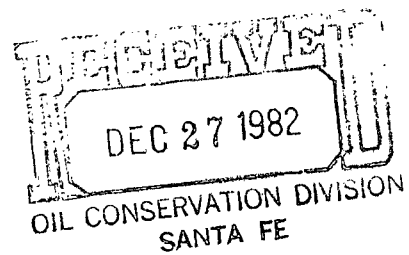
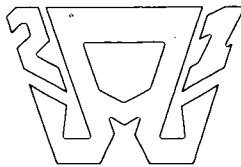

## ALPHA TWENTY-ONE PRODUCTION COMPANY

POST OFFICE BOX 1206  
JAL, NEW MEXICO 88252

505/395-3056

December 15, 1982

Oil Conservation Commission  
P. O. Box 2088  
Santa Fe, New Mexico 87501

Attention: Joe D. Ramey, Director

RE: Application for non-standard gas proration unit, Eumont Gas Pool, comprising the SW 1/4 of Section 6, T-19-S, R-37-E, of Lea County, New Mexico.

Mr. Ramey:

In reference to our letter dated December 3, 1982, we wish to correct an error.

The letter stated Alpha Twenty-One Production Company was applying for a 640 acre non-standard gas proration unit. The letter should have stated, Alpha Twenty-One Production Company was applying for a 160 acre non-standard gas proration unit.

All Offset Operators involved in this matter have been notified of the error.

We are sorry for any inconvenience this may have caused. Please accept our apology.

Sincerely yours,

Michael D. Oney  
Drilling Superintendent

MDO/bfm

Amoco Producing and Exploration Company  
P. O. Box 68  
Hobbs, New Mexico 88240  
Attn: Pete McRae

Apollo Energy, Incorporated  
P. O. Box 5315  
Hobbs, New Mexico 88241  
Attn: My Merchant

Lonnie J. Buck  
P. O. Box 129  
Hobbs, New Mexico 88240  
Attn: Joe Buck

Carbon Energy  
P. O. Box 129  
Hobbs, New Mexico 88240  
Attn: Joe Buck

Conoco, Incorporated  
P. O. Box 460  
Hobbs, New Mexico 88240  
Attn: Mark Mosley

Gulf Oil Corporation  
P. O. Box 670  
Hobbs, New Mexico 88240  
Attn: R. D. Pitre

Herman J. Ledbetter  
P. O. Box 5879  
Abilene, Texas 79608  
Attn: Herman J. Ledbetter

Texaco, Incorporated  
P. O. Box 728  
Hobbs, New Mexico 88240  
Attn: John V. Gannon

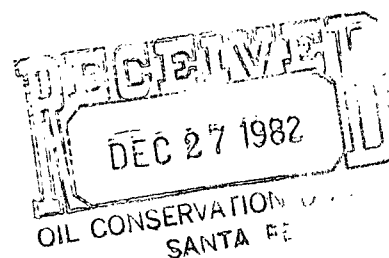



**PHILLIPS PETROLEUM COMPANY**

ODESSA, TEXAS 79762  
4001 PENBROOK

NATURAL RESOURCES GROUP  
Exploration and Production

1342  
December 16, 1982

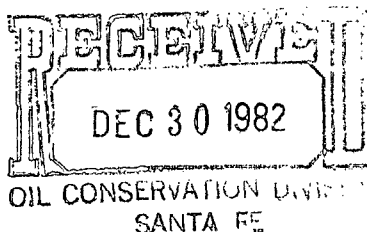

In Re: Alpha Twenty-One Production Company  
Application for a 160 acre non-  
standard unit--SW/4, Section 6,  
T-19-S, R-37-E, Eumont gas pool,  
Lea County, New Mexico

---

New Mexico Dept. of Energy and Minerals  
Oil Conservation Division  
P. O. Box 2088  
Santa Fe, New Mexico 87501

Attention: Mr. Joe Ramey

Gentlemen:

*Waiver*

Phillips Petroleum Company as an offset operator, hereby waives any and all objections to subject application for a 160 acre non-standard gas proration unit. It is understood that this unit is to be dedicated to the operator's Jo Well No. 1 located in Unit (N) 1944' FWL, 660' FSL, Section 6, T-19-S, R-37-E, Lea County, New Mexico.

Very truly yours,

G. R. Smith  
Director of Reservoir Engineering

THM:amw

cc: Alpha Twenty-One Production Company  
Attention: Mr. Michael D. Oney  
P. O. Box 1206  
Jal, New Mexico 88252

WAIVER

By signing this letter, the undersigned herin agrees to waive any rights to a New Mexico Oil Conservation Commision hearing concerning the Non-Standard Gas Proration Unit in the Eumont Gas Pool, for the proposed Alpha Twenty-One Production Company well, to be drilled in Section 6, T-19-S, R-37-E, Lea County, New Mexico. The perpendicular measurements are:

1944' FWL-660' FSL

This well is to be drilled to an estimated total depth of 3900'.

If you choose to exercise this waiver, please indicate your acceptance hereof in the space provided below and return to Michael D. Oney, P.O. Box 1206, Jal, New Mexico 88252, at your earliest convenience.

AGREED AND ACCEPTED THIS THE 16<sup>TH</sup>  
DAY OF DECEMBER, 1982.

*Michael D. Merchant*

My Merchant  
Apollo Energy, Inc.

