

DEC 13 1982

RECEIVED



## ALPHA TWENTY-ONE PRODUCTION COMPANY

POST OFFICE BOX 1206  
JAL, NEW MEXICO 88252

505/395-3056

December 3, 1982

Oil Conservation Commission  
P. O. Box 2088  
Santa Fe, New Mexico 87501

Attention: Joe D. Ramey, Director

RE: Application for a <sup>80</sup>~~640~~ acre non-standard gas proration unit,  
Eumont Gas Pool, comprising the N 1/2 of the NW 1/4 of  
Section 9, T-19-S, R-37-E, Lea County, New Mexico.

Mr. Ramey:

Alpha Twenty-One Production Company hereby makes an application for approval of a 640 acre non-standard gas proration unit in the Eumont Gas Pool comprising the N 1/2 of the NW 1/4 of Section 9, T-19-S, R-37-E, Lea County, New Mexico, and in support thereof states the following facts:

1. Alpha Twenty-One Production Company has acquired from Getty Oil Company, in the form of a farm out, the N 1/2 of the NW 1/4 of Section 9, T-19-S, R-37-E of Lea County, New Mexico (80 acres).
2. The proposed non-standard gas proration unit will meet the requirements of Rule 5 (C) of the Oil Conservation Commission Order No. R-1670 as follows:
  - a. The proposed non standard proration unit consists of less acreage than a standard proration unit.
  - b. The non-standard gas proration unit consists of contiguous quarter-quarter sections.
  - c. The non-standard gas proration unit lies wholly within a single governmental section in the Eumont Gas Pool with 640 acre standard proration units.

- d. The entire non-standard gas proration unit may reasonably be presumed to be productive of gas from the applicable gas pool.
- e. The length or width of the non-standard gas proration unit does not exceed 5,280 feet in pools with 640 acre standard proration units.
- f. By copy of this letter of application, all operators owning interest in the section in which the proposed non-standard gas proration unit is located and all operators within 1,500 feet of the proposed unit well are notified by registered mail of the intent of Alpha Twenty-One Production Company to form the proposed non-standard gas proration unit.

In view of the existence of the facts herein stated and compliance with the provisions of Rule 5 (C) of the Oil Conservation Commission's Order No. R-1670, Alpha Twenty-One Production Company requests that the Director of the Commission approve the above described non-standard gas proration unit.

Respectfully submitted,

ALPHA TWENTY-ONE PRODUCTION COMPANY

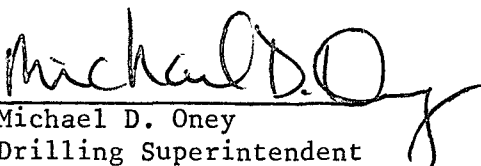
by:   
Michael D. Oney  
Drilling Superintendent

Registered Mail - Returned Receipt Requested:

Amerada Hess Corporation  
P. O. Box 840  
Seminole, Texas 79361  
Attn: George Garrett

Texaco, Incorporated  
P. O. Box 728  
Hobbs, New Mexico 88240  
Attn: John V. Gannon

Exxon Oil Company  
1700 West Broadway  
Andrews, Texas 79714  
Attn: E. C. McBee

Tripur Resources  
% Smith Petroleum  
One West Loop South  
Suite 808  
Houston, Texas 77027  
Attn: Don Pisklak

-Continued-

Getty Oil Company  
P. O. Box 1231  
Midland, Texas 79702  
Attn: L. R. Hall

Gulf Oil Corporation  
P. O. Box 670  
Hobbs, New Mexico 88240  
Attn: R. D. Pitre

Shell Oil Company  
P. O. Box 1950  
Hobbs, New Mexico 88240  
Attn: Welton Moore

Don H. Wilson  
1305 Stockton  
Brownfield, Texas 79316  
Attn: Don Wilson

Wiser Oil Company  
P. O. Box 2467  
Hobbs, New Mexico 88240  
Attn: Bill D. Singletary

cc: Oil Conservation Commission  
P. O. Box 1980  
Hobbs, New Mexico 88240

Bob Lansford  
Alpha Twenty-One Production Company

Alpha Twenty-One Production Company  
P. O. Box 1206  
Jal, New Mexico 88252

MDO/bfm

NO. OF COPIES RECEIVED	
DISTRIBUTION	
SANTA FE	
FILE	
U.S.G.S.	
LAND OFFICE	
OPERATOR	

DEC 13 1982

5A. Indicate Type of Lease
STATE <input type="checkbox"/> FEE <input checked="" type="checkbox"/>
5. State Oil & Gas Lease No.

## APPLICATION FOR PERMIT TO DRILL, DEEPEN, OR PLUG BACK

Type of Work

Type of Well DRILL ☒ DEEPEN ☐ PLUG BACK ☐  
OIL WELL ☐ GAS WELL ☒ OTHER ☐ SINGLE ZONE ☐ MULTIPLE ZONE ☐

Name of Operator

Alpha Twenty-One Production Company

Address of Operator

P.O. Box 1206 Jal, New Mexico 88252

Location of Well

UNIT LETTER D LOCATED 660 FEET FROM THE North LINE

660 FEET FROM THE West LINE OF SEC. 9 TWP. 19-S RGE. 37-E NMPM

7. Unit Agreement Name

8. Farm or Lease Name

Oney

9. Well No.

1

10. Field and Pool, or Wildcat

Eumont Gas

12. County

Lea

19. Proposed Depth	3850	19A. Formation	Queen	20. Rotary or C.T.	Rotary
21A. Kind & Status Plug. Bond	State Wide	21B. Drilling Contractor		22. Approx. Date Work will start	2-1-83

## PROPOSED CASING AND CEMENT PROGRAM

SIZE OF HOLE	SIZE OF CASING	WEIGHT PER FOOT	SETTING DEPTH	SACKS OF CEMENT	EST. TOP
12-1/4"	8-5/8"	24#	400'	250	Circulate
7-7/8"	5-1/2"	14#	3850'	1200	Circulate

The proposed well is being requested for a Non-Standard Gas Proration Unit in the Eumont Gas Pool. (See attachments.)

The proposed well will be equipped with a 3000 PSI Double Ram BOP System from the base of surface casing through the running of production casing.

MOVE SPACE DESCRIBE PROPOSED PROGRAM: IF PROPOSAL IS TO DEEPEN OR PLUG BACK, GIVE DATA ON PRESENT PRODUCTIVE ZONE AND PROPOSED NEW PRODUCTION. GIVE BLOWOUT PREVENTER PROGRAM, IF ANY.

I hereby certify that the information above is true and complete to the best of my knowledge and belief.

by Michael P. Ozy Title Drilling Superintendent Date 12-3-82  
(This space for State Use)

APPROVED BY \_\_\_\_\_ TITLE \_\_\_\_\_ DATE \_\_\_\_\_  
CONDITIONS OF APPROVAL, IF ANY:

NEW MEXICO OIL CONSERVATION COMMISSION  
WELL LOCATION AND ACREAGE DEDICATION PLAT

Form C-122  
Supersedes C-128  
Effective 1-1-85

All distances must be from the outer boundaries of the Section

Operator <b>ALPHA 21 PRODUCTION CO.</b>			Lease <b>ONEY</b>		Well No. <b>1</b>
Well Letter <b>D</b>	Section <b>9</b>	Township <b>19S</b>	Range <b>37E</b>	County <b>LEA</b>	
Actual Footage Location of Well: <b>660</b> feet from the <b>NORTH</b> line and <b>660</b> feet from the <b>WEST</b> line					
Ground Level Elev. <b>3693.3</b>	Producing Formation <b>Queen</b>		Pool <b>Eumont Gas</b>	Dedicated Acreage <b>80</b> Acres	

1. Outline the acreage dedicated to the subject well by colored pencil or hatchure marks on the plat below.
2. If more than one lease is dedicated to the well, outline each and identify the ownership thereof (both as to working interest and royalty).
3. If more than one lease of different ownership is dedicated to the well, have the interests of all owners been consolidated by communitization, unitization, force-pooling, etc?

☐ Yes ☐ No If answer is "yes," type of consolidation \_\_\_\_\_

If answer is "no," list the owners and tract descriptions which have actually been consolidated. (Use reverse side of this form if necessary.) \_\_\_\_\_

No allowable will be assigned to the well until all interests have been consolidated (by communitization, unitization, forced-pooling, or otherwise) or until a non-standard unit, eliminating such interests, has been approved by the Commission.



CERTIFICATION

I hereby certify that the information contained herein is true and complete to the best of my knowledge and belief.

*Michael D. Oney*  
Name  
**Michael D. Oney**

Position  
**Drilling Superintendent**

Company  
**Alpha 21 Production Co.**

Date  
**12-3-82**

I hereby certify that the well location shown on this plat was plotted from field notes of actual surveys made by me or under my supervision, and that the same is true and correct to the best of my knowledge and belief.

Date Surveyed  
**12/3/82**

Registered Professional Engineer and/or Land Surveyor

*John W. West*  
Signature

Certificate No.  
**JOHN W. WEST N.M.#676**

0 880 860 840 820 800 780 760 740 720 700 680 660 640 620 600 580 560 540 520 500 480 460 440 420 400 380 360 340 320 300 280 260 240 220 200 180 160 140 120 100 80 60 40 20 0

Township 19-South Range 37-East

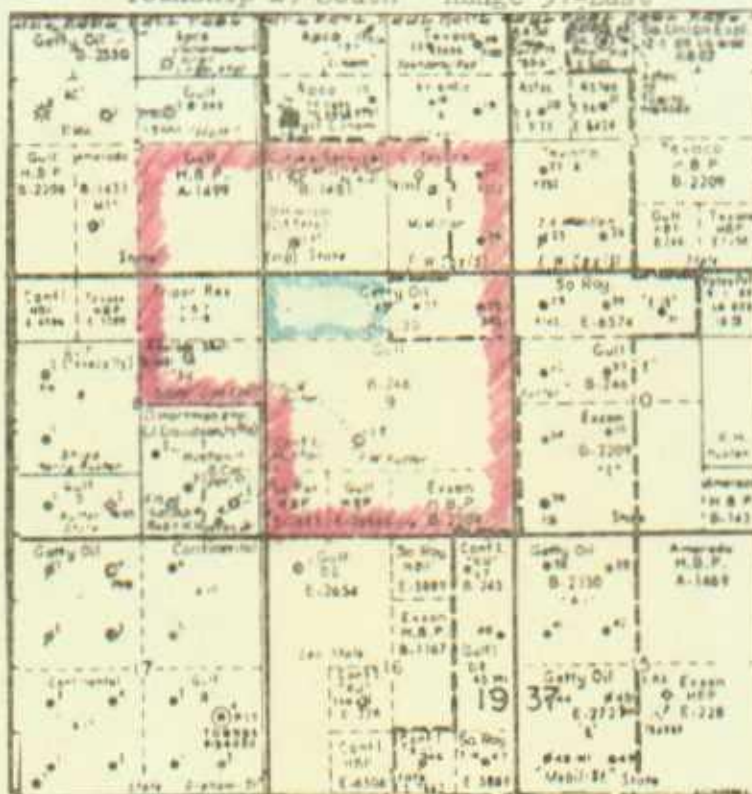

ALPHA TWENTY-ONE PRODUCTION COMPANY

JAL OFFICE

Scale 1"=4000'

Plat accompanying application for  
640-acre Non-Standard Gas Unit  
(Eumont Gas Pool)

Alpha 21-Getty Farm Out-80 acres

Blue-Alpha 21 Lease acreage  
Red-Offset Operators notified

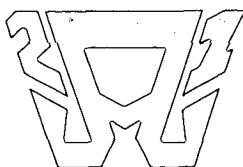

## ALPHA TWENTY-ONE PRODUCTION COMPANY

POST OFFICE BOX 1206  
JAL, NEW MEXICO 88252

505/395-3056

December 20, 1982

Oil Conservation Commission  
P. O. Box 2088  
Santa Fe, New Mexico 87501

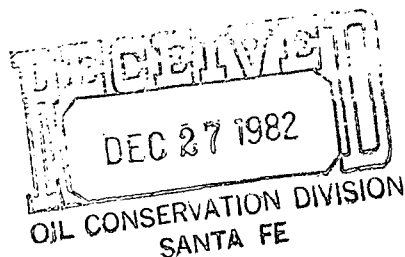

Attention: Joe D. Ramey, Director

RE: Application for non-standard gas proration unit, Eumont Gas Pool, comprising the N 1/2 of the NW 1/4 of Section 9, T-19-S, R-37-E, Lea County, New Mexico.

Mr. Ramey:

In reference to our letter dated December 3, 1982, we wish to correct an error.

The letter stated Alpha Twenty-One Production Company was applying for a 640 acre non-standard gas proration unit. The letter should have stated, Alpha Twenty-One Production Company was applying for an 80 acre non-standard gas proration unit.

All offset operators involved in this matter have been notified of the error.

We are sorry for any inconvenience this may have caused. Please accept our apology.

Sincerely yours,

Michael D. Oney  
Drilling Superintendent

MDO/bfm

Amerada Hess Corporation  
P. O. Box 840  
Seminole, Texas 79361  
Attn: George Garrett

Exxon Oil Company  
1700 West Broadway  
Andrews, Texas 79714  
Attn: E. C. McBee

Getty Oil Company  
P. O. Box 1231  
Midland, Texas 79702  
Attn: L. R. Hall

Gulf Oil Corporation  
P. O. Box 670  
Hobbs, New Mexico 88240  
Attn: R. D. Pitre

Shell Oil Company  
P. O. Box 1950  
Hobbs, New Mexico 88240  
Attn: Welton Moore

Texaco, Incorporated  
P. O. Box 728  
Hobbs, New Mexico 88240  
Attn: John V. Gannon

Tripot Resources  
% Smith Petroleum  
One West Loop South  
Suite 808  
Houston, Texas 77027  
Attn: Don Pisklak

Don H. Wilson  
1305 Stockton  
Brownfield, Texas 79316  
Attn: Don Wilson

Wiser Oil Company  
P. O. Box 2467  
Hobbs, New Mexico 88240  
Attn: Bill D. Singletary

