



**Marathon
Oil Company**

*NSP K407
Rule 5 C 3 81670
10-27-83
Superseded NSP 1262*

Houston Division
Production Operations, United States

P.O. Box 2409
Hobbs, New Mexico 88240
Telephone 505/393-7106

October 3, 1983

State of New Mexico
Oil Conservation Division
P. O. Box 2088
Santa Fe, NM 87501

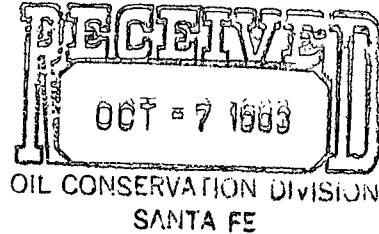

Re: Nonstandard Tubb Gas Proration Unit
L. G. Warlick "C" lease
Tubb Oil and Gas Pool
Lea County, New Mexico

Dear Sir:

Marathon Oil Company requests administrative approval of an 80 acre nonstandard Tubb gas proration unit for the L. G. Warlick "C" Well No. 1. This well is located 1980' FSL and 1980' FEL, Unit J, Section 15, T21S, R37E, Lea County, New Mexico.

The L. G. Warlick "C" No. 1 is a Tubb gas well producing from a non-standard 120 acre proration unit. In 1981 permission was granted for the present nonstandard proration unit. At that time the L. G. Warlick "C" Well No. 3 was completed as a Tubb oil well. In September, 1983 the L. G. Warlick "C" Well No. 7 was completed in the Tubb oil. It is still being tested and is producing an average of 16 BOPD and 27 BWPD. Well No. 1 is producing 40 MCFD and Well No. 3 makes 8 BOPD and 230 MCFD. It is proposed to dedicate the SW quarter of this quarter section to Well No. 7. This leaves the NW and NE quarters for Well No. 1.

Attached are the proposed C102's for these three wells outlining their acreage. A copy of the certified letter receipt to each of the offset operators is enclosed also.

Please contact this office if any questions arise.

Sincerely,

Thomas F. Zapatka
Production Engineer

TFZ:lbp

Enclosures

All distances must be from the outer boundaries of the Section.

Operator Marathon Oil Company			Lease L. G. Warlick "C"		Well No. 1
Unit Letter J	Section 15	Township 21S	Range 37E	County Lea	
Actual Footage Location of Well: 1980 feet from the South line and 1980 feet from the East line					
Ground Level Elev. 3418	Producing Formation Tubb	Pool Tubb Gas		Dedicated Acreage: 80 Acres	

1. Outline the acreage dedicated to the subject well by colored pencil or hatchure marks on the plat below.
2. If more than one lease is dedicated to the well, outline each and identify the ownership thereof (both as to working interest and royalty).
3. If more than one lease of different ownership is dedicated to the well, have the interests of all owners been consolidated by communitization, unitization, force-pooling, etc?

☐ Yes ☐ No If answer is "yes," type of consolidation _____

If answer is "no," list the owners and tract descriptions which have actually been consolidated. (Use reverse side of this form if necessary.) _____

No allowable will be assigned to the well until all interests have been consolidated (by communitization, unitization, forced-pooling, or otherwise) or until a non-standard unit, eliminating such interests, has been approved by the Division.

R-37E

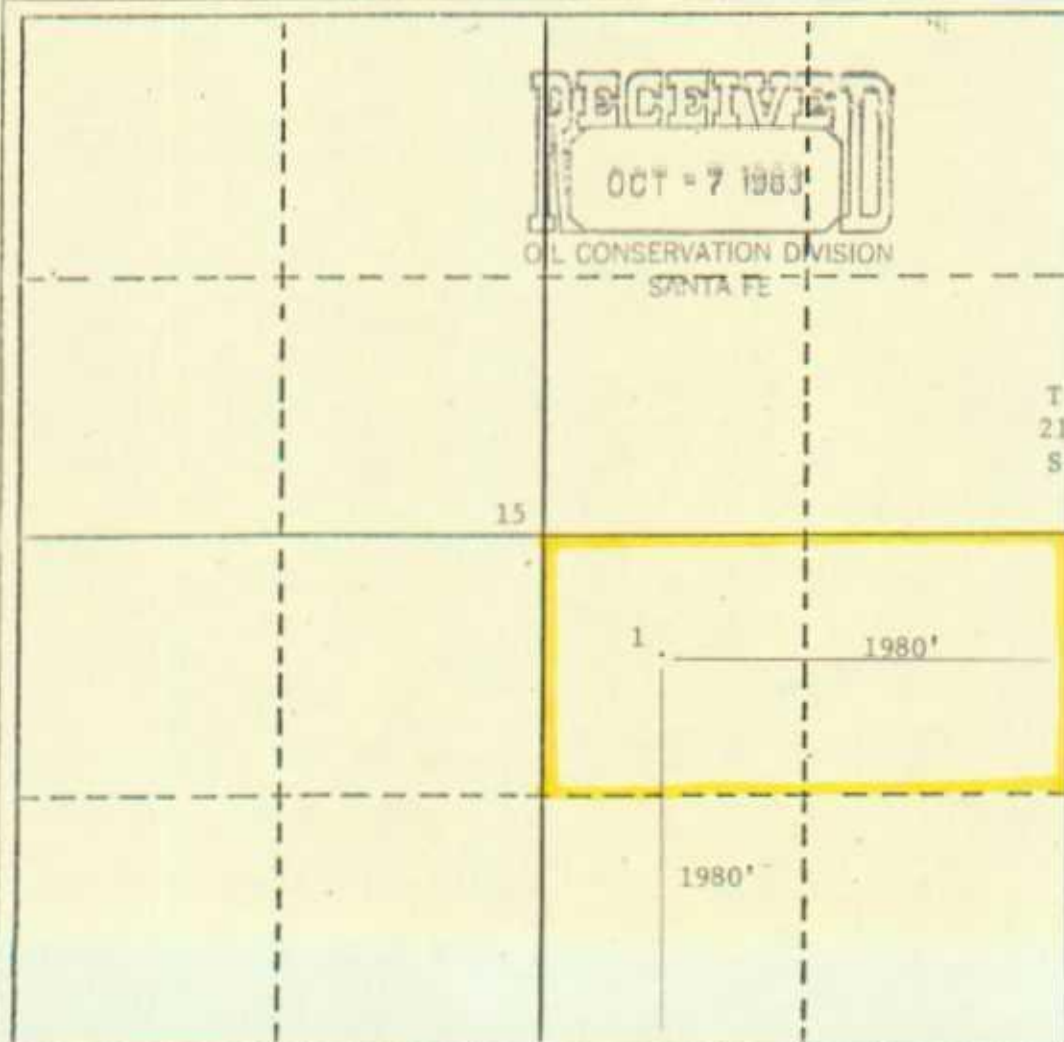

CERTIFICATION

I hereby certify that the information contained herein is true and complete to the best of my knowledge and belief.

Name Thomas F. Zaparka
Position Production Engineer
Company Marathon Oil Company
Date October 3, 1983

I hereby certify that the well location shown on this plat was plotted from field notes of actual surveys made by me or under my supervision, and that the same is true and correct to the best of my knowledge and belief.

Date Surveyed _____
Registered Professional Engineer
and/or Land Surveyor

Certificate No. _____



OIL CONSERVATION DIVISION

STATE OF NEW MEXICO
ENERGY AND MINERALS DEPARTMENTP. O. BOX 2088
SANTA FE, NEW MEXICO 87501Form C-102
Revised 10-1-78

All distances must be from the outer boundaries of the Section.

Operator Marathon Oil Company			Lease L. G. Warlick "C"			Well No. 7		
Unit Letter 0	Section 15	Township 21S	Range 37E	County Lea				
Actual Footage Location of Well: 405 feet from the South line and 2310 feet from the East line								
Ground Level Elev. 3415	Producing Formation Tubb		Pool Tubb-Oil			Dedicated Acreage: 40 Acres		

1. Outline the acreage dedicated to the subject well by colored pencil or hatchure marks on the plat below.
2. If more than one lease is dedicated to the well, outline each and identify the ownership thereof (both as to working interest and royalty).
3. If more than one lease of different ownership is dedicated to the well, have the interests of all owners been consolidated by communitization, unitization, force-pooling, etc?

☐ Yes ☐ No If answer is "yes," type of consolidation _____

If answer is "no," list the owners and tract descriptions which have actually been consolidated. (Use reverse side of this form if necessary.) _____

No allowable will be assigned to the well until all interests have been consolidated (by communitization, unitization, forced-pooling, or otherwise) or until a non-standard unit, eliminating such interests, has been approved by the Division.

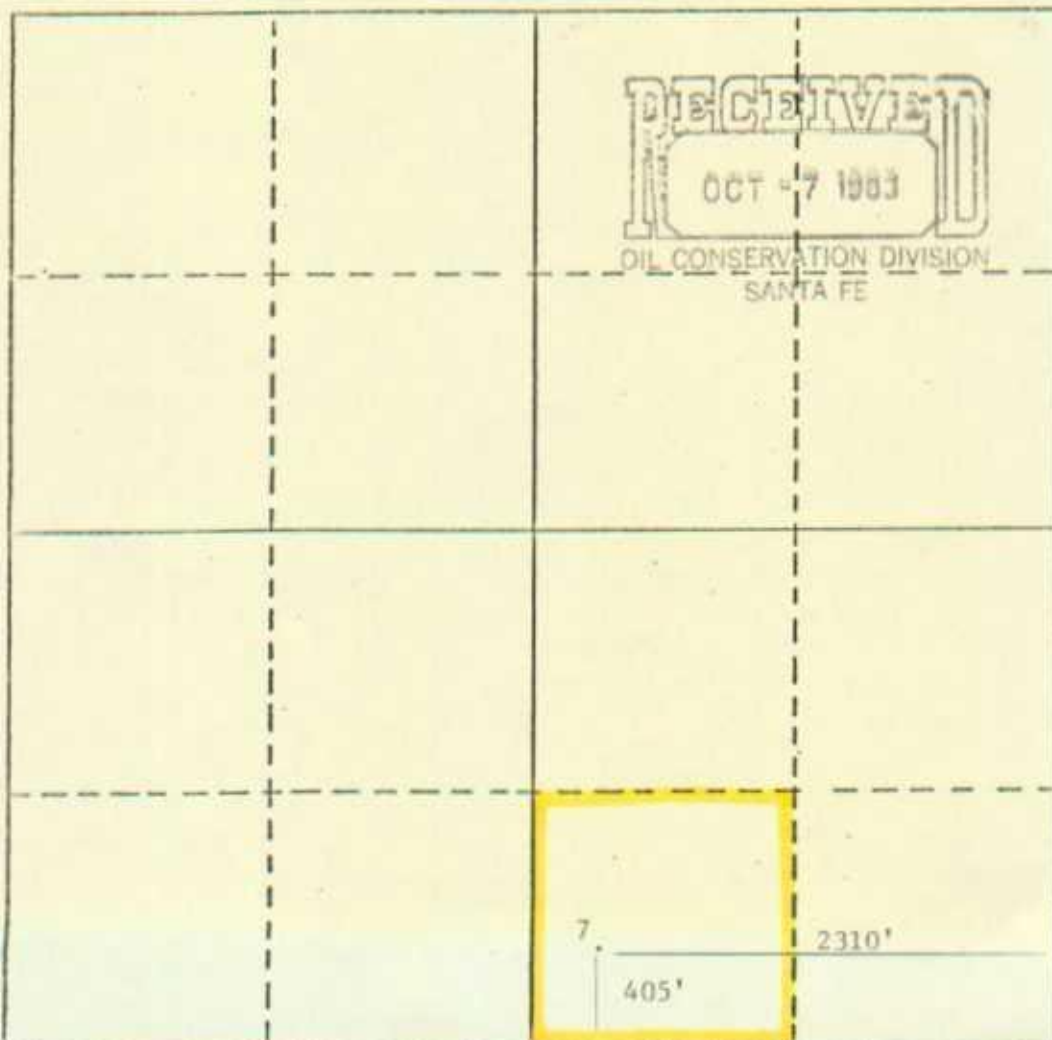

CERTIFICATION

I hereby certify that the information contained herein is true and complete to the best of my knowledge and belief.

Name Thomas F. Zaparka
 Position Production Engineer
 Company Marathon Oil Company
 Date October 3, 1983

I hereby certify that the well location shown on this plat was plotted from field notes of actual surveys made by me or under my supervision, and that the same is true and correct to the best of my knowledge and belief.

Date Surveyed _____

Registered Professional Engineer
and/or Land Surveyor

Certificate No. _____



OIL CONSERVATION DIVISION

STATE OF NEW MEXICO
ENERGY AND MINERALS DEPARTMENTP. O. BOX 2088
SANTA FE, NEW MEXICO 87501Form C-102
Revised 10-1-78

All distances must be from the outer boundaries of the Section.

Operator Marathon Oil Company			Lease L. G. Warlick "C"			Well No. 3		
Unit Letter P	Section 15	Township 21S	Range 37E	County Lea				
Actual Footage Location of Well: 660 feet from the South line and 660 feet from the East line								
Ground Level Elev. 3411	Producing Formation Tubb		Pool Tubb Oil			Dedicated Acreage: 40 Acres		

1. Outline the acreage dedicated to the subject well by colored pencil or hatchure marks on the plat below.
2. If more than one lease is dedicated to the well, outline each and identify the ownership thereof (both as to working interest and royalty).
3. If more than one lease of different ownership is dedicated to the well, have the interests of all owners been consolidated by communitization, unitization, force-pooling, etc?

☐ Yes ☐ No If answer is "yes," type of consolidation _____

If answer is "no," list the owners and tract descriptions which have actually been consolidated. (Use reverse side of this form if necessary.) _____

No allowable will be assigned to the well until all interests have been consolidated (by communitization, unitization, forced-pooling, or otherwise) or until a non-standard unit, eliminating such interests, has been approved by the Division.

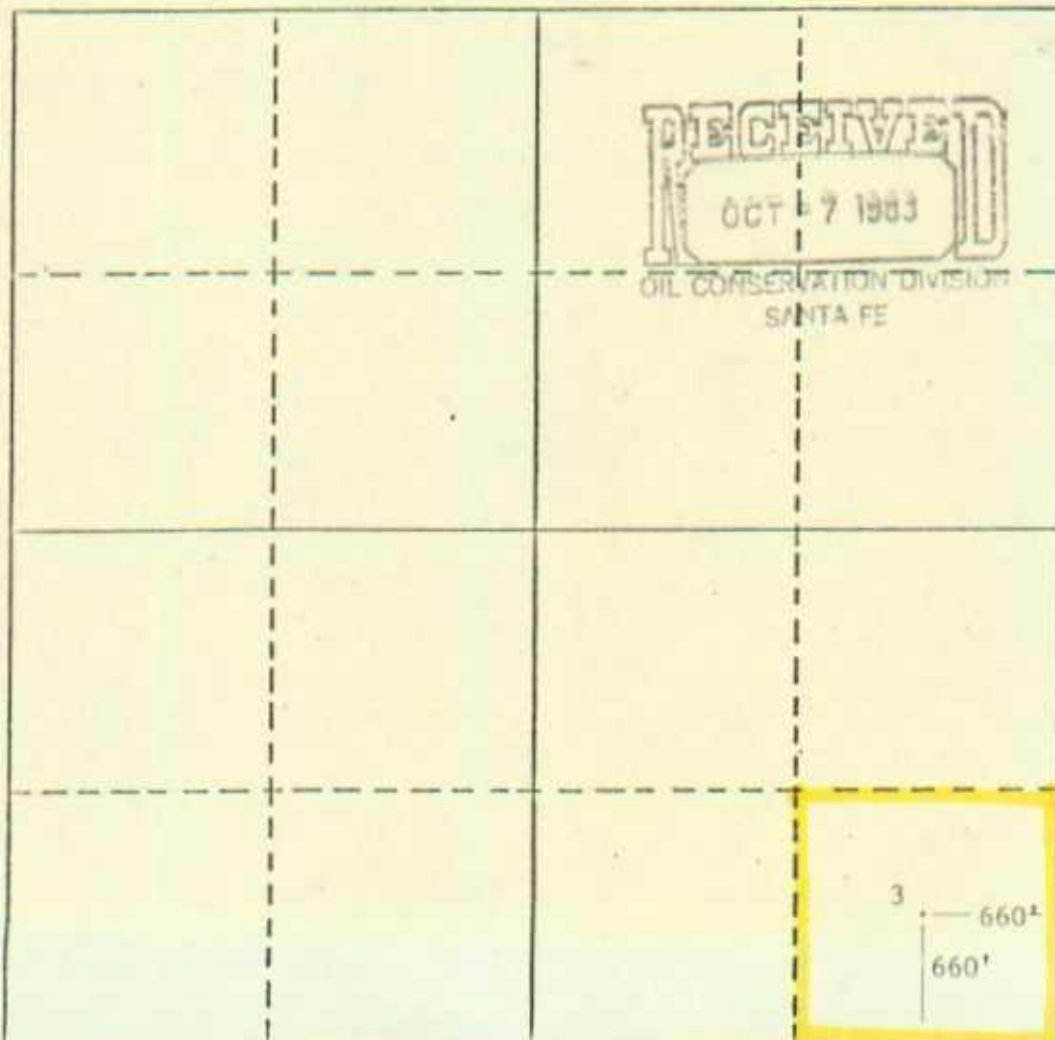

CERTIFICATION

I hereby certify that the information contained herein is true and complete to the best of my knowledge and belief.

Name Thomas F. Zaparka
Position Production Engineer
Company Marathon Oil Company
Date October 3, 1983

I hereby certify that the well location shown on this plat was plotted from field notes of actual surveys made by me or under my supervision, and that the same is true and correct to the best of my knowledge and belief.

Date Surveyed _____

Registered Professional Engineer
and/or Land Surveyor

Certificate No. _____





Marathon Oil Company

L. G. Warlick "C" Lease
 Sec. 15, T-21S, R-37E
 Lea County, New Mexico

Houston Division
Production Operations, United States



**Marathon
Oil Company**

P.O. Box 2409
Hobbs, New Mexico 88240
Telephone 505/393-7106

October 5, 1983

TO WHOM IT MAY CONCERN:

Re: Nonstandard Tubb Gas Proration Unit
L. G. Warlick "C" Lease
Tubb Oil and Gas Pool
Lea County, New Mexico

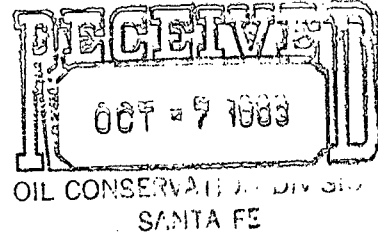

Gentlemen:

Marathon Oil Company has applied to the New Mexico Oil Conservation Division for a nonstandard 80-acre Tubb gas proration unit for our L. G. Warlick "C" Well No. 1, Unit J, Section 15, Township 21-South, Range 37-East, Lea County, New Mexico.

Marathon recently recompleted the L. G. Warlick "C" Well No. 7 in the Tubb oil. This makes the second Tubb oil well on this lease, the other being Well No. 3. On this 160-acre lease, 40 acres are presently dedicated to Well No. 3 and the remaining 120 acres to Well No. 1.

Any objections to this action must be filed with the Director within 30 days of his receipt of our application.

Very truly yours,

A handwritten signature in dark ink, appearing to read 'Thomas F. Zapatka'.

Thomas F. Zapatka
Production Engineer

TFZ:mfm

xc: Flag-Redfern Oil Company
P. O. Box 2280
Midland, Texas 79702

Shell Oil Company
P. O. Box 1509
Midland, Texas 79702

Getty Oil Company
P. O. Box 730
Hobbs, New Mexico 88240

Gulf Oil Expl. & Prod. Co.
P. O. Box 670
Hobbs, New Mexico 88240

P 433 664 856

RECEIPT FOR CERTIFIED MAIL

NO INSURANCE COVERAGE PROVIDED—
NOT FOR INTERNATIONAL MAIL

(See Reverse)

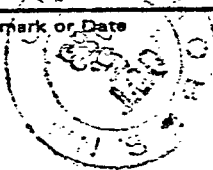
Sent to <i>Shell Oil Co</i>	
Street and No.	
P.O., State and ZIP Code <i>P.O. 1509, Hickory, La 75220</i>	
Postage	\$
Certified Fee	
Special Delivery Fee	
Restricted Delivery Fee	
Return Receipt Showing to whom and Date Delivered	
Return Receipt Showing to whom, Date, and Address of Delivery	
TOTAL Postage and Fees	\$
Postmark or Date 	

PS Form 3800, Feb. 1982

P 433 664 850

RECEIPT FOR CERTIFIED MAIL

NO INSURANCE COVERAGE PROVIDED—
NOT FOR INTERNATIONAL MAIL

(See Reverse)

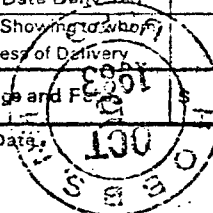
Sent to <i>Flag-Rubber Oil Co</i>	
Street and No.	
P.O., State and ZIP Code <i>P.O. 2280, Hickory, La 75220</i>	
Postage	\$
Certified Fee	
Special Delivery Fee	
Restricted Delivery Fee	
Return Receipt Showing to whom and Date Delivered	
Return Receipt Showing to whom, Date, and Address of Delivery	
TOTAL Postage and Fees	\$
Postmark or Date 	

PS Form 3800, Feb. 1982

P 433 664 849

RECEIPT FOR CERTIFIED MAIL

NO INSURANCE COVERAGE PROVIDED—
NOT FOR INTERNATIONAL MAIL

(See Reverse)

Sent to <i>Gulf Oil Co</i>	
Street and No.	
P.O., State and ZIP Code <i>P.O. 620, Hobbs N.M. 88240</i>	
Postage	\$
Certified Fee	
Special Delivery Fee	
Restricted Delivery Fee	
Return Receipt Showing to whom and Date Delivered	
Return Receipt Showing to whom, Date, and Address of Delivery	
TOTAL Postage and Fees	\$
Postmark or Date 	

PS Form 3800, Feb. 1982

P 497 960 806

RECEIPT FOR CERTIFIED MAIL

NO INSURANCE COVERAGE PROVIDED—
NOT FOR INTERNATIONAL MAIL

(See Reverse)

Sent to <i>Gulf Oil Company</i>	
Street and No.	
P.O., State and ZIP Code <i>P.O. 230, Hobbs N.M. 88240</i>	
Postage	\$
Certified Fee	
Special Delivery Fee	
Restricted Delivery Fee	
Return Receipt Showing to whom and Date Delivered	
Return Receipt Showing to whom, Date, and Address of Delivery	
TOTAL Postage and Fees	\$
Postmark or Date 	

PS Form 3800, Feb. 1982