

Gulf Oil Exploration and Production Company

R. C. Anderson
PRODUCTION MANAGER,
HOBBS AREA

October 26, 1983

P. O. Box 670
Hobbs, NM 88240

Re: Application for a 160-Acre Non-Standard
Gas Proration Unit, Eumont Gas Pool,
Comprising the S/2 of NE/4 and N/2 of SE/4
of Section 29-T20S-R37E

NSP-1408
523

Rule ~~16~~ R-1670

~~SE 1/4 of NE 1/4 of Section 29-T20S-R37E~~

Nov. 30, 1983

Joe D. Ramey
Oil Conservation Division
P. O. Box 2088
Santa Fe, New Mexico 87501

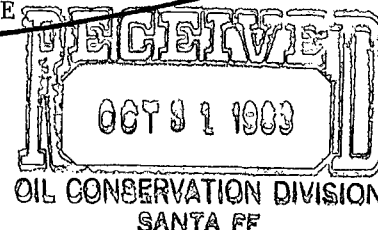

Gentlemen:

Gulf Oil Corporation requests administrative approval for a 160-Acre Non-Standard Gas Proration Unit in the Eumont Gas Pool, comprising the S/2 of NE/4 and N/2 of SE/4 of Section 29-T20S-R37E, Lea County, New Mexico, to be assigned to Gulf's A. B. Reeves #3 well. In support thereof, Gulf Oil Corporation states the following facts:

1. The proposed Non-Standard Gas Proration Unit will meet the requirements of Rule 5(c) of the Oil Conservation Division Order No. R-1670 as follows:
 - a. The proposed Non-Standard 160-Acre Proration Unit consists of less acreage than a standard 640-acre proration unit.
 - b. The Non-Standard Gas 160-Acre Proration Unit consists of contiguous quarter-quarter sections.
 - c. The Non-Standard 160-Acre Proration Unit lies wholly within a single government section in the Eumont Gas Pool with 640-acre standard proration units.
 - d. The entire Non-Standard 160-Acre Gas Proration Unit may be reasonably presumed to be productive of gas from the Eumont Pool.
 - e. The length or width of the Non-Standard Gas Proration Unit does not exceed 5280 feet.
 - f. This letter will serve as notification to all operators owning interest in the section containing the proposed Non-Standard 160-Acre Proration Unit and all operators within 1500 feet of the A. B. Reeves #3 well.



A DIVISION OF GULF OIL CORPORATION

In view of the above facts, Gulf Oil Corporation requests that administrative approval of the subject 160-Acre Non-Standard Proration Unit be granted.

Yours very truly,



R. C. ANDERSON

DCE/skc

cc: Oil Conservation Division
P. O. Box 1980
Hobbs, New Mexico 88240

REGISTERED MAIL - RETURN RECEIPT REQUESTED:

Sun Oil Co.
901 W. Wall
Midland, Texas 79702

NEW MEXICO OIL CONSERVATION COMMISSION
WELL LOCATION AND ACREAGE DEDICATION PLAT

Form C-102
Supersedes C-126
Effective 1-1-65

All distances must be from the outer boundaries of the Section

| | | | | | |
|----------------------------------|------------------------------|----------------------|----------------------|---------------------------------|---------------|
| GULF OIL CORP. | | | Lease A.B. REEVES | | Well No. 3 |
| Tract Letter C | Section 29 | Township 20 SOUTH | Range 37 EAST | County LEA | |
| Actual Footage Location of Well: | | | | | |
| 1980 | feet from the | NORTH | line and | 1980 | feet from the |
| | | | | | EAST |
| Ground Level Elev. 3512.3 | Producing Formation Queen | | Pool Eumont | Dedicated Acreage: 160 Acres | |

- Outline the acreage dedicated to the subject well by colored pencil or hachure marks on the plat below.
- If more than one lease is dedicated to the well, outline each and identify the ownership thereof (both as to working interest and royalty).
- If more than one lease of different ownership is dedicated to the well, have the interests of all owners been consolidated by communitization, unitization, force-pooling, etc?

☐ Yes ☐ No If answer is "yes," type of consolidation _____

If answer is "no," list the owners and tract descriptions which have actually been consolidated. (Use reverse side of this form if necessary.) _____

No allowable will be assigned to the well until all interests have been consolidated (by communitization, unitization, forced-pooling, or otherwise) or until a non-standard unit, eliminating such interests, has been approved by the Commission.

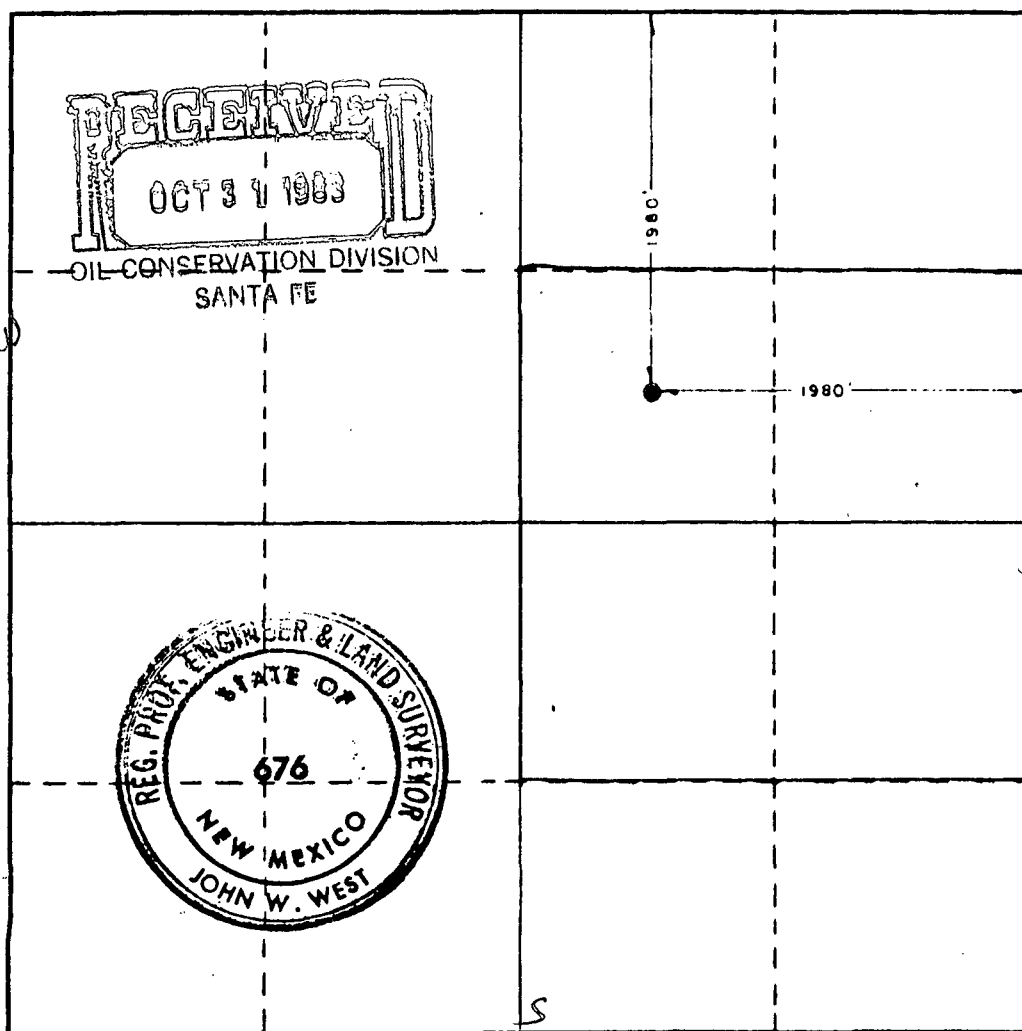

CERTIFICATION

I hereby certify that the information contained herein is true and complete to the best of my knowledge and belief.

R.C. Anderson

Name
R.C. ANDERSON
Position
AREA PROD MGR
Company
GULF OIL CORP
Date
10-19-83

I hereby certify that the well location shown on this plat was plotted from field notes of actual surveys made by me or under my supervision, and that the same is true and correct to the best of my knowledge and belief.

Date Surveyed
OCTOBER 17, 1983
Registered Professional Engineer and/or Land Surveyor

John W. West

Certificate No. JOHN W. WEST, 676
RONALD J. EIDSON, 3239

0 330 660 990 1320 1650 1980 2310 2640 2970 3300 3630 3960 4290 4620 4950 5280 5610 5940 6270 6600

