

By JPP

Gulf Oil Exploration and Production Company

R. C. Anderson
PRODUCTION MANAGER.
HOBBS AREA

January 27, 1984

P. O. Box 670
Hobbs, NM 88240

NSP 1222
ORDER R-6012 RULE 5(C)3
RELEASE IMMEDIATELY
TUBB OIL & GAS POOL

Re: Application for an 80-Acre Non-Standard Gas Proration Unit, Tubb Gas Pool, Comprising the NE/4 of SW/4 & NW/4 of SE/4 of Section 30-T22S-R38E

Joe D. Ramey
Oil Conservation Division
P. O. Box 2088
Santa Fe, New Mexico 87501

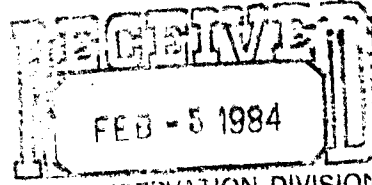

Gentlemen:

FEE ACREAGE SANTA FE

Gulf Oil Corporation requests administrative approval for an 80-Acre Non-Standard Gas Proration Unit in the Tubb Gas Pool, comprising the NE/4 of SW/4 & NW/4 of SE/4 of Section 30-T22S-R38E, Lea County, New Mexico, to be assigned to Gulf's Drinkard B #7 well. In support thereof, Gulf Oil Corporation states the following facts:

1. The proposed Non-Standard Gas Proration Unit will meet the requirements of Rule 5(c) of the Oil Conservation Division Order No. R-1670 as follows:
 - a. The proposed Non-Standard 80-Acre Proration Unit consists of less acreage than a standard 160-acre proration unit.
 - b. The Non-Standard Gas 80-Acre Proration Unit consists of contiguous quarter-quarter sections.
 - c. The Non-Standard 80-Acre Proration Unit lies wholly within a single government section in the Tubb Gas Pool with 160-acre standard proration units.
 - d. The entire Non-Standard 80-Acre Gas Proration Unit may be reasonable presumed to be productive of gas from the Tubb Pool.
 - e. The length or width of the Non-Standard Gas Proration Unit does not exceed 5280 feet.
 - f. This letter will serve as notification to all operators owning interest in the section containing the proposed Non-Standard 80-Acre Proration Unit and all operators within 1500 feet of the Drinkard B #7.



A DIVISION OF GULF OIL CORPORATION

Joe D. Ramey

-2-

1-27-84

In view of the above facts, Gulf Oil Corporation requests that administrative approval of the subject 80-Acre Non-Standard Proration Unit be granted.

Yours very truly,

R. C. ANDERSON

DCE/skc

cc: Oil Conservation Division
P. O. Box 1980
Hobbs, New Mexico 88240

REGISTERED MAIL - RETURN RECEIPT REQUESTED:

Texaco, Inc.
P. O. Box 3109
Midland, Texas 79701

Summit Energy Co.
1925 Mercantile
Dallas Bldg.
Dallas, Texas 75201

NEW MEXICO OIL CONSERVATION COMMISSION
WELL LOCATION AND ACREAGE DEDICATION PLAT

Form C-102
Supersedes C-124
Effective 1-1-65

All distances must be from the outer boundaries of the Section

Operator GULF OIL CORP.		Lease DRINKARD NCT-B		Well No. 7
Unit Letter K	Section 30	Township 22S	Range 38E	County LEA
Actual Footage Location of Well:				
2120 feet from the SOUTH line and 1980 feet from the WEST line				
Ground Level Elev. 3338.2	Producing Formation <i>Jubilee</i>	Pool <i>Jubilee</i>	Estimated Acreage 80	

1. Outline the acreage dedicated to the subject well by colored pencil or hatchure marks on the plat below.
2. If more than one lease is dedicated to the well, outline each and identify the ownership thereof (both as to working interest and royalty).
3. If more than one lease of different ownership is dedicated to the well, have the interests of all owners been consolidated by communitization, unitization, force-pooling, etc?

☐ Yes ☐ No If answer is "yes," type of consolidation _____

If answer is "no," list the owners and tract descriptions which have actually been consolidated. Use reverse side of this form if necessary.) _____

No allowable will be assigned to the well until all interests have been consolidated (by communitization, unitization, forced-pooling, or otherwise) or until a non-standard unit, eliminating such interests, has been approved by the Commission.

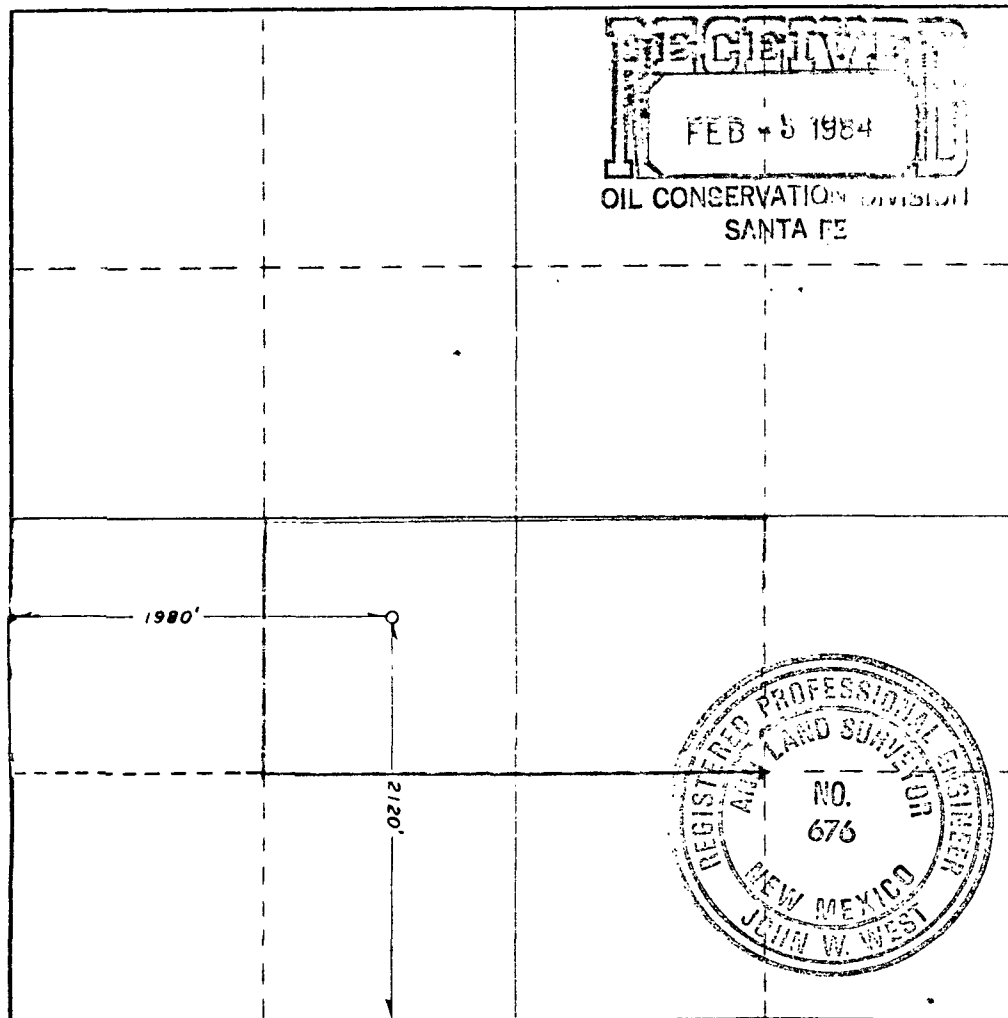
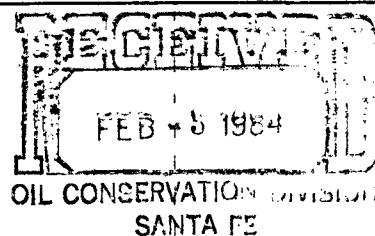

CERTIFICATION

I hereby certify that the information contained herein is true and complete to the best of my knowledge and belief.

L. M. Rychemer
for **R.C. ANDERSON**
AREA PROD MGR
GULF OIL CORP
1-27-84

I hereby certify that the well location shown on this plat was plotted from field notes of actual surveys made by me or under my supervision, and that the same is true and correct to the best of my knowledge and belief.

Date Surveyed

1/24/84

Registered Professional Engineer
and Land Surveyor

John W. West
Certificate No. **JOHN W. WEST, 676**
RONALD J. EIDSON, 3239

0 330 660 990 1320 1650 1980 2310 2640 2970 3300 3630 3960 4290 4620 4950 5280 5610 5940 6270 6600

R 38 E

T 22 S

Texas

New Mexico

