

Release October 14, 1985

By DRC



Chevron U.S.A. Inc.
P.O. Box 670, Hobbs, NM 80240

R. C. Anderson
Division Manager
Hobbs Division
Production Department

NSP-1472
RULE- 5(c)3
R-6012

August 29, 1985

APPLICATION FOR A 160 ACRE NON-STANDARD PRORATION UNIT

Richard Stamets
Oil Conservation Division
P. O. Box 2088
Santa Fe, New Mexico 87501

Gentlemen:

Chevron U.S.A. Inc. respectfully requests administrative approval for a 160 acre Non-Standard Gas Proration Unit in the Tubb Oil and Gas Pool, comprising the NE/4 of NW/4 and N/2 of NE/4 and SE/4 of NE/4 of Section 30-T22S-R38E, Lea County, New Mexico, to be assigned to Chevron's Vivian #1 Well. In support thereof, Chevron U.S.A. Inc. states the following facts:

1. The proposed Non-Standard Gas Proration Unit will meet the requirements of Rule 5(c)3 of the Oil Conservation Division Order No. R-6012 as follows:
 - a. The proposed unit consists of 160 acres.
 - b. The proposed unit consists of contiguous quarter-quarter sections.
 - c. The proposed unit lies wholly within a single government section in the Tubb Oil and Gas Pool.
 - d. The entire proposed unit may reasonably be presumed to be productive of gas from the Tubb Oil and Gas Pool.
 - e. A copy of this application will be sent by certified mail to all offset operators and operators owning interests in the proposed unit's boundary and shall serve as notification.

In support of this application, attached is a plat outlining the proposed Non-Standard Unit, the acreage to be dedicated to the proposed unit, and showing all offset operated properties and wells.

In view of the facts submitted, Chevron U.S.A. Inc. requests that administrative approval of the subject 160 acre Non-Standard Proration Unit be granted.

Yours very truly,

R. C. Anderson
R. C. ANDERSON

MWC/skc
Att'd

cc: OCD-Hobbs

CERTIFIED MAIL - RETURN RECEIPT REQUESTED

Texaco, Inc.
P. O. Box 728
Hobbs, New Mexico 88240

Marathon Oil Co.
P. O. Box 552
Midland, Texas 79702

Summit Energy Co.
1925 Mercantile
Dallas Bldg.
Dallas, Texas 75201

WELL LOCATION AND ACREAGE DEDICATION PLAT

Superseries C-128
Effective 1-1-65

All distances must be from the outer boundaries of the Section.

Operator Chevron U.S.A. Inc.			Lease Vivian		Well No. 1
Unit Letter C	Section 30	Township 22S	Range 38E	County Lea	
Actual Footage Location of Well: <div style="display: flex; justify-content: space-between;"> 660 feet from the North line and 1980 feet from the West line </div>					
Ground Level Elev. 3348'	Producing Formation Tubb	Post Tubb Oil and Gas	Dedicated Acreage: 160 Acres		

1. Outline the acreage dedicated to the subject well by colored pencil or hachure marks on the plat below.
2. If more than one lease is dedicated to the well, outline each and identify the ownership thereof (both as to working interest and royalty).
3. If more than one lease of different ownership is dedicated to the well, have the interests of all owners been consolidated by communitization, unitization, force-pooling, etc?

☐ Yes ☐ No If answer is "yes," type of consolidation _____

If answer is "no," list the owners and tract descriptions which have actually been consolidated. (Use reverse side of this form if necessary.) _____

No allowable will be assigned to the well until all interests have been consolidated (by communitization, unitization, forced-pooling, or otherwise) or until a non-standard unit, eliminating such interests, has been approved by the Commission.

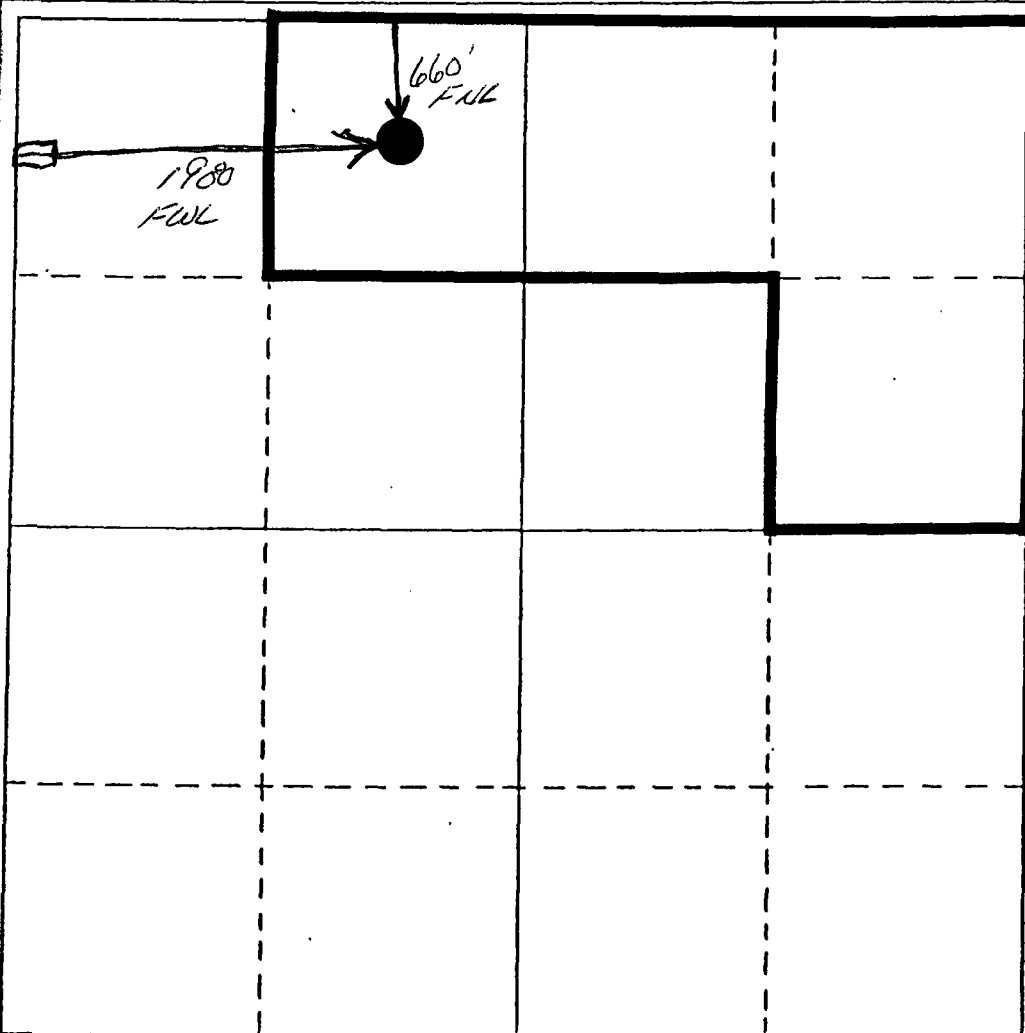

CERTIFICATION

I hereby certify that the information contained herein is true and complete to the best of my knowledge and belief.

R. D. Pitre

Name

R. D. Pitre

Position

Division Petroleum Engineer

Company

Chevron U.S.A. Inc.

Date

August 29, 1985

I hereby certify that the well location shown on this plat was plotted from field notes of actual surveys made by me or under my supervision, and that the same is true and correct to the best of my knowledge and belief.

Date Surveyed

Registered Professional Engineer
and/or Land Surveyor

Certificate No.

