

**BLACKWOOD & NICHOLS CO., LTD.**

P.O. BOX 1237  
DURANGO, COLORADO 81302-1237  
(303) 247-0728

**NORTHWEST PIPELINE  
CORPORATION**

December 21, 1988

DEC 29 1988

**PRODUCTION AND DRILLING**

Northwest Pipeline Corporation  
3539 E. 30th Street  
Farmington, New Mexico 87401

Re: Fruitland Coal Well  
Non-Standard Unit Size  
Non-Standard Location  
NEBU No. 212  
O, Sec. 01, T31N, R7W  
San Juan County, New Mexico

Gentlemen:

Enclosed is a copy of Blackwood & Nichols' application for the referenced exceptions to the Basin Fruitland Coal Pool Rules. Please sign the waiver provided below and return it to the Oil Conservation Division and a copy to this office.

Thank you for your cooperation.

Sincerely,

BLACKWOOD & NICHOLS, CO., LTD.

William F. Clark  
Operations Manager

WFC:lk1

Enclosures

Northwest Pipeline Corporation herewith waives objection to Blackwood & Nichols' Northeast Blanco Unit No. 212 well which is of non-standard size and non-standard quarter section location.

BY Paul C. Thompson

DATE 12/30/88

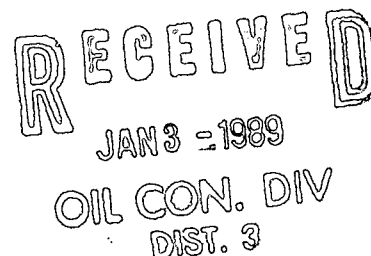

- Appl. received by OCP Santa Fe  
1/9/89

**BLACKWOOD & NICHOLS CO., LTD.**

P.O. BOX 1237  
DURANGO, COLORADO 81302-1237

(303) 247-0728

**NORTHWEST PIPELINE  
CORPORATION**

DEC 29 1988

December 21, 1988

**PRODUCTION AND DRILLING**

New Mexico Oil Conservation Division  
P. O. Box 2088  
Santa Fe, New Mexico 87504

Gentlemen:

In accordance with Order No. R-8768, "Special Rules and Regulations for the Basin-Fruitland Coal Gas Pool", the last section, Blackwood & Nichols Co., Ltd. is filing amended Forms C-102 and C-104 for the Northeast Blanco Unit No. 212 well which was drilled in 1985.

Administrative approval is requested for a non-standard unit size of 181.4 acres and for a non-standard pattern (SE) within the section. Notices to offset operators, Northwest Pipeline and Quinoco (Denver) have been sent.

Your cooperation in this matter is appreciated.

Sincerely,

BLACKWOOD & NICHOLS CO., LTD.

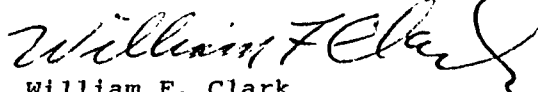

William F. Clark  
Operations Manager

WFC:1kl

Attachments

cc: Aztec District Office ✓

**RECEIVED**  
JAN 3 1989  
OIL CON. DIV.  
DIST. 3

## OIL CONSERVATION DIVISION

STATE OF NEW MEXICO  
ENERGY AND MINERALS DEPARTMENT

P. O. BOX 2088

SANTA FE, NEW MEXICO 87501

Form C-102  
Revised 10-1-78

All distances must be from the outer boundaries of the Section.

Operator BLACKWOOD & NICHOLS CO., LTD.			Lease NORTHEAST BLANCO UNIT		Well No. 212
Init Letter O	Section 01	Township 31N	Range 7W, NMPM	County San Juan	NORTHWEST PIPELINE CORPORATION
Actual Footage Location of Well:					DEC 29 1988
1030	feet from the South	line and	1650	feet from the East	
Ground Level Elev. 6518' UG	Producing Formation Fruitland Coal	Pool Basin Fruitland Coal Gas	Dedicated Acreage: PRODUCTION AND DRILLING		

1. Outline the acreage dedicated to the subject well by colored pencil or hachure marks on the plat below.
2. If more than one lease is dedicated to the well, outline each and identify the ownership thereof (both as to working interest and royalty).
3. If more than one lease of different ownership is dedicated to the well, have the interests of all owners been consolidated by communitization, unitization, force-pooling, etc?

☒ Yes ☐ No If answer is "yes," type of consolidation Unitization

If answer is "no," list the owners and tract descriptions which have actually been consolidated. (Use reverse side of this form if necessary.)

No allowable will be assigned to the well until all interests have been consolidated (by communitization, unitization, forced-pooling, or otherwise) or until a non-standard unit, eliminating such interests, has been approved by the Division.

NOTE: The footage from the South line had to be revised to avoid an archaeological site.

13.53  
12.15  
25.68  
11.09  
36.77  
10.31  
47.08

RECEIVED

JAN 3 - 1989

OIL CON. DIST

13.58  
12.15  
25.73  
11.09  
36.82  
10.31  
47.13

13.58  
12.15  
25.73  
11.09  
36.82  
10.31  
47.23

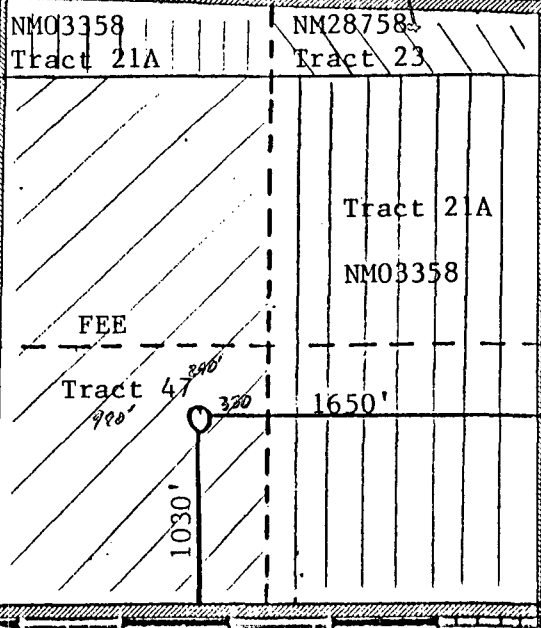

## CERTIFICATION

I hereby certify that the information contained herein is true and complete to the best of my knowledge and belief.

Name

William F. Clark

Position

Operations Manager

Company

Blackwood &amp; Nichols Co., Ltd.

Date

December 21, 1988

I hereby certify that the well location shown on this plat was plotted from field notes of actual surveys made by me or under my supervision, and that the same is true and correct to the best of my knowledge and belief.

Date Surveyed

April 9, 1985

Registered Professional Engineer  
and/or Land Surveyor

Allison L. Kroeger

Certificate No.  
7922

RECEIVED  
JAN 10 1988

STATE OF NEW MEXICO  
ENERGY AND MINERALS DEPARTMENT

Form C-104  
Revised 10-01-78  
Format 08-01-83  
Page 1

OIL CONSERVATION DIVISION

P. O. BOX 2088

SANTA FE, NEW MEXICO 87501

REQUEST FOR ALLOWABLE  
AND  
AUTHORIZATION TO TRANSPORT OIL AND NATURAL GAS

RECEIVED  
DEC 27 1988

NO. OF COPIES RECEIVED	
DISTRIBUTION	
SANTA FE	
FILE	
U.S.G.S.	
LAND OFFICE	
TRANSPORTER	OIL
	GAS
OPERATOR	
PRODUCTION OFFICE	

I. Operator  
Blackwood & Nichols Company, Ltd.

Address  
P. O. Box 1237, Durango, Colorado 81302

Reason(s) for filing (Check proper box)  
☒ New Well  
☐ Recompletion  
☐ Change in Ownership

Change in Transporter of:  
☐ Oil  
☐ Casinghead Gas  
☐ Dry Gas  
☐ Condensate

Other (Please explain)  
Change of Pool Name from S. L. 5  
R-7768  
PROD. FR. JC

If change of ownership give name  
and address of previous owner

II. DESCRIPTION OF WELL AND LEASE

Lease Name Northeast Blanco Unit	Well No. 212	Pool Name, including Formation Basin Fruitland Coal Gas	Kind of Lease State, Federal or Fee Fee/Fed	Lease No. NM03358 NM28758
Location Unit Letter 0 : 1030 Feet From The South Line and 1650 Feet From The East Line of Section 01 Township 31N Range 7W, NMPM, San Juan County				

III. DESIGNATION OF TRANSPORTER OF OIL AND NATURAL GAS

Name of Authorized Transporter of Oil <input type="checkbox"/> or Condensate <input checked="" type="checkbox"/> Giant Industries	Address (Give address to which approved copy of this form is to be sent) P. O. Box 9156, Phoenix, Arizona 85063
Name of Authorized Transporter of Casinghead Gas <input type="checkbox"/> or Dry Gas <input checked="" type="checkbox"/> Northwest Pipeline Corporation	Address (Give address to which approved copy of this form is to be sent) P. O. Box 8900, Salt Lake City, Utah 84108-0900
If well produces oil or liquids, give location of tanks.	Unit Sec. Twp. Rge. Is gas actually connected? When Yes January, 1986

If this production is commingled with that from any other lease or pool, give commingling order number:

NOTE: Complete Parts IV and V on reverse side if necessary.

VI. CERTIFICATE OF COMPLIANCE

I hereby certify that the rules and regulations of the Oil Conservation Division have been complied with and that the information given is true and complete to the best of my knowledge and belief.

William F. Clark  
(Signature)  
Operations Manager  
(Title)  
December 21, 1988  
(Date)

OIL CONSERVATION DIVISION

DEC 27 1988

APPROVED  
BY  
TITLE SUPERVISOR DISTRICT 3

This form is to be filed in compliance with RULE 1104.

If this is a request for allowable for a newly drilled or deepened well, this form must be accompanied by a tabulation of the deviation tests taken on the well in accordance with RULE 1111.

All sections of this form must be filled out completely for allowable on new and recompleted wells.

Fill out only Sections I, II, III, and VI for changes of owner, well name or number, or transporter, or other such change of condition.

Separate Forms C-104 must be filed for each pool in multiply completed wells.

#### IV. COMPLETION DATA

Designate Type of Completion - (X)		Oil Well	Gas Well	New Well	Workover	Deepen	Plug Back	Same Res'v.	Diff. Res'v.
Date Spudded	Date Compl. Ready to Prod.		Total Depth			P.B.T.D.			
Elevations (DF, RKB, RT, GR, etc.)	Name of Producing Formation		Top Oil/Gas Pay			Tubing Depth			
Perforations						Depth Casing Shoe			
<b>TUBING, CASING, AND CEMENTING RECORD</b>									
HOLE SIZE	CASING & TUBING SIZE		DEPTH SET			SACKS CEMENT			

#### V. TEST DATA AND REQUEST FOR ALLOWABLE (Tests must be after recovery of total volume of load oil and must be equal to or exceed top allowable for this depth or be for full 24 hours)

Date First New Oil Run To Tanks	Date of Test	Producing Method (Flow, pump, gas lift, etc.)	
Length of Test	Tubing Pressure	Casing Pressure	Choke Size
Actual Prod. During Test	Oil - Bbls.	Water - Bbls.	Gas - MCF

#### GAS WELL

Actual Prod. Test - MCF/D	Length of Test	Bbls. Condensate/MMCF	Gravity of Condensate
Testing Method (psot, back pr.)	Tubing Pressure (Start-End)	Casing Pressure (Start-End)	Choke Size

All distances must be from the outer boundaries of the Section.

Operator BLACKWOOD & NICHOLS CO., LTD.			Lease NORTHEAST BLANCO UNIT		Well No. 212
Unit Letter 0	Section 01	Township 31N	Range 7W, NMPM	County San Juan	
Actual Footage Location of Well: 1030 feet from the South line and 1650 feet from the East line					
Ground Level Elev. 6518' UG	Producing Formation Fruitland Coal	Pool Basin Fruitland Coal Gas		Dedicated Acreage: 181.4 Acres	

- Outline the acreage dedicated to the subject well by colored pencil or hatchure marks on the plat below.
- If more than one lease is dedicated to the well, outline each and identify the ownership thereof (both as to working interest and royalty).
- If more than one lease of different ownership is dedicated to the well, have the interests of all owners been consolidated by communitization, unitization, force-pooling, etc?

☒ Yes ☐ No If answer is "yes," type of consolidation Unitization

If answer is "no," list the owners and tract descriptions which have actually been consolidated. (Use reverse side of this form if necessary.)

No allowable will be assigned to the well until all interests have been consolidated (by communitization, unitization, forced-pooling, or otherwise) or until a non-standard unit, eliminating such interests, has been approved by the Division.

NOTE: The footage from the South line had to be revised to avoid an archaeological site.

RECEIVED  
DEC 27 1988

OIL CON. DIV  
DIST. 3

JAN 09 1989  
OIL CONSERVATION DIVISION  
SANTA FE

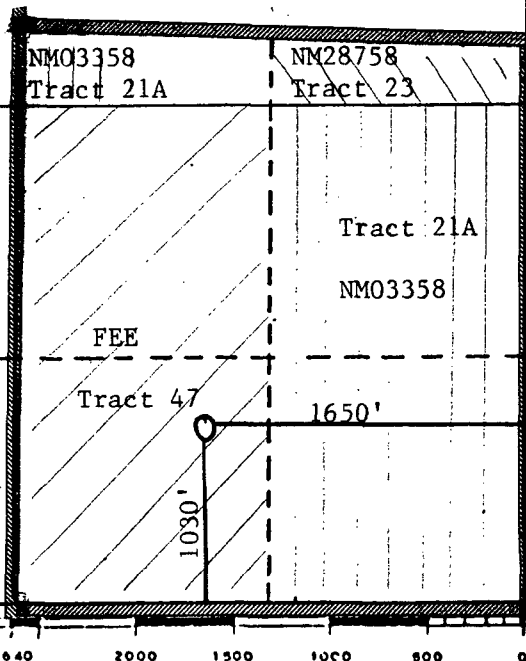

CERTIFICATION

I hereby certify that the information contained herein is true and complete to the best of my knowledge and belief.

*William F. Clark*

Name  
William F. Clark  
Position  
Operations Manager  
Company  
Blackwood & Nichols Co., L  
Date  
December 21, 1988

I hereby certify that the well location shown on this plat was plotted from field notes of actual surveys made by me or under my supervision, and that the same is true and correct to the best of my knowledge and belief.

Date Surveyed  
April 9, 1985  
Registered Professional Engineer  
and/or Land Surveyor

Allison L. Kroeger

Certificate No.  
7922

STATE OF NEW MEXICO  
ENERGY AND MINERALS DEPARTMENT

NO. OF COPIES RECEIVED	
DISTRIBUTION	
SANTA FE	
FILE	
U.S.G.S.	
LAND OFFICE	
TRANSPORTER	OIL
	GAS
OPERATOR	
PERMITS OFFICE	

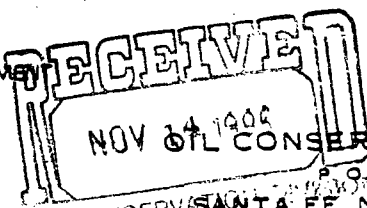

Form C-104  
Revised 10-01-78  
Format 08-01-83  
Page 1

REQUEST FOR ALLOWABLE  
AND  
AUTHORIZATION TO TRANSPORT OIL AND NATURAL GAS

Operator Blackwood & Nichols Company, Ltd.		RECEIVED OCT 08 1985 OIL CON. DIV. DIST. 3
Address P. O. Box 1237, Durango, Colorado 81302		
Reason(s) for filing (Check proper box)		Other (Please explain)
<input checked="" type="checkbox"/> New Well	Change in Transporter of:	
<input type="checkbox"/> Recompletion	<input type="checkbox"/> Oil	<input type="checkbox"/> Dry Gas
<input type="checkbox"/> Change in Ownership	<input type="checkbox"/> Casinghead Gas	<input type="checkbox"/> Condensate

If change of ownership give name  
and address of previous owner \_\_\_\_\_

II. DESCRIPTION OF WELL AND LEASE

Lease Name Northeast Blanco Unit	Well No. 212	Pool Name, including Formation S. Los Pinos-Ft./PC	Kind of Lease State, Federal or Fee	Fee	Lease No.
Location Unit Letter <u>0</u> : <u>1030</u> Feet From The <u>South</u> Line and <u>1650</u> Feet From The <u>East</u> Line of Section <u>1</u> Township <u>31N</u> Range <u>7W</u> , NMPM, <u>San Juan</u> County					

III. DESIGNATION OF TRANSPORTER OF OIL AND NATURAL GAS

Name of Authorized Transporter of Oil <input type="checkbox"/> or Condensate <input checked="" type="checkbox"/>	Address (Give address to which approved copy of this form is to be sent)
Giant Industries	P. O. Box 9156, Phoenix, Arizona 85068
Name of Authorized Transporter of Casinghead Gas <input type="checkbox"/> or Dry Gas <input checked="" type="checkbox"/>	Address (Give address to which approved copy of this form is to be sent)
Northwest Pipeline Corporation	P. O. Box 90, Farmington 87401
If well produces oil or liquids, give location of tanks.	Unit Sec. Twp. Rge. Is gas actually connected? When
	No October, 1985 or May, 198

If this production is commingled with that from any other lease or pool, give commingling order number: \_\_\_\_\_

NOTE: Complete Parts IV and V on reverse side if necessary.

VI. CERTIFICATE OF COMPLIANCE

I hereby certify that the rules and regulations of the Oil Conservation Division have been complied with and that the information given is true and complete to the best of my knowledge and belief.

William F. Clark  
William F. Clark (Signature)  
Petroleum Engineer (Title)  
October 3, 1985 (Date)

11-7-85 OIL CONSERVATION DIVISION  
APPROVED NOV 07 1985  
BY [Signature]  
TITLE SUPERVISOR DISTRICT # 3

This form is to be filed in compliance with RULE 1104.  
If this is a request for allowable (or a newly drilled or deepened well, this form must be accompanied by a tabulation of the deviation tests taken on the well in accordance with RULE 111.  
All sections of this form must be filled out completely for allowable on new and recompleted wells.  
Fill out only Sections I, II, III, and VI for changes of owner, well name or number, or transporter, or other such change of condition.  
Separate Forms C-104 must be filed for each pool in multiply completed wells.

#### IV. COMPLETION DATA

Designate Type of Completion - (X)		Oil Well	Gas Well X	New Well	Workover	Deepen	Plug Back	Same Res'v.	Diff. Res'v.
Date Spudded 6-15-85	Date Compl. Ready to Prod. 8-31-85	Total Depth 3212'			P.B.T.D. 3212'				
Elevations /DF, RKB, RT, GR, etc., 6515' GR	Name of Producing Formation Fruitland/PC	Top Oil/Gas Pay 3184'			Tubing Depth 3181'				
Perforations Open Hole from 3174' to 3212' - 38'						Depth Casing Shoe 3174'			
<b>TUBING, CASING, AND CEMENTING RECORD</b>									
HOLE SIZE		CASING & TUBING SIZE		DEPTH SET		SACKS CEMENT			
12 1/4"		9 5/8" 32.3#		216 230		236 cf			
7 7/8"		4 1/2" 10.5#		3174		1379 cf			
		2 3/8		3181					

#### V. TEST DATA AND REQUEST FOR ALLOWABLE (Test must be after recovery of total volume of load oil and must be equal to or exceed top allowable for this depth or be for full 24 hours)

Date First New Oil Run To Tanks	Date of Test	Producing Method (Flow, pump, gas lift, etc.)	
Length of Test	Tubing Pressure	Casing Pressure	Choke Size
Actual Prod. During Test	Oil - Bbls.	Water - Bbls.	Gas - MCF

#### GAS WELL

Actual Prod. Test - MCF/D 814	Length of Test 3 hours	Bbls. Condensate/MMCF None	Gravity of Condensate
Testing Method (prior, back pr.) A.O.F. - 1786 MCFD	Tubing Pressure (Shut-in) 1410 psig	Casing Pressure (Shut-in) 1510 psig	Choke Size 3/16"



## OIL CONSERVATION DIVISION

P. O. BOX 2088

SANTA FE, NEW MEXICO 87501

## WELL COMPLETION OR RECOMPLETION REPORT AND LOG

NO. OF COPIES RECEIVED	
DISTRIBUTION	
SANTA FE	
FILE	
U.S.G.S.	
LAND OFFICE	
OPERATOR	

5a. Indicate Type of Lease

State ☐Fee ☒

5. State Oil &amp; Gas Lease No.

## 1a. TYPE OF WELL

OIL WELL ☐GAS WELL ☒DRY ☐OTHER ☐

## b. TYPE OF COMPLETION

NEW WELL ☒WORK OVER ☐DEEPEN ☐PLUG BACK ☐DIFF. RESVR. ☐OTHER ☐

## 2. Name of Operator

Blackwood &amp; Nichols Company, Ltd.

## 3. Address of Operator

P.O. Box 1237, Durango, CO 81302

## 4. Location of Well

UNIT LETTER 0 LOCATED 1030 FEET FROM THE South LINE AND 1650 FEET FROMTHE East LINE OF SEC. 1 TWP. 31N RGE. 7W NMPM

## 15. Date Spudded

6-15-85

## 16. Date T.D. Reached

6-21-85

## 17. Date Compl. (Ready to Prod.)

8-31-85

## 18. Elevations (DF, RKB, RT, GR, etc.)

6515' GR

## 19. Elev. Casinghead

6517'

## 20. Total Depth

3212'

## 21. Plug Back T.D.

3212'

## 22. If Multiple Compl., How Many

23. Intervals Drilled By Rotary Tools

0 to T.D.

## Cable Tools

## 24. Producing Interval(s), of this completion - Top, Bottom, Name

Fruitland/Pictured Cliffs 3174' to 3212' Open Hole

## 25. Was Directional Survey Made

Yes

## 26. Type Electric and Other Logs Run

Dual Induction, Density, Neutron, GR

## 27. Was Well Cored

No

## 28. CASING RECORD (Report all strings set in well)

CASING SIZE	WEIGHT LB. FT.	DEPTH SET	HOLE SIZE	CEMENTING RECORD	AMOUNT PULLED
9 5/8"	32.3 H-40	230-216	12 1/4"	236 cf B Neat	Circulated
4 1/2"	10.5 K-55	3174	7 7/8"	1379 cf 50/50 Pozmix	Circulated

## 29. LINER RECORD

SIZE	TOP	BOTTOM	SACKS CEMENT	SCREEN	SIZE	DEPTH SET	PACKER SET
					2.375	3181	

## 30. TUBING RECORD

## 31. Perforation Record (Interval, size and number)

4 1/2" Csg. Shoe at 3174'

7 7/8" Total Depth 3212'

Open Hole 38'

## 32. ACID, SHOT, FRACTURE, CEMENT SQUEEZE, ETC.

DEPTH INTERVAL	AMOUNT AND KIND MATERIAL USED
3174 to 3212	No Stimulation

## 33. PRODUCTION

Date First Production Not Connected		Production Method (Flowing, gas lift, pumping – Size and type pump) Flowing				Well Status (Prod. or Shut-in) Shut In	
Date of Test 9-12-85	Hours Tested 3 hours	Choke Size 3/16	Prod'n. For Test Period →	Oil – Bbl.	Gas – MCF 102	Water – Bbl.	Gas – Oil Ratio
Flow Tubing Press. 960 psig	Casing Pressure 1510 psig	Calculated 24- Hour Rate →	Oil – Bbl.	Gas – MCF 814	Water – Bbl.	Oil Gravity – API (Corr.)	

## 34. Disposition of Gas (Sold, used for fuel, vented, etc.)

To be connected to Northwest Pipeline

## Test Witnessed By

Ron Thompson

## 35. List of Attachments

DST #1, 6-19-85, 3067' - 3209'; Flowed 2,250 MCFD

## 36. I hereby certify that the information shown on both sides of this form is true and complete to the best of my knowledge and belief.

SIGNED

*William F. Clark*  
William F. Clark

TITLE Petroleum Engineer

DATE October 3, 1985

# INSTRUCTIONS

This form is to be filed with the appropriate District Office of the Division not later than 20 days after the completion of any newly-drilled or deepened well. It shall be accompanied by one copy of all electrical and radio-activity logs run on the well and a summary of all special tests conducted, including drill stem tests. All depths reported shall be measured depths. In the case of directionally drilled wells, true vertical depths shall also be reported. For multiple completions, items 30 through 34 shall be reported for each zone. The form is to be filed in quintuplicate except on state land, where six copies are required. See Rule 1105.

## INDICATE FORMATION TOPS IN CONFORMANCE WITH GEOGRAPHICAL SECTION OF STATE

### Southeastern New Mexico

### Northwestern New Mexico

T. Anhy _____	T. Canyon _____	T. Ojo Alamo _____	T. Penn. "B" _____
T. Salt _____	T. Strawn _____	T. Kirtland-Fruitland _____	T. Penn. "C" _____
B. Salt _____	T. Atoka _____	T. Pictured Cliffs _____	T. Penn. "D" _____
T. Yates _____	T. Miss _____	T. Cliff House _____	T. Leadville _____
T. 7 Rivers _____	T. Devonian _____	T. Menefee _____	T. Madison _____
T. Queen _____	T. Silurian _____	T. Point Lookout _____	T. Elbert _____
T. Grayburg _____	T. Montoya _____	T. Mancos _____	T. McCracken _____
T. San Andres _____	T. Simpson _____	T. Gallup _____	T. Ignacio Qtzte _____
T. Glorieta _____	T. McKee _____	Base Greenhorn _____	T. Granite _____
T. Paddock _____	T. Ellenburger _____	T. Dakota _____	T. _____
T. Blinebry _____	T. Gr. Wash _____	T. Morrison _____	T. _____
T. Tubb _____	T. Granite _____	T. Todilto _____	T. _____
T. Drinkard _____	T. Delaware Sand _____	T. Entrada _____	T. _____
T. Abo _____	T. Bone Springs _____	T. Wingate _____	T. _____
T. Wolfcamp _____	T. _____	T. Chinle _____	T. _____
T. Penn. _____	T. _____	T. Permian _____	T. _____
T. Cisco (Bough C) _____	T. _____	T. Penn. "A" _____	T. _____

## OIL OR GAS SANDS OR ZONES

No. 1, from _____ to _____	No. 4, from _____ to _____
No. 2, from _____ to _____	No. 5, from _____ to _____
No. 3, from _____ to _____	No. 6, from _____ to _____

## IMPORTANT WATER SANDS

Include data on rate of water inflow and elevation to which water rose in hole.

No. 1, from _____ to _____ feet	_____
No. 2, from _____ to _____ feet	_____
No. 3, from _____ to _____ feet	_____
No. 4, from _____ to _____ feet	_____

## FORMATION RECORD (Attach additional sheets if necessary)

From	To	Thickness in Feet	Formation	From	To	Thickness in Feet	Formation
1485	2390	905	Animas				
2390	2510	120	Ojo Alamo				
2510	3120	610	Kirtland				
3120			Fruitland				
	3212		Total Depth				

OIL CONSERVATION COMMISSION

1000 Rio Brazos Road

AZTEC, NEW MEXICO 87410

NOTICE OF GAS CONNECTION

DATE January 31, 1986

THIS IS TO NOTIFY THE OIL CONSERVATION COMMISSION THAT CONNECTION FOR THE PURCHASE OF  
GAS FROM THE Blackwood & Nichols  
OPERATOR

NE BLANCO #212 1 31N 7W  
LEASE WELL UNIT S-T-R  
S. LOS PINOS - FRUITLAND / PC NORTHWEST PIPELINE CORPORATION  
POOL NAME OF PURCHASER

WAS MADE ON 1-15-86 , FIRST DELIVERY 1-15-86  
DATE DATE  
386 mcf/D  
INITIAL POTENTIAL

NORTHWEST PIPELINE CORPORATION  
PURCHASER

Ivan R. Lucas  
REPRESENTATIVE

ASSOCIATE CONTRACT ANALYST  
TITLE

cc: OPERATOR  
BLACKWOOD & NICHOLS

P  
045  
GR

FEB 06 1986  
OIL CON. DIV.  
DIST. 3

N. OF COPIES RECEIVED		
DISTRIBUTION		
SANTA FE		
FILE		
U.S.G.S.		
LAND OFFICE		
OPERATOR		

# NEW MEXICO OIL CONSERVATION COMMISSION

Form C-103  
Supersedes Old  
C-102 and C-103  
Effective 1-1-65

API 30-045-26328

## SUNDRY NOTICES AND REPORTS ON WELLS

(DO NOT USE THIS FORM FOR PROPOSALS TO DRILL OR TO DEEPEN OR PLUG BACK TO A DIFFERENT RESERVOIR.  
USE "APPLICATION FOR PERMIT -" (FORM C-101) FOR SUCH PROPOSALS.)

1. OIL WELL <input type="checkbox"/> GAS WELL <input checked="" type="checkbox"/> OTHER- <input type="checkbox"/>		5a. Indicate Type of Lease State <input type="checkbox"/> Fee <input checked="" type="checkbox"/>
2. Name of Operator Blackwood & Nichols Co., Ltd.		5. State Oil & Gas Lease No.
3. Address of Operator P. O. Box 1237, Durango, Colorado 81302		7. Unit Agreement Name NEBU #1, Sec. 929
4. Location of Well UNIT LETTER <u>0</u> , <u>1030</u> FEET FROM THE <u>South</u> LINE AND <u>1650</u> FEET FROM THE <u>West</u> LINE, SECTION <u>1</u> TOWNSHIP <u>31N</u> RANGE <u>7W</u> NMPM.		8. Farm or Lease Name Northeast Blanco Unit
15. Elevation (Show whether DF, RT, GR, etc.) 6518 G.L.		9. Well No. 212
		10. Field and Pool, or Wildcat Los Pinos, S Ft/PC
		12. County San Juan

16. Check Appropriate Box To Indicate Nature of Notice, Report or Other Data

### NOTICE OF INTENTION TO:

PERFORM REMEDIAL WORK <input type="checkbox"/>	PLUG AND ABANDON <input type="checkbox"/>
TEMPORARILY ABANDON <input type="checkbox"/>	CHANGE PLANS <input type="checkbox"/>
PULL OR ALTER CASING <input type="checkbox"/>	OTHER <input type="checkbox"/>

### SUBSEQUENT REPORT OF:

REMEDIAL WORK <input type="checkbox"/>	ALTERING CASING <input type="checkbox"/>
COMMENCE DRILLING OPNS. <input checked="" type="checkbox"/>	PLUG AND ABANDONMENT <input type="checkbox"/>
CASING TEST AND CEMENT JOBS <input checked="" type="checkbox"/>	OTHER <input type="checkbox"/>

17. Describe Proposed or Completed Operations (Clearly state all pertinent details, and give pertinent dates, including estimated date of starting any proposed work) SEE RULE 1103.

- 6-16-85 Spudded well at 11:45 a.m. on 6-15-85; Drilled 234' of 12 1/4" hole with Bit #1; Survey - 1/4° at 234'. Ran 5 jts. 9 5/8" 32.3#, H-40, ST&C Casing (216'); set at 230'; Howco cemented with 200 sacks (236 cf) Class B Neat with 2% CaCl; circulated 10 bbls. of cement. Plug down @7:15 p.m. Waiting on cement 12 hours. Pressure tested casing to 800 psi; held ok.
- 6-21-85 Ran 78 jts. 4 1/2" 10.5#, K-55, ST&C, new Voest Alpine Casing (3164.41'). Set Guide Shoe at 3174' after tagging bottom at 3212'. Circulated hole and then set Howco packer at 3130' with 1400 psi; pumped 20 bbls. of chemical wash; cemented with 985 sacks (1,379 cf) 50/50 Pozmix with 2% gel, 10% salt, 10% Cal Seal, 1/4# flocele per sack and 0.5% Halid 22A; mixed at 6 BPM at 600 psi. Displaced with 50 bbls. of water at 7BPM at 800 psi. Maximum pressure - 1200 at 7 BPM; bumped plug to 1800 psi; circulated out 5 bbls. cement. Plug down at 4:45 p.m. 6-20-85. Set 4 1/2" x 10" Cameron slips. Released rig at 6:00 p.m. 6-20-85.

**RECEIVED**

JUL 12 1985

18. I hereby certify that the information above is true and complete to the best of my knowledge and belief.

**OIL CON. DIV.**  
**DIST. 3**

SIGNED William F. Clark TITLE Petroleum Engineer DATE July 9, 1985

APPROVED BY [Signature] TITLE SUPERVISOR DISTRICT # 3 DATE JUL 12 1985

CONDITIONS OF APPROVAL, IF ANY:



TONEY ANAYA  
GOVERNOR

STATE OF NEW MEXICO  
ENERGY AND MINERALS DEPARTMENT  
OIL CONSERVATION DIVISION  
AZTEC DISTRICT OFFICE

April 24, 1985

1000 RIO BRAZOS ROAD  
AZTEC, NEW MEXICO 87410  
(505) 334-6178

Blackwood & Nichols Co. Ltd.  
P.O. Box 1237  
Durango, Co 83102-1237

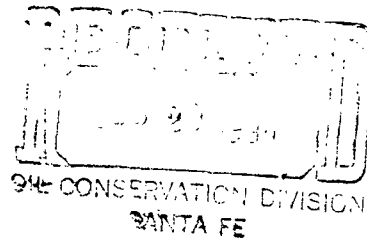

NWU 3- 1034

SUBJECT: NON-STANDARD GAS PRORATION UNIT CONSISTING OF 181.40  
ACRES IN THE South Los Pinos Fruitland Pictured Cliffs GAS  
POOL DESCRIBED AS FOLLOWS:

TOWNSHIP 31 NORTH, RANGE 7 WEST, NMPM

SECTION: 1 E/2

By authority granted me by Rule 5 (B) of Order R-1670, as amended, the above-  
described acreage has been approved as a non-standard gas proration unit to  
be dedicated to the Northeast Blanco Unit  
well no. 212, located 990'FSL and 1650'FEL of said  
Section 1.

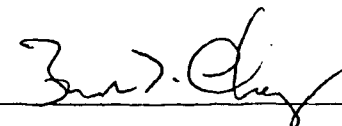
  
Supervisor, District #3

sc: Oil Conservation Division  
Santa Fe, New Mexico

STATE OF NEW MEXICO  
ENERGY AND MINERALS DEPARTMENT

OIL CONSERVATION DIVISION

30-C45-26328

Form C-101  
Revised 10-1-70

NO. OF COPIES DESIRED	
DISTRIBUTION	
SANTA FE	
FILE	
U.S.O.S.	
LAND OFFICE	
OPERATOR	

SANTA FE, NEW MEXICO 87501

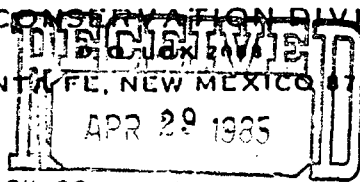

OIL CONSERVATION DIVISION  
SANTA FE

7A. Indicate Type of Lease  
STATE ☐ REC ☒

8. State Oil & Gas Lease No.

APPLICATION FOR PERMIT TO DRILL, DEEPEN, OR PLUG BACK

1a. Type of Work b. Type of Well OIL WELL <input type="checkbox"/> GAS WELL <input type="checkbox"/> OTHER <input type="checkbox"/> SINGLE ZONE <input checked="" type="checkbox"/> MULTIPLE ZONE <input type="checkbox"/>		DRILL <input checked="" type="checkbox"/> DEEPEN <input type="checkbox"/> PLUG BACK <input type="checkbox"/>		7. Unit Agreement Name NEBU Agreement No. 1, Sec.
2. Name of Operator Blackwood & Nichols Co., Ltd.		8. Farm or Lease Name Northeast Blanco Unit		9. Well No. #212
3. Address of Operator P. O. Box 1237, Durango, Colorado 81302		10. Field and Pool, or Wildcat Los Pinos, S. Ft/PC		
4. Location of Well UNIT LETTER <u>0</u> LOCATED <u>990</u> FEET FROM THE <u>South</u> LINE AND <u>1650</u> FEET FROM THE <u>East</u> LINE OF SEC. <u>1</u> TWP. <u>31</u> RGE. <u>7</u> NMPM		12. County San Juan		
1. Elevations (Show whether DF, KI, etc.) 6518' U.G.		21A. Kind & Status Plug. Band	19. Proposed Depth 3718'	19A. Formation Pictured Cliffs
		21B. Drilling Contractor Unknown	20. Rotary or C.T. Rotary	22. Approx. Date Work will start May 15, 1985

23.

PROPOSED CASING AND CEMENT PROGRAM

SIZE OF HOLE	SIZE OF CASING	WEIGHT PER FOOT	SETTING DEPTH	SACKS OF CEMENT	EST. TOP
12 1/4"	9 5/8"	32.3 H-40	200'	200 sxs.	Circulate
7 7/8"	4 1/2"	10.5 K-55	3718'	400 cf	Circulate
				50/50 Pozmix 800 cf Howcolite	

We propose to drill a Fruitland-Pictured Cliffs well to further develop the Northeast Blanco Unit. A low solids mud system with sufficient weight to control the Fruitland Formation will be used to total depth. Well control will be a 10" Series 900 blow out preventer, drilling head and sufficient kill and bleed lines.

This gas is dedicated to El Paso Natural Gas Company.

Attached you will find:

1. C-102
2. Proposed Access Map
3. Drilling Pad Layout
5. Map of area wells

APPROVAL EXPIRES 10-18-85  
UNLESS DRILLING IS COMMENCED.  
SPUD NOTICE MUST BE SUBMITTED  
WITHIN 10 DAYS.

RECEIVED  
APR 18 1985  
OIL CON. DIV.  
DIST. 3

IN ABOVE SPACE DESCRIBE PROPOSED PROGRAM: IF PROPOSAL IS TO DEEPEN OR PLUG BACK, GIVE DATA ON PRESENT PRODUCTIVE ZONE AND PROPOSED NEW PROD TIVE ZONE. GIVE BLOWOUT PREVENTER PROGRAM, IF ANY.

I hereby certify that the information above is true and complete to the best of my knowledge and belief.

Signed William F. Clark Title Petroleum Engineer Date April 16, 1985

(This space for State Use)

SUPERVISOR DISTRICT # 3

APR 18 1985

APPROVED BY [Signature] TITLE \_\_\_\_\_ DATE \_\_\_\_\_  
CONDITIONS OF APPROVAL, IF ANY:

NEW MEXICO OIL CONSERVATION COMMISSION  
WELL LOCATION AND ACREAGE DEDICATION PLAT

Form C-102  
Supersedes C-128  
Effective 1-4-65

All distances must be from the outer boundaries of the Section.

Operator <b>BLACKWOOD &amp; NICHOLS CO., LTD.</b>		Lease <b>NORTHEAST BLANCO UNIT</b>		Well No. <b>212</b>
Unit Letter <b>O</b>	Section <b>1</b>	Township <b>31 N.</b>	Range <b>7W., N.M.P.M.</b>	County <b>SAN JUAN</b>
Actual Footage Location of Well: 990 feet from the south line and 1650 feet from the east line				
Ground Level Elev: <b>6518 (U.G.)</b>	Producing Formation <b>Fruitland</b>	Pool <b>Undesignated Pictured Cliffs</b>	Dedicated Acreage: <b>181.4</b> Acres	

1. Outline the acreage dedicated to the subject well by colored pencil or hachure marks on the plat below.
2. If more than one lease is dedicated to the well, outline each and identify the ownership thereof (both as to working interest and royalty).
3. If more than one lease of different ownership is dedicated to the well, have the interests of all owners been consolidated by communitization, unitization, force-pooling, etc?

☒ Yes ☐ No If answer is "yes," type of consolidation Unitization

If answer is "no," list the owners and tract descriptions which have actually been consolidated. (Use reverse side of this form if necessary.)

No allowable will be assigned to the well until all interests have been consolidated (by communitization, unitization, forced-pooling, or otherwise) or until a non-standard unit, eliminating such interests, has been approved by the Commission.

CERTIFICATION

I hereby certify that the information contained herein is true and complete to the best of my knowledge and belief.

*William F. Clark*  
Name

William F. Clark

Position  
Petroleum Engineer

Company  
Blackwood & Nichols Co.,

Date  
April 16, 1985

I hereby certify that the well location shown on this plat was plotted from field notes of actual surveys made by me or under my supervision, and that the same is true and correct to the best of my knowledge and belief.

Date Surveyed  
April 9, 1985

Registered Professional Engineer and/or Land Surveyor  
*Allison L. Kroeger*  
Allison L. Kroeger

Certificate No.  
7922

RECEIVED  
APR 18 1985  
OIL CON. DIV.  
DIST. 3

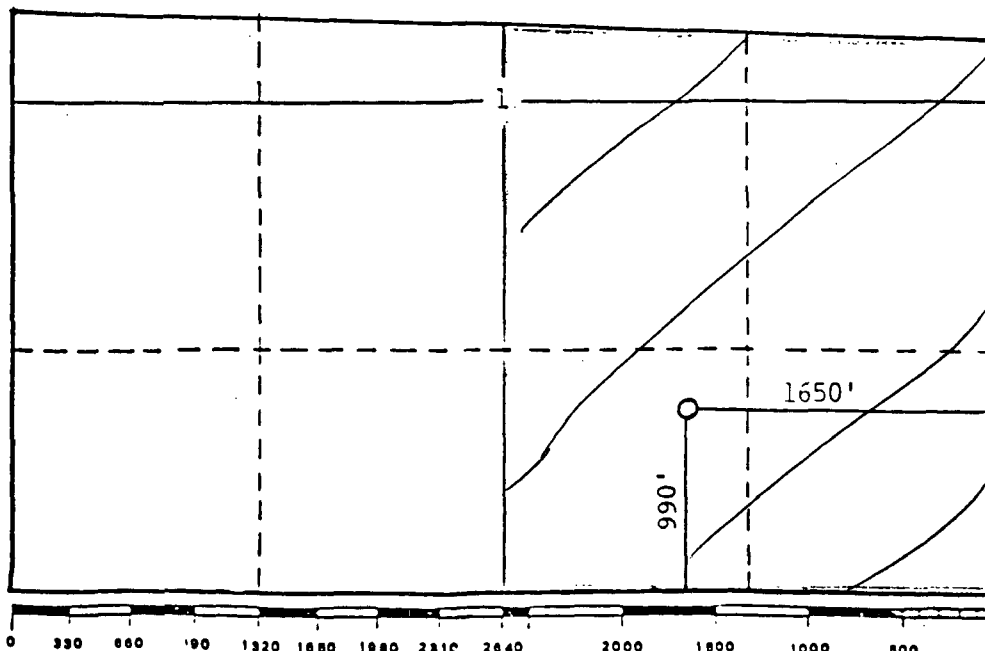

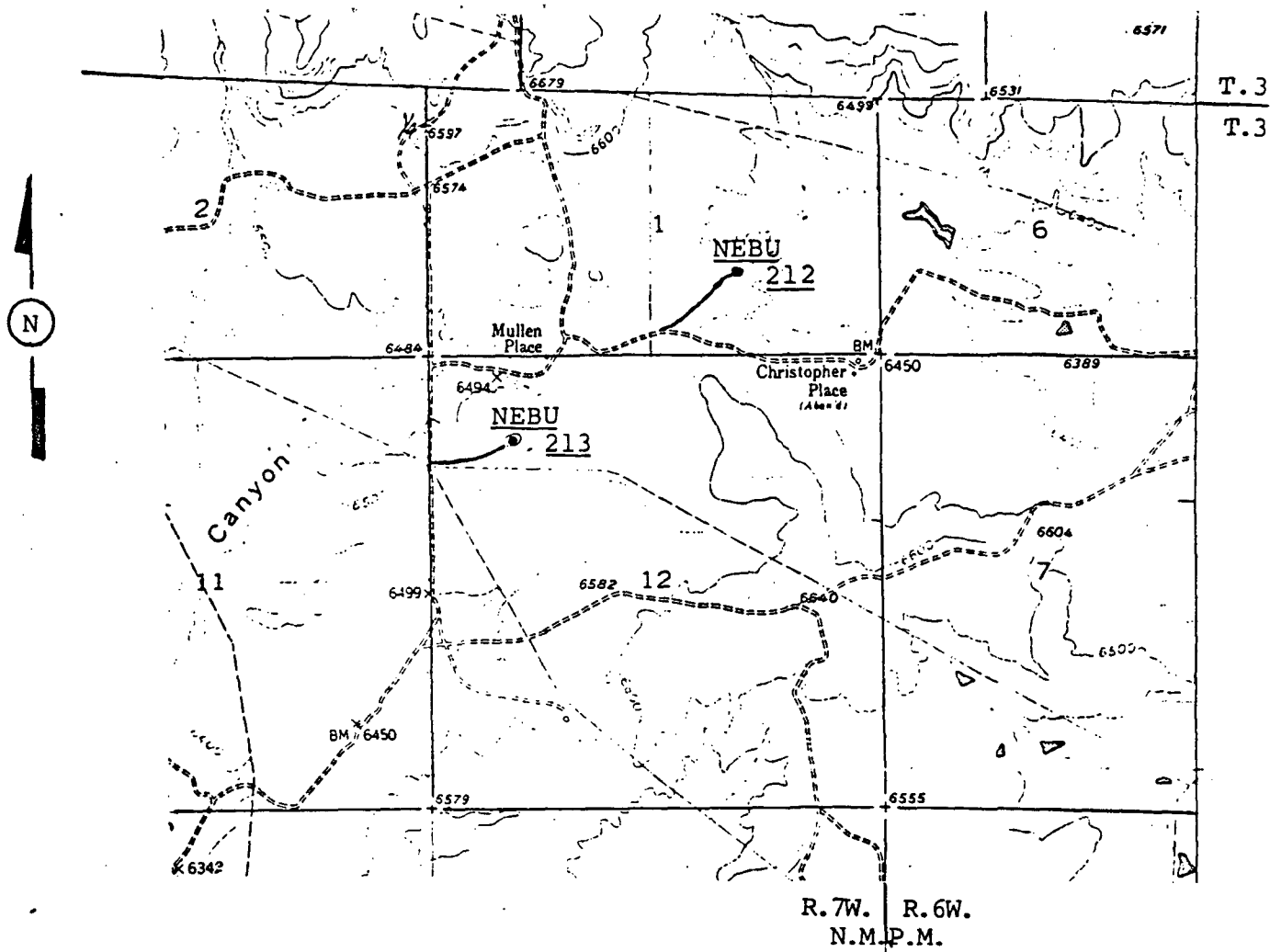

NOTE:

- 1) The total length of Access Road to NEBU 212 is 1,000'±
- 2) The total length of Access Road to NEBU 213 is 1,000'±

**BLACKWOOD & NICHOLS CO., LTD.**

PROPOSED ACCESS ROAD TO NEBU 212 and NEBU 213  
LOCATED IN SEC. 1 & SEC. 12, T.31N., R.7W., N.M.P.M.  
SAN JUAN COUNTY, NEW MEXICO

Date: April, 1985

Scale: 1"=2000'

KROEGER ENGINEERING COMPANY  
DURANGO, COLO.



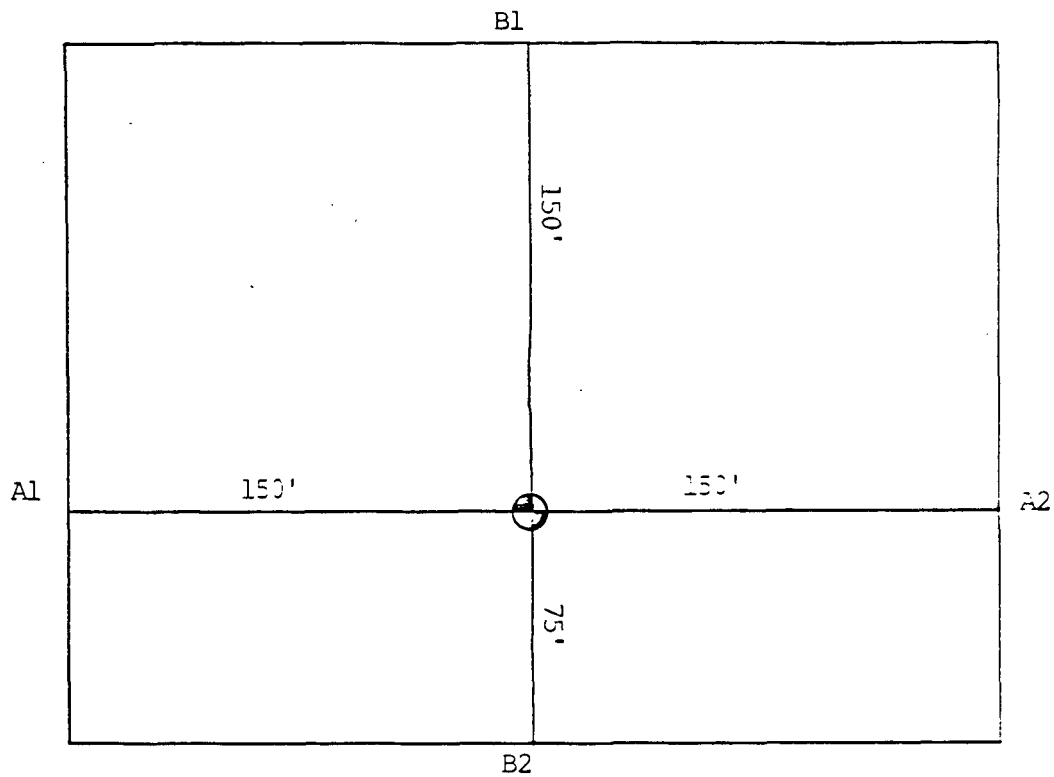

Vertical Scale: 1"=20'

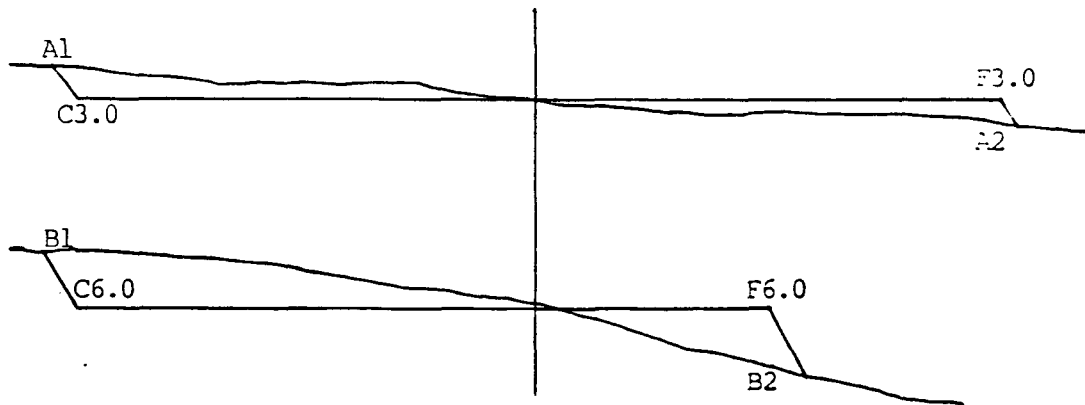

**BLACKWOOD & NICHOLS CO., LTD.**

PROPOSED PAD LAYOUT  
of  
NORTHEAST BLANCO UNIT No. 212

Date: April, 1985 Horiz. Scale: 1"=60'

KROEGER ENGINEERING COMPANY  
DURANGO, COLO.

Blackwood & Nichols Co.  
Northeast Blanco Unit Well #212  
990'S, 1650'East, Sec. 1, T-31N, 7W

**R 7 W**

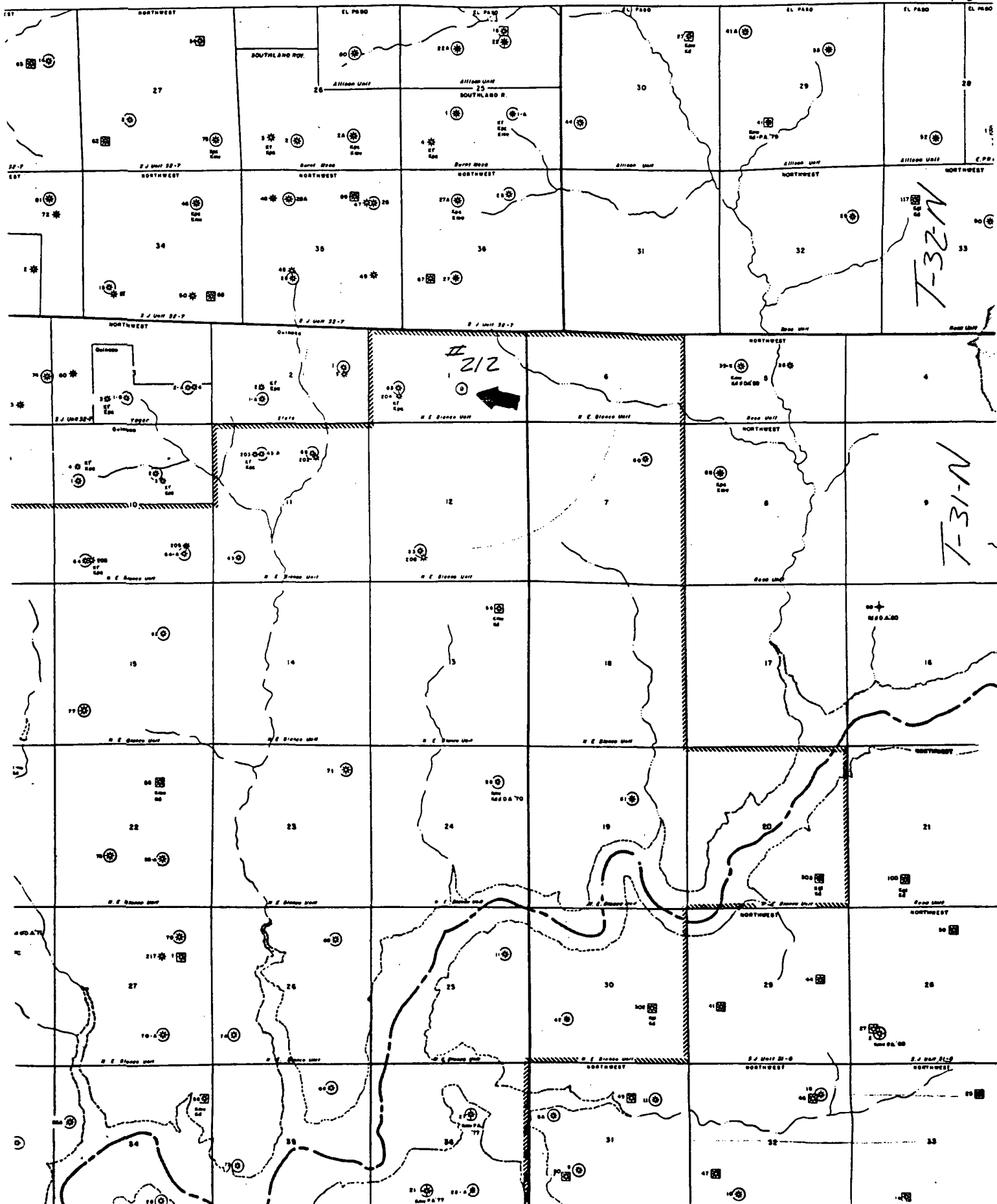

*Amended loc.*

NEW MEXICO OIL CONSERVATION COMMISSION  
WELL LOCATION AND ACREAGE DEDICATION PLAT

Form C-102  
Supersedes C-121  
Effective 1-4-65

All distances must be from the outer boundaries of the Section.

Operator <b>BLACKWOOD &amp; NICHOLS CO., LTD.</b>		Lease <b>NORTHEAST BLANCO UNIT</b>		Well No. <b>212</b>
Unit Letter <b>0</b>	Section <b>1</b>	Township <b>31 N.</b>	Range <b>7W., N.M.P.M.</b>	County <b>SAN JUAN</b>
Actual Footage Location of Wells <b>1030</b> feet from the <b>south</b> line and <b>1650</b> feet from the <b>east</b> line				
Ground Level Elev: <b>6518 (U.G.)</b>	Producing Formation <b>Fruitland</b>		Pool <b>S. Los Pinos Fruitland/PO</b>	Dedicated Acreage <b>181.4</b> Acres

1. Outline the acreage dedicated to the subject well by colored pencil or hachure marks on the plat below.
2. If more than one lease is dedicated to the well, outline each and identify the ownership thereof (both as to working interest and royalty).
3. If more than one lease of different ownership is dedicated to the well, have the interests of all owners been consolidated by communitization, unitization, force-pooling, etc?

☒ Yes ☐ No If answer is "yes," type of consolidation Unitization

If answer is "no," list the owners and tract descriptions which have actually been consolidated. (Use reverse side of this form if necessary.)

No allowable will be assigned to the well until all interests have been consolidated (by communitization, unitization, forced-pooling, or otherwise) or until a non-standard unit, eliminating such interests, has been approved by the Commission.

Note: The footage from the South line had to be revised to avoid an archaeological site.

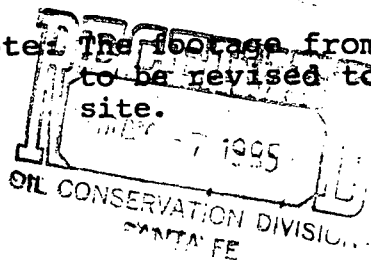

RECEIVED

APR 29 1985

OIL CON. DIV.  
DIST. 3

CERTIFICATION

I hereby certify that the information contained herein is true and complete to the best of my knowledge and belief.

*William F. Clark*

Name

William F. Clark

Position

Petroleum Engineer

Company

Blackwood & Nichols Co.,

Date

April 16, 1985

I hereby certify that the well location shown on this plat was plotted from field notes of actual surveys made by me or under my supervision, and that the same is true and correct to the best of my knowledge and belief.

Date Surveyed

April 9, 1985

Registered Professional Engineer  
and/or Land Surveyor

*Allison L. Kroeger*  
Allison L. Kroeger

Certificate No.

7922

