

| | |
|-----------------------|--|
| NO. OF COPIES DESIRED | |
| DISTRIBUTION | |
| SANTA FE | |
| FILE | |
| U.S.G.A. | |
| LAND OFFICE | |
| TRANSPORTER | |
| OPERATOR | |
| PROMOTION OFFICE | |

OCT - 6 1986

OIL CONSERVATION DIVISION

P. O. BOX 2088

SANTA FE, NEW MEXICO 87501

OIL CONSERVATION DIVISION
SANTA FEREQUEST FOR ALLOWABLE
AND

AUTHORIZATION TO TRANSPORT OIL AND NATURAL GAS

I. OPERATOR

LOBO PRODUCTION

Address c/o Walsh Engineering & Prod. Corp.
P.O. Drawer 419 Farmington, New Mexico 87499

Reason(s) for filing (Check proper box)

☐ New Well ☐ Change in Transporter of:

☐ Recompletion ☐ Oil ☐ Dry Gas

☐ Change in Ownership ☐ Casinghead Gas ☐ Condensate

Other (Please explain)
Change in gas transporter from
Intrastate Gathering to
TexLine Gas Company (TLG)

If change of ownership give name
and address of previous owner

II. DESCRIPTION OF WELL AND LEASE

| | | | | |
|--------------------------------|-----------------|--|---|------------------------|
| Lease Name Mesa Kirtland 11 | Well No. 1 | Pool Name, Including Formation Cha Cha Gallup | Kind of Lease State, Federal or Fee FEE | Lease No. |
| Location | | | | |
| Unit Letter C | 1850 | Feet From The West | Line and 1190 | Feet From The North |
| Line of Section 11 | Township 29N | Range 15W | NMPM, San Juan | County |

III. DESIGNATION OF TRANSPORTER OF OIL AND NATURAL GAS

| | | | | | | |
|--|--|------------|-------------|-------------|-----------------------------------|------|
| Name of Authorized Transporter of Oil <input type="checkbox"/> or Condensate <input type="checkbox"/> Giant Refining Company | Address (Give address to which approved copy of this form is to be sent) P.O. Box 256 Farmington, N.M. 87499 | | | | | |
| Name of Authorized Transporter of Casinghead Gas <input type="checkbox"/> or Dry Gas <input type="checkbox"/> TexLine Gas Company | Address (Give address to which approved copy of this form is to be sent) P.O. Box 1980 Corpus Christi, Tx 78405 | | | | | |
| If well produces oil or liquids, give location of tanks. | Unit C | Sec. 11 | Twp. 29N | Rge. 15W | Is gas actually connected? Yes | When |

If this production is commingled with that from any other lease or pool, give commingling order number

NOTE: Complete Parts IV and V on reverse side if necessary.

VI. CERTIFICATE OF COMPLIANCE

I hereby certify that the rules and regulations of the Oil Conservation Division have been complied with and that the information given is true and complete to the best of my knowledge and belief.

FOR: LOBO PRODUCTION

Ewell N. Walsh, (Signature) President
Walsh Engr. & Prod. Corp.

(Title)

9/30/86

(Date)

OIL CONSERVATION DIVISION

APPROVED

BY

TITLE

This form is to be filed in compliance with RULE 1104.

If this is a request for allowable for a newly drilled or deeper well, this form must be accompanied by a tabulation of the deviate tests taken on the well in accordance with RULE 111.

All sections of this form must be filled out completely for all wells on new and recompleted wells.

Fill out only Sections I, II, III, and VI for changes of owner, well name or number, or transporter, or other such change of condition.

Separate Forms C-104 must be filed for each pool in multiple completed wells.

OCT 01 1986

OIL CONSERVATION DIVISION
SANTA FE, N.M.

IV. COMPLETION DATA

| | | | | | | | | | |
|-------------------------------------|-----------------------------|-----------------|----------|----------|----------|-------------------|-----------|-------------|------|
| Designate Type of Completion -- (X) | | Oil Well | Gas Well | New Well | Workover | Deepen | Plug Back | Same Restv. | DILL |
| Date Spudded | Date Compl. Ready to Prod. | Total Depth | | | | P.B.T.D. | | | |
| Elevations (DF, RKB, RT, GR, etc.) | Name of Producing Formation | Top Oil/Gas Pay | | | | Tubing Depth | | | |
| Particulations | | | | | | Depth Casing Shoe | | | |

TUBING, CASING, AND CEMENTING RECORD

| HOLE SIZE | CASING & TUBING SIZE | DEPTH SET | SACKS CEMENT |
|-----------|----------------------|-----------|--------------|
| | | | |
| | | | |
| | | | |
| | | | |

V. TEST DATA AND REQUEST FOR ALLOWABLE (Test must be after recovery of total volume of load oil and must be equal to or exceed to able for this depth or be for full 24 hours)

| | | | |
|---------------------------------|-----------------|---|------------|
| Date First New Oil Run To Tanks | Date of Test | Producing Method (Flow, pump, gas lift, etc.) | |
| Length of Test | Tubing Pressure | Casing Pressure | Choke Size |
| Actual Prod. During Test | Oil - Bbls. | Water - Bbls. | Gas - MCF |

GAS WELL

| | | | |
|---------------------------------|-----------------------------|-----------------------------|-----------------------|
| Actual Prod. Test - MCF/D | Length of Test | Bbls. Condensate/MCF | Gravity of Condensate |
| Testing Method (flow, back pr.) | Tubing Pressure (Start-End) | Casing Pressure (Start-End) | Choke Size |

OIL CONSERVATION DIVISION

P. O. BOX 2088

SANTA FE, NEW MEXICO 87501

Form C-104
Revised 10-1-78REQUEST FOR ALLOWABLE
AND
AUTHORIZATION TO TRANSPORT OIL AND NATURAL GAS

RECEIVED

MAY 25 1983

OIL CON. DIV.

DIST. 3

| | |
|------------------------|-----|
| NO. OF COPIES RECEIVED | |
| DISTRIBUTION | |
| SANTA FE | |
| FILE | |
| U.S.G.S. | |
| LAND OFFICE | |
| TRANSPORTER | OIL |
| | GAS |
| OPERATOR | |
| PRODUCTION OFFICE | |
| Operator | |

Lobo Production

Address

P.O. Box 2364, Farmington, New Mexico 87499

Reason(s) for filing (Check proper box)

New Well

Recompletion

Change in Ownership

Change in Transporter of:

Oil

Casinghead Gas

Dry Gas

Condensate

Other (Please explain)

Hookup to Gas Line

If change of ownership give name
and address of previous owner

DESCRIPTION OF WELL AND LEASE

| | | | | |
|------------------|----------|----------------------------------|---------------------------|-----------------------|
| Lease Name | Well No. | Pool Name, Including Formation | Kind of Lease | Lease No. |
| Mesa Kirtland-11 | #1 | Cha Cha Gallup | State, Federal or Fee FEE | |
| Location | | | | |
| Unit Letter | C | 1850 Feet From The West Line and | 1190 Feet From The North | |
| Line of Section | 11 | Township 29N | Range 15W | NMPM, San Juan County |

DESIGNATION OF TRANSPORTER OF OIL AND NATURAL GAS

| | | | | | | |
|--|--|------|------|------|----------------------------|--------|
| Name of Authorized Transporter of Oil <input checked="" type="checkbox"/> or Condensate <input type="checkbox"/> | Address (Give address to which approved copy of this form is to be sent) | | | | | |
| Giant Industries | P.O. Box 256, Farmington Highway, Bloomfield | | | | | |
| Name of Authorized Transporter of Casinghead Gas <input checked="" type="checkbox"/> or Dry Gas <input type="checkbox"/> | Address (Give address to which approved copy of this form is to be sent) | | | | | |
| Intrastate Gathering | P.O. Box 32999, San Antonio, Texas | | | | | |
| If well produces oil or liquids, give location of tanks. | Unit | Sec. | Twp. | Rge. | Is gas actually connected? | When |
| | C | 11 | 29N | 15W | Yes | 5-8-83 |

If this production is commingled with that from any other lease or pool, give commingling order number:

COMPLETION DATA

| | | | | | | | | |
|------------------------------------|-----------------------------|-----------------|-------------------|----------|--------|-----------|-------------|--------------|
| Designate Type of Completion - (X) | Oil Well | Gas Well | New Well | Workover | Deepen | Plug Back | Same Res'v. | Diff. Res'v. |
| | X | | X | | | | X | |
| Date Spudded | Date Compl. Ready to Prod. | Total Depth | P.B.T.D. | | | | | |
| 10-13-82 | 12-11-82 | 5173.9'KB | 5140'KB | | | | | |
| Elevations (DE, RKB, RT, GR, etc.) | Name of Producing Formation | Top Oil/Gas Pay | Tubing Depth | | | | | |
| 5157.0Gr. (5169)KB | ! Gallup | 4281' | 4373'KB | | | | | |
| Perforations | 5126-5022 | | Depth Casing Shoe | | | | | |
| 4281-4466 | | | | | | | | |

TUBING, CASING, AND CEMENTING RECORD

| | | | |
|-----------|----------------------|--------------------|-------------------|
| HOLE SIZE | CASING & TUBING SIZE | DEPTH SET | SACKS CEMENT |
| 12 1/4" | 2 3/8" | 4373'KB | 475 sks. |
| 7 7/8" | 8 5/8" 24# | 248'KB | 248 sks. |
| | 5 1/2" 15.50# | 5173.9KB(5164'Gr.) | 265 sks & 50 sks. |

TEST DATA AND REQUEST FOR ALLOWABLE OIL WELL (Test must be after recovery of total volume of load oil and must be equal to or exceed top allowable for this depth or be for full 24 hours)

| | | | |
|---------------------------------|-----------------|---|------------|
| Date First New Oil Run To Tanks | Date of Test | Producing Method (Flow, pump, gas lift, etc.) | |
| 12-3-82 | 1-15-83 | Pumping | |
| Length of Test | Tubing Pressure | Casing Pressure | Choke Size |
| 24 Hours | 30 PSI | 30 PSI | .625 |
| Actual Prod. During Test | Oil - Bbls. | Water - Bbls. | Gas - MCF |
| 21 | 21 | 0 | 47 |

GAS WELL

| | | | |
|----------------------------------|---------------------------|---------------------------|-----------------------|
| Actual Prod. Tests MCF/D | Length of Test | Bbls. Condensate/MMCF | Gravity of Condensate |
| 47MCF | 24 hours | 47 | 2,238:1 |
| Testing Method (pilot, back pr.) | Tubing Pressure (shut-in) | Casing Pressure (shut-in) | Choke Size |
| Back Pr. | 30 PSI | 30 PSI | .625 |

CERTIFICATE OF COMPLIANCE

I hereby certify that the rules and regulations of the Oil Conservation
Division have been complied with and that the information given
above is true and complete to the best of my knowledge and belief.

APPROVED

BY

TITLE

OIL CONSERVATION DIVISION

MAY 25 1983

SUPERVISOR DISTRICT #

This form is to be filed in compliance with RULE 1104.

If this is a request for allowable for a newly drilled or deepened
well, this form must be accompanied by a tabulation of the deviation
tests taken on the well in accordance with RULE 111.All sections of this form must be filled out completely for allow-
able on new and recompleted wells.Fill out only Sections I, II, III, and VI for changes of owner,
well name or number, or transporter, or other such change of condition.Separate Forms C-104 must be filed for each pool in multiply
completed wells.

Operator

(Title)

5-23-83

(Date)

All distances must be from the outer boundaries of the well.

| | | | | | |
|--|---------------------|----------------------------------|--------------------------|---------------------------------------|--|
| Operator R. E. LAURETSEN DRILLING | | Lease (Fee) Mesa - Lobo Prod. | | Well No. 1 | |
| Unit Letter C | Section 11 | Township 29 NORTH | Range 15 WEST | County SAN JUAN | |
| Actual Footage Location of Well: 1190 feet from the NORTH line and 1850 feet from the WEST line | | | | OIL CONSERVATION DIVISION SANTA FE | |
| Ground Level Elev. 5157.0 | Producing Formation | Pool Ch. Ch. Gallup | Dedicated Acreage: 80 | | |

1. Outline the acreage dedicated to the subject well by colored pencil or hatchure marks on the plat below.
2. If more than one lease is dedicated to the well, outline each and identify the ownership thereof (both as to working interest and royalty).
3. If more than one lease of different ownership is dedicated to the well, have the interests of all owners been consolidated by communitization, unitization, force-pooling, etc?

☒ Yes ☐ No If answer is "yes," type of consolidation Force Pooling

If answer is "no," list the owners and tract descriptions which have actually been consolidated. (Use reverse side of this form if necessary.)

No allowable will be assigned to the well until all interests have been consolidated (by communitization, unitization, forced-pooling, or otherwise) or until a non-standard unit, eliminating such interests, has been approved by the Division.

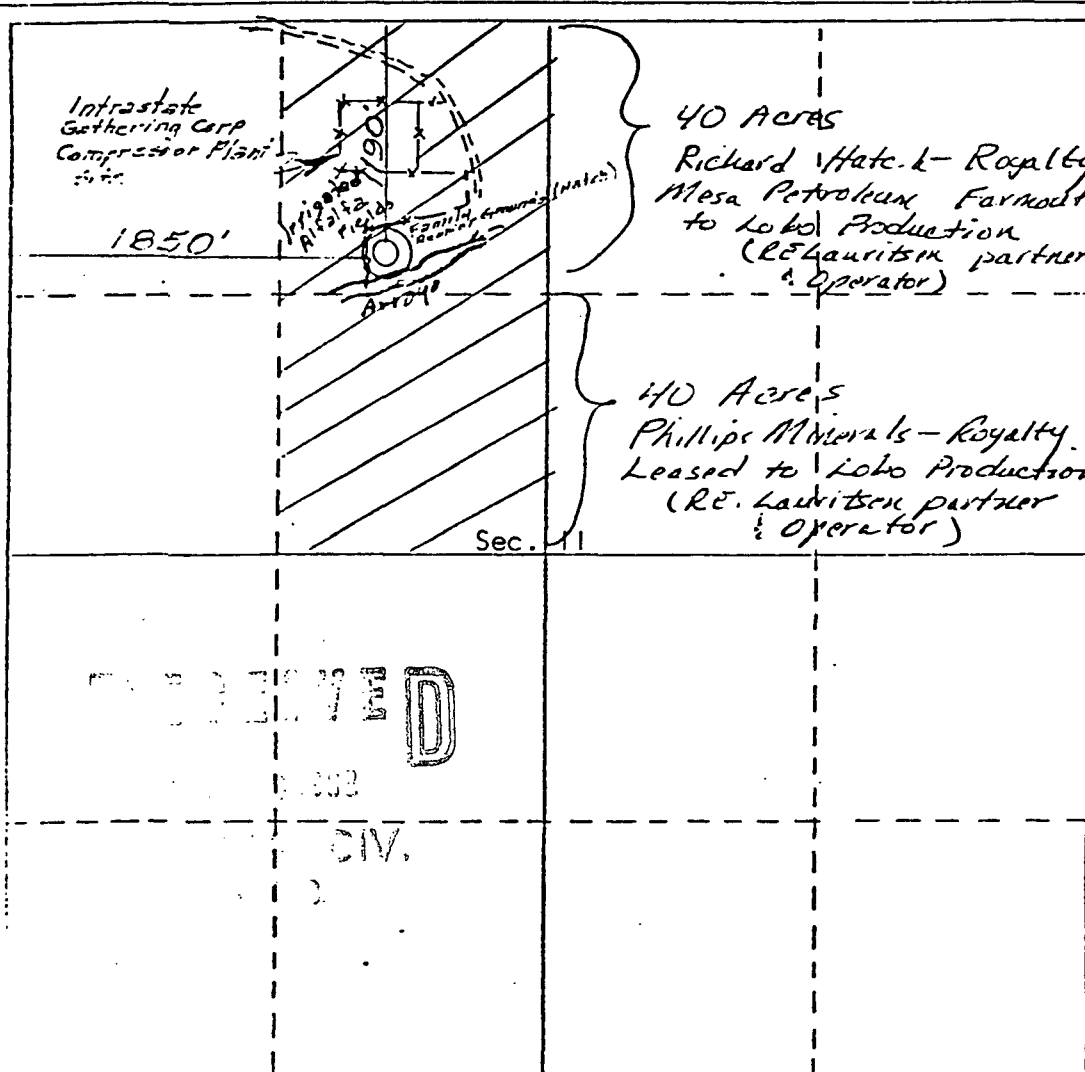

CERTIFICATION

I hereby certify that the information contained herein is true and complete to the best of my knowledge and belief.

R. E. Lauretson

Name

Partner - Operator

Position

Lobo Production

Company

12-27-82

Date

I hereby certify that the well location shown on this plat was plotted from field notes of actual surveys made by me or under my supervision, and that the same is true and correct to the best of my knowledge and belief.

16 AUGUST 1982

Date of Survey
Registered Professional Engineer
and/or Licensed Surveyor

Curtis C. Stocking
ENGINEER

Certificate No.
5980

STATE OF NEW MEXICO
ENERGY AND MINERALS DEPARTMENT

Form C-105
Revised 10-1-78

OIL CONSERVATION DIVISION

P. O. BOX 2088

SANTA FE, NEW MEXICO 87501

WELL COMPLETION OR RECOMPLETION REPORT AND LOG

| | |
|------------------------|--|
| NO. OF COPIES RECEIVED | |
| DISTRIBUTION | |
| SANTA FE | |
| FILE | |
| U.S.G.S. | |
| LAND OFFICE | |
| OPERATOR | |

TYPE OF WELL

OIL WELL ☒ GAS WELL ☐ DRY ☐ OTHER ☐

TYPE OF COMPLETION

NEW WELL ☒ WORK OVER ☐ DEEPEN ☐ PLUG BACK ☐ DIFF. RESVR. ☐ OTHER ☐

Name of Operator

LOBO PRODUCTION

Address of Operator

3005 Northridge, Suite I, Farmington, New Mexico 87401

Location of Well

LETTER C LOCATED 1850 FEET FROM THE West LINE AND 1190 FEET FROM

North LINE OF SEC. 11 TWP. 29N RGE. 15W NMPM

Date Spudded 10-13-82 16. Date T.D. Reached 10-23-82 17. Date Compl. (Ready to Prod.) 12-11-82 18. Elevations (DF, RKB, RT, GR, etc.) 5157.0 Gr. (5169' KB) 19. Elev. Casinghead 5169'

Total Depth 5173.9' KB 21. Plug Back T.D. 5140' KB 22. If Multiple Compl., How Many Rotary 23. Intervals Drilled By Rotary Cable Tools

Producing Interval(s), of this completion - Top, Bottom, Name

4281' - Gallup 5126' - Dakota

Type Electric and Other Logs Run

CCL-GR-CBL

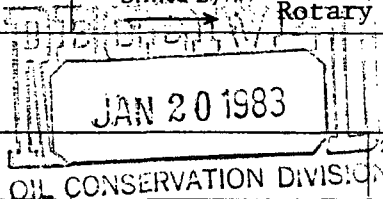

CASING RECORD (Report all strings set in well) SANTA FE

| CASING SIZE | WEIGHT LB./FT. | DEPTH SET | HOLE SIZE | CEMENTING RECORD | AMOUNT PULLED |
|-------------|----------------|-----------|-----------|-----------------------------|-----------------|
| 8 5/8" | 24# | 240' KB | 12 1/4" | 475 sks. | |
| 5 1/2" | 15.50# | 5173.9 KB | 7 7/8" | 248 sks. 50/50 Poz, 2% gel | 6 1/4 Gilsonite |
| | | | | 265 sks. 65/35 Poz, 12% gel | 6 1/4 Gilsonite |
| | | | | 50 sks. cls, B. 2% CaCl. | |

LINER RECORD

| SIZE | TOP | BOTTOM | SACKS CEMENT | SCREEN | SIZE | DEPTH SET | PACKER SET |
|------|-----|--------|--------------|--------|--------|-----------|------------|
| | | | | | 2 3/8" | 4373 KB | |

Perforation Record (Interval, size and number)

4281-82....2 holes 4" 4357-60...3holes 4"
4287-89....3 holes 4" 4372-75...3holes 4"
4296-98....3 holes 4" 4382-85...3holes 4"
4324-30....6 holes 4" 4395-98...3 holes 4"
4346-50....4 holes 4" 4464-66...2 holes 4"

32. ACID, SHOT, FRACTURE, CEMENT SQUEEZE, ETC.

| DEPTH INTERVAL | AMOUNT AND KIND MATERIAL USED |
|----------------|---------------------------------|
| 4281' - 4466' | PAD, 4450 gls. 2/1# gel. |
| | 20/40 sand. Fracced w/2000 gls. |
| | PAD, 5000 gls. @ 1#, 5400 gls |
| | @ 1 1/2# |

PRODUCTION

| | | |
|--|---|--|
| First Production <u>12-3-82</u> | Production Method (Flowing, gas lift, pumping - Size and type pump) <u>Pumping</u> | Well Status (Prod. or Shut-in) <u>Producing</u> |
| of Test <u>12-14-82</u> | Hours Tested <u>24</u> | Choke Size <u>Open</u> |
| Tubing Press. <u>50</u> | Casing Pressure <u>50</u> | Calculated 24-Hour Rate <u>56</u> |
| Oil - Bbl. <u>56</u> | Gas - MCF <u>40</u> | Water - Bbl. <u>1</u> |
| Oil Gravity - API (Corr.) <u>47</u> | Test Witnessed By <u>Dave Simmons</u> | |

Disposition of Gas (Sold, used for fuel, vented, etc.)

Vented (to be connected)

I hereby certify that the information shown on both sides of this form is true and complete to the best of my knowledge and belief.

SIGNED [Signature]

TITLE Operator (Partner)

DATE 1-11-83

This form is to be filed with the appropriate District Office of the Division not later than 20 days after the completion of any newly-drilled or deepened well. It shall be accompanied by one copy of all electrical and radio-activity logs run on the well and a summary of all special tests conducted, including drill stem tests. All depths reported shall be measured depths. In the case of directionally drilled wells, true vertical depths shall also be reported. For multiple completions, items 30 through 34 shall be reported for each zone. The form is to be filed in quintuplicate except on state land, where six copies are required. See Rule 1105.

Southeastern New Mexico

| | | | |
|--------------------------|------------------------|-------------------------------|------------------------|
| T. Anhy _____ | T. Canyon _____ | T. Ojo Alamo _____ | T. Penn. "B" _____ |
| T. Salt _____ | T. Strawn _____ | T. Kirtland-Fruitland _____ | T. Penn. "C" _____ |
| B. Salt _____ | T. Atoka _____ | T. Pictured Cliffs _____ | T. Penn. "D" _____ |
| T. Yates _____ | T. Miss _____ | T. Cliff House _____ 1183 | T. Leadville _____ |
| T. 7 Rivers _____ | T. Devonian _____ | T. Menefee _____ | T. Madison _____ |
| T. Queen _____ | T. Silurian _____ | T. Point Lookout _____ 2730 | T. Elbert _____ |
| T. Grayburg _____ | T. Montoya _____ | T. Mancos _____ 3058 | T. McCracken _____ |
| T. San Andres _____ | T. Simpson _____ | T. Gallup _____ 3970 | T. Ignacio Qtzte _____ |
| T. Glorieta _____ | T. McKee _____ | Base Greenhorn _____ 4822 | T. Granite _____ |
| T. Paddock _____ | T. Ellenburger _____ | T. Dakota Granerso _____ 4938 | T. _____ |
| T. Blinebry _____ | T. Gr. Wash _____ | T. Morrison _____ | T. _____ |
| T. Tubb _____ | T. Granite _____ | T. Todilto _____ | T. _____ |
| T. Drinkard _____ | T. Delaware Sand _____ | T. Entrada _____ | T. _____ |
| T. Abo _____ | T. Bone Springs _____ | T. Wingate _____ | T. _____ |
| T. Wolfcamp _____ | T. _____ | T. Chinle _____ | T. _____ |
| T. Penn. _____ | T. _____ | T. Permian _____ | T. _____ |
| T. Cisco (Bough C) _____ | T. _____ | T. Penn. "A" _____ | T. _____ |

Northwestern New Mexico

OIL OR GAS SANDS OR ZONES

No. 1, from 4281 to 4466 No. 4, from _____ to _____
 No. 2, from _____ to _____ No. 5, from _____ to _____
 No. 3, from _____ to _____ No. 6, from _____ to _____

IMPORTANT WATER SANDS

include data on rate of water inflow and elevation to which water rose in hole.

lo. 1, from.....to.....feet.....

lo. 2, from.....to.....feet.....

lo. 3, from.....to.....feet.....

lo. 4, from.....to.....feet.....

FORMATION RECORD (Attach additional sheets if necessary)

| From | To | Thickness in Feet | Formation | From | To | Thickness in Feet | Formation |
|------|----|----------------------|-----------|------|----|----------------------|-----------|
| | | | | | | | |

2-18-83

OIL CONSERVATION DIVISION
P. O. BOX 2988
SANTA FE, NEW MEXICO 87501

Form C-104
Revised 10-1-78

NSC
R-7706

REQUEST FOR ALLOWABLE
AND
AUTHORIZATION TO TRANSPORT OIL AND NATURAL GAS

I. OPERATOR
Operator
LOBO PRODUCTION, (R.E. Lauritsen & Gary Roberts, Partners)
Address
3005 Northridge, Suite I, Farmington, New Mexico 87401 P.O. Box 2364
Reason(s) for filing (Check proper box)
New Well ☒ Change in Transporter of:
Recompletion ☐ Oil ☐ Dry Gas ☐
Change in Ownership ☐ Casinghead Gas ☐ Condensate ☐
Other (Please explain)
If change of ownership give name and address of previous owner

II. DESCRIPTION OF WELL AND LEASE
Lease Name Mesa Kirtland-11 Well No. #1 Pool Name, Including Formation Cha Cha Gallup Kind of Lease State, Federal or Fee Fee Lease No.
Location
Unit Letter C ; 1850 Feet From The West Line and 1190 Feet From The North
Line of Section 11 Township 29N Range 15 W , NMPM, San Juan County

III. DESIGNATION OF TRANSPORTER OF OIL AND NATURAL GAS
Name of Authorized Transporter of Oil ☒ or Condensate ☐
Giant Industries Address (Give address to which approved copy of this form is to be sent)
P.O. Box 256, Farmington Hwy, Bloomfield, New Mexico
Name of Authorized Transporter of Casinghead Gas ☐ or Dry Gas ☐
IGC Address (Give address to which approved copy of this form is to be sent)
If well produces oil or liquids, give location of tanks. Unit C Sec. 11 Twp. 29N Rge. 15W Is gas actually connected? No When

IV. COMPLETION DATA
Designate Type of Completion - (X) Oil Well X Gas Well New Well X Workover Deepen Plug Back Same Res'v. X Diff. Res'v.
Date Spudded 10-13-82 Date Compl. Ready to Prod. 12-11-82 Total Depth 5173.9' KB (5164 Gr.) P.B.T.D. 5140' KB
Elevations (DF, RKB, RT, GR, etc.) 5157.0 Gr. (5169 RKB) Name of Producing Formation Gallup Top Oil/Gas Pay 4281' Tubing Depth 4373' KB
Perforations 4281-4466 5126-5022 Depth Casing Shoe
TUBING, CASING, AND CEMENTING RECORD
HOLE SIZE CASING & TUBING SIZE DEPTH SET SACKS CEMENT
12 1/4" 2 3/8" 4373' KB
8 5/8" 24# 240'KB 475 sks.
7 7/8" 5 1/2" 15.50# 5173.9 KB(5164 Gr) 248 sks.
265 sks & 50 sks

V. TEST DATA AND REQUEST FOR ALLOWABLE (Test must be after recovery of total volume of load oil and must be equal to or exceed top allowable for this depth or be for full 24 hours)
Date First New Oil Run To Tanks 12-3-82 Date of Test 12-14-82 Producing Method (Flow, pump, gas lift, etc.) Pumping
Length of Test 24 hrs. Tubing Pressure 50 Casing Pressure 50 Choke Size Open
Actual Prod. During Test Oil-Bbls. 56 Water-Bbls. 1 Gas-MCF
80

GAS WELL
Actual Prod. Test-MCF/D Length of Test Bbls. Condensate/MMCF JAN 17 1983
Testing Method (pitot, back pr.) Tubing Pressure (shut-in) Casing Pressure (shut-in) OIL CON. DIV. DIST. 3

VI. CERTIFICATE OF COMPLIANCE
I hereby certify that the rules and regulations of the Oil Conservation Division have been complied with and that the information given above is true and complete to the best of my knowledge and belief.
Operator
(Signature)
(Title)
(Date)

OIL CONSERVATION DIVISION
APPROVED
BY
TITLE
This form is to be filed in compliance with RULE 1104.
If this is a request for allowable for a newly drilled or deepened well, this form must be accompanied by a tabulation of the deviation tests taken on the well in accordance with RULE 111.
All sections of this form must be filled out completely for allowable on new and recompleted wells.
Fill out only Sections I, II, III, and VI for changes of owner, well name or number, or transporter, or other such change of condition.
Form C-104 must be filed for each pool in multiply

| | |
|------------------------|--|
| NO. OF COPIES RECEIVED | |
| DISTRIBUTION | |
| SANTA FE | |
| FILE | |
| U.S.G.S. | |
| LAND OFFICE | |
| OPERATOR | |

OIL CONSERVATION DIVISION
P. O. BOX 1212
SANTA FE, NEW MEXICO 87501

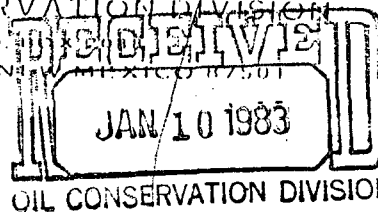

SUNDRY NOTICES AND REPORTS ON WELLS

(DO NOT USE THIS FORM FOR PROPOSALS TO DRILL OR TO DEEPEN OR PLUG BACK TO A DIFFERENT RESERVOIR. USE "APPLICATION FOR PERMIT" (FORM C-101) FOR SUCH PROPOSALS.)

| | | |
|---|-----------------------------------|--------------------------------|
| OIL WELL <input checked="" type="checkbox"/> | GAS WELL <input type="checkbox"/> | OTHER <input type="checkbox"/> |
| Name of Operator LOBO PRODUCTION, (R.E. Lauritsen & Gary Roberts, Partners) | | |
| Address of Operator 3005 Northridge, Suite I, Farmington, New Mex. 87401 | | |
| Location of Well UNIT LETTER <u>C</u> <u>1850</u> FEET FROM THE <u>West</u> LINE AND <u>1190</u> FEET FROM THE <u>North</u> LINE, SECTION <u>11</u> TOWNSHIP <u>29N</u> RANGE <u>15 W</u> | | |
| 15. Elevation (Show whether DF, RT, GR, etc.) 5157.0 Gr. | | |

Check Appropriate Box To Indicate Nature of Notice, Report or Other Data
NOTICE OF INTENTION TO: SUBSEQUENT REPORT

| | | |
|---|---|--|
| INFORM REMEDIAL WORK <input type="checkbox"/> | PLUG AND ABANDON <input type="checkbox"/> | REMEDIAL WORK <input type="checkbox"/> |
| TEMPORARILY ABANDON <input type="checkbox"/> | CHANGE PLANS <input type="checkbox"/> | COMMENCE DRILLING OPER. <input type="checkbox"/> |
| REPAIR OR ALTER CASING <input type="checkbox"/> | OTHER <input type="checkbox"/> | CASING TEST AND CEMENT JOB <input checked="" type="checkbox"/> |

Describe Proposed or Completed Operations (Clearly state all pertinent details, and give pertinent dates, including estimate work) *SEE RULE 1103.

Surface Casing- 8 5/8" at 250' Production Casing- 5 1/2", 15.50 # J55 @

First Stage Cement: 248 Sk. 50/50 Poz., 2% gel, 6 1/4# Gilsonite, 6# s:
4196' Circulation good. Plug Down at 10:30 a.m.

Second Stage : 265 Sk. 65/35 Poz., 12% gel, 6 1/4 # Gilsonite, ta
1710' 50 sks class B w/2% KCL. Plug Down at 2:15 P.M.

Tubing 2 3/8" RTTS @ 4900'. Plugback Total Depth-5130' KB.

Spot 500 gls. 7 1/2 % HCL @ 4460' and perf w/ 4" guns in Gallup:

11-5-82.....Ran 4" casing guns and perf 5126-30, 5075-78', 5044-46', 5
Circulated hole with 1% KCL water. Acidized perforated w/
15% HCL acid. Set packer @ 4986'.

11-8-82.....Swabbed down in 4 runs. checked fluid level. Released pac
pulled out of hole.

11-9-82.....Fraced down casing w/ 15,000 gals. PAD 7,500 gals. @ 1/2#
sand, 7,500 gals. @ 1#, 10,000 gals @ 1 1/2#, 20,000 gals.

I hereby certify that the information above is true and complete to the best of my knowledge and belief.

BY R.E. Lauritsen TITLE Partner DATE _____
BY John J. O'Quinn TITLE SUPERVISOR DATE _____
CONDITIONS OF APPROVAL, IF ANY:

11-15.....Swabbed down to 2200' in 6 runs.. Made total of 22 runs and recovered 113 bbls. Casing pressure 200 psig.

11-16.....Tubing estimated at 30 psig. Fluid level 2100' first run. Made 8 runs. Ran tubing to PBTD and spot 50 sacks Cl. "B" cement w/2% CaCl₂ . Squeezed Dakota Perforations wo 2000 psig. Perforated 4 squeeze holes @ 4396'. Ran RTTS to 3876' and set. 35 sacks CL "h" w/ Halad 9, 35 Sacks Cl. "H" w/ 2% CaCl.

11-17.....Perfed Gallup with 32 holes w/ 1 Shot per foot:

| | |
|---------|---------|
| 4281-82 | 4357-60 |
| 4287-89 | 4372-75 |
| 4296-98 | 4382-85 |
| 4324-30 | 4395-98 |
| 4346-50 | 4464-66 |

Frac down casing @ 52BPM @980 Psig. PAD and 4450 gals w/1#/ gals.20/40 sand and shut down.

Fraced down casing w/ 2000 gals. PAD and 5000 gals @ 1#, 54000 gals. @ 1 1/2#.

11-20.....Swabbed. 32 runs.

11-22.....38 runs.

11-23.....27 runs and swabbed down to 2000'.

11-24.....6 runs and swabbed down to 2000'.

11-26.....14 runs. well shut in.

OIL CONSERVATION DIVISION

P. O. BOX 2000

SANTA FE, NEW MEXICO 87401

Form C-101
Revised 12-1-81

| | |
|------------------------|--|
| NO. OF COPIES RECEIVED | |
| DISTRIBUTION | |
| SANTA FE | |
| FILE | |
| U.S.G.S. | |
| LAND OFFICE | |
| OPERATOR | |

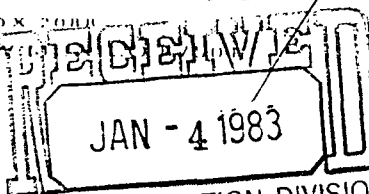

SUNDRY NOTICES AND REPORTS ON WELLS

(DO NOT USE THIS FORM FOR PROPOSALS TO DRILL OR TO DEEPEN OR PLUG BACK TO A DIFFERENT RESERVOIR. USE "APPLICATION FOR PERMIT" (FORM C-101) FOR SUCH PROPOSALS.)

OIL WELL ☒ GAS WELL ☐ OTHER ☐

Name of Operator

LOBO PRODUCTION, (R.E. Lauritsen & Gary Roberts, Partners)

Address of Operator

3005 Northridge, Suite I, Farmington, New Mex. - 87401

Location of Well

UNIT LETTER C 1850 FEET FROM THE West LINE AND 1190 FEET FROM

THE North LINE, SECTION 11 TOWNSHIP 29N RANGE 15 W

15. Elevation (Show whether DF, RT, GR, etc.)

5157.0 Gr.

10. Indicate Type of Lease

State ☐ Fee ☒

11. State Oil & Gas Lease No.

N/A

12. Unit Agreement Date

13. Term of Lease Date

Mesa-Kirtland-11

14. Well No.

#1

15. Field and Pool, or Wildcat Basin Dakota

16. County

San Juan

Check Appropriate Box To Indicate Nature of Notice, Report or Other Data

NOTICE OF INTENTION TO:

PERFORM REMEDIAL WORK ☐PLUG AND ABANDON ☐REMEDIAL WORK ☐TEMPORARILY ABANDON ☐COMMENCE DRILLING WORK ☐REPAIR OR ALTER CASING ☐CHANGE PLANS ☐CASING TEST AND CEMENT JOB ☒OTHER ☐

ALTERING CASING

PLUG AND ABANDONMENT

Describe Proposed or Completed Operations (Clearly state all pertinent details, and give pertinent dates, including estimated date of starting any proposed work) SEE RULE 1103.

Surface Casing- 8 5/8" at 250' Production Casing- 5 1/2", 15.50 # J55 @ 5173.9

First Stage Cement: 248 Sks. 50/50 Poz., 2% gel, 6 1/4# Gilsonite, 6# salt
4196' Circulation good. Plug Down at 10:30 a.m.Second Stage : 265 Sks. 65/35 Poz., 12% gel, 6 1/4 # Gilsonite, tailed with
1710' 50 sks class B w/2% KCL. Plug Down at 2:15 P.M.

Tubing 2 3/8" RTTS @ 4900'. Plugback Total Depth-5130' KB.

Spot 500 gals. 7 1/2 % HCL @ 4460' and perf w/ 4" guns in Gallup:

11-5-82.....Ran 4" casing guns and perf 5126-30, 5075-78', 5044-46', 5012-22',
Circulated hole with 1% KCL water. Acidized perforated w/ 250 gal.
15% HCL acid. Set packer @ 4986'.11-8-82.....Swabbed down in 4 runs. checked fluid level. Released packer and
pulled out of hole.11-9-82.....Frased down casing w/ 15,000 gals. PAD 7,500 gals. @ 1/2# 20/40
sand, 7,500 gals. @ 1#, 10,000 gals @ 1 1/2#, 20,000 gals. @ 2# (cont.)

I hereby certify that the information above is true and complete to the best of my knowledge and belief.

BY R. E. LauritsenTITLE PartnerDATE 11-30-82

APPROVED BY

TITLE

DATE

SIGNATURES OF APPROVAL, IF ANY:

- 11-15.....Swabbed down to 2200' in 6 runs.. Made total of 22 runs and recovered 113 bbls. Casing pressure 200 psig.
- 11-16.....Tubing estimated at 30 psig. Fluid level 2100' first run. Made 8 runs. Ran tubing to PBTD and spot 50 sacks Cl. "B" cement w/2% CaCl₂ . Squeezed Dakota Perforations wo 2000 psig. Perforated 4 squeeze holes @ 4396'. Ran RTTS to 3876' and set. 35 sacks CL "h" w/ Halad 9, 35 Sacks Cl. "H" w/ 2% CaCl.
- 11-17.....Perfed Gallup with 32 holes w/ 1 Shot per foot:
- | | |
|---------|---------|
| 4281-82 | 4357-60 |
| 4287-89 | 4372-75 |
| 4296-98 | 4382-85 |
| 4324-30 | 4395-98 |
| 4346-50 | 4464-66 |
- Frac dwon casing @ 52BPM @980 Psig. PAD and 4450 gals w/1#/ gals.20/40 sand and shut down.
- Fraced down casing w/ 2000 gals. PAD and 5000 gals @ 1#, 54000 gals. @ 1 1/2#.
- 11-20.....Swabbed. 32 runs.
- 11-22.....38 runs.
- 11-23.....27 runs and swabbed down to 2000'.
- 11-24.....6 runs and swabbed down to 2000'.
- 11-26.....14 runs. well shut in.

STATE OF NEW MEXICO
ENERGY AND MINERALS DEPARTMENT

| | |
|------------------------|--|
| NO. OF COPIES RECEIVED | |
| DISTRIBUTION | |
| SANTA FE | |
| FILE | |
| U.S.G.S. | |
| LAND OFFICE | |
| OPERATOR | |

OIL CONSERVATION DIVISION

P. O. BOX 2088
SANTA FE, NEW MEXICO 87501

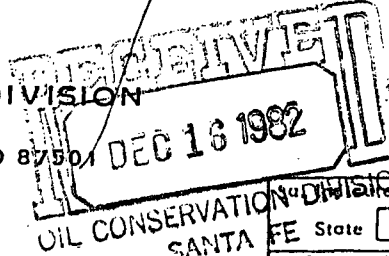

Form C-103
Revised 10-1-

OIL CONSERVATION DIVISION
SANTA FE State ☐ Fee ☒

5. State Oil & Gas Lease No.

N/A

7. Unit Agreement Name

8. Farm or Lease Name

Mesa-Kirtland-11

9. Well No.

#1

10. Field and Pool, or Wildcat

Basin Dakota

15. Elevation (Show whether DF, RT, GR, etc.)

5157.0' Gr. (5169' KB)

12. County

San Juan

Check Appropriate Box To Indicate Nature of Notice, Report or Other Data
NOTICE OF INTENTION TO: SUBSEQUENT REPORT OF:

UNIFORM REMEDIAL WORK ☐

TEMPORARILY ABANDON ☐

WELL OR ALTER CASING ☐

OTHER ☐

PLUG AND ABANDON ☐

CHANGE PLANS ☐

☐

☐

☐

REMEDIAL WORK ☐

COMMENCE DRILLING OPNS. ☐

CASING TEST AND CEMENT JOB ☐

OTHER Surface Casing and Cement ☒

ALTERING CASING ☐

PLUG AND ABANDONMENT ☐

☐

Describe Proposed or Completed Operations (Clearly state all pertinent details, and give pertinent dates, including estimated date of starting any proposed work) *SEE RULE 1103.

Well Spud 2:00 p.m. October 13, 1982. Four Corners Drilling

Drilled 12 1/4 " hole to 240' KB. 8 5/8" 24# @ 240'

Cemented: 475 sks Class "B", 16 sks. CC, 5 sks. Glocele. Circulated to surface.

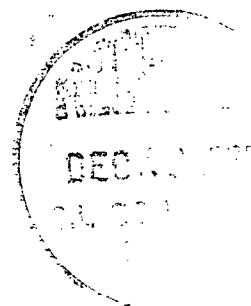

I hereby certify that the information above is true and complete to the best of my knowledge and belief.

WED

R. E. Lauritsen

TITLE

Operator

DATE

12-13-82

APPROVED BY

John J. O'Neil

TITLE

SUPERVISOR

DATE

CONDITIONS OF APPROVAL, IF ANY:

| | |
|------------------------|--|
| NO. OF COPIES RECEIVED | |
| DISTRIBUTION | |
| SANTA FE | |
| FILE | |
| U.S.G.S. | |
| LAND OFFICE | |
| OPERATOR | |

OIL CONSERVATION DIVISION
P. O. BOX 2088
SANTA FE, NEW MEXICO 87501

RECEIVED
DEC 18 1982
OIL CONSERVATION
SANTA FE
corrected copy

Form C-103
Revised 10-1-

5. Indicate Type of Lease
State ☐ Fee ☒
6. State Oil & Gas Lease No.
N/A

SUNDRY NOTICES AND REPORTS ON WELLS
(DO NOT USE THIS FORM FOR PROPOSALS TO DRILL OR TO DEEPEN OR PLUG BACK TO A DIFFERENT RESERVOIR.
USE "APPLICATION FOR PERMIT" (FORM C-101) FOR SUCH PROPOSALS.)

OIL WELL ☒ GAS WELL ☐ OTHER ☐

Name of Operator

LOBO PRODUCTION, (R.E. Lauritsen & Gary Roberts, Partners)

Address of Operator

3005 Northridge, Suite I, Farmington, New Mex. 87401

Location of Well

UNIT LETTER C 1850 FEET FROM THE West LINE AND 1190 FEET FROM

THE North LINE, SECTION 11 TOWNSHIP 29N RANGE 15W N.M.P.M.

7. Unit Agreement Name

8. Farm or Lease Name

Mesa-Kirtland-11

9. Well No.

#1

10. Field and Pool, or Wildcat

Basin Dakota

11. Elevation (Show whether DF, RT, GR, etc.)

5157.0' Gr. (5169' KB)

12. County

San Juan

Check Appropriate Box To Indicate Nature of Notice, Report or Other Data
NOTICE OF INTENTION TO: SUBSEQUENT REPORT OF:

INFORM REMEDIAL WORK ☐

PLUG AND ABANDON ☐

REMEDIAL WORK ☐

ALTERING CASING ☐

TEMPORARILY ABANDON ☐

COMMENCE DRILLING OPNS. ☐

PLUG AND ABANDONMENT ☐

WELL OR ALTER CASING ☐

CHANGE PLANS ☐

CASING TEST AND CEMENT JOBS ☐

OTHER ☐ Correction to Production, Casing, Cement

Describe Proposed or Completed Operations (Clearly state all pertinent details, and give pertinent dates, including estimated date of starting any proposed work) *SEE RULE 1103.

10-23-82.....Drilled 7 7/8" Hole to TD of 5173.9' KB, Ran CCL, GR, CBL
Ran 129 jts 5 1/2" 15.50 # 5173.9' KB. Threads Off.

Cemented in 2 stages: With Halliburton

1st stage: 248 sks. 50/50 Poz. 2% gel. 6 1/4# Gilsonite, 6# Salt to top of 4196'. Circulation good throughout, Plug Down at 10:30 a.m.

2nd stage: 265 sks. 65/35 Poz. , 12% gel, 6 1/4 Gilsonite, tailed with 50 sks. class B w/2% CaCl. Top 1710'. Plug down at 2:15 p.m.

I hereby certify that the information above is true and complete to the best of my knowledge and belief.

WELL 10-23-82

TITLE Operator

DATE 12-13-82

APPROVED BY [Signature]

TITLE [Signature]

DATE [Signature]

CONDITIONS OF APPROVAL, IF ANY:

STATE OF NEW MEXICO
ENERGY AND MINERALS DEPARTMENT

OIL CONSERVATION DIVISION

P. O. BOX 2088
SANTA FE, NEW MEXICO 87501

Form C-103
Revised 10-1-

| | |
|------------------------|--|
| NO. OF COPIES RECEIVED | |
| DISTRIBUTION | |
| SANTA FE | |
| FILE | |
| U.S.G.S. | |
| LAND OFFICE | |
| OPERATOR | |

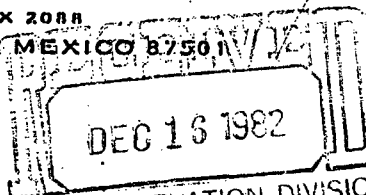

5a. Indicate Type of Lease
State ☐ Fee ☒

5. State Oil & Gas Lease No.

N/A

7. Unit Agreement Name

8. Term of Lease Name

Mesa-Kirtland-11

9. Well No.

#1

10. Field and Pool, or Wildcat

Chaco Basin, Gallup, Dakota

12. County

San Juan

SUNDRY NOTICES AND REPORTS ON WELLS

(DO NOT USE THIS FORM FOR PROPOSALS TO DRILL ON TO DEEPEN OR PLUG BACK TO A DIFFERENT RESERVOIR. USE "APPLICATION FOR PERMIT" (FORM C-101) FOR SUCH PROPOSALS.)

OIL WELL ☒

GAS WELL ☐

OTHER

Name of Operator

LOBO PRODUCTION, (R.E. Lauritsen & Gary Roberts, Partners)

Address of Operator

3005 Northridge, Suite I, Farmington, New Mex. 87401

Location of Well

UNIT LETTER C 1850 FEET FROM THE West LINE AND 1190 FEET FROM

THE North LINE, SECTION 11 TOWNSHIP 29N RANGE 15W NMPM.

15. Elevation (Show whether DF, RT, GR, etc.)

5157.0' Gr. (5169' KB)

Check Appropriate Box To Indicate Nature of Notice, Report or Other Data

NOTICE OF INTENTION TO:

SUBSEQUENT REPORT OF:

PERFORM REMEDIAL WORK ☐

PLUG AND ABANDON ☐

REMEDIAL WORK ☐

ALTERING CASING ☐

TEMPORARILY ABANDON ☐

COMMENCE DRILLING OPNS. ☐

PLUG AND ABANDONMENT ☐

WELL OR ALTER CASING ☐

CHANGE PLANS ☐

CASING TEST AND CEMENT JOBS ☐

OTHER Plug Back from Dakota to Gallup ☐

OTHER

Describe Proposed or Completed Operations (Clearly state all pertinent details, and give pertinent dates, including estimated date of starting any proposed work) SEE RULE 1103.

Operator plans to squeeze Dakota Perforations 5012-5126' w/50 sx Class "B" w/2% CaCl₂ cement, and leave 100' cement above top of Dakota perforations.

I hereby certify that the information above is true and complete to the best of my knowledge and belief.

BY

R. E. Lauritsen

TITLE Operator

DATE 12-8-82

APPROVED BY

Frank J. Dwyer

TITLE

SUPERVISOR DISTRICT

DATE

CONDITIONS OF APPROVAL, IF ANY:

STATE OF NEW MEXICO
ENERGY AND MINERALS DEPARTMENT

| | |
|------------------------|--|
| NO. OF COPIES RECEIVED | |
| DISTRIBUTION | |
| SANTA FE | |
| FILE | |
| U.S.G.S. | |
| LAND OFFICE | |
| OPERATOR | |

OIL CONSERVATION DIVISION

P. O. BOX 2088

SANTA FE, NEW MEXICO 87501

DEC 16 1982

Form C-103
Revised 10-1-7

OIL CONSERVATION DIVISION
SANTA FE

5a. Indicate Type of Lease

State ☐

Fee ☒

5. State Oil & Gas Lease No.

N/A

SUNDRY NOTICES AND REPORTS ON WELLS

(DO NOT USE THIS FORM FOR PROPOSALS TO DRILL OR TO DEEPEN OR PLUG BACK TO A DIFFERENT RESERVOIR.
USE "APPLICATION FOR PERMIT -" (FORM C-101) FOR SUCH PROPOSALS.)

OIL
WELL ☒

GAS
WELL ☐

OTHER-

Name of Operator

LOBO PRODUCTION, (R.E. Lauritsen & Gary Roberts, Partners)

Address of Operator

3005 Northridge, Suite I, Farmington, New Mex. 87401

Location of Well

UNIT LETTER C , 1850 FEET FROM THE West LINE AND 1190 FEET FROM

THE North LINE, SECTION 11 TOWNSHIP 29N RANGE 15W NMPM.

7. Unit Agreement Name

8. Farm or Lease Name

Mesa-Kirtland-11

9. Well No.

#1

10. Field and Pool, or Unit

Chaco Salinas
Basin Dakota

15. Elevation (Show whether DF, RT, GR, etc.)

5157.0' Gr. (5169' KB)

12. County

San Juan

Check Appropriate Box To Indicate Nature of Notice, Report or Other Data

NOTICE OF INTENTION TO:

SUBSEQUENT REPORT OF:

PERFORM REMEDIAL WORK ☐

PLUG AND ABANDON ☐

REMEDIAL WORK ☒

ALTERING CASING ☐

TEMPORARILY ABANDON ☐

COMMENCE DRILLING OPNS. ☐

PLUG AND ABANDONMENT ☐

ILL OR ALTER CASING ☐

CHANGE PLANS ☐

CASING TEST AND CEMENT JOB ☐

OTHER ☐

Describe Proposed or Completed Operations (Clearly state all pertinent details, and give pertinent dates, including estimated date of starting any proposed work) SEE RULE 1103.

11-15-82-----Ran 2 3/8" Tubing to ⁴³⁷³5140'. Spot 50 Sx / Clas "B" w/2%

CaCl₂. Pulled 350' of tubing. Squeezed Dakota Formation

Perforations (5012-5126') to 2000 psig for 30 minutes.

Tagged top cement @ 4912' (200' above top of Dakota Perforation).

I hereby certify that the information above is true and complete to the best of my knowledge and belief.

SIGNED R. E. Lauritsen TITLE Operator

DATE 12-10-82

APPROVED BY

TITLE

DATE

CONDITIONS OF APPROVAL, IF ANY:

STATE OF NEW MEXICO
OIL AND MINERALS DEPARTMENT

IL CONSERVATION DIVISION
P. O. BOX 2088
SANTA FE, NEW MEXICO 87501

Form C-103
Revised 10-1-78

| | |
|------------------------|--|
| NO. OF COPIES RECEIVED | |
| DISTRIBUTION | |
| SANTA FE | |
| FILE | |
| U.S.G.S. | |
| LAND OFFICE | |
| OPERATOR | |

| | |
|-------------------------------------|---|
| 5a. Indicate Type of Lease | |
| State <input type="checkbox"/> | Fee <input checked="" type="checkbox"/> |
| 5. State Oil & Gas Lease No. N/A | |

SUNDRY NOTICES AND REPORTS ON WELLS
(DO NOT USE THIS FORM FOR PROPOSALS TO DRILL OR TO DEEPEN OR PLUG BACK TO A DIFFERENT RESERVOIR.
USE "APPLICATION FOR PERMIT -" (FORM C-101) FOR SUCH PROPOSALS.)

OIL WELL ☒ GAS WELL ☐ OTHER ☐

Name of Operator

LOBO PRODUCTION, (R.E. Lauritsen & Gary Roberts, Partners) Mesa-Kirtland //

Address of Operator

3005 Northridge, Suite I, Farmington, New Mex. 87401

Location of Well

UNIT LETTER C, 1850 FEET FROM THE West LINE AND 1190 FEET FROM

THE North LINE, SECTION 11 TOWNSHIP 29N RANGE 15W NMPM.

7. Unit Agreement Name

8. Farm or Lease Name

9. Well No.

10. Field and Pool, or Wildcat
Wildcat

15. Elevation (Show whether DF, RT, GR, etc.)

5157.0 Gr

12. County
San Juan

Check Appropriate Box To Indicate Nature of Notice, Report or Other Data
NOTICE OF INTENTION TO:

FORM REMEDIAL WORK ☐

TEMPORARILY ABANDON ☐

ON ALTER CASING ☐

OTHER ☐

PLUG AND ABANDON ☐

CHANGE PLANS ☐

OTHER ☐

SUBSEQUENT REPORT OF:

REMEDIAL WORK ☐

COMMENCE DRILLING OPNS. ☐

CASING TEST AND CEMENT JOBS ☐

OTHER ☐

ALTERING CASING ☐

PLUG AND ABANDONMENT ☐

Formation Report ☐

Describe Proposed or Completed Operations (Clearly state all pertinent details, and give pertinent dates, including estimated date of starting any proposed work) *SEE RULE 1103.

| Formation | Estimated Tops Depth | Content |
|------------------------|----------------------|------------------|
| Lewis | 344' | Shale |
| Chacra | 824' | Salt Water |
| Mesa Verde-Cliff House | 1183' | Salt Water |
| Pt. Lookout | 2730' | Salt Water |
| Mancos | 3058' | Salt Water |
| Gallup | 3970' | Shale&Sand T/Gas |
| Lower Gallup | 4277' | Gas & Oil |
| Greenhorn | 4822' | Limestone |
| Graneros | 4938' | Salt Water T/Gas |
| Dakota | 4977' | Sand&Shale T/Gas |

Oct. 23, 1982-----TD @ 5164'

Dual Induction and Compensated Density Neutron Logs Run

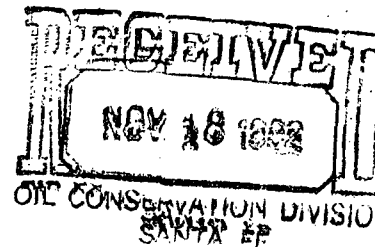

I hereby certify that the information above is true and complete to the best of my knowledge and belief.

R. E. Lauritsen TITLE Operator DATE 11-3-82

Frank D. Dwyer TITLE DATE

CONDITIONS OF APPROVAL, IF ANY:

OIL CONSERVATION DIVISION
P. O. BOX 2088
SANTA FE, NEW MEXICO 87501

Form C-103
Revised 10-1-78

| | |
|------------------------|--|
| NO. OF COPIES RECEIVED | |
| DISTRIBUTION | |
| SANTA FE | |
| FILE | |
| U.S.G.S. | |
| LAND OFFICE | |
| OPERATOR | |

5a. Indicate Type of Lease
State ☐ Fee ☒
5. State Oil & Gas Lease No.
N/A

SUNDRY NOTICES AND REPORTS ON WELLS
(DO NOT USE THIS FORM FOR PROPOSALS TO DRILL ON TO DEEPEN OR PLUG BACK TO A DIFFERENT RESERVOIR.
USE "APPLICATION FOR PERMIT -" (FORM C-101) FOR SUCH PROPOSALS.)

OIL WELL ☒ GAS WELL ☐ OTHER ☐

Name of Operator
LOBO PRODUCTION, (R.E. Lauritsen & Gary Roberts, Partners)

Address of Operator
3005 Northridge, Suite I, Farmington, New Mex. 87401

Location of Well
UNIT LETTER C 1850 FEET FROM THE West LINE AND 1190 FEET FROM

THE North LINE, SECTION 11 TOWNSHIP 29N RANGE 15 W. NMPM.

15. Elevation (Show whether DF, RT, GR, etc.)
5157.0 Gr.

7. Unit Agreement Name

8. Farm or Lease Name
Mesa-Kirtland //

9. Well No.
1-02

10. Field and Pool, or Wildcat
Wildcat

12. County
San Juan

Check Appropriate Box To Indicate Nature of Notice, Report or Other Data
NOTICE OF INTENTION TO: SUBSEQUENT REPORT OF:

FORM REMEDIAL WORK ☐
TEMPORARILY ABANDON ☐
OR ALTER CASING ☐
OTHER ☐

PLUG AND ABANDON ☐
CHANGE PLANS ☐

REMEDIAL WORK ☐
COMMENCE DRILLING OPNS. ☐
CASING TEST AND CEMENT JOB ☒
OTHER ☐

ALTERING CASING ☐
PLUG AND ABANDONMENT ☐

Describe Proposed or Completed Operations (Clearly state all pertinent details, and give pertinent dates, including estimated date of starting any proposed work) SEE RULE 1103.

10-23-82-----129 jts.- 5½ ", 15.50 , V-55, STC 8 Rd, 5173.9 ' Threads Off

Insert Float @ 5133' - DV Tool @ 3204'
Cemented with Halliburton in 2 stages:

248 Sks. 50/50 Poz., 2% Gel, 6½ # Gilsonite, 6# Salt
Circulation good throughout, Plug Down at 10:30 a.m.

265 Sks. 65/35 Poz., 12% Gel, 6½ # Gilsonite, tailed with 50 sks.
Class B w/2% CaCl.
Plug down at 2:15 ;.m. Bump Plug-Float held

Set slips and cut off casing

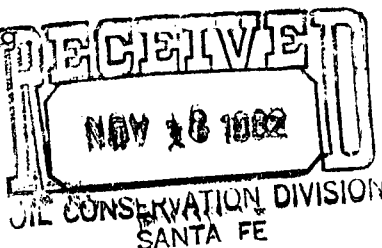

I hereby certify that the information above is true and complete to the best of my knowledge and belief.

Signature: R. E. Lauritsen TITLE Operator DATE 11-3-82

APPROVED BY: TITLE: DATE:

REMARKS OF APPROVAL, IF ANY:

OIL CONSERVATION DIVISION
P. O. BOX 2088
SANTA FE, NEW MEXICO 87501

Form C-103
Revised 10-1-78

| | | |
|------------------------|--|--|
| NO. OF COPIES RECEIVED | | |
| DISTRIBUTION | | |
| SANTA FE | | |
| FILE | | |
| U.S.G.S. | | |
| LAND OFFICE | | |
| OPERATOR | | |

| | |
|-------------------------------------|---|
| 5a. Indicate Type of Lease | |
| State <input type="checkbox"/> | Fee <input checked="" type="checkbox"/> |
| 5. State Oil & Gas Lease No. N/A | |

SUNDRY NOTICES AND REPORTS ON WELLS

(DO NOT USE THIS FORM FOR PROPOSALS TO DRILL OR TO DEEPEN OR PLUG BACK TO A DIFFERENT RESERVOIR.
USE "APPLICATION FOR PERMIT" (FORM C-101) FOR SUCH PROPOSALS.)

OIL WELL ☒ GAS WELL ☐ OTHER ☐

Name of Operator

LOBO PRODUCTION, (R.E. Lauritsen & Gary Roberts, Partners)

Address of Operator

P.O. Box 2364 3005 Northridge, Suite I, Farmington, New Mex

Location of Well

87401

UNIT LETTER C, 1850 FEET FROM THE West LINE AND 1190 FEET FROM

THE North LINE, SECTION 11 TOWNSHIP 29N RANGE 15W NMPM.

15. Elevation (Show whether DF, RT, GR, etc.)

12. County
San Juan

Check Appropriate Box To Indicate Nature of Notice, Report or Other Data
NOTICE OF INTENTION TO:

FORM REMEDIAL WORK ☐
PROBABLY ABANDON ☐
OR ALTER CASING ☐

PLUG AND ABANDON ☐
CHANGE PLANS ☐

OTHER ☐

SUBSEQUENT REPORT OF:

REMEDIAL WORK ☐
COMMENCE DRILLING OPNS. ☐
CASING TEST AND CEMENT JOB ☐

ALTERING CASING ☐
PLUG AND ABANDONMENT ☐

OTHER Change Name of Operator and Well ☒
Designation to Oil Well

Describe Proposed or Completed Operations (Clearly state all pertinent details, and give pertinent dates, including estimated date of starting any proposed work) SEE RULE 1103.

Operator changed to LOBO PRODUCTION, (R.E. Lauritsen & Gary Roberts, Partners,) on Application to Drill

Change Well Designation to Oil Well on Application to Drill

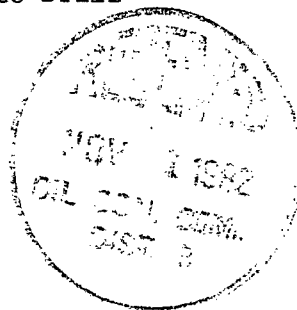
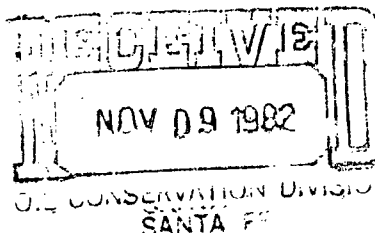

I hereby certify that the information above is true and complete to the best of my knowledge and belief.

R.E. Lauritsen TITLE Operator DATE 10-27-82

VED BY [Signature] TITLE _____ DATE _____

DITIONS OF APPROVAL, IF ANY:

Valid C-104 for NSL

OIL CONSERVATION DIVISION

P. O. BOX 2088
SANTA FE, NEW MEXICO 87501

Form C-103
Revised 10-1-78

| | |
|------------------------|--|
| NO. OF COPIES RECEIVED | |
| DISTRIBUTION | |
| SANTA FE | |
| FILE | |
| U.S.G.S. | |
| LAND OFFICE | |
| OPERATOR | |

| | |
|-------------------------------------|---|
| 5a. Indicate Type of Lease | |
| State <input type="checkbox"/> | Fee <input checked="" type="checkbox"/> |
| 5. State Oil & Gas Lease No. N/A | |

SUNDRY NOTICES AND REPORTS ON WELLS

(DO NOT USE THIS FORM FOR PROPOSALS TO DRILL ON TO DEEPEN OR PLUG BACK TO A DIFFERENT RESERVOIR.
USE "APPLICATION FOR PERMIT -" (FORM C-101) FOR SUCH PROPOSALS.)

OIL WELL ☒ GAS WELL ☐ OTHER-

Name of Operator

LOBO PRODUCTION, (R.E. Lauritsen & Gary Roberts, Partners)

Address of Operator

P.O. Box 2364 3005 Northridge, Suite I, Farmington, New Mex.

Location of Well

87401

UNIT LETTER C 1850 FEET FROM THE West LINE AND 1190 FEET FROM

THE North LINE, SECTION 11 TOWNSHIP 29N RANGE 15 W. NMPM.

7. Unit Agreement Name

8. Farm or Lease Name

Mesa-Kirtland //

9. Well No.

1-~~1~~

10. Field and Pool, or Wildcat

~~Wildcat~~ Basin Dakota

15. Elevation (Show whether DF, RT, GR, etc.)

5157.0 Gr.

12. County

San Juan

Check Appropriate Box To Indicate Nature of Notice, Report or Other Data

NOTICE OF INTENTION TO:

SUBSEQUENT REPORT OF:

FORM REMEDIAL WORK ☐

PLUG AND ABANDON ☐

REMEDIAL WORK ☐

ALTERING CASING ☐

PROBABLY ABANDON ☐

COMMENCE DRILLING OPNS. ☒

PLUG AND ABANDONMENT ☐

OR ALTER CASING ☐

CHANGE PLANS ☐

CASING TEST AND CEMENT JOBS ☐

OTHER ☐

Describe Proposed or Completed Operations (Clearly state all pertinent details, and give pertinent dates, including estimated date of starting any proposed work) *SEE RULE 1103.

Well Spud 2:00p.m. October 13, 1982

10-14-----260' Tripping for bit Attempting to Run Surface Casing 240'
10-15-----550' Drilling
10-16-----2350' Drilling
10-17-----3406' Drilling
10-18-----4150' Drilling
10-19-----4800' Drilling

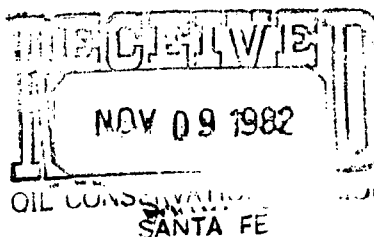

I hereby certify that the information above is true and complete to the best of my knowledge and belief.

R. E. Lauritsen

TITLE Operator

DATE 10-27-82

Frank T. Dargatzis

TITLE

DATE

CONDITIONS OF APPROVAL, IF ANY:

| | |
|------------------------|--|
| NO. OF COPIES RECEIVED | |
| DISTRIBUTION | |
| SANTA FE | |
| FILE | |
| U.S.G.S. | |
| LAND OFFICE | |
| OPERATOR | |

P. O. BOX 2088
SANTA FE, NEW MEXICO 87501
AUG 26 1982

O. C. D.
ARTESIA, OFFICE

5A. Indicate Type of Lease
STATE ☐ FEE ☒

5. State Oil & Gas Lease No.
N/A

APPLICATION FOR PERMIT TO DRILL, DEEPEN, OR PLUG BACK

1a. Type of Work
b. Type of Well DRILL ☒ DEEPEN ☐ PLUG BACK ☐
OIL WELL ☐ GAS WELL ☒ OTHER ☐ SINGLE ZONE ☐ MULTIPLE ZONE ☐

7. Unit Agreement Name

8. Form or Lease Name

Mesa - Kirtland II

9. Well No.

#1-~~2~~

10. Field and Pool, or Wildcat

Basin Dakota

W 320

12. County

San Juan

2. Name of Operator
R. E. Lauritsen

3. Address of Operator
P. O. Box 2364 3005 Northridge, Suite I, Farmington, N.M. 87401

4. Location of Well
UNIT LETTER C LOCATED 1850 FEET FROM THE West LINE
AND 1190 FEET FROM THE North LINE OF SEC. 11 TWP. 29 RGE. 15 NMPM

19. Proposed Depth

5200'

19A. Formation

Dakota

20. Rotary or C.T.

Rotary

21. Elevations (Show whether DH, RT, etc.)

5157.0 Gr.

21A. Kind & Status Plug. Bond

21B. Drilling Contractor

Four Corners

22. Approx. Date Work will start

9-30-82

23.

PROPOSED CASING AND CEMENT PROGRAM

| SIZE OF HOLE | SIZE OF CASING | WEIGHT PER FOOT | SETTING DEPTH | SACKS OF CEMENT | EST. TOP |
|--------------|----------------|-----------------|---------------|-----------------|----------|
| 12 1/4 | 8 5/8 | 24 | 250' | 250 | Circulab |
| 7 7/8 | 5 1/2 | 15.50 | 5200' | 900 | |

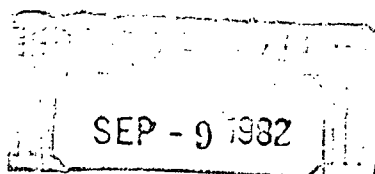

OIL CONSERVATION DIVISION
SANTA FE



IN ABOVE SPACE DESCRIBE PROPOSED PROGRAM: IF PROPOSAL IS TO DEEPEN OR PLUG BACK, GIVE DATA ON PRESENT PRODUCTIVE ZONE AND PROPOSED NEW PRO-
TIVE ZONE. GIVE BLOWOUT PREVENTER PROGRAM, IF ANY.

I hereby certify that the information above is true and complete to the best of my knowledge and belief.

Signed R. E. Lauritsen Title Operator Date 8-18-82

(This space for State Use)

APPROVED BY John D. Day TITLE SUPERVISOR DISTRICT #3 DATE 8-22-82

CONDITIONS OF APPROVAL, IF ANY:

Hold C104 for communitization or forced pooling

All distances must be from the outer boundaries of the Section.

| | | | | |
|--|-------------------------------|--|-----------------------------|--------------------------------|
| Operator R. E. LAURITSEN DRILLING | | Lease Various fee Mesa Kirtland II | | Well No. #1- 102 |
| Unit Letter C | Section 11 | Township 29 NORTH | Range 15 WEST | County SAN JUAN |
| Actual Footage Location of Well: 1190 feet from the NORTH line and 1850 feet from the WEST line | | | | |
| Ground Level Elev. 5157.0 | Producing Formation Dakota | Pool Basin | Dedicated Acreage: W 320 | |

1. Outline the acreage dedicated to the subject well by colored pencil or hachure marks on the plat below.
2. If more than one lease is dedicated to the well, outline each and identify the ownership thereof (both as to work interest and royalty).
3. If more than one lease of different ownership is dedicated to the well, have the interests of all owners been consolidated by communitization, unitization, force-pooling, etc?

☒ Yes ☐ No If answer is "yes," type of consolidation In process of force-pooling

If answer is "no," list the owners and tract descriptions which have actually been consolidated. (Use reverse side this form if necessary.)

No allowable will be assigned to the well until all interests have been consolidated (by communitization, unitization, forced-pooling, or otherwise) or until a non-standard unit, eliminating such interests, has been approved by the Division.

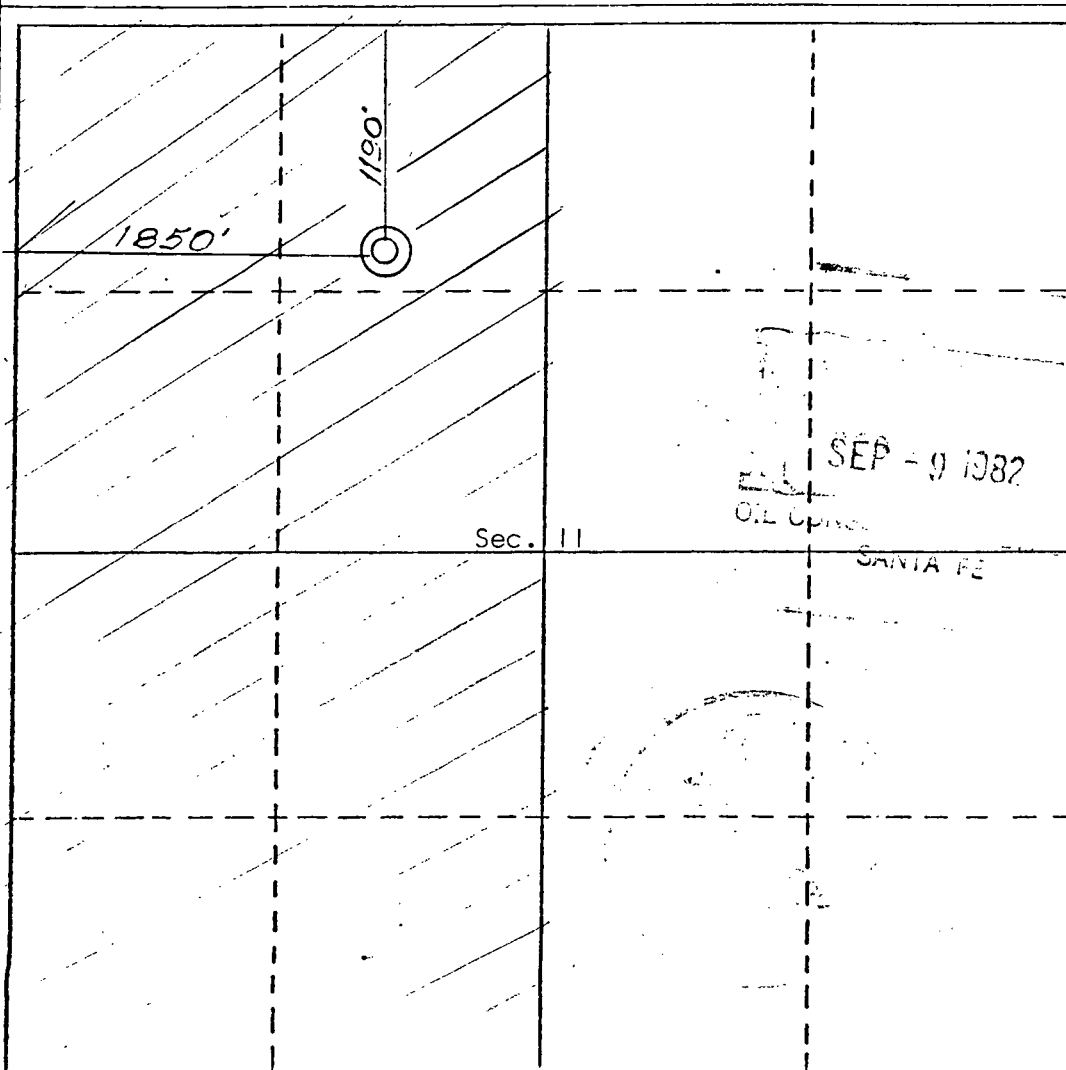

CERTIFICATION

I hereby certify that the information contained herein is true and complete to the best of my knowledge and belief.

R. E. Lauritsen

Name

R. E. LAURITSEN

Position

R. E. LAURITSEN DRILL

Company

OPERATOR

Date

8-23-82

I hereby certify that the well location shown on this plat was plotted from the notes of actual surveys made by me under my supervision, and that the same is true and correct to the best of my knowledge and belief.

16 REGISTERED LAND August, 1982
Date of Survey
REGISTERED LAND MEXICO
Registered Professional Engineer
and/or Land Surveyor
Curt C. Stocking
Certificate No. 5980