

20S-30E

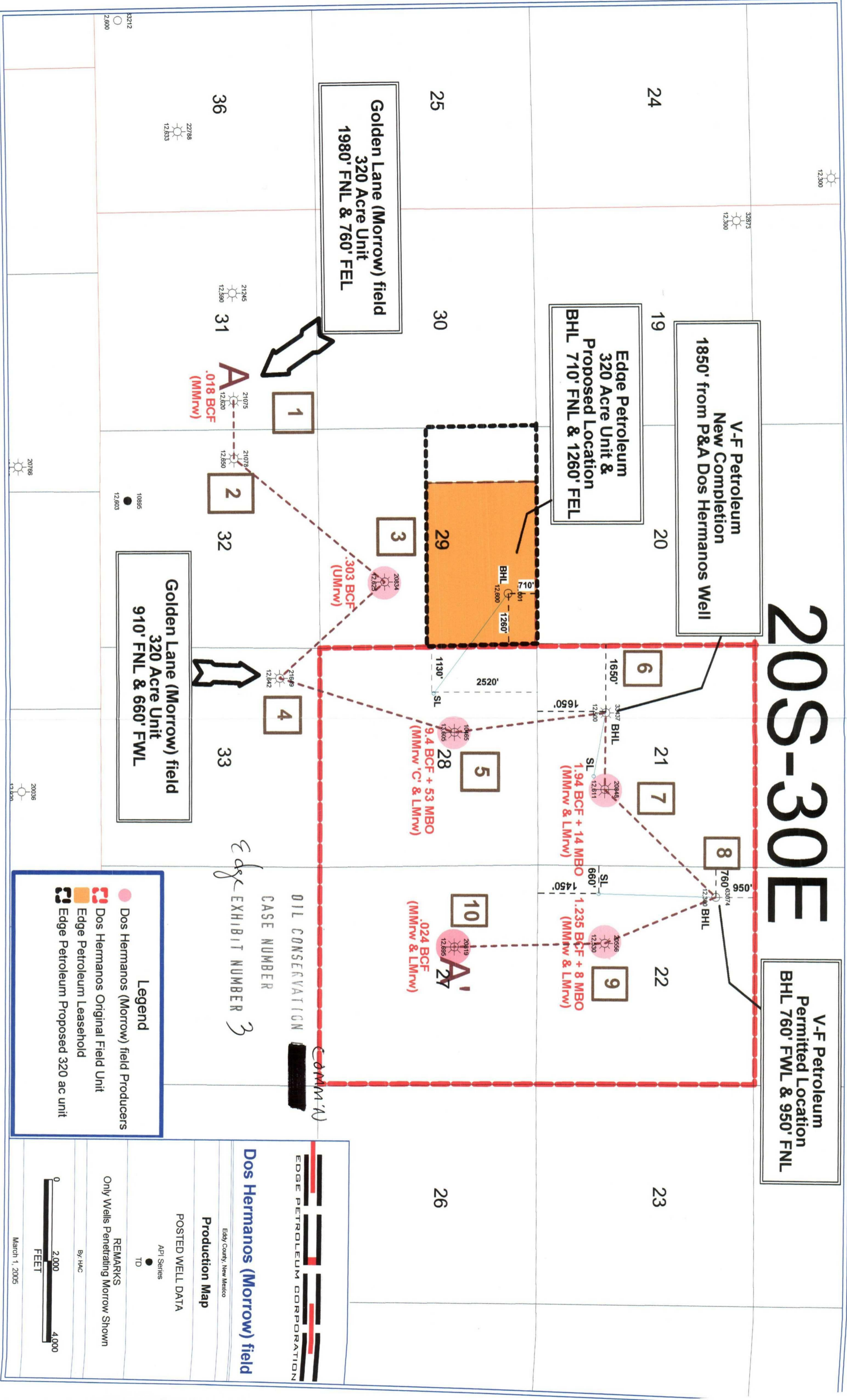

Legend

- Dos Hermanos (Morrow) field Producers
- Dos Hermanos Original Field Unit
- Edge Petroleum Leasehold
- Edge Petroleum Proposed 320 ac unit

OIL CONSERVATION
CASE NUMBER [redacted]
EDGE EXHIBIT NUMBER 3

EDGE PETROLEUM CORPORATION

Dos Hermanos (Morrow) field

Eddy County, New Mexico

Production Map

POSTED WELL DATA

API Series ●

TD ●

REMARKS

Only Wells Penetrating Morrow Shown

By: HAC

