

Offset Well Information

Area of Interest: Bone Springs
S2S2 Section 13, T24S, R28E
Eddy, County, New Mexico
Completion Date: 4/7/2015

A

E2SE4 Section 14, Township 24S, Range 28E

Current Operators:

Lands HBP: S2S2 acres – 30-015-43012 Tiger 14 24S 28E RB #124H
Operator: Matador Production Company
5400 LBJ Freeway, Suite 150
Dallas, Texas 75240-1017

Leases:

Lands: N2NE4NE4SE4, N2SE4NE4SE4, W2SE4SE4, N2NE4NW4SE4, S2NW4NW4SE4,
S2SW4NW4SE4, SW4SW4

Lessor: Conquistador Council Boy Scouts of America
2603 North Aspen Avenue
Roswell,, NM 88201

Lessee: Devon Energy Production Company
333 West Sheridan Ave.
Oklahoma City, OK 73102

And: Oxy USA Inc.
2810 Tumbleweed Drive
Addison, TX 75001

Lands: S2NE4NE4SE4

Lessor: Roy E. McLain and Francis A. McLain Revocable Trust
Carlsbad National Bank as Trustee
PO Box 1359
Carlsbad, NM 88221

Lessee: Matador Production Company
5400 LBJ Freeway, Suite 150
Dallas, Texas 75240-1017

And: RSC Resources, LP
6824 Island Circle
Midland, TX 79707

And: HHC Consulting & Investments, LLC
2889 N. Garfield
Midland, Texas 79702

And: JTD LLC
415 W. Wall Street
Midland, TX 79701

And: Texabec
Dallas, TX

And: CI St Clair LLC
2804 North Garfield
Midland, TX 79701

Lands: S2NE4NE4SE4
Lessor: Elizabeth Ann Wilson
PO Box 1434
Artesia, NM 88221
Lessee: Matador Production Company
5400 LBJ Freeway, Suite 150
Dallas, Texas 75240-1017
And: RSC Resources, LP
6824 Island Circle
Midland, TX 79707
And: HHC Consulting & Investments, LLC
2889 N. Garfield
Midland, Texas 79702
And: JTD LLC
415 W. Wall Street
Midland, TX 79701
And: Texabec
Dallas, TX
And: CI St Clair LLC
2804 North Garfield
Midland, TX 79701

Lands: S2NE4NE4SE4
Lessor: Ross Duncan
PO Box 647
Artesia, NM 88221
Lessee: Matador Production Company
5400 LBJ Freeway, Suite 150
Dallas, Texas 75240-1017
And: RSC Resources, LP
6824 Island Circle
Midland, TX 79707
And: HHC Consulting & Investments, LLC
2889 N. Garfield
Midland, Texas 79702
And: JTD LLC
415 W. Wall Street
Midland, TX 79701
And: Texabec
Dallas, TX
And: CI St Clair LLC
2804 North Garfield
Midland, TX 79701

Lands: S2NE4NE4SE4
Lessor: Xplor Resources, LLC
1104 N. Shore
Carlsbad, NM 88220
Lessee: Matador Production Company
5400 LBJ Freeway, Suite 150
Dallas, Texas 75240-1017
And: RSC Resources, LP
6824 Island Circle
Midland, TX 79707
And: HHC Consulting & Investments, LLC
2889 N. Garfield
Midland, Texas 79702
And: JTD LLC
415 W. Wall Street
Midland, TX 79701
And: Texabec
Dallas, TX
And: CI St Clair LLC
2804 North Garfield
Midland, TX 79701

Lands: S2NE4NE4SE4
Lessor: Featherstone Development Corporation
PO Box 429
Roswell, NM 88202
Lessee: Matador Production Company
5400 LBJ Freeway, Suite 150
Dallas, Texas 75240-1017
And: RSC Resources, LP
6824 Island Circle
Midland, TX 79707
And: HHC Consulting & Investments, LLC
2889 N. Garfield
Midland, Texas 79702
And: JTD LLC
415 W. Wall Street
Midland, TX 79701
And: Texabec
Dallas, TX
And: CI St Clair LLC
2804 North Garfield
Midland, TX 79701

Lands: S2NE4NE4SE4
Lessor: Prospector
PO Box 429
Roswell, NM 88202
Lessee: Matador Production Company
5400 LBJ Freeway, Suite 150
Dallas, Texas 75240-1017
And: RSC Resources, LP
6824 Island Circle
Midland, TX 79707
And: HHC Consulting & Investments, LLC
2889 N. Garfield
Midland, Texas 79702
And: JTD LLC
415 W. Wall Street
Midland, TX 79701
And: Texabec
Dallas, TX
And: CI St Clair LLC
2804 North Garfield
Midland, TX 79701

Lands: S2NE4NE4SE4
Lessor: Big Three Energy Group LLC
PO Box 429
Roswell, NM 88202
Lessee: Matador Production Company
5400 LBJ Freeway, Suite 150
Dallas, Texas 75240-1017
And: RSC Resources, LP
6824 Island Circle
Midland, TX 79707
And: HHC Consulting & Investments, LLC
2889 N. Garfield
Midland, Texas 79702
And: JTD LLC
415 W. Wall Street
Midland, TX 79701
And: Texabec
Dallas, TX
And: CI St Clair LLC
2804 North Garfield
Midland, TX 79701

Lands: S2NE4NE4SE4
Lessor: Brian C. Reid and Katherine A. Reid
2502 Camarie
Midland, TX 79705
Lessee: Matador Production Company
5400 LBJ Freeway, Suite 150
Dallas, Texas 75240-1017
And: RSC Resources, LP
6824 Island Circle
Midland, TX 79707
And: HHC Consulting & Investments, LLC
2889 N. Garfield
Midland, Texas 79702
And: JTD LLC
415 W. Wall Street
Midland, TX 79701
And: Texabec
Dallas, TX
And: CI St Clair LLC
2804 North Garfield
Midland, TX 79701

Lands: S2NE4NE4SE4
Lessor: Jennifer Seltzer
2053 16th Street
Cuyahoga, OH 44223
Lessee: Matador Production Company
5400 LBJ Freeway, Suite 150
Dallas, Texas 75240-1017
And: RSC Resources, LP
6824 Island Circle
Midland, TX 79707
And: HHC Consulting & Investments, LLC
2889 N. Garfield
Midland, Texas 79702
And: JTD LLC
415 W. Wall Street
Midland, TX 79701
And: Texabec
Dallas, TX
And: CI St Clair LLC
2804 North Garfield
Midland, TX 79701

Lands: S2SE4NE4SE4, N2NW4NE4SE4, S2NW4NE4SE4, S2NE4NW4SE4
Lessor: Don and Ruth James Revocable Trust
1350 CR 132 A
Kingsland, TX 78639
Lessee: Matador Production Company
5400 LBJ Freeway, Suite 150
Dallas, Texas 75240-1017
And: RSC Resources, LP
6824 Island Circle
Midland, TX 79707
And: HHC Consulting & Investments, LLC
2889 N. Garfield
Midland, Texas 79702
And: JTD LLC
415 W. Wall Street
Midland, TX 79701
And: Texabec
Dallas, TX
And: CI St Clair LLC
2804 North Garfield
Midland, TX 79701

Lands: S2SE4NE4SE4, N2NW4NE4SE4, S2NW4NE4SE4, S2NE4NW4SE4
Lessor: Harriet Camilla Fiderlick
2165 Lander St.
Reno, NV 89509
Lessee: Matador Production Company
5400 LBJ Freeway, Suite 150
Dallas, Texas 75240-1017
And: RSC Resources, LP
6824 Island Circle
Midland, TX 79707
And: HHC Consulting & Investments, LLC
2889 N. Garfield
Midland, Texas 79702
And: JTD LLC
415 W. Wall Street
Midland, TX 79701
And: Texabec
Dallas, TX
And: CI St Clair LLC
2804 North Garfield
Midland, TX 79701

Lands: S2SE4NE4SE4, N2NW4NE4SE4, S2NW4NE4SE4, S2NE4NW4SE4
Lessor: Patricia Ann James
PO Box 1127
Noble, OK 73068
Lessee: Matador Production Company
5400 LBJ Freeway, Suite 150
Dallas, Texas 75240-1017
And: RSC Resources, LP
6824 Island Circle
Midland, TX 79707
And: HHC Consulting & Investments, LLC
2889 N. Garfield
Midland, Texas 79702
And: JTD LLC
415 W. Wall Street
Midland, TX 79701
And: Texabec
Dallas, TX
And: CI St Clair LLC
2804 North Garfield
Midland, TX 79701

Lands: S2SE4NE4SE4, N2NW4NE4SE4, S2NW4NE4SE4, S2NE4NW4SE4
Lessor: Laura Claire James
50 TNT Lane
Heber Springs, AR 72543
Lessee: Matador Production Company
5400 LBJ Freeway, Suite 150
Dallas, Texas 75240-1017
And: RSC Resources, LP
6824 Island Circle
Midland, TX 79707
And: HHC Consulting & Investments, LLC
2889 N. Garfield
Midland, Texas 79702
And: JTD LLC
415 W. Wall Street
Midland, TX 79701
And: Texabec
Dallas, TX
And: CI St Clair LLC
2804 North Garfield
Midland, TX 79701

Lands: S2SE4NE4SE4, N2NW4NE4SE4, S2NW4NE4SE4, S2NE4NW4SE4
Lessor: Robert L. James
50 TNT Lane
Heber Springs, AR 72543
Lessee: Matador Production Company
5400 LBJ Freeway, Suite 150
Dallas, Texas 75240-1017
And: RSC Resources, LP
6824 Island Circle
Midland, TX 79707
And: HHC Consulting & Investments, LLC
2889 N. Garfield
Midland, Texas 79702
And: JTD LLC
415 W. Wall Street
Midland, TX 79701
And: Texabec
Dallas, TX
And: CI St Clair LLC
2804 North Garfield
Midland, TX 79701

Lands: S2SE4NE4SE4, N2NW4NE4SE4, S2NW4NE4SE4, S2NE4NW4SE4
Lessor: Therese James Berry
205 Chinkapin Drive
Pangburn, AR 77121
Lessee: Matador Production Company
5400 LBJ Freeway, Suite 150
Dallas, Texas 75240-1017
And: RSC Resources, LP
6824 Island Circle
Midland, TX 79707
And: HHC Consulting & Investments, LLC
2889 N. Garfield
Midland, Texas 79702
And: JTD LLC
415 W. Wall Street
Midland, TX 79701
And: Texabec
Dallas, TX
And: CI St Clair LLC
2804 North Garfield
Midland, TX 79701

Lands: S2SE4NE4SE4, N2NW4NE4SE4, S2NW4NE4SE4, S2NE4NW4SE4
Lessor: Roy G. Barton
1919 North Turner Street
Hobbs, NM 88241
Lessee: Matador Production Company
5400 LBJ Freeway, Suite 150
Dallas, Texas 75240-1017
And: RSC Resources, LP
6824 Island Circle
Midland, TX 79707
And: HHC Consulting & Investments, LLC
2889 N. Garfield
Midland, Texas 79702
And: JTD LLC
415 W. Wall Street
Midland, TX 79701
And: Texabec
Dallas, TX
And: CI St Clair LLC
2804 North Garfield
Midland, TX 79701

Lands: S2SE4NE4SE4, N2NW4NE4SE4, S2NW4NE4SE4, S2NE4NW4SE4
Lessor: Brett C. Barton
5408 NW118 circle
Oklahoma City, OK 73162
Lessee: Matador Production Company
5400 LBJ Freeway, Suite 150
Dallas, Texas 75240-1017
And: RSC Resources, LP
6824 Island Circle
Midland, TX 79707
And: HHC Consulting & Investments, LLC
2889 N. Garfield
Midland, Texas 79702
And: JTD LLC
415 W. Wall Street
Midland, TX 79701
And: Texabec
Dallas, TX
And: CI St Clair LLC
2804 North Garfield
Midland, TX 79701

Lands: S2SE4NE4SE4, N2NW4NE4SE4, S2NW4NE4SE4, S2NE4NW4SE4
Lessor: Heidi C. Barton
2008 North Vega Court
Hobbs, NM 88240
Lessee: Matador Production Company
5400 LBJ Freeway, Suite 150
Dallas, Texas 75240-1017
And: RSC Resources, LP
6824 Island Circle
Midland, TX 79707
And: HHC Consulting & Investments, LLC
2889 N. Garfield
Midland, Texas 79702
And: JTD LLC
415 W. Wall Street
Midland, TX 79701
And: Texabec
Dallas, TX
And: Cl St Clair LLC
2804 North Garfield
Midland, TX 79701

Lands: S2SE4NE4SE4, N2NW4NE4SE4, S2NW4NE4SE4, S2NE4NW4SE4
Lessor: Realeza Del Spear LP
PO Box 1684
Midland, TX 70702
Lessee: Matador Production Company
5400 LBJ Freeway, Suite 150
Dallas, Texas 75240-1017
And: RSC Resources, LP
6824 Island Circle
Midland, TX 79707
And: HHC Consulting & Investments, LLC
2889 N. Garfield
Midland, Texas 79702
And: JTD LLC
415 W. Wall Street
Midland, TX 79701
And: Texabec
Dallas, TX
And: Cl St Clair LLC
2804 North Garfield
Midland, TX 79701

Lands: N2SW4NE4SE4
Lessor: Pardue Limited Company
PO Box 2018
Carlsbad, NM 88221
Lessee: 0-13,100'
Devon Energy Production Company
333 West Sheridan Ave.
Oklahoma City, OK 73102
And: Pogo Producing Company
No address located
Lessee: 13,100' to Center of Earth
M. Brad Bennett
PO Box 51510
Midland, TX 79710

Lands: N2SW4NE4SE4
Lessor: J.R. Crawmer
2053 16th Street
Cuyahoga Falls, OH 44223
Lessee: 0-13,100'
Devon Energy Production Company
333 West Sheridan Ave.
Oklahoma City, OK 73102
And: Pogo Producing Company
No address located
Lessee: 13,100' to Center of Earth
M. Brad Bennett
PO Box 51510
Midland, TX 79710

B.

N2S2 Section 13 Township 24S Range 28E

Lands: E2SE4NE4SW4
Lessor: Mary Neil Mileta and Peter Mileta
1365 Brilliant Street
Raton, NM 87740
Lessee: Matador Production Company
5400 LBJ Freeway, Suite 150
Dallas, Texas 75240-1017
And: RSC Resources, LP
6824 Island Circle
Midland, TX 79707
And: HHC Consulting & Investments, LLC
2889 N. Garfield
Midland, Texas 79702
And: JTD LLC
415 W. Wall Street
Midland, TX 79701
And: Texabec
Dallas, TX
And: CI St Clair LLC
2804 North Garfield
Midland, TX 79701

Lands: E2SE4NE4SW4
Lessor: Alan Jochimsen
4209 Cardinal Lane
Midland, TX 79707
Lessee: Matador Production Company
5400 LBJ Freeway, Suite 150
Dallas, Texas 75240-1017
And: RSC Resources, LP
6824 Island Circle
Midland, TX 79707
And: HHC Consulting & Investments, LLC
2889 N. Garfield
Midland, Texas 79702
And: JTD LLC
415 W. Wall Street
Midland, TX 79701
And: Texabec
Dallas, TX
And: CI St Clair LLC
2804 North Garfield
Midland, TX 79701

Lands: E2SE4NE4SW4
Lessor: Monty D. McClane and Karen R. McClane
PO Box 9451
Midland, TX 79708
Lessee: Matador Production Company
5400 LBJ Freeway, Suite 150
Dallas, Texas 75240-1017
And: RSC Resources, LP
6824 Island Circle
Midland, TX 79707
And: HHC Consulting & Investments, LLC
2889 N. Garfield
Midland, Texas 79702
And: JTD LLC
415 W. Wall Street
Midland, TX 79701
And: Texabec
Dallas, TX
And: CI St Clair LLC
2804 North Garfield
Midland, TX 79701

Lands: E2SE4NW4SE4, E2SW4NW4SE4
Lessor: Pardue Limited Company
PO Box 2018
Carlsbad, NM 88221
Lessee: Xplor Resources
1104 N. Shore
Carlsbad, NM 88220

Lands: E2SE4NW4SE4, E2SW4NW4SE4
Lessor: Leslie D. Guitar
PO Box 58
Abilene, TX 79604
Lessee: MRC
5400 LBJ Freeway, Suite 150
Dallas, Texas 75240-1017

Lands: E2SE4NW4SE4, E2SW4NW4SE4
Lessor: Pressley Guitar
PO Box 5383
Abilene, TX 79604
Lessee: MRC
5400 LBJ Freeway, Suite 150
Dallas, Texas 75240-1017

Lands: E2SE4NW4SE4, E2SW4NW4SE4
Lessor: Guitar Holding
PO Box 58
Abilene, TX 79604
Lessee: MRC
5400 LBJ Freeway, Suite 150
Dallas, Texas 75240-1017

Lands: E2SE4NW4SE4, E2SW4NW4SE4
Lessor: Repps Guitar Jr Estate John Guitar and Leslie Guitar Nicholas
PO Box 1628
Big Spring, TX 79721
Lessee: MRC
5400 LBJ Freeway, Suite 150
Dallas, Texas 75240-1017

Lands: E2SE4NW4SE4, E2SW4NW4SE4
Lessor: Guitar Holding
PO Box 58
Abilene, TX 79604
Lessee: MRC
5400 LBJ Freeway, Suite 150
Dallas, Texas 75240-1017

Lands: E2SE4NW4SE4, E2SW4NW4SE4
Lessor: Gayle N. Nicolay Revocable Trust
5528 Tahoe Lane
Fairway, KS
Lessee: MRC
5400 LBJ Freeway, Suite 150
Dallas, Texas 75240-1017

Lands: E2SE4NW4SE4, E2SW4NW4SE4
Lessor: Virginia N. Hoff Management
2601 Lakewood circle
Tuscaloosa, AL 35405
Lessee: MRC
5400 LBJ Freeway, Suite 150
Dallas, Texas 75240-1017

Lands: E2SE4NW4SE, E2SW4NW4SE4
Lessor: Guy P. Witherspoon III
PO Box 100403
Fort Worth, TX 76185
Lessee: MRC
5400 LBJ Freeway, Suite 150
Dallas, Texas 75240-1017

Lands: E2SE4NW4SE4, E2SW4NW4SE4
Lessor: John Guitar Witherspoon Jr.
7404 Lemonwood Lane
Fort Worth, TX 76133
Lessee: MRC
5400 LBJ Freeway, Suite 150
Dallas, Texas 75240-1017

Lands: E2SE4NW4SE4, E2SW4NW4SE4
Lessor: Sally Guitar, Mellisa McGee, John Guitar Uhey, Sharon Guitar Ellis: Estate of
John Guitar III
10 Woodhaven Circle
Abilene, TX 79605
Lessee: MRC
5400 LBJ Freeway, Suite 150
Dallas, Texas 75240-1017

Lands: E2SE4NW4SE4, E2SW4NW4SE4
Lessor: Witten Guitar Witherspoon Jr.
7524 Pear Tree Lane
Fort Worth, TX 76185
Lessee: MRC
5400 LBJ Freeway, Suite 150
Dallas, Texas 75240-1017

Lands: E2SE4NW4SE4, E2SW4NW4SE4
Lessor: Brett Witherspoon
PO Box 100635
Fort Worth, TX 76185
Lessee: MRC
5400 LBJ Freeway, Suite 150
Dallas, Texas 75240-1017

Lands: E2SE4NW4SE4, E2SW4NW4SE4
Lessor: Wende Witherspoon Morgan
1720 Southwick
Flower Mound, TX 75022
Lessee: MRC
5400 LBJ Freeway, Suite 150
Dallas, Texas 75240-1017

Lands: E2SE4NW4SE4, E2SW4NW4SE4
Lessor: Catherine Gall Parker Exempt Trust
3721 Palos Verde Drive
Dallas, TX 75229
Lessee: MRC
5400 LBJ Freeway, Suite 150
Dallas, Texas 75240-1017

Lands: E2SE4NW4SE4, E2SW4NW4SE4
Lessor: Caren Gall Lucas Exempt Trust
3721 Palos Verde Drive
Dallas, TX 75229
Lessee: MRC
5400 LBJ Freeway, Suite 150
Dallas, Texas 75240-1017

Lands: E2SE4NW4SE4, E2SW4NW4SE4
Lessor: Gall Credit Shelter Trust
3721 Palos Verde Drive
Dallas, TX 75229
Lessee: MRC
5400 LBJ Freeway, Suite 150
Dallas, Texas 75240-1017

Lands: E2SE4NW4SE4, E2SW4NW4SE4
Lessor: Kelly Woods Leach
312 Greatview Circle
Birmingham, Al 35226
Lessee: MRC
5400 LBJ Freeway, Suite 150
Dallas, Texas 75240-1017

Lands: E2SE4NW4SE4, E2SW4NW4SE4
Lessor: Jack G. Woods Jr.
13 Glenway Drive
Austin , TX 78738
Lessee: MRC
5400 LBJ Freeway, Suite 150
Dallas, Texas 75240-1017

Lands: E2SE4NW4SE4, E2SW4NW4SE4
Lessor: Carren G. Lucas
Po Box 1485
Santa Rosa, FL 32459
Lessee: MRC
5400 LBJ Freeway, Suite 150
Dallas, Texas 75240-1017

Lands: E2SE4NW4SE4, E2SW4NW4SE4
Lessor: Catherine Gail Parker
3721 Palos Verde Drive
Dallas, TX 75229
Lessee: MRC
5400 LBJ Freeway, Suite 150
Dallas, Texas 75240-1017

Lands: E2SE4NW4SE4, E2SW4NW4SE4
Lessor: Woods Dickens Ranch
36 Surrey Square
Abilene, TX
Lessee: MRC
5400 LBJ Freeway, Suite 150
Dallas, Texas 75240-1017

Lands: E2SE4NW4SE4, E2SW4NW4SE4
Lessor: Laura Jean Hofer Trust
11248 S. Turner
Ontario, CA 91761
Lessee: MRC
5400 LBJ Freeway, Suite 150
Dallas, Texas 75240-1017

Lands: E2SE4NW4SE4, E2SW4NW4SE4
Lessor: Murchison-Guitar Family LP
Po Box 712
Red Bluff, CA 96080
Lessee: MRC
5400 LBJ Freeway, Suite 150
Dallas, Texas 75240-1017

Lands: E2SE4NW4SE4, E2SW4NW4SE4
Lessor: Barbara Lee Backman Inc.
4407 N. Division Suite 900
Spokane, Washington
Lessee: MRC
5400 LBJ Freeway, Suite 150
Dallas, Texas 75240-1017

Lands: E2SE4NW4SE4, E2SW4NW4SE4
Lessor: JPH Holdings
4400 Arcady
Dallas, TX
Lessee: MRC
5400 LBJ Freeway, Suite 150
Dallas, Texas 75240-1017

Lands: E2SE4NW4SE4, E2SW4NW4SE4
Lessor: Honey Heritage LP
Po Box 833206
Richardson, TX
Lessee: MRC
5400 LBJ Freeway, Suite 150
Dallas, Texas 75240-1017

Lands: E2SE4NW4SE4, E2SW4NW4SE4
Lessor: Polk Land and Minerals
1101 Butternut
Abilene, TX
Lessee: MRC
5400 LBJ Freeway, Suite 150
Dallas, Texas 75240-1017

Lands: E2SE4NW4SE4, E2SW4NW4SE4
Lessor: Lost Creek Royalties
400 Marienfield Suite 200
Midland, TX 79701
Lessee: MRC
5400 LBJ Freeway, Suite 150
Dallas, Texas 75240-1017

Lands: E2SE4NW4SE4, E2SW4NW4SE4

Lessor: James M. Alexander
Po Box 58
Abilene, TX

Lessee: MRC
5400 LBJ Freeway, Suite 150
Dallas, Texas 75240-1017

Lands: E2SE4NW4SE4, E2SW4NW4SE4

Lessor: Jeri Alexander Lott
Po Box 58
Abilene, TX

Lessee: MRC
5400 LBJ Freeway, Suite 150
Dallas, Texas 75240-1017

Lands: E2SE4NW4SE4, E2SW4NW4SE4

Lessor: Jeri Alexander Mangum and First Financial Trust and Asset Management
Company
Po Box 58
Abilene, TX

Lessee: MRC
5400 LBJ Freeway, Suite 150
Dallas, Texas 75240-1017

Lands: E2SE4NW4SE4, E2SW4NW4SE4

Lessor: Guitar Land and Cattle
Po Box 58
Abilene, TX

Lessee: MRC
5400 LBJ Freeway, Suite 150
Dallas, Texas 75240-1017

Lands: E2SE4NW4SE4, E2SW4NW4SE4

Lessor: Earl B. Guitar Jr. and Margaret Ann Guitar
Po Box 58
Abilene, TX

Lessee: MRC
5400 LBJ Freeway, Suite 150
Dallas, Texas 75240-1017

Lands: N2NW4SE4
Lessor: Henry McDonald
PO Box 597
Loving, NM 88256
Lessee: MRC Company
5400 LBJ Freeway, Suite 150
Dallas, Texas 75240
And: Gahr Energy Company
PO Box 1889
Midland, TX
And: Denmar Properties
No address Located
And: HHC Consulting & Investments, LLC
2889 N. Garfield
Midland, Texas 79702
And: RSC
6824 Island Circle
Midland, TX 79707

Lands: N2NW4SE4
Lessor: Harriett Camila Fiderlick
2165 Lander Street
Reno, NV 79707
Lessee: MRC Company
5400 LBJ Freeway, Suite 150
Dallas, Texas 75240
And: Gahr Energy Company
PO Box 1889
Midland, TX
And: Denmar Properties
No address Located
And: HHC Consulting & Investments, LLC
2889 N. Garfield
Midland, Texas 79702
And: RSC
6824 Island Circle
Midland, TX 79707

Lands: N2NW4SE4
Lessor: Donald M. James and Ruth James Ind. and as Trustees
1513 CR 132 A
Hot Springs AR 72543
Lessee: MRC Company
5400 LBJ Freeway, Suite 150
Dallas, Texas 75240
And: Gahr Energy Company
PO Box 1889
Midland, TX
And: Denmar Properties
No address Located
And: HHC Consulting & Investments, LLC
2889 N. Garfield
Midland, Texas 79702
And: RSC
6824 Island Circle
Midland, TX 79707

Lands: N2NW4SE4
Lessor: Theresa James Berry
20 Chinkapin Dr.
Pangburn AR 72121
Lessee: MRC Company
5400 LBJ Freeway, Suite 150
Dallas, Texas 75240
And: Gahr Energy Company
PO Box 1889
Midland, TX
And: Denmar Properties
No address Located
And: HHC Consulting & Investments, LLC
2889 N. Garfield
Midland, Texas 79702
And: RSC
6824 Island Circle
Midland, TX 79707

Lands: N2NW4SE4
Lessor: Robert Lafayette James III
50 TNT Lane
Heber Springs, AR 72543
Lessee: MRC Company
5400 LBJ Freeway, Suite 150
Dallas, Texas 75240
And: Gahr Energy Company
PO Box 1889
Midland, TX
And: Denmar Properties
No address Located
And: HHC Consulting & Investments, LLC
2889 N. Garfield
Midland, Texas 79702
And: RSC
6824 Island Circle
Midland, TX 79707

Lands: N2NW4SE4
Lessor: Patricia Ann James
PO Box 1127
Noble, OK 73068
Lessee: MRC Company
5400 LBJ Freeway, Suite 150
Dallas, Texas 75240
And: Gahr Energy Company
PO Box 1889
Midland, TX
And: Denmar Properties
No address Located
And: HHC Consulting & Investments, LLC
2889 N. Garfield
Midland, Texas 79702
And: RSC
6824 Island Circle
Midland, TX 79707

Lands: N2NW4SE4
Lessor: Laura Claire Guido aka Laura Claire James
PO Box 1127
Noble, OK 73068
Lessee: MRC Company
5400 LBJ Freeway, Suite 150
Dallas, Texas 75240
And: Gahr Energy Company
PO Box 1889
Midland, TX
And: Denmar Properties
No address Located
And: HHC Consulting & Investments, LLC
2889 N. Garfield
Midland, Texas 79702
And: RSC
6824 Island Circle
Midland, TX 79707

Lands: NE4SE4
Lessor: Beth Ann Botros
720 North Post Oak #330
Houston, TX
Lessee: Devon Energy Production Company
333 West Sheridan Ave.
Oklahoma City, OK 73102

Lands: NW4SW4
Lessor: Ross Duncan
PO Box 647
Artesia, NM 88221
Lessee: MRC
5400 LBJ Freeway, Suite 150
Dallas, Texas 75240-1017

Lands: NW4SW4
Lessor: Xplor Resources, LLC
1104 N. Shore
Carlsbad, NM 88220
Lessee: MRC
5400 LBJ Freeway, Suite 150
Dallas, Texas 75240-1017

Lands: NW4SW4
Lessor: Featherstone Development Corporation
PO Box 429
Roswell, NM 88202
Lessee: MRC
5400 LBJ Freeway, Suite 150
Dallas, Texas 75240-1017

Lands: NW4SW4
Lessor: Prospector
PO Box 429
Roswell, NM 88202
Lessee: MRC
5400 LBJ Freeway, Suite 150
Dallas, Texas 75240-1017

Lands: NW4SW4
Lessor: Big Three Energy Group LLC
PO Box 429
Roswell, NM 88202
Lessee: MRC
5400 LBJ Freeway, Suite 150
Dallas, Texas 75240-1017

Lands: NW4SW4
Lessor: Brian C. Reid and Katherine A. Reid
2502 Camarie
Midland, TX 79705
Lessee: MRC
5400 LBJ Freeway, Suite 150
Dallas, Texas 75240-1017

Lands: NW4SW4
Lessor: Elizabeth Ann Wilson
PO Box 1434
Artesia, NM 88221
Lessee: MRC
5400 LBJ Freeway, Suite 150
Dallas, Texas 75240-1017

Lands: N2NE4SW4, SW4NE4SW4
Lessor: Trent M. Kirkes and Sherlene Kirkes
505 Chaparelles Drive
Carlsbad, NM 88220
Lessee: MRC
5400 LBJ Freeway, Suite 150
Dallas, Texas 75240-1017

Lands: N2NE4SW4, SW4NE4SW4
Lessor: Elias Navarrette
1002 West Bonbright
Carlsbad, NM 88220
Lessee: MRC
5400 LBJ Freeway, Suite 150
Dallas, Texas 75240-1017

Lands: N2NE4SW4, SW4NE4SW4
Lessor: Jovita Dominguez
301 North Maple
Carlsbad, NM 88220
Lessee: MRC
5400 LBJ Freeway, Suite 150
Dallas, Texas 75240-1017

Lands: N2NE4SW4, SW4NE4SW4
Lessor: Richard Graziano
2607 Ohio
Carlsbad, NM 88220
Lessee: MRC
5400 LBJ Freeway, Suite 150
Dallas, Texas 75240-1017

Lands: N2NE4SW4, SW4NE4SW4
Lessor: Mary Parraz
907 North Mesa
Carlsbad, NM 88220
Lessee: MRC
5400 LBJ Freeway, Suite 150
Dallas, Texas 75240-1017

Lands: N2NE4SW4, SW4NE4SW4
Lessor: Lupe G. Sing
4204 Townsend
Carlsbad, NM 88220
Lessee: MRC
5400 LBJ Freeway, Suite 150
Dallas, Texas 75240-1017

Lands: N2NE4SW4, SW4NE4SW4
Lessor: Raul Graziano
2607 Ohio
Carlsbad, NM 88220
Lessee: MRC
5400 LBJ Freeway, Suite 150
Dallas, Texas 75240-1017

Lands: N2NE4SW4, SW4NE4SW4
Lessor: Ramey Graziano
4304 Jones
Carlsbad, NM 88220
Lessee: MRC
5400 LBJ Freeway, Suite 150
Dallas, Texas 75240-1017

Lands: N2NE4SW4, SW4NE4SW4
Lessor: Grace Barela
2416 Western Way
Carlsbad, NM 88220
Lessee: MRC
5400 LBJ Freeway, Suite 150
Dallas, Texas 75240-1017

Lands: N2NE4SW4, SW4NE4SW4
Lessor: Elida Florez
1407 W. Stevens
Carlsbad, NM 88220
Lessee: MRC
5400 LBJ Freeway, Suite 150
Dallas, Texas 75240-1017

Lands: N2NE4SW4, SW4NE4SW4
Lessor: Barry J. Nunez
1002 West Bonbight
Carlsbad, NM 88220
Lessee: MRC
5400 LBJ Freeway, Suite 150
Dallas, Texas 75240-1017

Lands: N2NE4SW4, SW4NE4SW4
Lessor: Dorothy Baeza
1002 West Bonbight
Carlsbad, NM 88220
Lessee: MRC
5400 LBJ Freeway, Suite 150
Dallas, Texas 75240-1017

Lands: N2NE4SW4, SW4NE4SW4
Lessor: Dimitri E. Nunez
1002 West Bonbight
Carlsbad, NM 88220
Lessee: MRC
5400 LBJ Freeway, Suite 150
Dallas, Texas 75240-1017

Lands: N2NE4SW4, SW4NE4SW4
Lessor: Marcello Navarrette Jr.
1002 West Bonbight
Carlsbad, NM 88220
Lessee: MRC
5400 LBJ Freeway, Suite 150
Dallas, Texas 75240-1017

Lands: N2NE4SW4, SW4NE4SW4
Lessor: Eminia N. Chavez
1002 West Bonbight
Carlsbad, NM 88220
Lessee: MRC
5400 LBJ Freeway, Suite 150
Dallas, Texas 75240-1017

Lands: N2NE4SW4, SW4NE4SW4
Lessor: Jose Navarrette
1002 West Bonbight
Carlsbad, NM 88220
Lessee: MRC
5400 LBJ Freeway, Suite 150
Dallas, Texas 75240-1017

Lands: W2SE4NW4SE4
Lessor: Margaret V. Dowling
1829 Georgia Street
Albuquerque, NM 87110
Lessee: Xplor Resources
1104 N. Shore
Carlsbad, NM 88220

Appears Open:

Lands: E2SE4NE4SW4
Owner: States Royalty Limited Partnership
PO Box 911
Breckenridge, TX 76424

Lands: E2SE4NW4SW4
Owner: Mourne Oil and Gas
Colorado Springs, CO

Lands: N2NE4SW4, SW4NE4SW4
Owner: Lupe Lara
605 N. 2nd Street
Carlsbad, NM 88220

Lands: N2NE4SW4, SW4NE4SW4
Owner: Yvette Lara
505 N. Maple
Carlsbad, NM 88220

Lands: N2NE4SW4, SW4NE4SW4
Owner: Michelle Lara
310 N. Mesa
Carlsbad, NM 88220

Lands: W2SW4NW4SE4
Owner: Camilia Land LLC
PO Box 51510
Midland, TX 79710

C.

W2SW4 Sec 18 Township 24S, Range 29E

Lands: All
Lessor: John C. Skinner
412 Corinne Palce
Carlsbad, NM 88220
Lessee: Cogent Energy, Inc.
6824 Island Circle
Midland, Texas 79707

Lands: S2NW4, NW4NW4, NW4SW4
Lessor: Jane S. Bailey
36 Will Scarlett
Mayhill, NM 79707
Lessee: Cogent Energy, Inc.
6824 Island Circle
Midland, Texas 79707

Lands: S2NW4, NW4NW4, NW4SW4
Lessor: Christy B. Motycka, et al
PO Box 10505
Midland, TX 79702
Lessee: RSC Resources, LP
6824 Island Circle
Midland, TX 79707

Lands: S2NW4, NW4NW4, NW4SW4
Lessor: Allison L. Birnie
14435 Benefit St. Apt 2
Sherman Oaks, CA 91423
Lessee: RSC Resources, LP
6824 Island Circle
Midland, TX 79707

Lands: S2NW4, NW4NW4, NW4SW4
Lessor: Jeff Morris Graef
4904 Haley,
Flower Mound, TX 75028
Lessee: RSC Resources, LP
6824 Island Circle
Midland, TX 79707

Lands: S2NW4, NW4NW4, NW4SW4
Lessor: Taylor L. Barr
PO Box 78694
Charlotte, NC 28271
Lessee: RSC Resources, LP
6824 Island Circle
Midland, TX 79707

Lands: NW4, NW4SW4
Lessor: Debra Kay Primera
PO Box 28504
Austin, TX 78755
Lessee: RSC Resources, LP
6824 Island Circle
Midland, TX 79707

Lands: Lot 1, 2, 3, SE4NW4
Lessor: Cameron Birnie
1066 Del Robles Pl
Simi, CA 93063
Lessee: RSC Resources, LP
6824 Island Circle
Midland, TX 79707

Lands: Lot 1, 2, 3, SE4NW4
Lessor: Robin E. Birnie
14435 Benefit
Sherman Oaks, CA 91423
Lessee: RSC Resources, LP
6824 Island Circle
Midland, TX 79707

Lands: Lot 1, 2, 3, SE4NW4
Lessor: Jason Bond
902 Hall
Roswell, NM 88201
Lessee: RSC Resources, LP
6824 Island Circle
Midland, TX 79707

Lands: Lot 1, 2, 3, SE4NW4
Lessor: Wells Fargo Bank NA Agent for the Loving Barr Family Trust
PO Box 1959
Midland, TX 79702
Lessee: RSC Resources, LP
6824 Island Circle
Midland, TX 79707

Lands: Lot 1, 2, 3, SE4NW4
Lessor: Ricky Raindl
PO Box 142454
Irving, TX 75014
Lessee: RSC Resources, LP
6824 Island Circle
Midland, TX 79707

Lands: Lot 1, 2, 3, SE4NW4
Lessor: R. F. Fort AKA Raymond Fort Sr.
PO Box 65093
Lubbock, TX 79464
Lessee: RSC Resources, LP
6824 Island Circle
Midland, TX 79707

Lands: Lot 1, 2, 3, SE4NW4
Lessor: Randall A. Fort
9716 Admiral Emerson Ave. NE
Albuquerque, NM 87111
Lessee: RSC Resources, LP
6824 Island Circle
Midland, TX 79707

Lands: Lot 1, 2, 3, SE4NW4
Lessor: Margie Fort Burn
10316 Country Manor PL NW
Albuquerque, NM 87114
Lessee: RSC Resources, LP
6824 Island Circle
Midland, TX 79707

Lands: Lot 1, 2, 3, SE4NW4
Lessor: Robert Mitchell Raindl
PO Box 853
Tohoka, TX 79373
Lessee: RSC Resources, LP
6824 Island Circle
Midland, TX 79707

Lands: Lot 1, 2, 3, SE4NW4
Lessor: Tommy L Fort
PO Box 5356
Midland, TX 79704
Lessee: RSC Resources, LP
6824 Island Circle
Midland, TX 79707

Lands: Lot 1, 2, 3, SE4NW4
Lessor: Charles M. Farrell
119 Seabell Rd.
Belen, NM 87002
Lessee: Cogent Energy Inc.
6824 Island Circle
Midland, TX 79707

Lands: Lot 1, 2, 3, SE4NW4
Lessor: Jane S. Bailey
36 Will Scarlett
Mayhill, NM 88339
Lessee: Cogent Energy Inc.
6824 Island Circle
Midland, TX 79707

Lands: Lot 1, 2, 3, SE4NW4
Lessor: Zachariah J. Reid
PO Box 505
Midland, TX 79702
Lessee: RSC Resources, LP
6824 Island Circle
Midland, TX 79707

Lands: Lot 1, 2, 3, SE4NW4
Lessor: Craig W. Barr
1031 NW 43rd Ave.
Camas, WA 98607
Lessee: RSC Resources, LP
6824 Island Circle
Midland, TX 79707

Lands: Lot 4, NE4NW4, W2SW4
Lessor: Bureau of Land Management
301 Dinosaur Trail
Santa Fe, NM
Lessee: Chevron Midcontinent
500 West Illinois
Midland, TX

D.

NW4NW4 Section 19, Township 24, Range 29

Current Leases:

Lands: Lots 1, 2, 3, 4, E2W2, E2 (All)
Lessor: Bureau of Land Management
301 Dinosaur Trail
Santa Fe, NM
Lessee: Chevron USA
Venice, LA

E.

N2N2 Section 24, Township 24S Range 28E

Current Leases:

Lands:	NW4
Lessor:	United States of America 301 Dinosaur Trail Santa Fe, NM
Lessee:	Dinero Operating 1004 N. Big spring Midland, TX
Lands:	E2NE4, SW4NE4, NE4SE4
Lessor:	United States of America 301 Dinosaur Trail Santa Fe, NM
Lessee:	PPC 10355 Centrepark Suite 100 Houston, TX
Lands:	NW4NE4
Lessor:	United States of America 301 Dinosaur Trail Santa Fe, NM
Lessee:	Dinero Operating 1004 N. Big spring Midland, TX

F.

NE4NE4 Section 23 Township 24S Range 28E

Current Leases:

Lands:	NE4NE4NE4, S2NE4NE4, SE4NE4, E2SE4, SW4SE4
Lessor:	Guy A. Reed 813 North Main Carlsbad, NM
Lessee:	Devon Energy Production Company 333 West Sheridan Oklahoma City, OK 73102
Lands:	NW4NE4NE4
Lessor:	Pardue Farms PO Box 128 Loving, NM
Lessee:	Devon Energy Production Company 333 West Sheridan Oklahoma City, OK 73102

Janie Conner 13-24S-28E RB #124

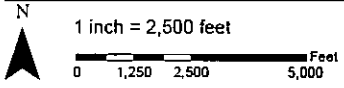
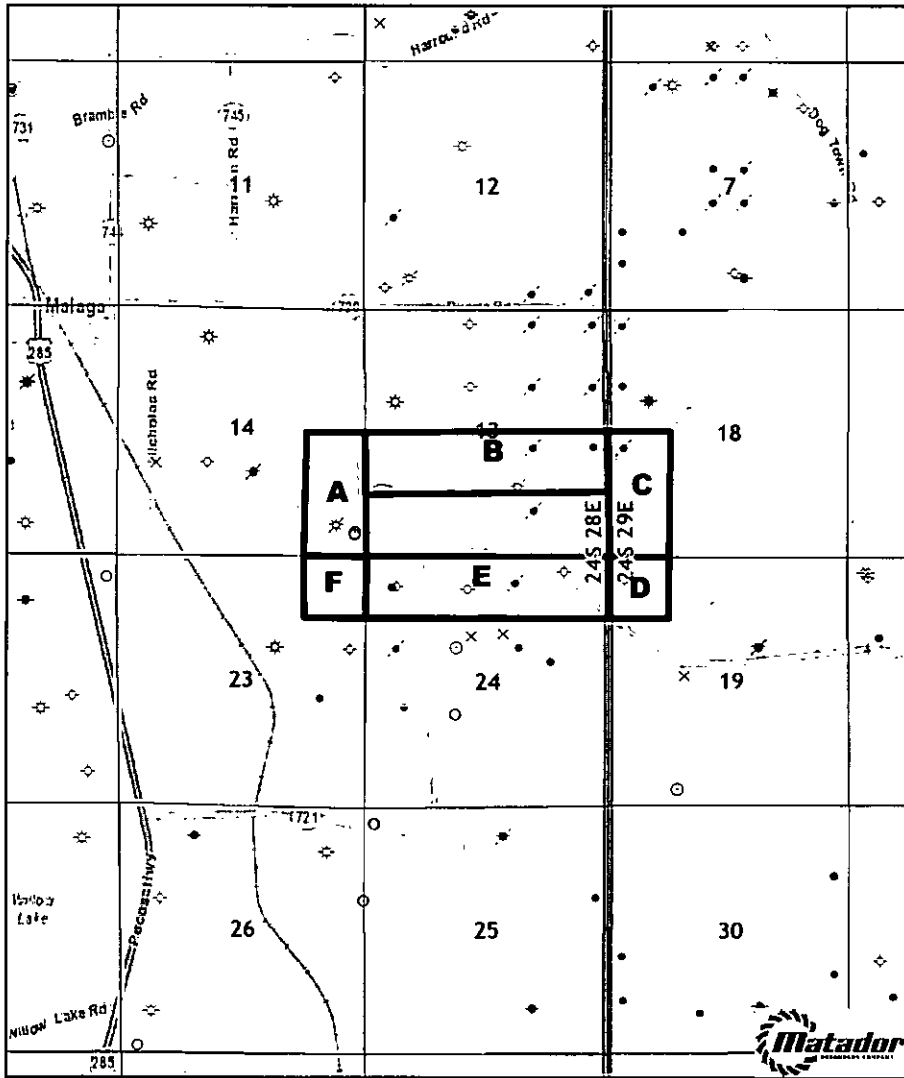

Projection: NAD_1927_StatePlane_New_Mexico_East_FIPS_3001 (feet)

Map Prepared by agriplan
 Date: April 5, 2015
 Operator: MIC, Farmway, O'Neill, Plac
 Source: National Agriculture Imagery Program (NAIP)
 Enhancement Systems Research Institute (ESRI) 1:4 Energy P446

