

From Tim Speer <TSpeer@nearburg.com>
Sent Thursday April 23 2015 8 31 PM
To Michael Griffin <mgriffin@nearburg.com> Randy Howard <rhoward@nearburg.com>
Duane Davis <ddavis@nearburg.com> Bill Elton <belton@nearburg.com>
Subject SRO Unit
Attach SRO Area 2nd Bone Spring Wells bmp

Here s a bubble map of the 2nd Bone Spring wells surrounding our acreage We own the W/2 of Section 20 26S 28E COG has drilled and completed two – two mile horizontals running through the W/2 of Section 17 and 20 They were both completed in March

NMOCC CASE Nos 15441 15481 15482
NEX SRO2 LLC AND SRO3 LLC
Exhibit No 66
February 28 2017

Confidential Subject to Protective Order
in Nearburg Exploration Company
LLC SRO 2 LLC and SRO3 LLC v
COG Operating LLC Cause No D 101
CV 2015 02541 NM 1st Judicial District
Court Santa Fe County

NEX00012429

SRO Area
2nd Bone Spring Wells

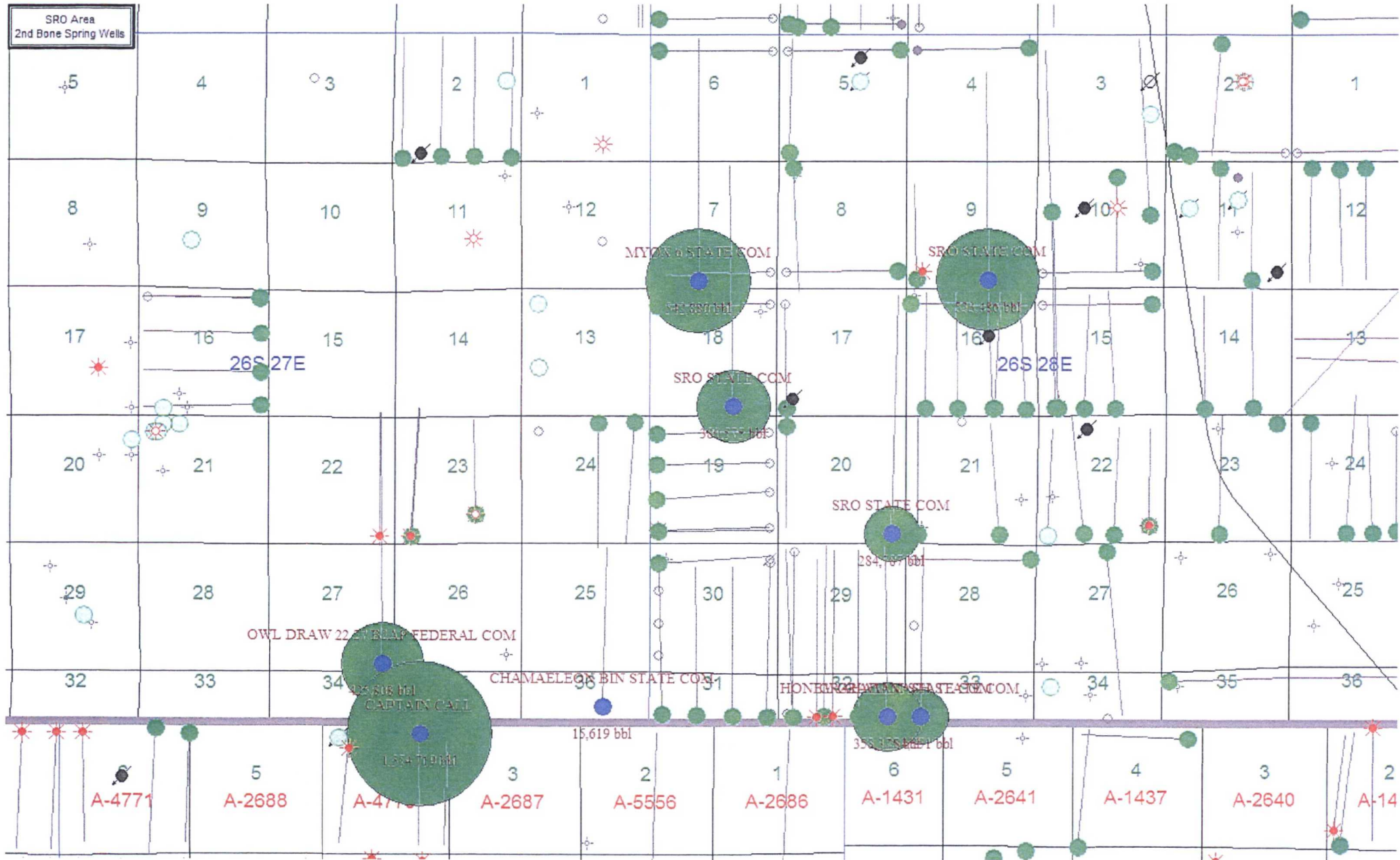

MYON & STATE COM

SRO STATE COM

SRO STATE COM

SRO STATE COM

OWL DRAW 22 & BLAD FEDERAL COM

CHAMAELEON BIN STATE COM

HONORABLE MOUNTAIN STATE COM

CAPTAIN CALL

A-4771

A-2688

A-4770

A-2687

A-5556

A-2686

A-1431

A-2641

A-1437

A-2640

A-14

15,619 bbl

356,375 bbl

12,747 bbl

26S 27E

26S 28E