

ALLISON UNIT COM # 146
 1000' FNL, 1265' FWL
 SECTION 23, T32N, R7W

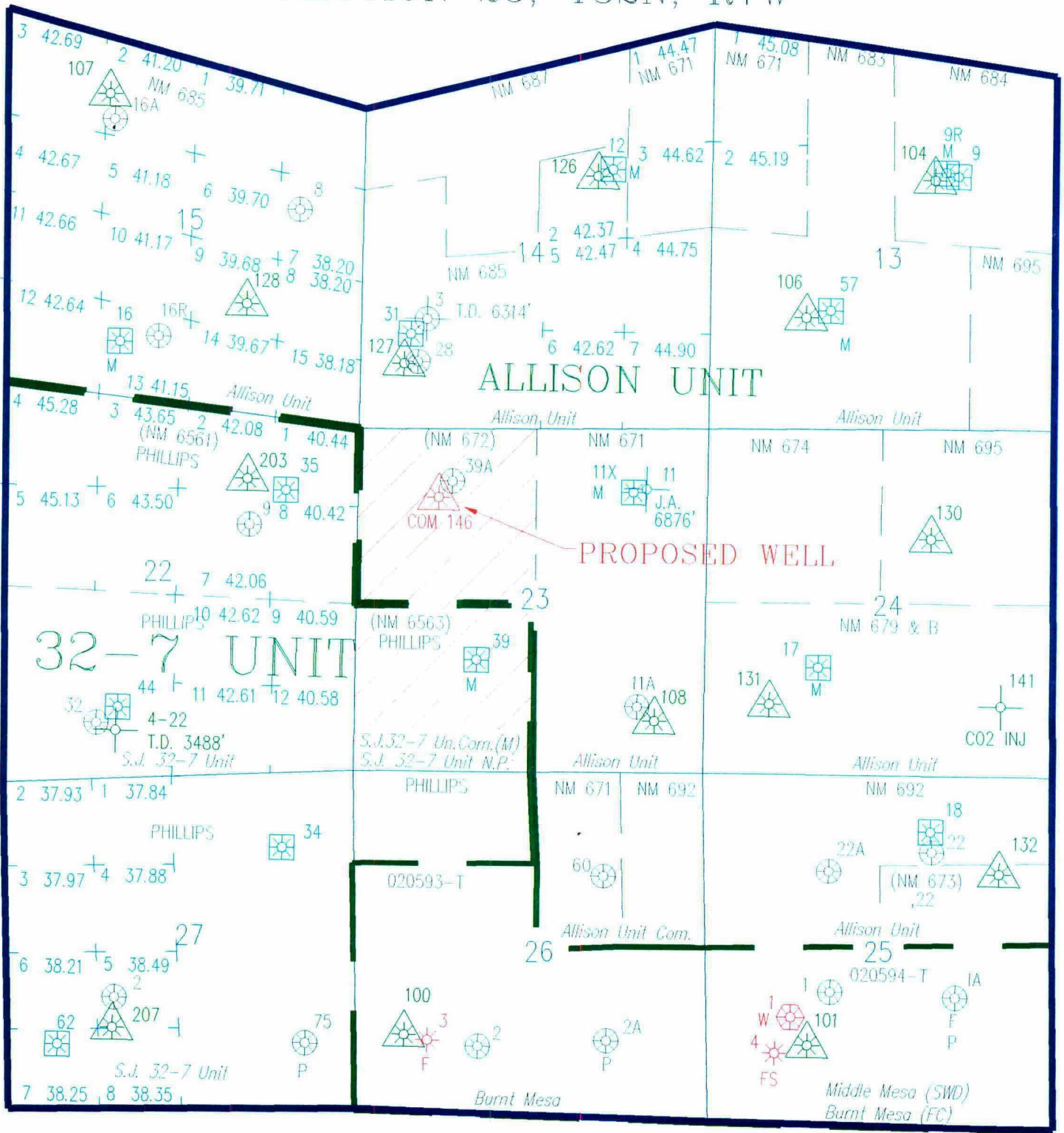

-  FRUITLAND SAND
-  MESAVERDE
-  FRUITLAND COAL
-  DAKOTA
-  PICTURED CLIFFS
-  GALLUP

 PROPOSED DRILLBLOCK

MERIDIAN OIL INC

ALLISON UNIT COM #146

OFFSET OPERATOR \ OWNER PLAT

Off-Pattern Fruitland Coal Well Location

Township 32 North, Range 7 West

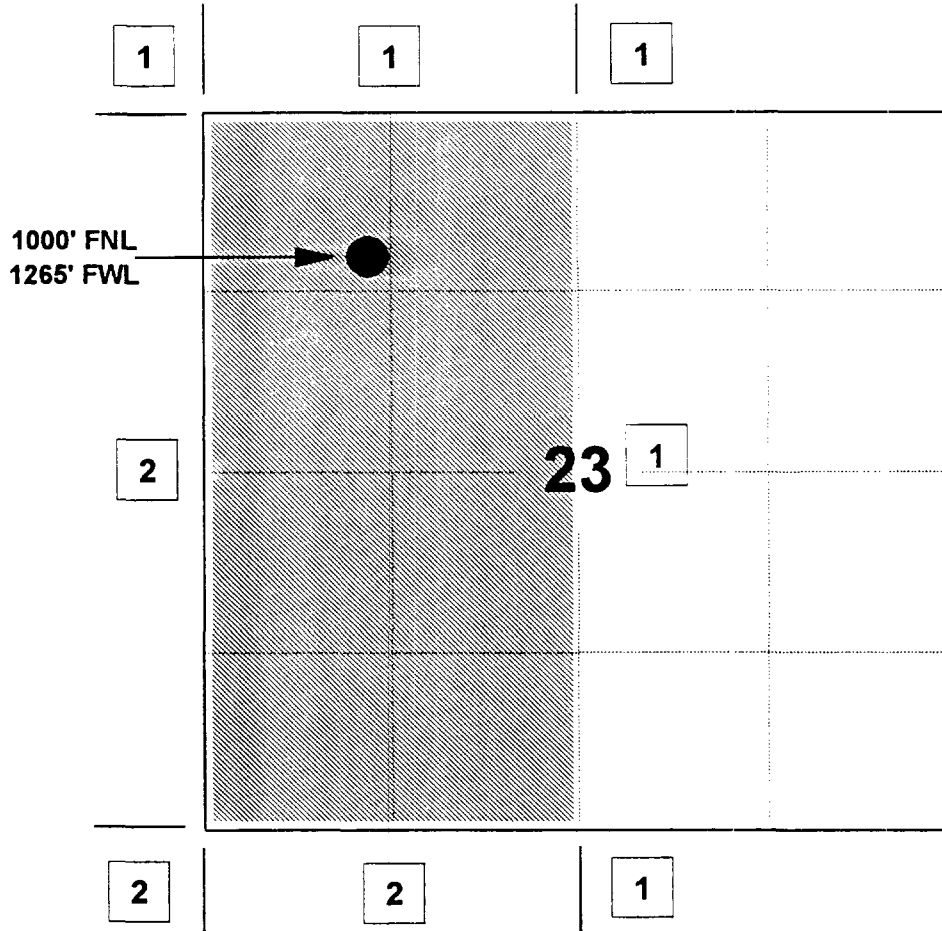

1) Meridian Oil Inc

2) Phillip Petroleum Company

5525 Hwy. 64, NBU 3004, Farmington, NM 87401
