

**HAVASU #1
LEASE OWNERSHIP PLAT
S/2 Sec. 22, T32N, R13W
San Juan County, NM**

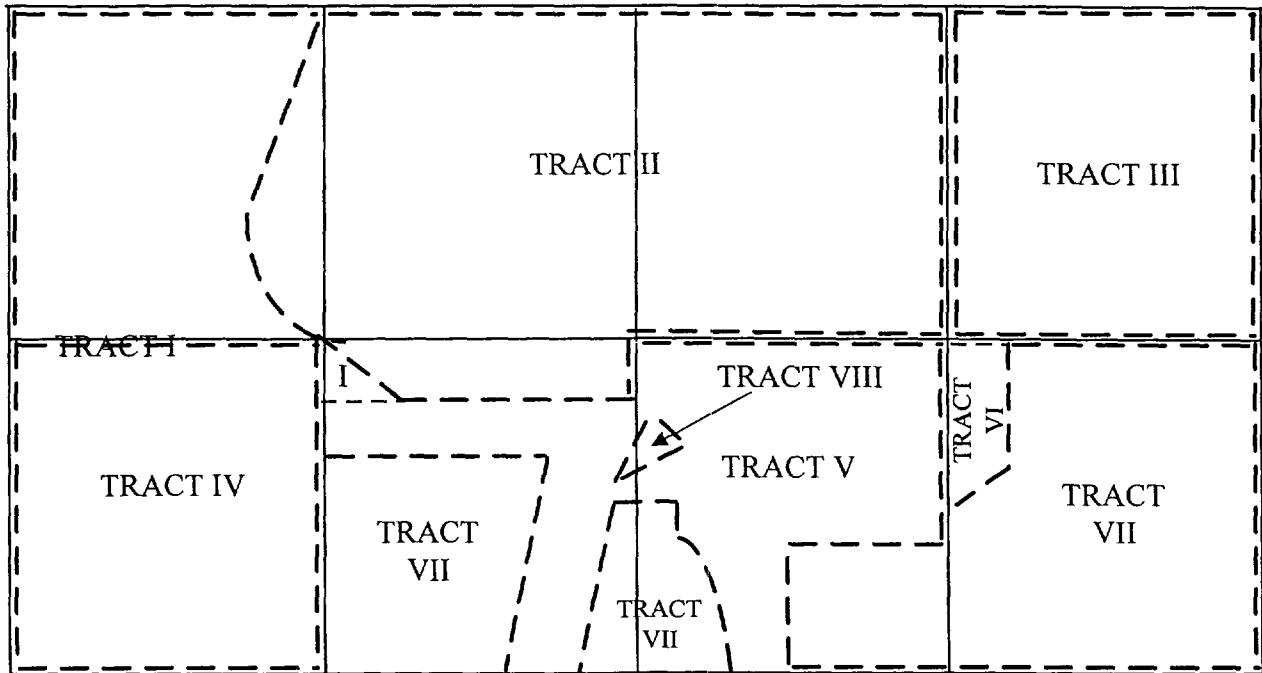

<u>Tract</u>	<u>Acres</u>	<u>Ownership</u>
I	34.6493	100% Merrion
II	90.4009	80% Merrion, 20% Fields
III	40	100% Burlington
IV	39.95	100% Merrion
V	40.27	100% Merrion
VI	3.68	100% Merrion
VII	72.30	100% Merrion
VIII	.92	100% E. Waymen-Palmer
Total	322.1702	81.68664% Merrion, 12.4158% Burlington (Committed), 5.612% Fields, .28556% Palmer (Uncommitted)

NMOCD Examiner Hearing
May 1, 1997
Docket #13-97
Case #11766
Ex. #3