

SCIENTIFIC DRILLING INTERNATIONAL

MIDLAND, TEXAS

NEARBURG PRODUCING COMPANY

Well Name : EAGLE CREEK '11' #1
Field : EAGLE CREEK FIELD, EDDY COUNTY, NM
Site : SEC 14, T-17-S, R-25-E
SHL : 1070' FNL & 2110' FWL
Plan BHL : SEC 11, 660' FSL & 1980 FEL
Date Surveyed : 29 OCTOBER 1998
Job No. : WELL PLAN

s survey is correct to the best of my knowledge
is supported by actual field data.

..... COMPANY REPRESENTATIVE

BEFORE THE
OIL CONSERVATION DIVISION
Case No. 12073 Exhibit No. 10
Submitted By:
Nearburg Exploration Co.
Hearing Date: November 5, 1998

Directional Well Plan

SCIENTIFIC DRILLING INTERNATIONAL

Customer : NEARBURG PRODUCING COMPANY
 Well Name : EAGLE CREEK '11' #1
 Field : EAGLE CREEK FIELD, EDDY COUNTY, NM
 Site : SEC 14, T-17-S, R-25-E
 Well : 1070' FNL & 2110' FWL
 Plan BHL : SEC 11, 660' FSL & 1980 FEL

Page 1 of 2
 Date 29 OCTOBER 1998
 Filename : EAGLE#1

Interpolation

Height Of WELLSITE Datum Above Field Datum 0.00 ft

MD ft	INC deg	DIR deg	TVD ft	+N/-S ft	+E/-W ft	VS ft	D'LEG °/100
3800.0	0.00	N34.52°E	3800.00	0.00	0.00	0.00	0.0
3900.0	0.00	N34.52°E	3900.00	0.00	0.00	0.00	0.0
4000.0	0.00	N34.52°E	4000.00	0.00	0.00	0.00	0.0
4100.0	0.00	N34.52°E	4100.00	0.00	0.00	0.00	0.0
4200.0	2.50	N34.52°E	4199.97	1.80	1.24	2.18	2.5
4300.0	5.00	N34.52°E	4299.75	7.19	4.94	8.72	2.5
4400.0	7.50	N34.52°E	4399.14	16.15	11.11	19.61	2.5
4500.0	10.00	N34.52°E	4497.97	28.69	19.73	34.82	2.5
4600.0	12.50	N34.52°E	4596.04	44.76	30.79	54.33	2.5
4700.0	15.00	N34.52°E	4693.17	64.34	44.26	78.09	2.5
4800.0	17.50	N34.52°E	4789.17	87.39	60.11	106.07	2.5
4900.0	20.00	N34.52°E	4883.85	113.88	78.33	138.21	2.5
5000.0	22.50	N34.52°E	4977.05	143.73	98.87	174.46	2.5
5100.0	25.00	N34.52°E	5068.57	176.91	121.69	214.73	2.5
5200.0	27.50	N34.52°E	5158.25	213.35	146.76	258.95	2.5
5300.0	30.00	N34.52°E	5245.92	252.98	174.01	307.05	2.5
5400.0	32.50	N34.52°E	5331.40	295.72	203.41	358.92	2.5
5487.3	34.68	N34.52°E	5404.14	335.52	230.79	407.23	2.5
5500.0	34.68	N34.52°E	5414.56	341.46	234.88	414.44	0.0
5600.0	34.68	N34.52°E	5496.79	388.35	267.13	471.35	0.0
5700.0	34.68	N34.52°E	5579.02	435.23	299.38	528.25	0.0
5800.0	34.68	N34.52°E	5661.25	482.11	331.63	585.16	0.0
5900.0	34.68	N34.52°E	5743.48	528.99	363.87	642.06	0.0
6000.0	34.68	N34.52°E	5825.72	575.88	396.12	698.96	0.0
6100.0	34.68	N34.52°E	5907.95	622.76	428.37	755.87	0.0
6200.0	34.68	N34.52°E	5990.18	669.64	460.62	812.77	0.0
6300.0	34.68	N34.52°E	6072.41	716.53	492.87	869.67	0.0
6400.0	34.68	N34.52°E	6154.64	763.41	525.12	926.58	0.0
6500.0	34.68	N34.52°E	6236.87	810.29	557.37	983.48	0.0
6600.0	34.68	N34.52°E	6319.10	857.18	589.62	1040.39	0.0
6700.0	34.68	N34.52°E	6401.33	904.06	621.87	1097.29	0.0
6800.0	34.68	N34.52°E	6483.57	950.94	654.12	1154.19	0.0
6900.0	34.68	N34.52°E	6565.80	997.83	686.37	1211.10	0.0
7000.0	34.68	N34.52°E	6648.03	1044.71	718.62	1268.00	0.0
7100.0	34.68	N34.52°E	6730.26	1091.59	750.86	1324.90	0.0

SCIENTIFIC DRILLING INTERNATIONAL

Customer : NEARBURG PRODUCING COMPANY
 Well Name : EAGLE CREEK '11' #1
 Field : EAGLE CREEK FIELD, EDDY COUNTY, NM
 Site : SEC 14, T-17-S, R-25-E
 Well : 1070' FNL & 2110' FWL
 Plan BHL : SEC 11, 660' FSL & 1980 FEL

Page 2 of 2
 Date 29 OCTOBER 1998
 Filename : EAGLE#1

Interpolation

Height Of WELLSITE Datum Above Field Datum 0.00 ft

MD ft	INC deg	DIR deg	TVD ft	+N/-S ft	+E/-W ft	VS ft	D'LEG °/100
7200.0	34.68	N34.52°E	6812.49	1138.48	783.11	1381.81	0.0
7300.0	34.68	N34.52°E	6894.72	1185.36	815.36	1438.71	0.0
7400.0	34.68	N34.52°E	6976.95	1232.24	847.61	1495.62	0.0
7500.0	34.68	N34.52°E	7059.18	1279.13	879.86	1552.52	0.0
7600.0	34.68	N34.52°E	7141.41	1326.01	912.11	1609.42	0.0
7700.0	34.68	N34.52°E	7223.65	1372.89	944.36	1666.33	0.0
7800.0	34.68	N34.52°E	7305.88	1419.77	976.61	1723.23	0.0
7900.0	34.68	N34.52°E	7388.11	1466.66	1008.86	1780.13	0.0
8000.0	34.68	N34.52°E	7470.34	1513.54	1041.11	1837.04	0.0
8100.0	34.68	N34.52°E	7552.57	1560.42	1073.36	1893.94	0.0
8200.0	34.68	N34.52°E	7634.80	1607.31	1105.60	1950.85	0.0
8300.0	34.68	N34.52°E	7717.03	1654.19	1137.85	2007.75	0.0
8400.0	34.68	N34.52°E	7799.26	1701.07	1170.10	2064.65	0.0
8461.7	34.68	N34.52°E	7850.00	1730.00	1190.00	2099.76	0.0
8500.0	34.68	N34.52°E	7881.50	1747.96	1202.35	2121.56	0.0
8600.0	34.68	N34.52°E	7963.73	1794.84	1234.60	2178.46	0.0
8644.1	34.68	N34.52°E	8000.00	1815.52	1248.83	2203.56	0.0

Origin of Bottom Hole Closure WELLSITE CENTRE
 Bottom Hole Closure 2204 ft N34.52°E



SCIENTIFIC DRILLING
FOR
NEARBURG PRODUCING COMPANY
EAGLE CREEK
11° 31'
SEC 14, T-17-S, R-25-E
IN
EDDY COUNTY, NEW MEXICO

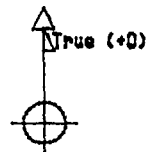

Wellbore will penetrate Morrow at southwest corner of 330' square target. Southwest corner is 1980' FEL, 660' FSL, Section 11, T17S, R25E.

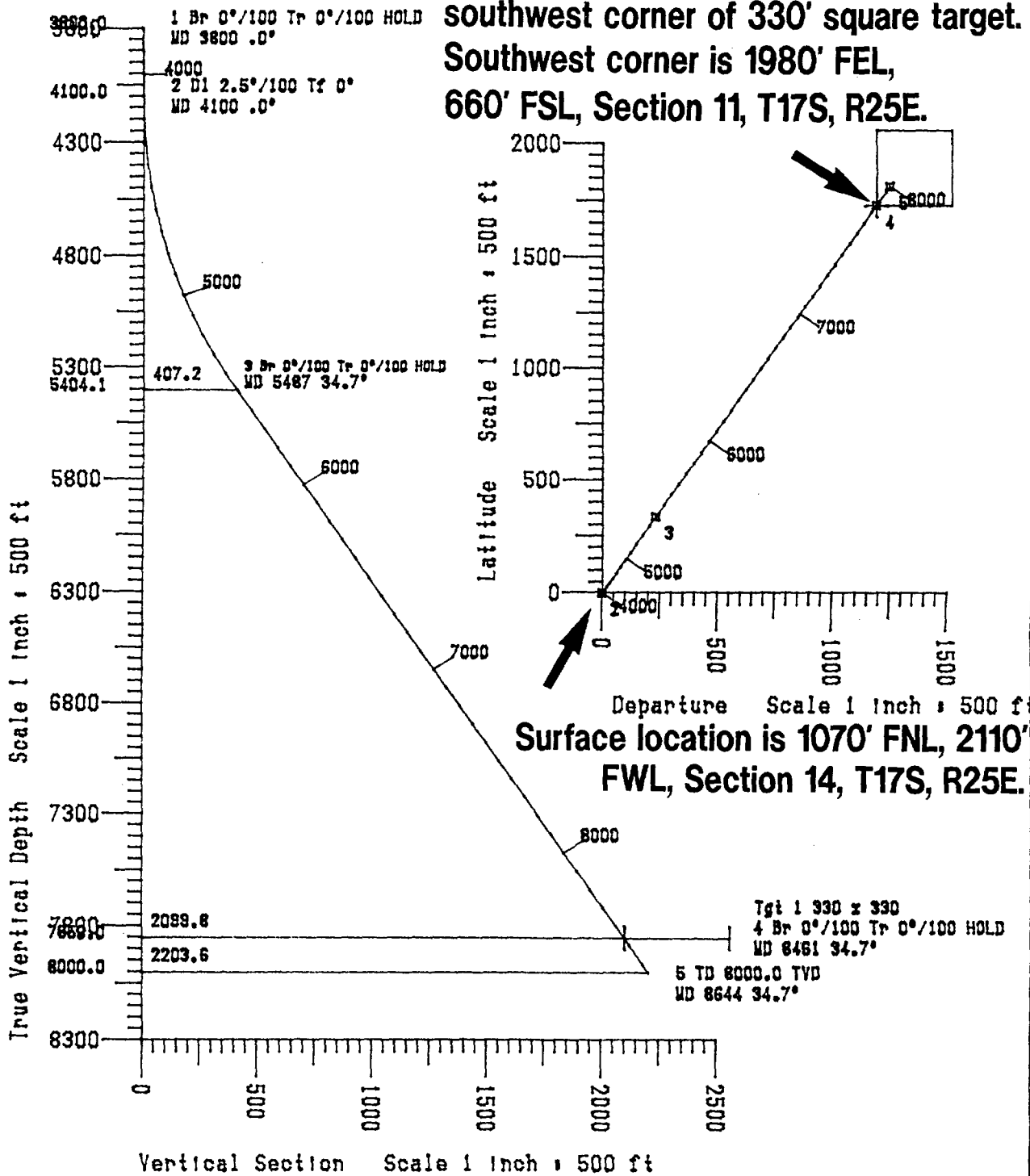

PLANE OF VERT SECTn 34.52°
PLOT DATE 10-30-1988

TARGET DETAILS

No	TVD	Lat	Dep
1	7850.0	1730.0	1190.0

WELL PROPOSAL

Sec	MD	TVD	VS	INC	DIR	LAT	DEP	TGT
1	3800.0	3800.0	0.0	0.0	34.52	0.0	0.0	
2	4100.0	4100.0	0.0	0.0	34.52	0.0	0.0	
3	5487.3	5404.1	407.2	34.7	34.52	335.5	230.8	
4	8461.7	7850.0	2088.8	34.7	34.52	1730.0	1190.0	1
5	8644.1	8000.0	2203.6	34.7	34.52	1815.5	1248.8	

