

STATE OF NEW MEXICO
ENERGY AND MINERALS DEPARTMENT

OIL CONSERVATION DIVISION

P. O. BOX 2088

SANTA FE, NEW MEXICO 87501

Form C-101
Revised 10-1-78

NO. OF COPIES RECEIVED	
DISTRIBUTION	
SANTA FE	1
FILE	1
U.S.G.S. B-HW	2
LAND OFFICE NM&M	1
OPERATOR	1

API # 30.001-20005

5A. Indicate Type of Lease
STATE ☐ FEE ☒

5. State Oil & Gas Lease No.

APPLICATION FOR PERMIT TO DRILL, DEEPEN, OR PLUG BACK

1a. Type of Work b. Type of Well OIL WELL <input type="checkbox"/> GAS WELL <input checked="" type="checkbox"/> OTHER <input type="checkbox"/> DEEPEN <input type="checkbox"/> PLUG BACK <input type="checkbox"/>		7. Unit Agreement Name	
2. Name of Operator UTEX OIL COMPANY		8. Farm or Lease Name WESTLAND DEVELOPMENT	
3. Address of Operator 4700 SOUTH 9TH EAST, SUITE 41-B, SALT LAKE CITY, UTAH 84117		9. Well No. 1	
4. Location of Well UNIT LETTER P LOCATED 990 FEET FROM THE SOUTH LINE AND 990 FEET FROM THE EAST LINE OF SEC. 1 TWP. 10N RGE. 1E NMPM		10. Field and Pool, or Wildcat WILDCAT	
21. Elevations (Show whether DF, RT, etc.) 5,752 GR.		12. County BERNALILLO	
21A. Kind & Status Plug. Bond ONE WELL*		19. Proposed Depth 16,500	
21B. Drilling Contractor UTEX DRILLING CO.		19A. Formation Cretaceous DALTON	
22. Approx. Date Work will start FEBRUARY 1, 1984		20. Rotary or C.T. ROTARY	

PROPOSED CASING AND CEMENT PROGRAM

SIZE OF HOLE	SIZE OF CASING	WEIGHT PER FOOT	SETTING DEPTH	SACKS OF CEMENT	EST. TOP
17 1/2"	13 3/8"	48#	500'	Circ. to surface	
12 1/2"	9 5/8"	36#	4,000'	Circ. to surface	
8 3/4"	7"	29#	14,600'	Est. 600 sx	9,000'
Liner 6"	5"	18#	16,500'	Est. 300 sx	14,400'

Blowout preventers: A Series 1500 - 5,000 psi W.P. double gate preventer with pipe and blind rams and a Series 1500 spherical type preventer will be used. A 5,000 psi W.P. choke manifold with hydraulic super-choke, PVT and flow sensors will be used. A full opening valve will be maintained on the rig floor.

Testing: Before drilling out each casing string, blowout preventers, casing head and casing will be pressure tested and blowout preventers will be checked for proper operation each day.

COLLECT AND SACK SAMPLES FOR
NEW MEXICO BUREAU OF MINES, SOCORRO
AT AT LEAST TEN FOOT INTERVALS

*See original Bond no. U-49-13-37 attached hereto.

IN ABOVE SPACE DESCRIBE PROPOSED PROGRAM: IF PROPOSAL IS TO DEEPEN OR PLUG BACK, GIVE DATA ON PRESENT PRODUCTIVE ZONE AND PROPOSED NEW PRODUCTIVE ZONE. GIVE BLOWOUT PREVENTER PROGRAM, IF ANY.

I hereby certify that the information above is true and complete to the best of my knowledge and belief.

Signed W. Hansen Title Executive Secretary Date January 12, 1984
(This space for State Use)

APPROVED BY Carl Wilcox TITLE COMMISSIONER DATE January 23, 1984
CONDITIONS OF APPROVAL, IF ANY:

OIL CONSERVATION COMMISSION TO BE NOTIFIED
WITHIN 24 HOURS OF BEGINNING OPERATIONS

APPROVAL VALID FOR 90 DAYS
PERMIT EXPIRES 4-21-84
UNLESS DRILLING UNDERWAY

OIL CONSERVATION DIVISION

STATE OF NEW MEXICO
ENERGY AND MINERALS DEPARTMENTP. O. BOX 2088
SANTA FE, NEW MEXICO 87501Form C-102
Revised 10-1-78

All distances must be from the outer boundaries of the Section.

Operator Utex Oil Company			Lease Westland Development		Well No. 1
Unit Letter P	Section 1	Township 10 North	Range 1 East	County Bernalillo	
Actual Footage Location of Well: 990 feet from the South line and 990 feet from the East line					
Ground Level Elev. 5752	Producing Formation Point Lookout		Pool Wildcat		Dedicated Acreage: 160.00 Acres

1. Outline the acreage dedicated to the subject well by colored pencil or hachure marks on the plat below.
2. If more than one lease is dedicated to the well, outline each and identify the ownership thereof (both as to working interest and royalty).
3. If more than one lease of different ownership is dedicated to the well, have the interests of all owners been consolidated by communitization, unitization, force-pooling, etc?

☐ Yes ☐ No If answer is "yes," type of consolidation _____

If answer is "no," list the owners and tract descriptions which have actually been consolidated. (Use reverse side of this form if necessary.) _____

No allowable will be assigned to the well until all interests have been consolidated (by communitization, unitization, forced-pooling, or otherwise) or until a non-standard unit, eliminating such interests, has been approved by the Division.

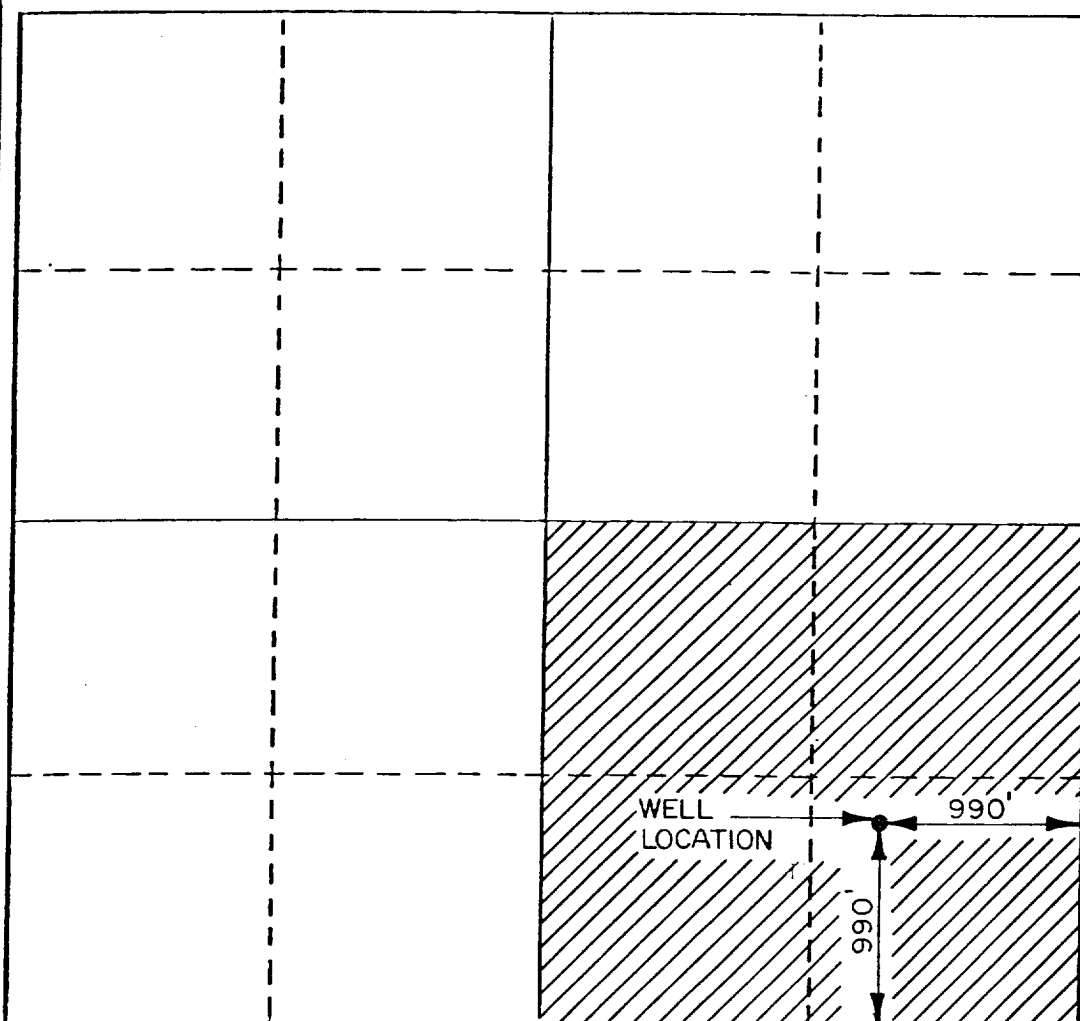

CERTIFICATION

I hereby certify that the information contained herein is true and complete to the best of my knowledge and belief.

W. Hansen
Name
Executive Secretary
Position

Company
Utex Oil Company

Date
January 12, 1984

I hereby certify that the well location shown on this plat was plotted from field notes of actual surveys made by me or under my supervision, and that the same is true and correct to the best of my knowledge and belief.

Date Surveyed
December 13, 1983
Registered Professional Engineer
and/or Land Surveyor

Certificate No.
N.M.L.S. No. 7248