

NEW MEXICO OIL CONSERVATION COMMISSION

WELL LOCATION AND ACREAGE DEDICATION PLAT

 FORM C-128
 Revised 5/1/57

SEE INSTRUCTIONS FOR COMPLETING THIS FORM ON THE REVERSE SIDE

SECTION A

Operator A. N. Spanel - W. O. Heinze			Lease Santa Fe - Pacific RR Co.		Well No. 1-9617
Unit Letter H	Section 27	Township 4 N	Range 11 W	County Catron	
Actual Footage Location of Well: <div style="display: flex; justify-content: space-between;"> 2080 feet from the North line and 560 feet from the East line </div>					
Ground Level Elev. 7675(est)	Producing Formation		Pool Wildcat		Dedicated Acreage: 160 Acres

1. Is the Operator the only owner in the dedicated acreage outlined on the plat below? YES ☒ NO ☐ . ("Owner" means the person who has the right to drill into and to produce from any pool and to appropriate the production either for himself or for himself and another. (65-3-29 (e) NMSA 1935 Comp.)
2. If the answer to question one is "no," have the interests of all the owners been consolidated by communitization agreement or otherwise? YES ☐ NO ☐ . If answer is "yes," Type of Consolidation _____
3. If the answer to question two is "no," list all the owners and their respective interests below:

Owner	Land Description

SECTION B

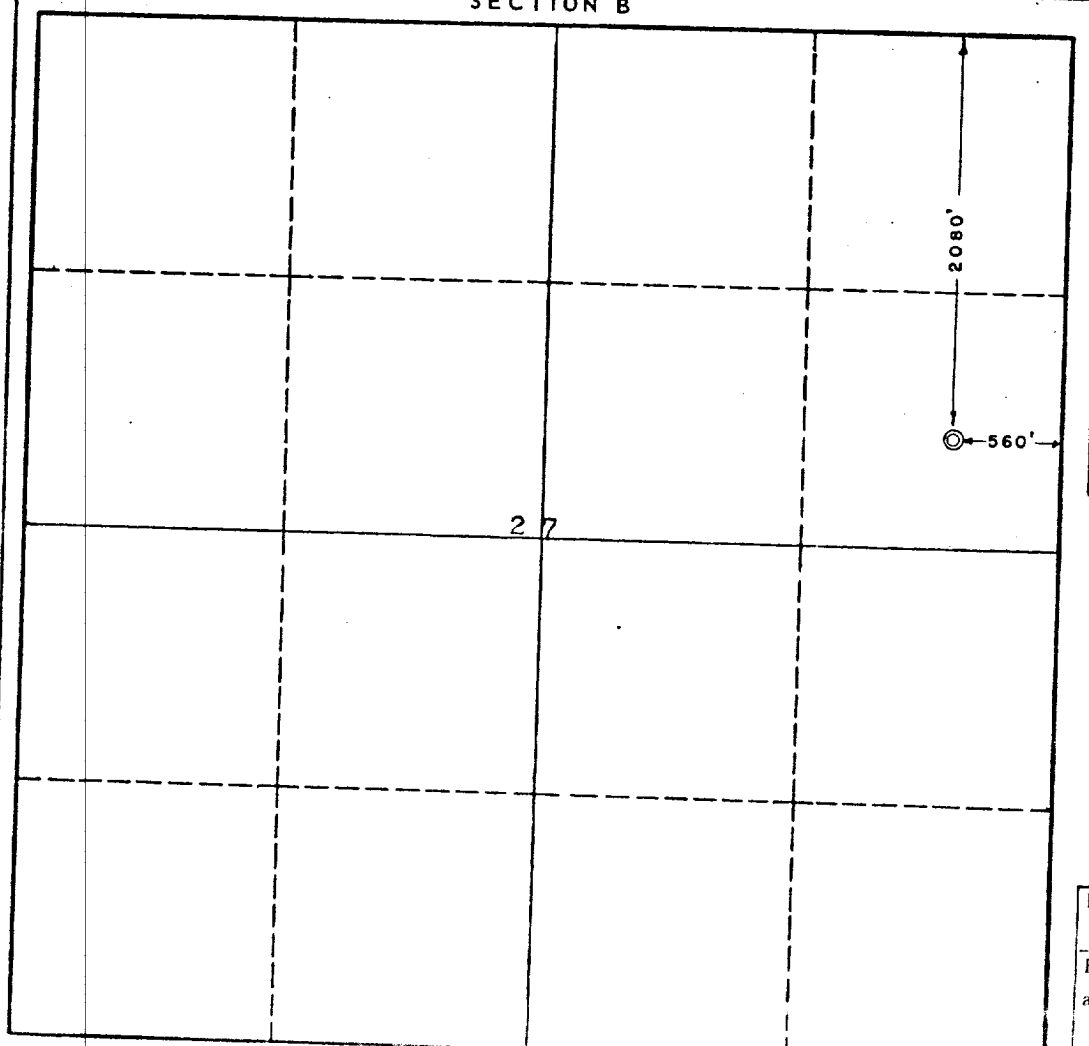

CERTIFICATION

I hereby certify that the information in SECTION A above is true and complete to the best of my knowledge and belief.

 Name Lee J. Thronson

 Position Sup't - Operations
A. N. Spanel - W. O. Heinze
 Company (Individuals)

 Date June 23, 1959

I hereby certify that the well location shown on the plat in SECTION B was plotted from field notes of actual surveys made by me or under my supervision, and that the same is true and correct to the best of my knowledge and belief.

 Date Surveyed June 20, 1959

 Registered Professional Engineer
 and/or Land Surveyor
Fred D. Marmore
 Fred D. Marmore

 Certificate No. L.S. 2031

0 330 660 990 1320 1650 1980 2310 2640 2970 3300 3630 3960 4290 4620 4950 5280 5610 5940 6270 6600