

NO. OF COPIES RECEIVED	
DISTRIBUTION	
SANTA FE	
FILE	✓
U.S.G.S.	
LAND OFFICE	
OPERATOR	

NEW MEXICO OIL CONSERVATION COMMISSION

Form C-101
Revised 1-1-65

API #30-003-20014

APPLICATION FOR PERMIT TO DRILL, DEEPEN, OR PLUG BACK

1a. Type of Work		5A. Indicate Type of Lease	
		STATE <input type="checkbox"/> FEE <input checked="" type="checkbox"/>	
b. Type of Well		5. State Oil & Gas Lease No.	
DRILL <input checked="" type="checkbox"/> DEEPEN <input type="checkbox"/> PLUG BACK <input type="checkbox"/>			
OIL WELL <input checked="" type="checkbox"/> GAS WELL <input type="checkbox"/> OTHER <input type="checkbox"/> SINGLE ZONE <input type="checkbox"/> MULTIPLE ZONE <input type="checkbox"/>			
2. Name of Operator		7. Unit Agreement Name	
Black Oil, Inc.			
3. Address of Operator		8. Farm or Lease Name	
P.O. Box 537, Farmington, NM 87499		SFPRR	
4. Location of Well		9. Well No.	
UNIT LETTER <u>F</u> LOCATED <u>1560</u> FEET FROM THE <u>North</u> LINE		21-6	
AND <u>1575</u> FEET FROM THE <u>West</u> LINE OF SEC. <u>21</u> TWP. <u>3N</u> RGE. <u>9W</u> NMMPM		10. Field and Pool, or Wildcat	
		Wildcat	
		12. County	
		Catron	
		19. Proposed Depth	
		1000	
		19A. Formation	
		Dakota	
		20. Rotary or C.T.	
		Rotary	
21. Elevations (Show whether DF, RT, etc.)		22. Approx. Date Work will start	
7130 GL		1 November 1986	
21A. Kind & Status Plug. Bond		21B. Drilling Contractor	
Blanket		Salazar Drlg.	

PROPOSED CASING AND CEMENT PROGRAM

SIZE OF HOLE	SIZE OF CASING	WEIGHT PER FOOT	SETTING DEPTH	SACKS OF CEMENT	EST. TOP
8-1/2"	6-5/8"	22#	500'	40	Surface

We intend to air drill an 8-1/2" hole to 500' and set 6-5/8" casing. We will then drill a 6-1/4" hole to test the Dakota at 1000'. In the event oil and/or gas are found, we will run 4-1/2" slotted liner across the producing interval, or 4-1/2" casing and cement and perforate, and attempt a completion.

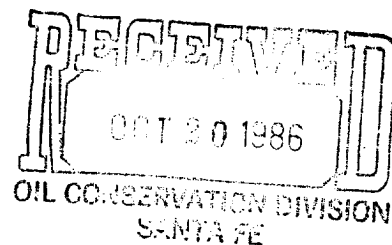

IN ABOVE SPACE DESCRIBE PROPOSED PROGRAM: IF PROPOSAL IS TO DEEPEN OR PLUG BACK, GIVE DATA ON PRESENT PRODUCTIVE ZONE AND PROPOSED NEW PRODUCTIVE ZONE. GIVE BLOWOUT PREVENTER PROGRAM, IF ANY.

I hereby certify that the information above is true and complete to the best of my knowledge and belief.

Signed Samuel Blash Title President Date September 30, 1986

(This space for State Use)

APPROVED BY Ray Johnson TITLE DISTRICT SUPERVISOR DATE 10-20-86

CONDITIONS OF APPROVAL IF ANY: Resurvey may be required if production is encountered, NSL must be approved prior to Allowable

All distances must be from the outer boundaries of the Section.

Operator Black Oil, Inc.			Lease SFPRR			Well No. 21-6		
Unit Letter F	Section 21	Township 3N	Range 9W	County Catron				
Actual Footage Location of Well: 1560 feet from the North line and 1575 feet from the west line								
Ground Level Elev. 7130	Producing Formation unknown		Pool Wildcat			Dedicated Acreage: 40		

1. Outline the acreage dedicated to the subject well by colored pencil or hachure marks on the plat below.
2. If more than one lease is dedicated to the well, outline each and identify the ownership thereof (both as to working interest and royalty).
3. If more than one lease of different ownership is dedicated to the well, have the interests of all owners been consolidated by communitization, unitization, force-pooling, etc?

☐ Yes ☒ No If answer is "yes," type of consolidation _____

If answer is "no," list the owners and tract descriptions which have actually been consolidated. (Use reverse side of this form if necessary.) _____

No allowable will be assigned to the well until all interests have been consolidated (by communitization, unitization, forced-pooling, or otherwise) or until a non-standard unit, eliminating such interests, has been approved by the Division

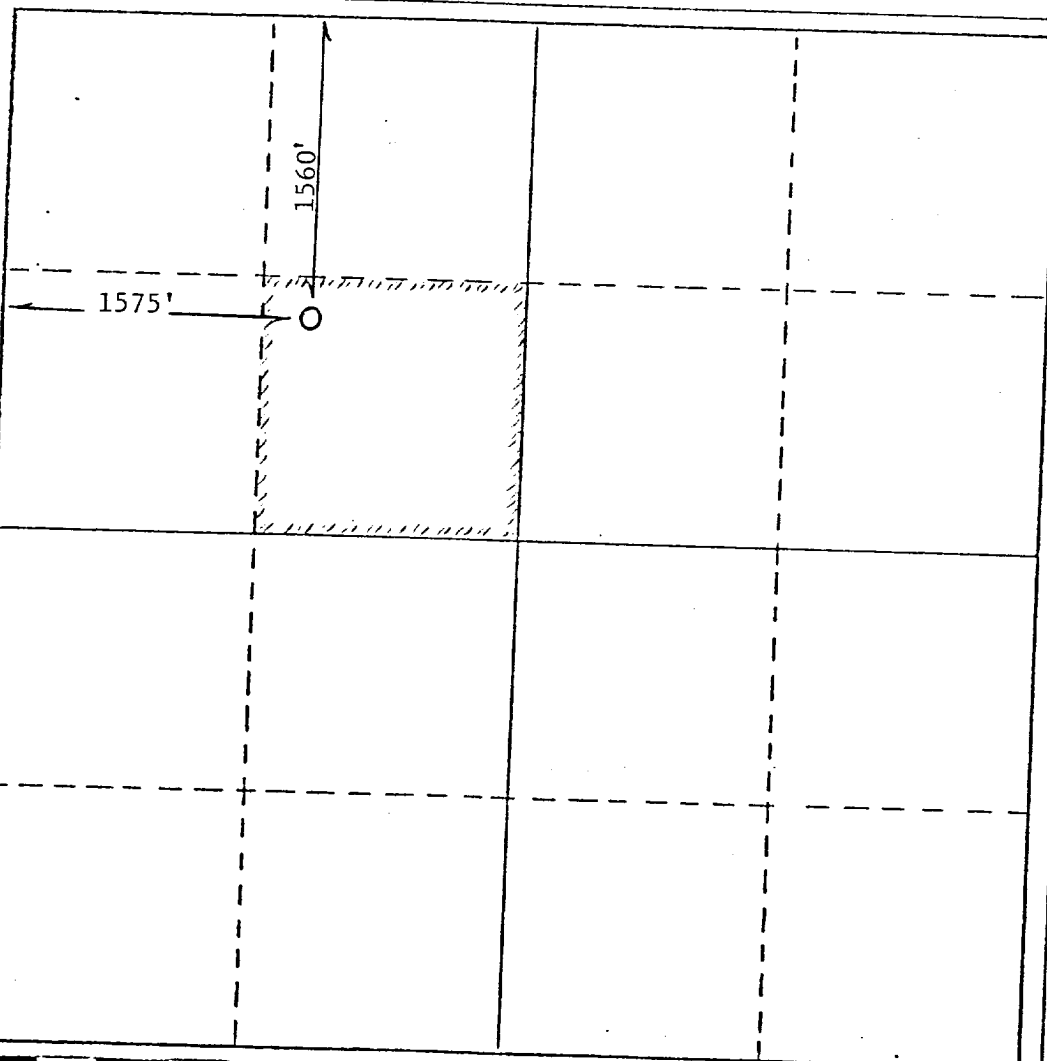

CERTIFICATION

I hereby certify that the information contained herein is true and complete to the best of my knowledge and belief.

Name
Bruce A. Black

Position
President

Company
Black Oil, Inc.

Date
September 30, 1986

I hereby certify that the well location shown on this plat was plotted from field notes of actual surveys made by me or under my supervision, and that the same is true and correct to the best of my knowledge and belief.

September 12, 1986
Date Surveyed
Professional Engineer and Land Surveyor
BRUCE A. BLACK
AIPG 1743
Certificate No. 1917
AAPG No. 1743

