

DISTRIBUTION	
SANTA FE	
FILE	
U.S.G.S.	
LAND OFFICE	
TRANSPORTER	OIL
	GAS
PRODUCTION OFFICE	
OPERATOR	

NEW MEXICO OIL CONSERVATION COMMISSION
WELL LOCATION AND ACREAGE DEDICATION PLAT
 SEE INSTRUCTIONS FOR COMPLETING THIS FORM ON THE REVERSE SIDE

FORM C-128
 Revised 5/1/57

SECTION A					
Operator OBIE SHAW			Lease Federal		Well No. 1-A
Unit Letter H	Section 36	Township 12N	Range 9W	County Valencia	
Actual Footage Location of Well: 2220 feet from the North line and 460 feet from the East line					
Ground Level Elev. 7162		Producing Formation Wildcat		Dedicated Acreage: 40 Acres	

1. Is the Operator the only owner in the dedicated acreage outlined on the plat below? YES X NO ____ . ("Owner" means the person who has the right to drill into and to produce from any pool and to appropriate the production either for himself or for himself and another. (65-3-29 (e) NMSA 1935 Comp.)
2. If the answer to question one is "no," have the interests of all the owners been consolidated by communitization agreement or otherwise? YES ____ NO ____ . If answer is "yes," Type of Consolidation _____
3. If the answer to question two is "no," list all the owners and their respective interests below:

Owner	Land Description

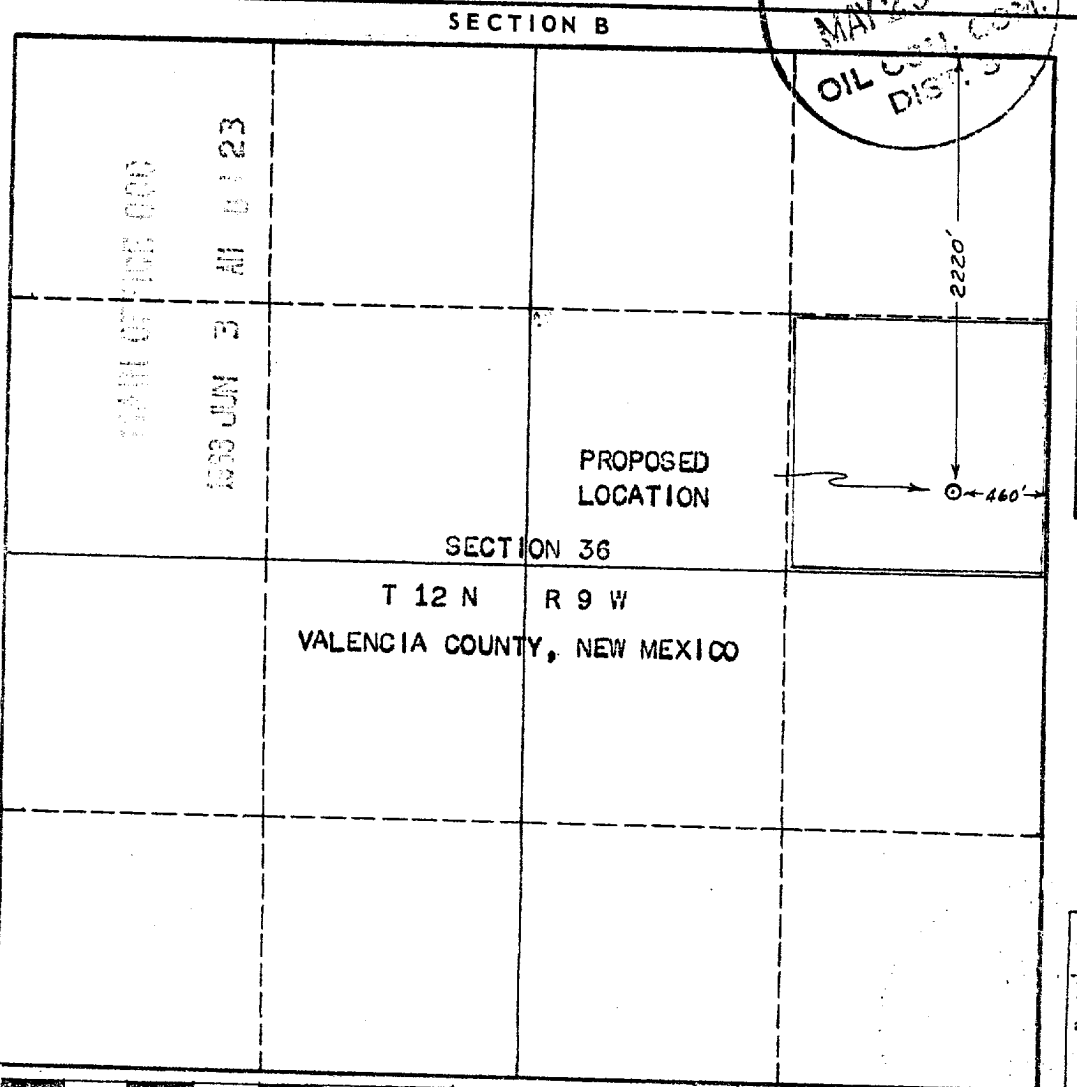

CERTIFICATION
 U.S. DEPARTMENT OF THE INTERIOR
 BUREAU OF LAND MANAGEMENT

I hereby certify that the information in SECTION A above is true and complete to the best of my knowledge and belief.

R.E. Lauth
 Name
R.E. Lauth
 Position
Geologist
 Company
OBIE SHAW
 Date
May 27, 1963

I hereby certify that the well location shown on the plat in SECTION B was plotted from field notes of actual surveys made by me or under my supervision, and that the same is true and correct to the best of my knowledge and belief.

Date Surveyed
MAY 24, 1963

Registered Professional Engineer and/or Land Surveyor
John M. Clark
 Certificate No.
73122