

NO. OF COPIES RECEIVED	
DISTRIBUTION	
SANTA FE	
FILE	
U.S.G.S.	
LAND OFFICE	
OPERATOR	

NEW MEXICO OIL CONSERVATION COMMISSION

Form C-101
Revised 1-1-65

API # 30-006-20005

5A. Indicate Type of Lease STATE <input type="checkbox"/> FEE <input checked="" type="checkbox"/>
5. State Oil & Gas Lease No.
7. Unit Agreement Name
8. Farm or Lease Name Santa Fe A
9. Well No. 1
10. Field and Pool, or Wildcat Wildcat
12. County Cibola
19. Proposed Depth 5170'
19A. Formation Sandia
20. Rotary or C.T. Rotary
21. Elevations (Show whether DF, RT, etc.) 7089' GR
21A. Kind & Status Plug. Bond Required/Approved
21B. Drilling Contractor Unknown
22. Approx. Date Work will start November 15, 1982

APPLICATION FOR PERMIT TO DRILL, DEEPEN, OR PLUG BACK

1a. Type of Work b. Type of Well OIL WELL <input checked="" type="checkbox"/> GAS WELL <input type="checkbox"/> OTHER <input type="checkbox"/>	DRILL <input checked="" type="checkbox"/> DEEPEN <input type="checkbox"/> PLUG BACK <input type="checkbox"/>
2. Name of Operator Cities Service Company-	SINGLE ZONE <input checked="" type="checkbox"/> MULTIPLE ZONE <input type="checkbox"/>
3. Address of Operator P.O. Box 1919 - Midland, Texas 79702	
4. Location of Well UNIT LETTER G LOCATED 2310 FEET FROM THE North LINE AND 2310 FEET FROM THE East LINE OF SEC. 27 TWP. 5N RGE. 7W NMPM	
21. Elevations (Show whether DF, RT, etc.) 7089' GR	21A. Kind & Status Plug. Bond Required/Approved
21B. Drilling Contractor Unknown	22. Approx. Date Work will start November 15, 1982

PROPOSED CASING AND CEMENT PROGRAM

SIZE OF HOLE	SIZE OF CASING	WEIGHT PER FOOT	SETTING DEPTH	SACKS OF CEMENT	EST. TOP
12-1/4"	8-5/8"	24#	300'	300	Circulated
7-7/8"	5 1/2"	14#	5170'	1100	Circulated

It is proposed to drill this well to a T.D. of 5170' and test the Sandia Formation. The blowout prevention program is as follows:

- One set of blind rams
- One set of drill pipe rams

APPROVAL VALID FOR 90 DAYS
PERMIT EXPIRES 2/8/83
UNLESS DRILLING UNDERWAY

The acreage assigned to this well is not dedicated to any gas purchaser.

COLLECT AND SACK SAMPLES FOR
NEW MEXICO BUREAU OF MINES, SOCORRO
AT AT LEAST TEN FOOT INTERVALS

OIL CONSERVATION COMMISSION TO BE NOTIFIED
WITHIN 24 HOURS OF BEGINNING OPERATIONS

IN ABOVE SPACE DESCRIBE PROPOSED PROGRAM: IF PROPOSAL IS TO DEEPEN OR PLUG BACK, GIVE DATA ON PRESENT PRODUCTIVE ZONE AND PROPOSED NEW PRODUCTIVE ZONE. GIVE BLOWOUT PREVENTER PROGRAM, IF ANY.

I hereby certify that the information above is true and complete to the best of my knowledge and belief.

Signed Elmer Startz Title Region Opr. Mgr. Prod. Date 11-2-82

(This space for State Use)

APPROVED BY Carl Ulloa TITLE REGIONAL MANAGER DATE 11/9/82

CONDITIONS OF APPROVAL, IF ANY:

All distances must be from the outer boundaries of the Section.

Operator CITIES SERVICE COMPANY			Lease SANTA FE "A"		Well No. 1
Unit Letter G	Section 27	Township 5N	Range 7W	County CIBOLA	
Actual Footage Location of Well: 2310 feet from the North line and 2310 feet from the East line					
Ground Level Elev: 7089	Producing Formation Sandia		Pool Wildcat	Dedicated Acreage: 40 Acres	

1. Outline the acreage dedicated to the subject well by colored pencil or hachure marks on the plat below.
2. If more than one lease is dedicated to the well, outline each and identify the ownership thereof (both as to working interest and royalty).
3. If more than one lease of different ownership is dedicated to the well, have the interests of all owners been consolidated by communitization, unitization, force-pooling, etc?

☐ Yes ☐ No If answer is "yes," type of consolidation _____

If answer is "no," list the owners and tract descriptions which have actually been consolidated. (Use reverse side of this form if necessary.) _____

No allowable will be assigned to the well until all interests have been consolidated (by communitization, unitization, forced-pooling, or otherwise) or until a non-standard unit, eliminating such interests, has been approved by the Commission.

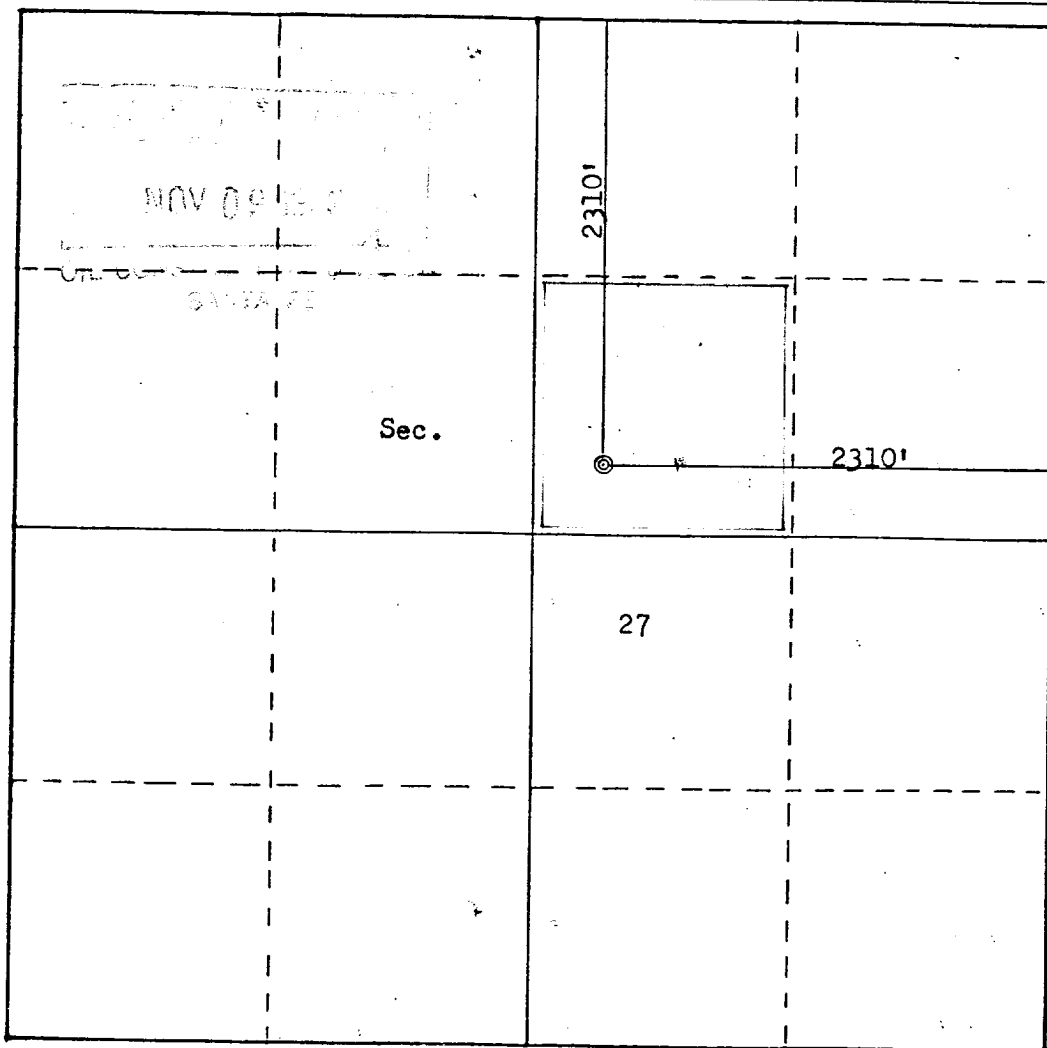

Scale: 1"=1000'

CERTIFICATION

I hereby certify that the information contained herein is true and complete to the best of my knowledge and belief.

Name
Elmer Startz
Position
Region Opr. Mgr. - Prod.
Company
Cities Service Company

Date
November 2, 1982

I hereby certify that the well location shown on this plat was plotted from field notes of actual surveys made by me or under my supervision, and that the same is true and correct to the best of my knowledge and belief.

Date Surveyed
October 27, 1982
Registered Professional Engineer
and Land Surveyor
Fred B. Kerr Jr.
Certificate No. **4622**