

NEW MEXICO OIL CONSERVATION COMMISSION
Santa Fe, New Mexico

Form C-101
Revised (12/1/55)

NOTICE OF INTENTION TO DRILL

Notice must be given to the District Office of the Oil Conservation Commission and approval obtained before drilling or recompletion begins. If changes in the proposed plan are considered advisable, a copy of this notice showing such changes will be returned to the sender. Submit this notice in **QUINTUPPLICATE**. One copy will be returned following approval. See additional instructions in Rules and Regulations of the Commission. If State Land submit 6 Copies Attach Form G- 128 in triplicate to first 3 copies of form C-101

Springer, New Mexico
(Place)

April 10, 1957
(Date)

OIL CONSERVATION COMMISSION
SANTA FE, NEW MEXICO

Gentlemen:

You are hereby notified that it is our intention to commence the Drilling of a well to be known as

Lyle A. Garner

(Company or Operator)

Mesa Ranch Company
(Lessee)

, Well No. 1, in E The well is

located 1650 feet from the North line and 990 feet from the West line of Section 27, T. 28-N., R. 21-E., NMPM.

(GIVE LOCATION FROM SECTION LINE) Wildcat Pool, Colfax County

D	C	B	A
E	F	G	H
L	K	J	I
M	N	O	P

If State Land the Oil and Gas Lease is No.

If patented land the owner is Mesa Ranch Company

Address Springer, New Mexico

We propose to drill well with drilling equipment as follows:

Rotary Drilling Rig

The status of plugging bond is \$5,000.00

Drilling Contractor Mahres Drilling Company

Artesia, New Mexico P. O. Box 845

We intend to complete this well in the Dakota

formation at an approximate depth of 1400 feet.

CASING PROGRAM

We propose to use the following strings of Casing and to cement them as indicated:

Size of Hole	Size of Casing	Weight per Foot	New or Second Hand	Depth	Backs Cement
11"	8 5/8"	24 lb.	used	80'	50
7 7/8"	5 1/2"	15 1/2 lb.	new	1400' ✓	125
Gun perforate to complete					

If changes in the above plans become advisable we will notify you immediately.

ADDITIONAL INFORMATION (If recompletion give full details of proposed plan of work.)

APR 18 1957

Approved _____, 19_____
Except as follows:

NEW MEXICO BUREAU OF MINES, SOCORRO
AT AT LEAST TEN FOOT INTERVALS

OIL CONSERVATION COMMISSION

DANIEL S. NUTTER
Petroleum Engineer

Sincerely yours,

Lyle A. Garner

(Company or Operator)

By

Position

Send Communications regarding well to

Name

Address

Lyle A. Garner
1529 So. Forest St.
Springer, N. M.

NEW MEXICO
OIL CONSERVATION COMMISSION

Form C-128

Well Location and/or Gas Proration Plat

Date April 10, 1957

Operator Lyle A. Garner Lease Mesa Ranch Company

Well No. 1 Section 27 Township 25-N. Range 21-E. NMPM

Located 1650 Feet From North Line, 290 Feet From West Line,

Colfax County, New Mexico. G. L. Elevation 3000±

Name of Producing Formation Dakota Pool Wildcat Dedicated Acreage 40

(Note: All distances must be from outer boundaries of Section)

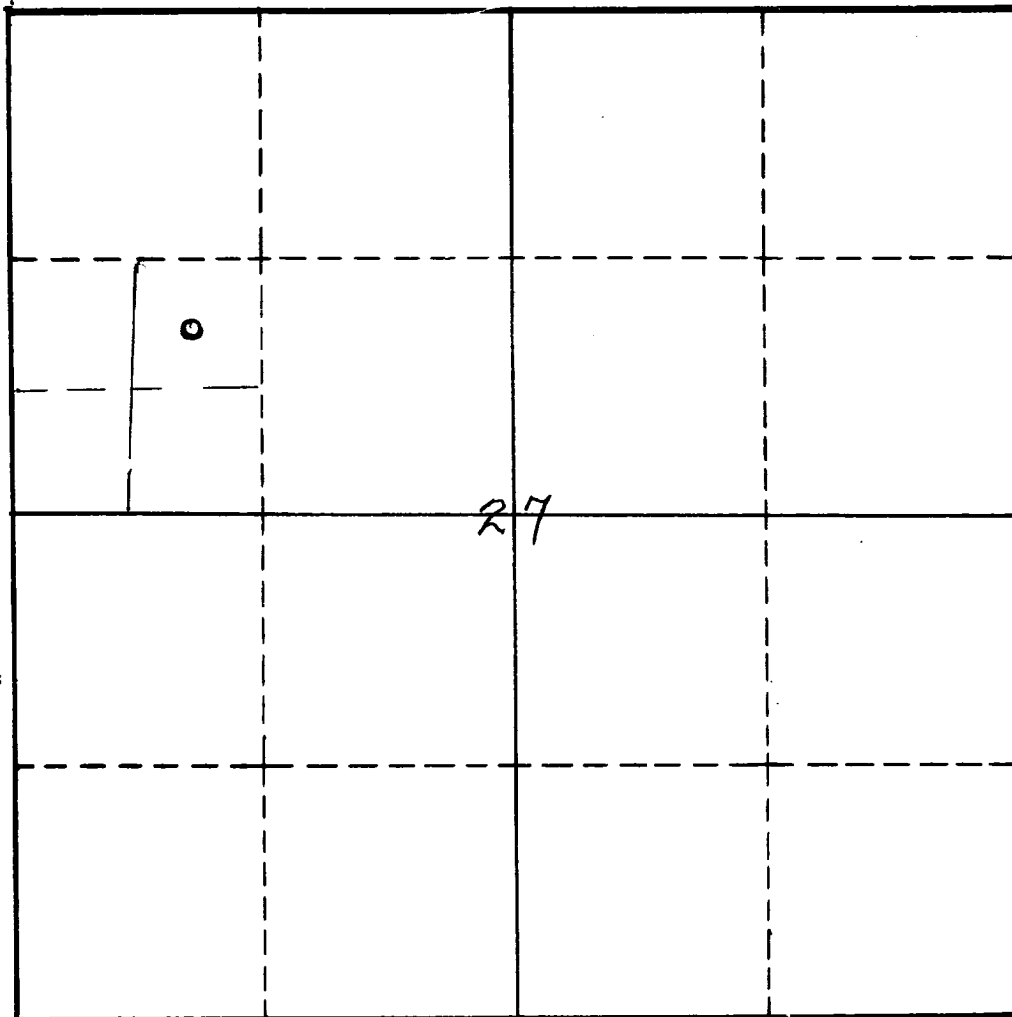

NOTE

This section of
form is to be
used for gas
wells only.



SCALE: 1"=1000'

1. Is this Well a Dual Comp. ? Yes No ☒.
2. If the answer to Question 1 is yes, are there any other dually completed wells within the dedicated acreage ? Yes No ☐.

Name Lyle A. Garner
Position owner
Representing
Address 1529 S. Forest St
Deming, N.M.

This is to certify that the above plat was prepared from field notes of actual surveys made by me or under my supervision and that the same are true and correct to the best of my knowledge and belief.

Date Surveyed April 10, 1957
P. M. Bowen
Registered Professional Engineer and/or
Land Surveyor