

NEW MEXICO OIL CONSERVATION COMMISSION
WELL LOCATION AND ACREAGE DEDICATION PLAT

RECEIVED
Form O-11
Adopted 6-12-68
Revised 1-1-65

All distances must be from the outer boundaries of the section

Operator Odessa Natural Corporation			Lease Odessa Natural Corp. W S Ranch		Well No. 1-X
Unit Letter	Section 16	Township 30N	Range 20E	County Colfax	
Actual Footage Location of Well: 2,310 feet from the south line and 987 feet from the west line					
Ground Level Elev. 7057.1	Producing Formation Dakota		Pool Wildcat	Estimated Acreage 40 Acres	

1. Outline the acreage dedicated to the subject well by colored pencil or hatchure marks on the plat below.
2. If more than one lease is dedicated to the well, outline each and identify the ownership thereof (both as to working interest and royalty).
3. If more than one lease of different ownership is dedicated to the well, have the interests of all owners been consolidated by communitization, unitization, force-pooling, etc?

☐ Yes ☐ No If answer is "yes" type of consolidation _____

If answer is "no," list the owners and tract descriptions which have actually been consolidated. (Use reverse side of this form if necessary.) _____

No allowable will be assigned to the well until all interests have been consolidated by communitization, unitization, forced-pooling, or otherwise) or until a non-standard unit, eliminating such interests, has been approved by the Commission.

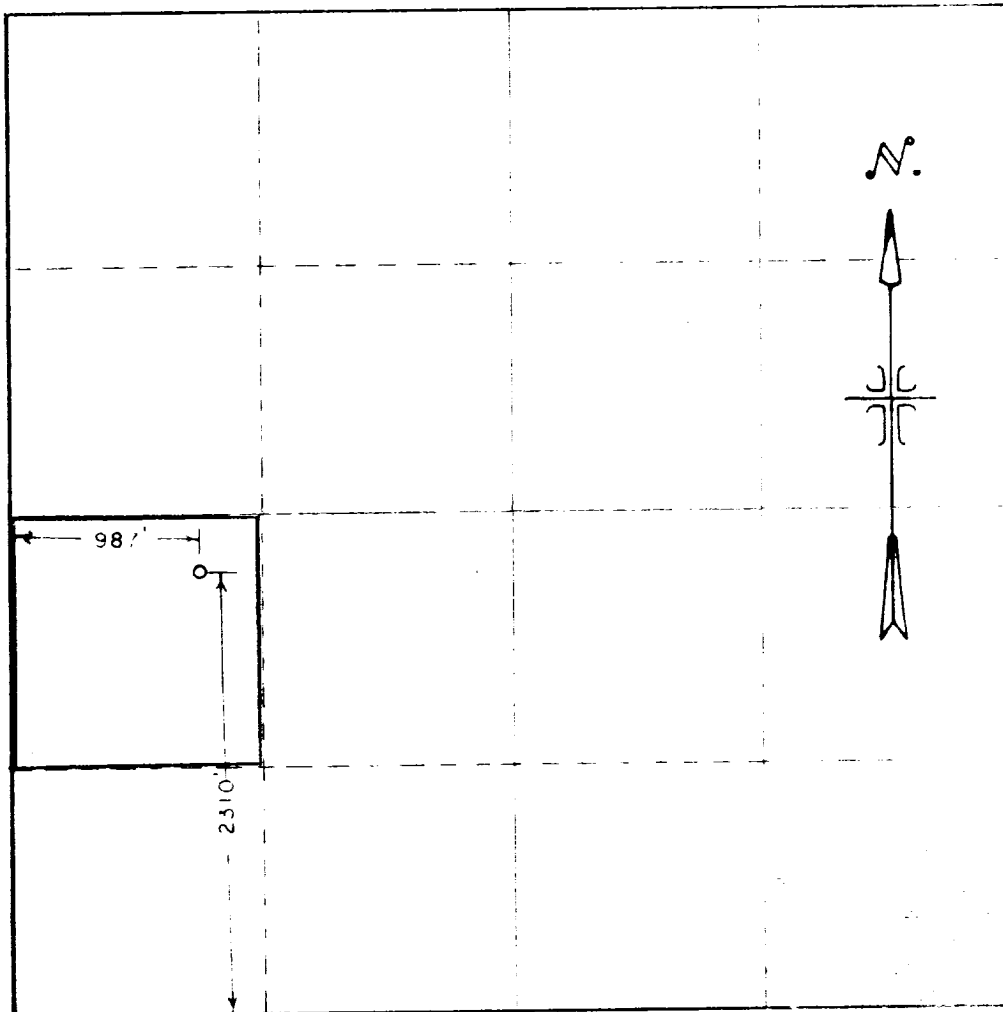

CERTIFICATION

I hereby certify that the information contained herein is true and complete to the best of my knowledge and belief.

John J. Strojek
John J. Strojek

Manager - Production

Odessa Natural Corporation

March 27, 1972

I hereby certify that the well location shown on this plat was plotted from field notes of actual surveys made by me or under my supervision, and that the same is true and correct to the best of my knowledge and belief.

J. E. Ballou Jr.

3/23/72

Surveyor General

J. E. Ballou, Jr.

3049