

NO. OF COPIES RECEIVED	
DISTRIBUTION	
SANTA FE	✓
FILE	
U.S.G.S.	
LAND OFFICE	
OPERATOR	

NEW MEXICO OIL CONSERVATION COMMISSION

Form C-101
Revised 1-1-65

5A. Indicate Type of Lease
STATE ☐ FEE ☒

5. State Oil & Gas Lease No.

20005

APPLICATION FOR PERMIT TO DRILL, DEEPEN, OR PLUG BACK

1a. Type of Work b. Type of Well OIL WELL <input type="checkbox"/> GAS WELL <input checked="" type="checkbox"/> OTHER <input type="checkbox"/>		DRILL <input checked="" type="checkbox"/> DEEPEN <input type="checkbox"/> PLUG BACK <input type="checkbox"/>		7. Unit Agreement Name	
2. Name of Operator ODESSA NATURAL CORPORATION				8. Farm or Lease Name Odessa Natural Corp. W S Ranch	
3. Address of Operator P. O. Box 3908, Odessa, Texas 79760				9. Well No. 3	
4. Location of Well UNIT LETTER M LOCATED 342 FEET FROM THE West LINE AND 537 FEET FROM THE South LINE OF SEC. 24 TWP. 29N RGE. 19E NMPM				10. Field and Pool, or Wildcat Wildcat	
				12. County Colfax	
19. Proposed Depth 5600'		19A. Formation Dakota'		20. Rotary or C.T. Rotary	
21. Elevations (Show whether DF, RT, etc.) GR 7271' KB 7284'		21A. Kind & Status Plug. Bond \$10,000 Blanket		21B. Drilling Contractor Loffland Brothers	
				22. Approx. Date Work will start April 6, 1972	

PROPOSED CASING AND CEMENT PROGRAM

SIZE OF HOLE	SIZE OF CASING	WEIGHT PER FOOT	SETTING DEPTH	SACKS OF CEMENT	EST. TOP
12-1/4"	8-5/8"	24.0	200'	175	Surface
7-7/8"	4-1/2"	10.5	5600'	250	4700'

It is proposed to drill this well to a depth sufficient to test the Dakota formation using rotary tools and the following program:

0 - 4000' Fresh water - Native mud; 4000' - TD Fresh water gel chemical mud.
Wt. approximately 9.3. Vis. 35-40. WL 3-7 cc.

All possible producing intervals will be perforated and sandfractured.

The Southwest Quarter of the Southwest Quarter of Section 24 is dedicated to this well.
SW/4 SW/4 Section 24, Township 29 North, Range 19 East

A double gate hydraulic blow-out preventer will be utilized in drilling this well.

This preventer will be tested daily to maintain a reliable operative condition.

APPROVAL VALID
FOR 90 DAYS UNLESS
DRILLING COMMENCED,
EXPIRES July 9, 1972

IN ABOVE SPACE DESCRIBE PROPOSED PROGRAM: IF PROPOSAL IS TO DEEPEN OR PLUG BACK, GIVE DATA ON PRESENT PRODUCTIVE ZONE AND PROPOSED NEW PRODUCTIVE ZONE. GIVE BLOWOUT PREVENTER PROGRAM, IF ANY.

I hereby certify that the information above is true and complete to the best of my knowledge and belief.

Signed John A. Strojek Title Manager - Production Date April 3, 1972

APPROVED BY John J. Strojek (This space for State Use)
John J. Strojek TITLE Oil & Gas Inspector DATE Apr. 10, 1972
CONDITIONS OF APPROVAL, IF ANY:

5/NMOCC-Santa Fe, 1/WSRanch, 1/RLH, 1/JBrown, 1/JJS, 1/LC, 1/WFile (All w/plats)

COLLECT AND SACK SAMPLES FOR
NEW MEXICO BUREAU OF MINES, SOCORRO

NEW MEXICO OIL CONSERVATION COMMISSION
WELL LOCATION AND ACREAGE DEDICATION PLAT

CE-111-D
Form C-111-D
Supersedes C-111-D
11/10/65

All distances must be from the outer boundaries of the Section

Operator Odessa Natural Corporation		Lease ODESSA NATURAL CORPORATION W S RANCH		Well No. 3
Unit Letter 	Section 24	Division 29N	Range 19E	County Colfax
Actual Depth of Well: 537 feet from the south line and 342 feet from the west line				
Ground Level Elev. 7271	Producing Formation Dakota		Well Name Wildcat	Estimated Acreage 40 Acres

1. Outline the acreage dedicated to the subject well by colored pencil or hashare marks on the plat below.
2. If more than one lease is dedicated to the well, outline each and identify the ownership thereof (both as to working interest and royalty).
3. If more than one lease of different ownership is dedicated to the well, have the interests of all owners been consolidated by communitization, unitization, force-pooling, etc?

☐ Yes ☐ No If answer is "yes" type of consolidation _____

If answer is "no" list the owners and tract descriptions which have actually been consolidated (Use reverse side of this form if necessary.) _____

No allowable will be assigned to the well until all interests have been consolidated by communitization, unitization, forced-pooling, or otherwise or until a non-standard unit, eliminating such interests, has been approved by the Commission.

No section corners located in this area.

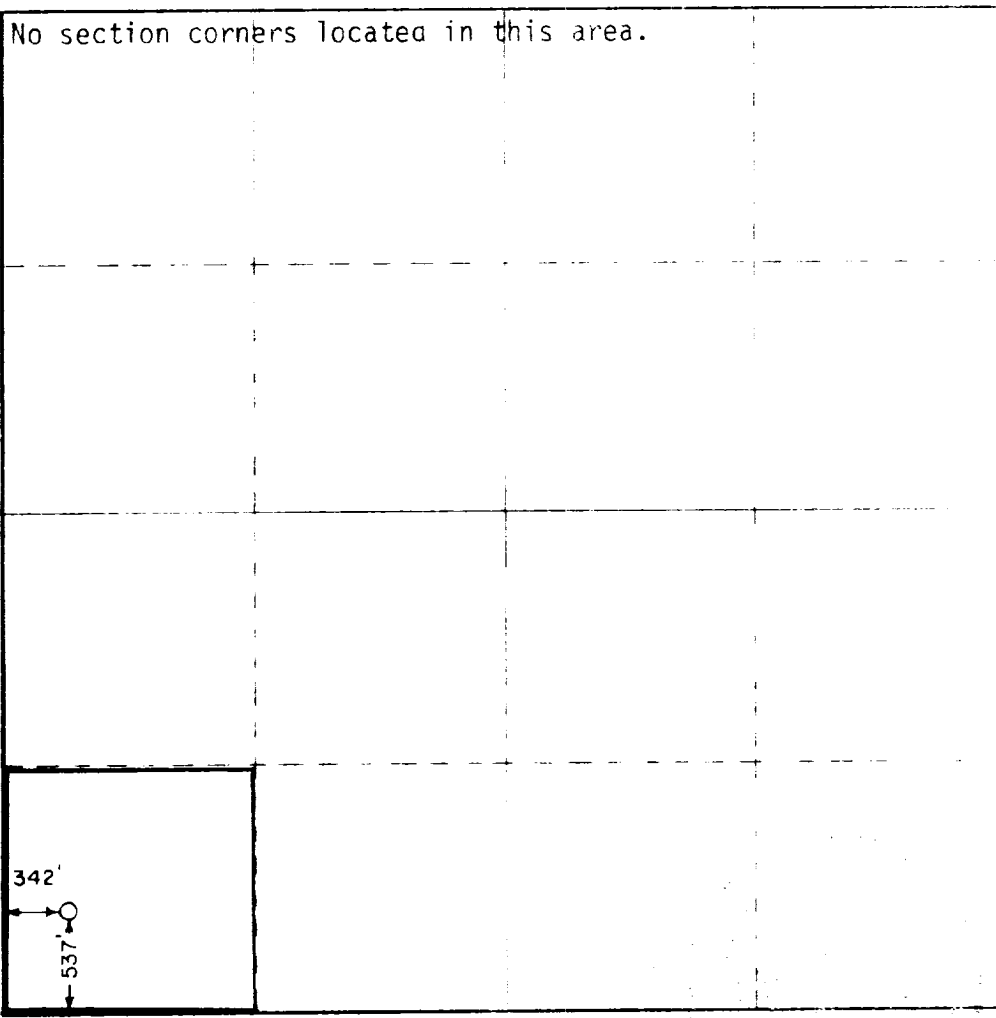

CERTIFICATION

I hereby certify that the information contained herein is true and complete to the best of my knowledge and belief.

John J. Strojek
JOHN J. STROJER/so

Manager - Production Dept.

ODESSA NATURAL CORPORATION

April 3, 1972

I hereby certify that the well location shown on this plat was plotted from field notes of actual surveys made by me or under my supervision, and that the same is true and correct to the best of my knowledge and belief.

Walter E. Brown

3/23/72

Registered Professional Engineer
in the State of New Mexico

Land Surveyor

4403