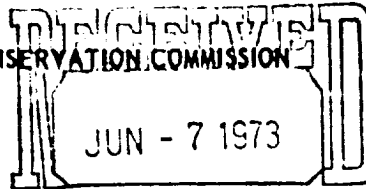

30-007-20019

NEW MEXICO OIL CONSERVATION COMMISSION

OIL CONSERVATION COMM.
Santa FeForm C-101
Revised 1-1-65

NO. OF COPIES RECEIVED	
DISTRIBUTION	
SANTA FE	
FILE	
U.S.G.S.	
LAND OFFICE	
OPERATOR	

5A. Indicate Type of Lease	
STATE <input checked="" type="checkbox"/>	FEED <input type="checkbox"/>
5. State Oil & Gas Lease No.	

APPLICATION FOR PERMIT TO DRILL, DEEPEN, OR PLUG BACK

1a. Type of Work				7. Unit Agreement Name	
b. Type of Well OIL WELL <input type="checkbox"/> GAS WELL <input checked="" type="checkbox"/> OTHER <input type="checkbox"/>				8. Firm or Lease Name STATE EX	
DEEPEN <input type="checkbox"/> PLUG BACK <input type="checkbox"/>				9. Well No. 1	
2. Name of Operator Amoco Production Company				10. Field and Pool, or Wildcat WILDCAT	
3. Address of Operator BOX 68, HOBBS, N. M. 88240				12. County COLFAX	
4. Location of Well UNIT LETTER H LOCATED 1980 FEET FROM THE NORTH LINE AND 660 FEET FROM THE EAST LINE OF SEC. 14 TWP. 25-N RGE. 25-E NMPM					
19. Proposed Depth 2700'		19A. Formation BASEMENT		20. Rotary or C.T. ROTARY	
21. Elevations (Show whether DE, RT, etc.) NA		21A. Kind & Status Plug. Bond BLANKET-ON FILE		22. Approx. Date Work will start 6-73	
21B. Drilling Contractor CACTUS DRILG Co.					

PROPOSED CASING AND CEMENT PROGRAM

SIZE OF HOLE	SIZE OF CASING	WEIGHT PER FOOT	SETTING DEPTH	SACKS OF CEMENT	EST. TOP
12 1/4 - 11"	8 5/8"	24#	300'	SUFF. TO	CIRC
7 7/8"	4 1/2"	9.5#	2700'	" "	300'

APPROVAL VALID
FOR 90 DAYS UNLESS
DRILLING COMMENCED,EXPIRES Sept. 6, 1973

IN ABOVE SPACE DESCRIBE PROPOSED PROGRAM; IF PROPOSAL IS TO DEEPEN OR PLUG BACK, GIVE DATA ON PRESENT PRODUCTIVE ZONE AND PROPOSED NEW PRODUCTIVE ZONE. GIVE BLOWOUT PREVENTER PROGRAM, IF ANY.

I hereby certify that the information above is true and complete to the best of my knowledge and belief.

Signed Steve Williams Title AREA SUPERINTENDENT Date 6-4-73

(This space for State Use)

APPROVED BY J. E. Kaptaina TITLE Oil & Gas Inspector DATE 6/8/73

CONDITIONS OF APPROVAL, IF ANY:

OIL & GAS INSPECTION
C. L. BOSPCOLLECT AND SACK SAMPLES FOR
NEW MEXICO BUREAU OF MINES, SOCCORRO
AT AT LEAST TEN FOOT INTERVALS

NEW MEXICO OIL CONSERVATION COMMISSION
WELL LOCATION AND ACREAGE DEDICATION PLAT

JUN - 7 1973

Form C-10
Supersedes C-10a
Effective 1-1-65

All distances must be from the outer boundaries of the Section

Lessee AMOCO PRODUCTION COMPANY			State EX			County Santa Fe			Lease No. 1		
Unit Letter H	Section 14	Township 25 North	Range 25 East	County Colfax							
Actual Portage Location of Well: 1980 feet from the north line and 660 feet from the east line											
Ground Level Elev. NA	Producing Formation BASEMENT			Pool WILDCAT				Dedicated Acreage: 160 Acres			

1. Outline the acreage dedicated to the subject well by colored pencil or hatchure marks on the plat below.
2. If more than one lease is dedicated to the well, outline each and identify the ownership thereof (both as to working interest and royalty).
3. If more than one lease of different ownership is dedicated to the well, have the interests of all owners been consolidated by communitization, unitization, force-pooling, etc?

☐ Yes ☐ No If answer is "yes;" type of consolidation _____

If answer is "no;" list the owners and tract descriptions which have actually been consolidated. (Use reverse side of this form if necessary.) _____

No allowable will be assigned to the well until all interests have been consolidated (by communitization, unitization, forced-pooling, or otherwise) or until a non-standard unit, eliminating such interests, has been approved by the Commission.

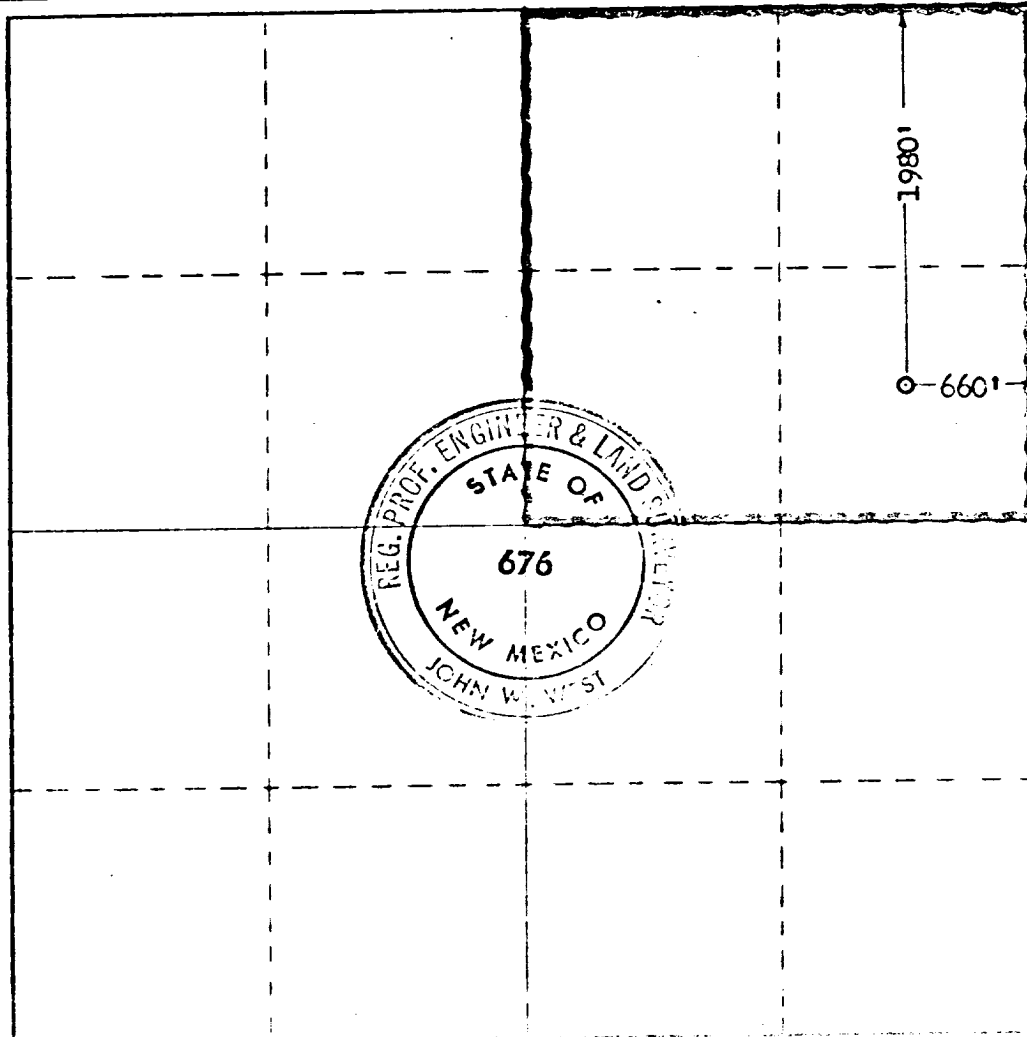

CERTIFICATION

I hereby certify that the information contained herein is true and complete to the best of my knowledge and belief.

Name *William J. Furman*
Position **AREA SUPERINTENDENT**
Company **Amoco Production Company**

Date **6/4/73**

I hereby certify that the well location shown on this plat was plotted from field notes of actual surveys made by me or under my supervision and that the same is true and correct to the best of my knowledge and belief.

Date Surveyed **May 19, 1973**

By Plat No. _____ and Lot No. _____

John W. West
676