

NO. OF COPIES RECEIVED	
DISTRIBUTION	
SANTA FE	
FILE	<input checked="" type="checkbox"/>
U.S.G.S.	
LAND OFFICE	
OPERATOR	

NEW MEXICO OIL CONSERVATION COMMISSION

API# 30-007-20030

Form C-101
Revised 1-1-65

5A. Indicate Type of Lease	
STATE <input type="checkbox"/>	FEE <input checked="" type="checkbox"/>
5. State Oil & Gas Lease No.	

APPLICATION FOR PERMIT TO DRILL, DEEPEN, OR PLUG BACK

1a. Type of Work		7. Unit Agreement Name	
b. Type of Well OIL WELL <input checked="" type="checkbox"/> GAS WELL <input type="checkbox"/> OTHER <input type="checkbox"/>		8. Farm or Lease Name	
DRILL <input checked="" type="checkbox"/> DEEPEN <input type="checkbox"/> PLUG BACK <input type="checkbox"/>		Anne Ruth Crews Bell	
2. Name of Operator		9. Well No.	
AMOCO PRODUCTION COMPANY		1	
3. Address of Operator		10. Field and Pool, or Wildcat	
501 Airport Drive, Farmington, New Mexico 87401		Wildcat	
4. Location of Well		12. County	
UNIT LETTER <u>P</u> LOCATED <u>330</u> FEET FROM THE <u>South</u> LINE		Colfax	
AND <u>330</u> FEET FROM THE <u>East</u> LINE OF SEC. <u>23</u> TWP. <u>28N</u> RGE. <u>23E</u> NMPM			
19. Proposed Depth		19A. Formation	
700'		Ft. Hays	
20. Rotary or C.T.		Rotary	
21. Elevations (Show whether DF, RT, etc.)		22. Approx. Date Work will start	
6129' GL ungraded		September 1974	
21A. Kind & Status Plug. Bond		21B. Drilling Contractor	
Statewide		Aztec Well Service	

PROPOSED CASING AND CEMENT PROGRAM

SIZE OF HOLE	SIZE OF CASING	WEIGHT PER FOOT	SETTING DEPTH	SACKS OF CEMENT	EST. TOP
11"	8-5/8"	24#	100'	50 sx	Surface
6-1/2"	4-1/2"	9.5#	700'	150 sx	Surface

Well to be drilled to test the Ft. Hays formation. Completion and stimulation will be determined from analysis of open hole logs. Copies of Location Plat attached.

Copies of well logs will be sent upon completion of the well.

APPROVAL VALID
FOR 90 DAYS UNLESS
DRILLING COMMENCED,

EXPIRES 12/23/74

IN ABOVE SPACE DESCRIBE PROPOSED PROGRAM: IF PROPOSAL IS TO DEEPEN OR PLUG BACK, GIVE DATA ON PRESENT PRODUCTIVE ZONE AND PROPOSED NEW PRODUCTIVE ZONE. GIVE BLOWOUT PREVENTER PROGRAM, IF ANY.

I hereby certify that the information above is true and complete to the best of my knowledge and belief.

Original Signed by
Signed R. E. McCLESKEY Title Area Engineer Date September 23, 1974

(This space for State Use)

ORIGINAL SIGNED BY
CARL ULVOG

APPROVED BY SENIOR PETROLEUM GEOLOGIST DATE 9/24/74

CONDITIONS OF APPROVAL, IF ANY:

COLLECT AND KEEP SAMPLES FOR
NEW MEXICO OIL CONSERVATION COMMISSION
ALBUQUERQUE, NEW MEXICO

NEW MEXICO OIL CONSERVATION COMMISSION
WELL LOCATION AND ACREAGE DEDICATION PLAT

Form C-1
Supersedes Form 128
Effective 1-1-65

All distances must be from the outer boundaries of the Section.

SEP 23 1974

Operator Amoco Production Company			Lease Anne Ruth Crews Bell		Well No.
Unit Letter P	Section 23	Township 28 North	Range 23 East	County Colfax	
Actual Footage Location of Well: 330 feet from the South line and 330 feet from the East line					
Ground Level Elev. 6129 est.	Producing Formation Ft. Hays		Pool Wildcat		Dedicated Acreage: 40 Acres

1. Outline the acreage dedicated to the subject well by colored pencil or hachure marks on the plat below.
2. If more than one lease is dedicated to the well, outline each and identify the ownership thereof (both as to working interest and royalty).
3. If more than one lease of different ownership is dedicated to the well, have the interests of all owners been consolidated by communitization, unitization, force-pooling, etc?

☐ Yes ☐ No If answer is "yes," type of consolidation _____

If answer is "no," list the owners and tract descriptions which have actually been consolidated. (Use reverse side of this form if necessary.) _____

No allowable will be assigned to the well until all interests have been consolidated (by communitization, unitization, forced-pooling, or otherwise) or until a non-standard unit, eliminating such interests, has been approved by the Commission.

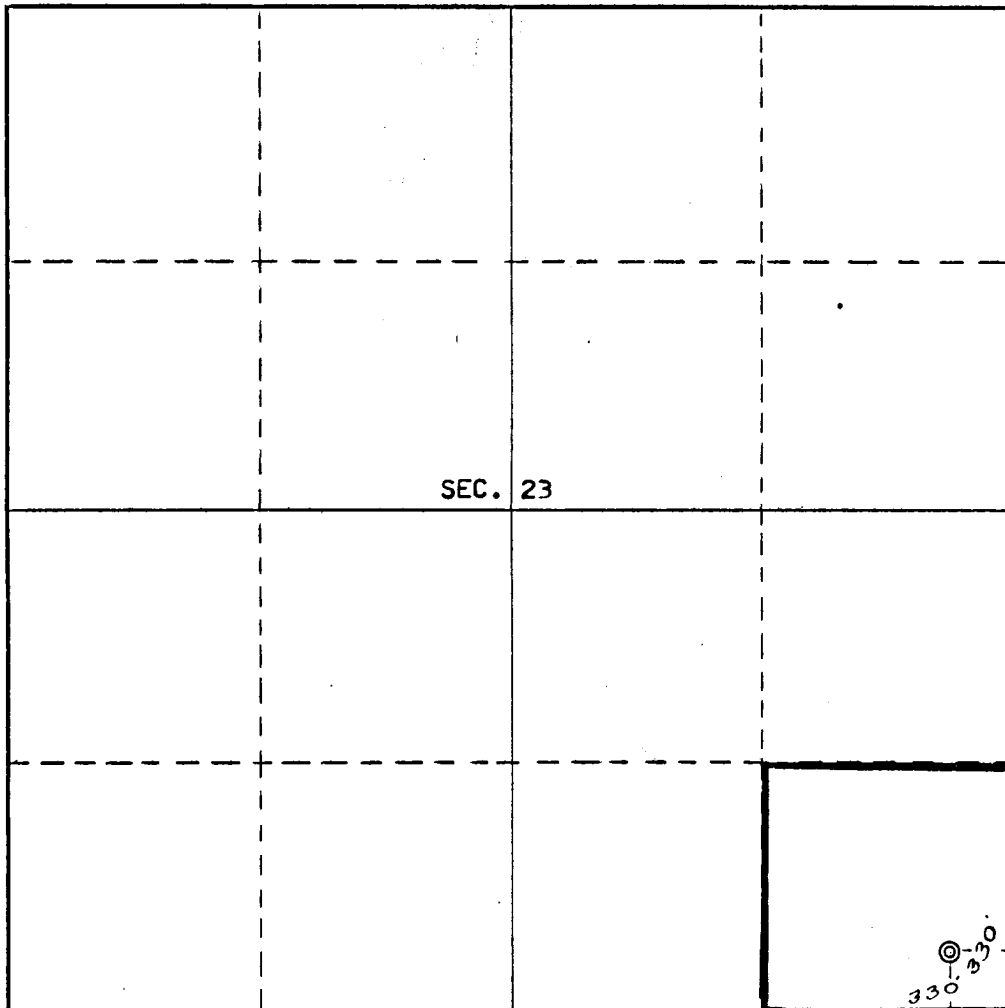

CERTIFICATION

I hereby certify that the information contained herein is true and complete to the best of my knowledge and belief.

R. E. McCleskey
Name

R. E. McCleskey

Position

Area Engineer

Company

AMOCO PRODUCTION COMPANY

Date

September 23, 1974

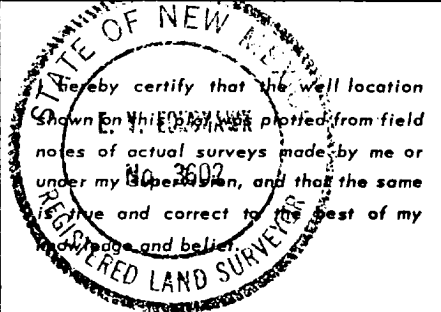

Date Surveyed

September 19, 1974

Registered Professional Engineer
and/or Land Surveyor

E. V. Echohawk

Certificate No. **3602**
E. V. Echohawk LS

