

NO. OF COPIES RECEIVED	
DISTRIBUTION	
SANTA FE	
FILE	<input checked="" type="checkbox"/>
U.S.G.S.	
LAND OFFICE	
OPERATOR	

P. O. BOX 2088
SANTA FE, NEW MEXICO 87501

API # 30-001-20048

5A. Indicate Type of Lease
STATE ☐ FEE ☒

5. State Oil & Gas Lease No.

APPLICATION FOR PERMIT TO DRILL, DEEPEN, OR PLUG BACK

1a. Type of Work DRILL <input checked="" type="checkbox"/> DEEPEN <input type="checkbox"/> PLUG BACK <input type="checkbox"/>				7. Unit Agreement Name	
b. Type of Well OIL WELL <input type="checkbox"/> GAS WELL <input type="checkbox"/> OTHER Carbon Dioxide & Hydrocarbons <input type="checkbox"/> SINGLE ZONE <input checked="" type="checkbox"/> MULTIPLE ZONE <input type="checkbox"/>				8. Farm or Lease Name T. L. Roach	
2. Name of Operator HNG FOSSIL FUELS COMPANY				9. Well No. 1	
3. Address of Operator P. O. Box 1188, Houston, Texas - 77001				10. Field and Pool, or Wildcat Wildcat	
4. Location of Well UNIT LETTER <u>H</u> LOCATED <u>1980</u> FEET FROM THE <u>North</u> LINE AND <u>660</u> FEET FROM THE <u>East</u> LINE OF SEC. <u>1</u> TWP. <u>29N</u> RGE. <u>25E</u> NMPM				12. County Colfax	
21. Elevations (Show whether DF, RT, etc.) 6660' GR				19. Proposed Depth 4000'	
21A. Kind & Status Plug. Bond Blanket on file				19A. Formation T/Granite	
21B. Drilling Contractor Texland Drilling Corp.				20. Rotary or C.T. Rotary	
22. Approx. Date Work will start 6/28/79					

PROPOSED CASING AND CEMENT PROGRAM

SIZE OF HOLE	SIZE OF CASING	WEIGHT PER FOOT	SETTING DEPTH	SACKS OF CEMENT	EST. TOP
12-1/4"	9-5/8" O.D.	32.30	250'	150 Sks.	Circulate
8-3/4"	7" O.D.	20.00	3010'	125 Sks.	2910'
6 1/2"	2 3/8" O.D.		4000'	Packer	3010'

We propose to air drill from surface to TD. If testing at that point indicates a non-commercial well, we will plug and abandon in accordance with Oil Conservation Commission regulations. If well is commercial, we will squeeze cement to tie back the 7" casing to the 9 5/8" casing.

OIL CONSERVATION COMMISSION TO BE NOTIFIED
WITHIN 24 HOURS OF BEGINNING OPERATIONS

APPROVAL VALID FOR 90 DAYS
PERMIT EXPIRES 9-25-79
UNLESS DRILLING UNDERWAY

IN ABOVE SPACE DESCRIBE PROPOSED PROGRAM: IF PROPOSAL IS TO DEEPEN OR PLUG BACK, GIVE DATA ON PRESENT PRODUCTIVE ZONE AND PROPOSED NEW PRODUCTIVE ZONE. GIVE BLOWOUT PREVENTER PROGRAM, IF ANY.

hereby certify that the information above is true and complete to the best of my knowledge and belief.

Signed Richard H. Boehm Title Administrative Manager Date June 25, 1979

(This space for State Use)

APPROVED BY Carl M. Long TITLE SENIOR GEOLOGIST DATE 6/27/79

CONDITIONS OF APPROVAL, IF ANY:

COLLECT AND SACK SAMPLES FOR
NEW MEXICO WATER RESOURCES, SOCORRO
AT AT LEAST TEN FOOT INTERVALS

NEW MEXICO OIL CONSERVATION COMMISSION
WELL LOCATION AND ACREAGE DEDICATION PLAT

Form C-102
Supersedes C-128
Effective 1-1-65

All distances must be from the outer boundaries of the Section.

Operator HNG FOSSIL FUELS COMPANY		Lease T. L. ROACH		Well No. 1
Unit Letter H	Section 1	Township T 29 N	Range R 25 E	County COLFAX
Actual Footage Location of Well: 1980 feet from the NORTH line and 660 feet from the EAST line				
Ground Level Elev. 6660	Producing Formation T/Granite	Pool Wildcat	Dedicated Acreage: 160 Acres	

1. Outline the acreage dedicated to the subject well by colored pencil or hachure marks on the plat below.
2. If more than one lease is dedicated to the well, outline each and identify the ownership thereof (both as to working interest and royalty).
3. If more than one lease of different ownership is dedicated to the well, have the interests of all owners been consolidated by communitization, unitization, force-pooling, etc?

☐ Yes ☐ No If answer is "yes," type of consolidation _____

If answer is "no," list the owners and tract descriptions which have actually been consolidated. (Use reverse side of this form if necessary.) _____

No allowable will be assigned to the well until all interests have been consolidated (by communitization, unitization, forced-pooling, or otherwise) or until a non-standard unit, eliminating such interests, has been approved by the Commission.

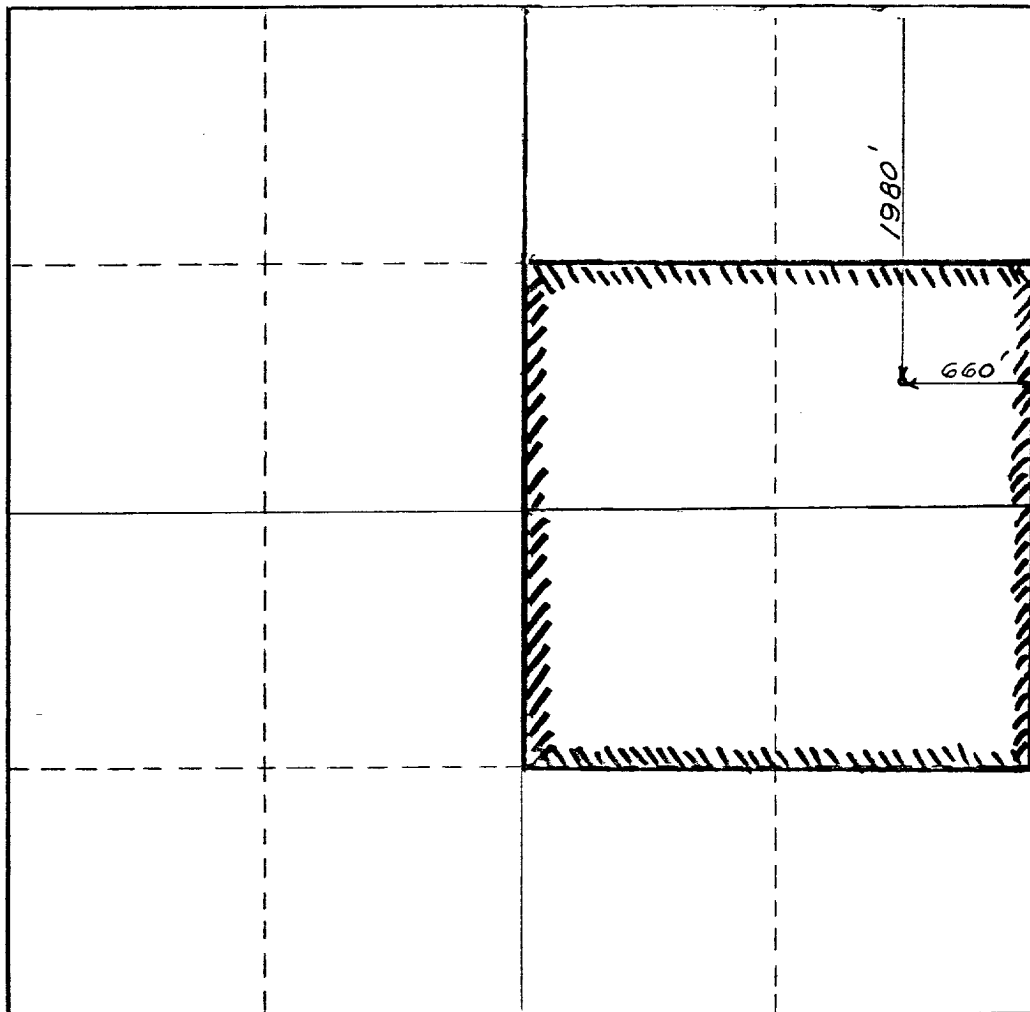

CERTIFICATION

I hereby certify that the information contained herein is true and complete to the best of my knowledge and belief.

Name *Richard H. Hahn*
Position
Administrative Manager
Company
HNG FOSSIL FUELS COMPANY
Date
June 25, 1979

I hereby certify that the well location shown on this plat was plotted from field notes of actual surveys made by me or under my supervision, and that the same is true and correct to the best of my knowledge and belief.

JUNE 14, 1979
Date Surveyed
Paul E. Schiller
Registered Professional Engineer
and/or Land Surveyor

N.M.L.S. NO. 5103
Certificate No.

0 330 660 990 1320 1650 1980 2310 2640 2970 3300 0