

NEW MEXICO OIL CONSERVATION COMMISSION
WELL LOCATION AND ACREAGE DEDICATION PLAT

Form C-102
 Supersedes C-120
 Effective 1-1-65

All distances must be from the outer boundaries of the Section.

Operator Austra-Tex Oil Co.		Lease Phelps Dodge		Well No. 1
Unit Letter F	Section 17	Township 29N	Range 21E	County Colfax
Actual Footage Location of Well:				
1,855	feet from the	North	line and	1,719
				feet from the
				West
Ground Level Elev. 7,235	Producing Formation Wildcat		Pool	Dedicated Acreage: 160-320 Acres

1. Outline the acreage dedicated to the subject well by colored pencil or hatchure marks on the plat below.
2. If more than one lease is dedicated to the well, outline each and identify the ownership thereof (both as to working interest and royalty).
3. If more than one lease of different ownership is dedicated to the well, have the interests of all owners been consolidated by communitization, unitization, force-pooling, etc?

☐ Yes ☐ No If answer is "yes," type of consolidation _____

If answer is "no," list the owners and tract descriptions which have actually been consolidated. (Use reverse side of this form if necessary.) _____

No allowable will be assigned to the well until all interests have been consolidated (by communitization, unitization, forced-pooling, or otherwise) or until a non-standard unit, eliminating such interests, has been approved by the Commission.

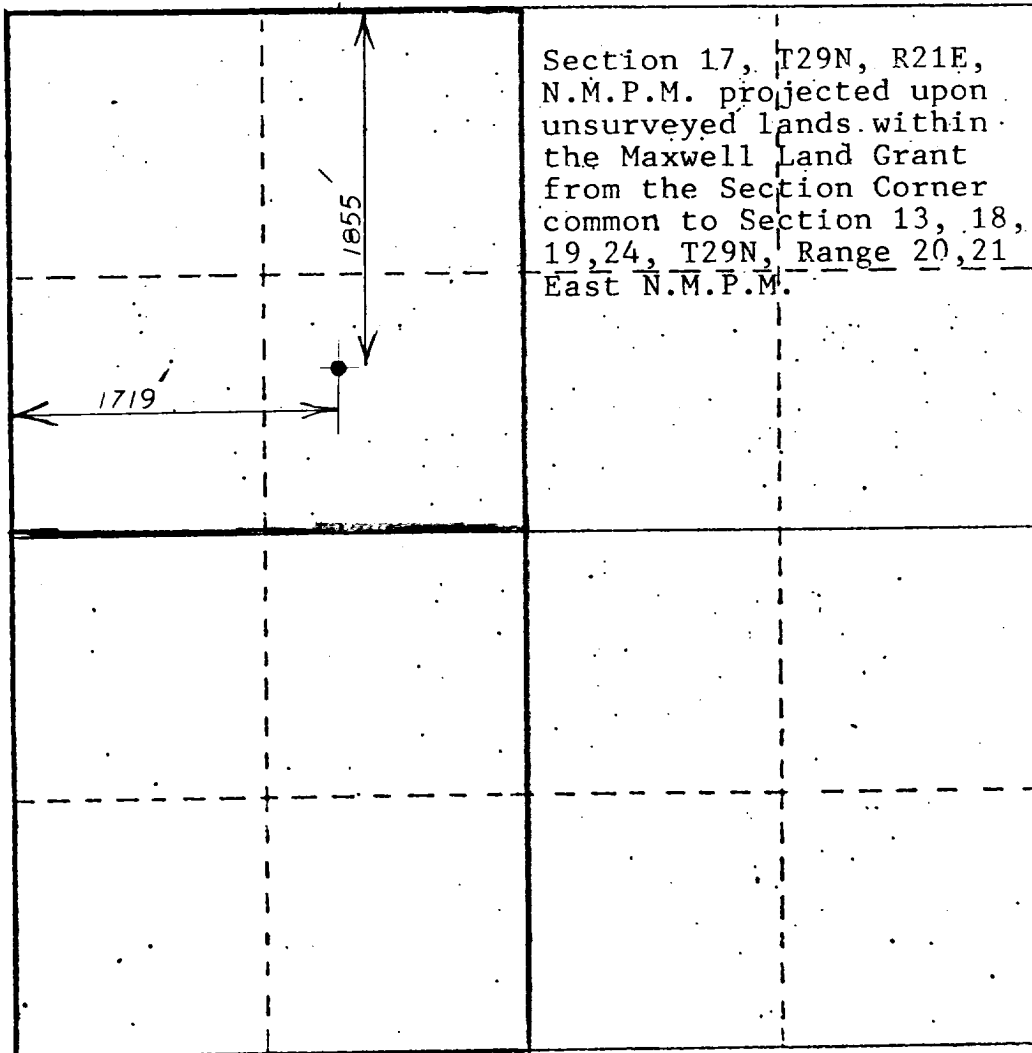

CERTIFICATION

I hereby certify that the information contained herein is true and complete to the best of my knowledge and belief.

Mark E. Thompson

Name

Geologist

Position

Austra-Tex Oil Company

Company

4-23-84

Date

I hereby certify that the well location shown on this plat was plotted from field notes of actual surveys made by me or under my supervision, and that the same is true and correct to the best of my knowledge and belief.

4/14/84

Date Surveyed

Butch R. Harris
 Registered Professional Engineer
 and/or Land Surveyor

Certificate No.