

(31a) 1963)

UNITED STATES
DEPARTMENT OF THE INTERIOR
GEOLOGICAL SURVEY

(Other Instructions on reverse side)

5. LEASE DESIGNATION AND SERIAL NO.

NM 13340

6. INDIAN, ALLOTTEE OR TRIBE NAME

SUNDRY NOTICES AND REPORTS ON WELLS

(Do not use this form for proposals to drill or to deepen or plug back to a different reservoir. Use "APPLICATION FOR PERMIT—" for such proposals.)

1. OIL WELL ☐ GAS WELL ☐ OTHER ☒ *Dry hole*

2. NAME OF OPERATOR

Continental Oil Company

3. ADDRESS OF OPERATOR

P. O. Box 460, Hobbs, New Mexico 88240

4. LOCATION OF WELL (Report location clearly and in accordance with any State requirements.* See also space 17 below.)
At surface

660' FSL and 660' FEL of Sec 25

14. PERMIT NO.

15. ELEVATIONS (Show whether OF, RT, GR, etc.)

4425' gr

12. COUNTY OR PARISH 13. STATE

Guadalupe N. Mexico

16. Check Appropriate Box To Indicate Nature of Notice, Report, or Other Data

NOTICE OF INTENTION TO:

TEST WATER SHUT-OFF

FRACTURE TREAT

SHOOT OR ACIDIZE

REPAIR WELL

(Other)

PULL OR ALTER CASING

MULTIPLE COMPLETE

ABANDON*

CHANGE PLANS

SUBSEQUENT REPORT OF:

WATER SHUT-OFF

FRACTURE TREATMENT

SHOOTING OR ACIDIZING

(Other)

REPAIRING WELL

ALTERING CASING

ABANDONMENT*

(Note: Report results of multiple completion on Well Completion or Recompletion Report and Log form.)

17. DESCRIBE PROPOSED OR COMPLETED OPERATIONS (Clearly state all pertinent details, and give pertinent dates, including estimated date of starting any proposed work. If well is directionally drilled, give subsurface locations and measured and true vertical depths for all markers and zones pertinent to this work.)*

This well was plugged and abandoned by the following procedures. Set cement plugs as follows: 50 sacks from 1306' to 1086'; 50 sacks from 880' to 660'; 50 sacks from 500' to 300' and 10 sacks from 40' to surface. Installed dry hole marker. Restored location for inspection.

Note: Verbal approval was obtained from Mr. Schmidt to perform this work.

Confidential

18. I hereby certify that the foregoing is true and correct

SIGNED

Thud Dwyer

TITLE Administrative Supervisor

DATE

12-23-71

(This space for Federal or State office use)

APPROVED BY

TITLE

DATE

CONDITIONS OF APPROVAL, IF ANY:

USGS (5) - *Durango, Colo File*

*See Instructions on Reverse Side

24 - Salt Lake City

DEPARTMENT OF THE INTERIOR (Reverse Side)
GEOLOGICAL SURVEY

SUNDRY NOTICES AND REPORTS ON WELLS

(Do not use this form for proposals to drill or to deepen or plug back to a different reservoir. Use "APPLICATION FOR PERMIT—" for such proposals.)

5. LEASE DESIGNATION AND SERIAL NO.

NM 13340

6. INDIAN, ALLOTTEE OR TRIBE NAME

7. UNIT AGREEMENT NAME

8. FARM OR LEASE NAME

Williams Fed A

9. WELL NO.

1

10. FIELD AND POOL, OR WILDCAT

Wildcat

11. SEC., T., R., M., OR B.L. AND SURVEY OR AREA

Sec 25, T-5N, R-23E

12. COUNTY OR PARISH 13. STATE

Chulup N. Mexico

1. OIL WELL ☐ GAS WELL ☐ OTHER ☒ Dry hole

2. NAME OF OPERATOR

Continental Oil Company

3. ADDRESS OF OPERATOR

P. O. Box 460, Hobbs, New Mexico 88240

4. LOCATION OF WELL (Report location clearly and in accordance with any State requirements.* See also space 17 below.)
At surface

660' FSL and 660' FEL of Sec 25

14. PERMIT NO.

15. ELEVATIONS (Show whether DT, RT, CR, etc.)

4425' gr.

16. Check Appropriate Box To Indicate Nature of Notice, Report, or Other Data

NOTICE OF INTENTION TO:

TEST WATER SHUT-OFF ☐

FRACTURE TREAT ☐

SHOOT OR ACIDIZE ☐

REPAIR WELL ☐

(Other) ☐

REEL OR ALTER CASING ☐

MULTIPLE COMPLETE ☐

ABANDON* ☒

CHANGE PLANS ☐

SUBSEQUENT REPORT OF:

WATER SHUT-OFF ☐

FRACTURE TREATMENT ☐

SHOOTING OR ACIDIZING ☐

(Other) ☐

REPAIRING WELL ☐

ALTERING CASING ☐

ABANDONMENT* ☐

(NOTE: Report results of multiple completion on Well Completion or Recompletion Report and Log form.)

17. DESCRIBE PROPOSED OR COMPLETED OPERATIONS (Clearly state all pertinent details, and give pertinent dates, including estimated date of starting any proposed work. If well is directionally drilled, give subsurface locations and measured and true vertical depths for all markers and zones pertinent to this work.)*

It is proposed to plug and abandon this well by setting cement plugs as follows: 50 socks from 1306' to 1086', 50 socks from 880' to 660', 50 socks from 500' to 300', and 10 socks from 40' to surface.

Confidential

18. I hereby certify that the foregoing is true and correct

SIGNED

Shuf Dugro

TITLE Administrative Supervisor

DATE

12-23-71

(This space for Federal or State office use)

APPROVED BY

CONDITIONS OF APPROVAL, IF ANY:

TITLE

DATE

0505 (5) - Durango, Colo File

*See Instructions on Reverse Side

12-23-71

UNITED STATES
DEPARTMENT OF THE INTERIOR
GEOLOGICAL SURVEY

SUBMIT IN DUPLICATE*

(See other instructions on reverse side)

Form approved,
Budget Bureau No. 42-R355.5.

WELL COMPLETION OR RECOMPLETION REPORT AND LOG*

1a. TYPE OF WELL: OIL WELL ☐ GAS WELL ☐ DRY ☐ Other Gas Well

b. TYPE OF COMPLETION:

NEW WELL ☐ WORK OVER ☐ DEEP-EN ☐ PLUG BACK ☐ DIFF. RESVR. ☐ Other _____

2. NAME OF OPERATOR

Continental Oil Company

3. ADDRESS OF OPERATOR

Box 660, Hatcher, New Mexico

4. LOCATION OF WELL (Report location clearly and in accordance with any State requirements)*

At surface 170' FSL and 660' FEL of Sec 25

At top prod. interval reported below

At total depth

same

14. PERMIT NO.

DATE ISSUED

12-22-71

5. LEASE DESIGNATION AND SERIAL NO.

RECEIVED

7. UNIT AGREEMENT NAME

JAN. 3 1972

OIL CONSERVATION COMM.

8. FARM OR LEASE NAME

9. WELL NO.

10. FIELD AND POOL, OR WILDCAT

11. SEC., T., R., M., OR BLOCK AND SURVEY OR AREA

Sec. 25, T-5N, R-9E

12. COUNTY OR PARISH

13. STATE

16. DATE T.D. REACHED

15. DATE SPUNDED

17. DATE COMPL. (Ready to prod.)

18. ELEVATIONS (OF, RKB, RT, GR, ETC.)*

19. ELEV. CASINGHEAD

12-17-71

12-22-71

12-22-71

20. TOTAL DEPTH, MD & TVD

21. PLUG, BACK T.D., MD & TVD

22. IF MULTIPLE COMPL., HOW MANY*

23. INTERVALS DRILLED BY

ROTARY TOOLS

CABLE TOOLS

1311'

N/A

1

→

X

→

24. PRODUCING INTERVAL(S), OF THIS COMPLETION—TOP, BOTTOM, NAME (MD AND TVD)*

N/A

25. WAS DIRECTIONAL SURVEY MADE

no

26. TYPE ELECTRIC AND OTHER LOGS RUN

GR-S, done and L.L.

27. WAS WELL CORED

yes

28. CASING RECORD (Report all strings set in well)

CASING SIZE	WEIGHT, LB./FT.	DEPTH SET (MD)	HOLE SIZE	CEMENTING RECORD	AMOUNT PULLED
<u>7 7/8"</u>	<u>24.7'</u>	<u>354'</u>	<u>9 7/8"</u>	<u>175 SKS - liner</u>	

29. LINER RECORD

SIZE	TOP (MD)	BOTTOM (MD)	SACKS CEMENT*	SCREEN (MD)
		<u>N/A</u>		

30. TUBING RECORD

SIZE	DEPTH SET (MD)	PACKER SET (MD)
	<u>N/A</u>	

31. PERFORATION RECORD (Interval, size and number)

32. ACID, SHOT, FRACTURE, CEMENT SQUEEZE, ETC.

DEPTH INTERVAL (MD)	AMOUNT AND KIND OF MATERIAL USED
<u>1506'-1086'</u>	<u>50 SKS</u>
<u>886'-660'</u>	<u>50 SKS</u>
<u>500'-300'</u>	<u>50 SKS</u>
<u>100'-0'</u>	<u>10 SKS</u>

33.* PRODUCTION

DATE FIRST PRODUCTION	PRODUCTION METHOD (Flowing, gas lift, pumping—size and type of pump)	WELL STATUS (Producing or shut-in)

DATE OF TEST	HOURS TESTED	CHOKE SIZE	PROD'N. FOR TEST PERIOD	OIL—BBL.	GAS—MCF.	WATER—BBL.	GAS-OIL RATIO
FLOW. TUBING PRESS.	CASING PRESSURE	CALCULATED 24-HOUR RATE	OIL—BBL.	GAS—MCF.	WATER—BBL.	OIL GRAVITY-API (CORR.)	

34. DISPOSITION OF GAS (Sold, used for fuel, vented, etc.)

TEST WITNESSED BY

35. LIST OF ATTACHMENTS

36. I hereby certify that the foregoing and attached information is complete and correct as determined from all available records

SIGNED

[Signature]

TITLE

Administrative Services

DATE

12-23-71

*(See Instructions and Spaces for Additional Data on Reverse Side)

USGS(5) - Denver, Colo File

INSTRUCTIONS

General: This form is designed for submitting a complete and correct well completion report and log on all types of lands and leases to either a Federal agency or a State agency, or both, pursuant to applicable Federal and/or State laws and regulations. Any necessary special instructions concerning the use of this form and the number of copies to be submitted, particularly with regard to local, area, or regional procedures and practices, either are shown below or will be issued by, or may be obtained from, the local Federal and/or State office. See instructions on items 22 and 24, and 33, below regarding separate reports for separate completions.

If not filed prior to the time this summary record is submitted, copies of all currently available logs (drillers, geologists, sample and core analysis, all types electric, etc.), formation and pressure tests, and directional surveys, should be attached hereto, to the extent required by applicable Federal and/or State laws and regulations. All attachments should be listed on this form, see item 35.

Item 4: If there are no applicable State requirements, locations on Federal or Indian land should be described in accordance with Federal requirements. Consult local State or Federal office for specific instructions.

Item 18: Indicate which elevation is used as reference (where not otherwise shown) for depth measurements given in other spaces on this form and in any attachments.

Items 22 and 24: If this well is completed for separate production from more than one interval zone (multiple completion), so state in item 22 and in item 24 show the producing interval, or intervals, top(s), bottom(s) and name(s) (if any) for only the interval reported in item 33. Submit a separate report (page) on this form, adequately identified, for each additional interval to be separately produced, showing the additional data pertinent to such interval.

Item 29: "Sacks Cement": Attached supplemental records for this well should show the details of any multiple stage cementing and the location of the cementing tool.

Item 33: Submit a separate completion report on this form for each interval to be separately produced. (See instruction for items 22 and 24 above.)

37. SUMMARY OF POROUS ZONES:			38. GEOLOGIC MARKERS	
SHOW ALL IMPORTANT ZONES OF POROSITY AND CONTENTS THEREOF: CORED INTERVALS; AND ALL DRILL-STEM TESTS, INCLUDING DEPTH INTERVAL TESTED, CUSHION USED, TIME TOOL OPEN, FLOWING AND SHUT-IN PRESSURES, AND RECOVERIES				
FORMATION	TOP	BOTTOM	NAME	MEAS. DEPTH
				TRUE VERT. DEPTH
			San Andres	1025'
			Glorieta	1275'

(May 1963)

DEPARTMENT OF THE INTERIOR
GEOLOGICAL SURVEY

(Other instructions on reverse side)

Report Form No. G-100

9. LEASE DESIGNATION AND SERIAL NO.

NM 13340

6. INDIAN, ALLOTTEE OR TRIBE NAME

7. UNIT AGREEMENT NAME

8. FARM OR LEASE NAME

Williams Fed A

9. WELL NO.

10. FIELD AND POOL, OR WILDCAT

Wilcat

11. SEC. T., R., N., OR BLK. AND SURVEY OR AREA

Sec 25, T-5N, R-23E

12. COUNTY OR PARISH 13. STATE

Guadalupe N. Mex

SUNDRY NOTICES AND REPORTS ON WELLS

(Do not use this form for proposals to drill or to deepen or plug back to a different reservoir. Use "APPLICATION FOR PERMIT" for such proposals.)

1. OIL WELL ☒ GAS WELL ☐ OTHER

OIL CONSERVATION COMM.

2. NAME OF OPERATOR

Continental Oil Company

3. ADDRESS OF OPERATOR

P. O. Box 460, Hobbs, New Mexico 88240

4. LOCATION OF WELL (Report location clearly and in accordance with any State requirements.)

See also space 17 below.)

At surface

14. PERMIT NO.

15. ELEVATIONS (Show whether DT, RT, GR, etc.)

4425' gr

16. Check Appropriate Box To Indicate Nature of Notice, Report, or Other Data

NOTICE OF INTENTION TO:

TEST WATER SHUT-OFF

FRACURE TREAT

SHOOT OR ACIDIZE

REPAIR WELL

(Other)

PLUG OR ALTER CASING

MULTIPLE COMPLETE

ABANDON*

CHANGE PLANS

SUBSEQUENT REPORT OF:

WATER SHUT-OFF

FRACURE TREATMENT

SHOOTING OR ACIDIZING

(Other)

REPAIRING WELL

ALTERING CASING

ABANDONMENT*

(Note: Report results of multiple completion on Well Completion or Recompletion Report and Log form.)

17. DESCRIBE PROPOSED OR COMPLETED OPERATIONS (Clearly state all pertinent details, and give pertinent dates, including estimated date of starting any proposed work. If well is directionally drilled, give subsurface locations and measured and true vertical depths for all markers and zones pertinent to this work.)

Ron 7 5/8", H-40 grade, 24 # casing and set at 354'. Cemented with 175 sacks class C cement w/ 490 gal and 290 gal and 1/4 # floccle per sack. Cement circulated, WOC 24 hours. Tested casing w/ 1000 psi for 30 minutes. Held O.K.

Confidential

DEC 16 1971

U.S. GEOLOGICAL SURVEY
BUREAU OF MINES

18. I hereby certify that the foregoing is true and correct

SIGNED

[Signature]

TITLE Administrative Supervisor

DATE 12-16-71

(This space for Federal or State office use)

APPROVED BY

TITLE

DATE

CONDITIONS OF APPROVAL, IF ANY:

USGS (5) File

→ Durango, Colo *See Instructions on Reverse Side

DEPARTMENT OF THE INTERIOR
GEOLOGICAL SURVEY

(Other instructions on reverse side)

5. LEASE DESIGNATION AND SERIAL NO.

1334-0
6. IF APPLICABLE, ALLOTTEE OR TRUST NAME

SUNDRY NOTICES AND REPORTS ON WELLS

(Do not use this form for proposals to drill or to deepen or plug back to a different reservoir. Use "APPLICATION FOR PERMIT" for such proposals.)

1. <input checked="" type="checkbox"/> OIL WELL <input type="checkbox"/> GAS WELL <input type="checkbox"/> OTHER		7. CONSERVATION COMMITTEE AGREEMENT NAME	
2. NAME OF OPERATOR Continental Oil Company		8. FARM OR LEASE NAME Williams Field	
3. ADDRESS OF OPERATOR P. O. Box 460, Hobbs, New Mexico 88240		9. WELL NO. 1	
4. LOCATION OF WELL (Report location clearly and in accordance with any State requirements. See also space 17 below.) At surface 660' FSL and 660' FEL of Sec 25		10. FIELD AND POOL, OR WILDCAT U. S. District	
14. PERMIT NO.		11. SEC., T., R., M., OR BLM. AND SURVEY OR ACCE. Sec 25, T-5N, R-23E	
15. ELEVATIONS (Show whether DT, RT, GR, etc.) 4425' gr		12. COUNTY OR PARISH Guadalupe	
		13. STATE N. Mex	

16. Check Appropriate Box To Indicate Nature of Notice, Report, or Other Data

NOTICE OF INTENTION TO:		SUBSEQUENT REPORT OF:	
TEST WATER SHUT-OFF <input type="checkbox"/>	PEEL OR ALTER CASING <input checked="" type="checkbox"/>	WATER SHUT-OFF <input type="checkbox"/>	REPAIRING WELL <input type="checkbox"/>
FRACTURE TREAT <input type="checkbox"/>	MULTIPLE COMPLETE <input type="checkbox"/>	FRACTURE TREATMENT <input type="checkbox"/>	ALTERING CASING <input type="checkbox"/>
SHOOT OR ACIDIZE <input type="checkbox"/>	ABANDON* <input type="checkbox"/>	SHOOTING OR ACIDIZING <input type="checkbox"/>	ABANDONMENT* <input type="checkbox"/>
REPAIR WELL <input type="checkbox"/>	CHANGE PLANS <input type="checkbox"/>	(Other) <input type="checkbox"/>	

(Note: Report results of multiple completion on Well Completion or Recompletion Report and Log form.)

17. DESCRIBE PROPOSED OR COMPLETED OPERATIONS (Clearly state all pertinent details, and give pertinent dates, including estimated date of starting any proposed work. If well is directionally drilled, give subsurface locations and measured and true vertical depths for all markers and zones pertinent to this work.)

It is proposed to change the setting depth of the 7 5/8" casing on our Permit to drill this well from 300' to 350'.

RECEIVED

DEC 14 1971

U. S. GEOLOGICAL SURVEY
DURANGO, COLO.

18. I hereby certify that the foregoing is true and correct
SIGNED [Signature] TITLE Administrative Supervisor DATE 12-10-71
(This space for Federal or State office use)

APPROVED BY _____ TITLE _____ DATE _____
CONDITIONS OF APPROVAL, IF ANY:

USGS (5) File

→ Durango, Colo *See Instructions on Reverse Side

30-019-20005

Form 9-331 C
(May 1963)

SUBMIT IN TRIPPLICATE*

Form approved.
Budget Bureau No. 42-R1425.

UNITED STATES
DEPARTMENT OF THE INTERIOR
GEOLOGICAL SURVEY

(Over instructions on
reverse side)

DEC 15 1971

APPLICATION FOR PERMIT TO DRILL, DEEPEN, OR PLUG BACK

5. LEASE DESIGNATION AND SERIAL NO.

NM 13340

6. IF INDIAN, ALLOTTEE OR TRIBE NAME

7. UNIT AGREEMENT NAME

8. FARM OR LEASE NAME

Williams Federal A

9. WELL NO.

10. FIELD AND POOL, OR WILDCAT

Wildcat

11. SEC., T., R., M., OR BLK.
AND SURVEY OR AREA

Sec 25, T-5N, R-23E

12. COUNTY OR PARISH

Gardnerville N. Mex

17. NO. OF ACRES ASSIGNED
TO THIS WELL

40

20. ROTARY OR CABLE TOOLS

rotary

22. APPROX. DATE WORK WILL START*

12-11-71

1a. TYPE OF WORK

DRILL ☒DEEPEN ☐PLUG BACK ☐

b. TYPE OF WELL

OIL

WELL ☒

GAS

WELL ☐OTHER ☐

SINGLE

ZONE ☐

MULTIPLE

ZONE ☐

2. NAME OF OPERATOR

3. ADDRESS OF OPERATOR

4. LOCATION OF WELL (Report location clearly and in accordance with any State requirements.)

At surface

660' FSL and 660' FEL of Sec 25

At proposed prod. zone

Same

14. DISTANCE IN MILES AND FRACTIONS FROM NEAREST TOWN OR POST OFFICE*

10. DISTANCE FROM PROPOSED

LOCATION TO NEAREST

PROPERTY OR LEASE LINE, FT.

(Also to nearest drlg. unit line, if any)

18. DISTANCE FROM PROPOSED LOCATION

TO NEAREST WELL, DRILLING COMPLETION

OR APPLIED FOR, ON THIS LEASE, FT.

16. NO. OF ACRES IN LEASE

1447.05

19. PROPOSED DEPTH

1400'

21. ELEVATIONS (Show whether DF, RT, GR, etc.)

23.

PROPOSED CASING AND CEMENTING PROGRAM

SIZE OF HOLE	SIZE OF CASING	WEIGHT PER FOOT	SETTING DEPTH	QUANTITY OF CEMENT
9 7/8"	7 5/8"	24#	300'	127 SKS - circulated
6 3/4"	5 1/2"	14#	TD	100 SKS

It is proposed to drill a straight hole to 1400' and complete in the Glauco, if commercial. Also we propose to core 200' from 1200' - 1400'.

Continental Oil Company will comply in connection with its operations with the applicable Special Stipulations, Form No. R5-43, and Bureau of Reclamation Lease Stipulations, Form No. 3103-1, to which this lease is subject.

IN ABOVE SPACE DESCRIBE PROPOSED PROGRAM: If proposal is to deepen or plug back, give data on present productive zone and proposed new productive zone. If proposal is to drill or deepen directionally, give pertinent data on subsurface locations and measured and true vertical depths. Give blowout preventer program, if any.

24.

SIGNED

TITLE

DATE

(This space for Federal or State office use)

PERMIT NO.

APPROVAL DATE

APPROVED BY

TITLE

DATE

CONDITIONS OF APPROVAL, IF ANY:

USGS(5) - Durango, Colo

File

*See Instructions On Reverse Side

NEW MEXICO OIL CONSERVATION COMMISSION
WELL LOCATION AND ACREAGE DEDICATION PLAT

RECEIVED
DEC 15 1971

Form C-102
Supersedes C-128
Effective 1-4-65

All distances must be from the outer boundaries of the Section.

Operator CONTINENTAL OIL COMPANY			Lease WILLIAMS FEDERAL "A"		Oil Conservation Comm. SANTA FE	Well No. 1
Unit Letter P	Section 25	Township 5 NORTH	Range 23 EAST	County GUADALUPE		
Actual Footage Location of Well: 660 feet from the SOUTH line and 660 feet from the EAST line						
Ground Level Elev. 4425.6	Producing Formation		Pool Wildcat	Dedicated Acreage: 40		

1. Outline the acreage dedicated to the subject well by colored pencil or hachure marks on the plat below.
2. If more than one lease is dedicated to the well, outline each and identify the ownership thereof (both as to working interest and royalty).
3. If more than one lease of different ownership is dedicated to the well, have the interests of all owners been consolidated by communitization, unitization, force-pooling, etc?

☐ Yes ☐ No If answer is "yes," type of consolidation _____

If answer is "no," list the owners and tract descriptions which have actually been consolidated. (Reverse side of this form if necessary.) _____

No allowable will be assigned to the well until all interests have been consolidated (by communitization, unitization, forced-pooling, or otherwise) or until a non-standard unit, eliminating such interests, has been approved by the Commission.

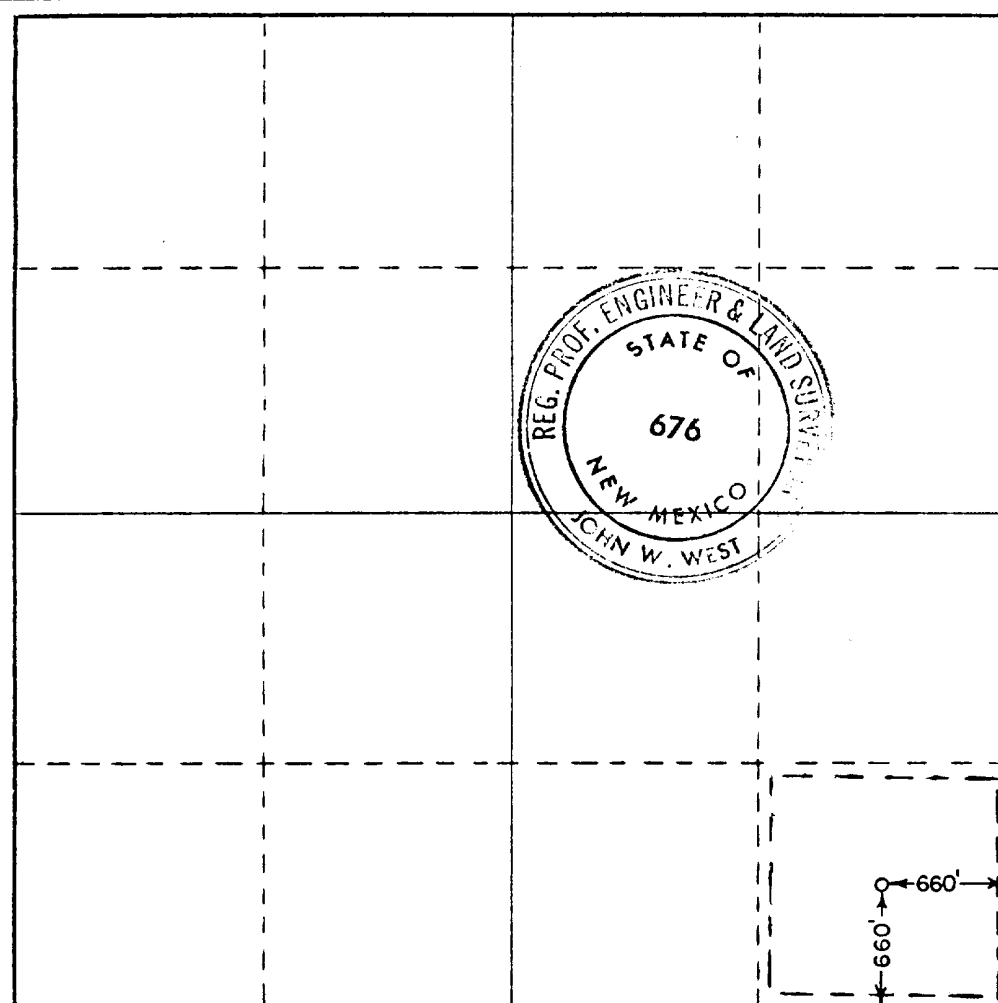
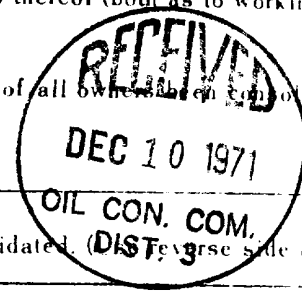

CERTIFICATION

I hereby certify that the information contained herein is true and complete to the best of my knowledge and belief.

Name *John W. West*
Position *Admin Supervisor*
Company *Continental Oil Co*
Date *December 7, 1971*

I hereby certify that the well location shown on this plat was plotted from field notes of actual surveys made by me or under my supervision, and that the same is true and correct to the best of my knowledge and belief.

Date Surveyed

DECEMBER 4, 1971

Registered Professional Engineer and/or Land Surveyor

John W. West
Certificate No. **676**



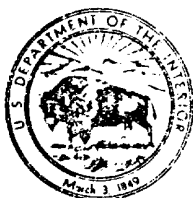

IN REPLY
REFER TO: 5-420

United States Department of the Interior
BUREAU OF RECLAMATION

REGIONAL OFFICE - REGION 5
HERRING PLAZA BOX H-4377
AMARILLO, TEXAS 79101

DEC 7 1971

RECEIVED

DEC 15 1971

RECEIVED
LAND SECTION
DEC 8 1971

Please Note	
H.M.N.	
R.E.L.	
B.H.M.	
B.S.B.	
File	Noted

To: Regional Oil and Gas Supervisor, U.S. Geological
Survey, Roswell, New Mexico

From: Regional Director

Subject: Oil and Gas Lease NM 13340

Mr. Howard Newton, Continental Oil Company, Midland, Texas, contacted our office today to ascertain if we object to location of a well in sec. 25, T. 5 N., R. 23 E., N.M.P.M., near Alamogordo Reservoir.

This is to advise that we have no objection to the proposed location or any other land outside the boundary of Alamogordo Reservoir, Carlsbad project, New Mexico.

We will desire to consider any location within the boundary of our reservoir area.

/s/ L. W. F. R. N.

cc:

Continental Oil Company
Post Office Box 431
Midland, Texas 79701

U.S. Geological Survey
Post Office Box 1809
Durango, Colorado 81301

UNITED STATES
DEPARTMENT OF THE INTERIOR
BUREAU OF LAND MANAGEMENT

Office New Mexico

Serial No. NM 13310

Fill in on typewriter
or print plainly in ink
and sign in ink.

OFFER TO LEASE AND LEASE FOR OIL AND GAS
(Sec. 17 Noncompetitive Public Domain Lease)

The undersigned hereby offers to lease all or any of the lands described in item 2 that are available for lease, pursuant and subject to the terms and provisions of the Act of February 25, 1920 (41 Stat. 437, 30 U. S. C. sec. 481), as amended hereafter referred to as the Act and to all reasonable regulations of the Secretary of the Interior now or hereafter in force, when not inconsistent with any express and specific provisions herein, which are made a part hereof.

Mr. ~~XXX~~ Wilbur Rocchio
(First Name, Middle Initial, Last Name)

Please notify the
Bureau of any
change of address.

203 V&J Tower Bldg.
(Number and Street)

Midland, Texas 79701
(City, State, ZIP Code)

2. Land requested: State New Mexico County Guadalupe T. 5 N : R. 23 E : NMP Meridian
Section 13: SE 1/4
" 24: E/2
" 25: All

County De Baca

T 4 N ; R 24 E: NMP Meridian

Section 1: Lots 2, 3 and 4;

Section 2: Lots 1, 2, and 3; NW 1/4 SE 1/4; NE 1/4 SW 1/4

T 5 N ; R 24 E : NMP Meridian

Section 7: NW 1/4 SE 1/4

Total Area 1,487.05 Acres

3. Land included in lease: State New Mexico County DeBaca and Guadalupe Counties T. 4 N : R. 24 E : NMP Meridian

This lease is subject to the determination by the Geological Survey as to whether the lands herein described were on a known geologic structure of a producing oil or gas field as of the date of signing hereof by the authorized officer.

LANDS IN LEASE WERE NOT
WITHIN A KNOWN GEOLOGIC
STRUCTURE ON DATE OF
LEASE ISSUANCE.

Sec. 1: Lots 2, 3, 4
2: Lots 1, 2, 3,
NE 1/4 SW 1/4, NW 1/4 SE 1/4
T. 5 N., R. 23 E.,
Sec. 13: SE 1/4
24: E 1/2
25: All

(Offeror does not fill in this block) Total Area 1447.05 Acres Rental retained \$ 724.00

5. Undersigned certifies as follows:

(a) Offeror is a citizen of the United States. Native born YES Naturalized Corporation or other legal entity (specify what kind):

(b) Offeror's interests, direct and indirect, do not exceed 200,000 acres in oil and gas options or 246,080 chargeable acres in options, offers to lease and leases in the same State, or 300,000 chargeable acres in leases, offers to lease and options in each leasing district in Alaska. (c) Offeror accepts as a part of this lease, to the extent applicable, the stipulations provided for in 43 CFR 3103.2. (d) Offeror is 21 years of age or over (or if a corporation or other legal entity, is duly qualified as shown by statements made or referred to herein). (e) Offeror has described all surveyed lands by legal subdivisions, all lands covered by protracted surveys by appropriate subdivisions thereof, or all unsurveyed lands not covered by protracted surveys by metes and bounds, and further states that there are no settlers on unsurveyed lands described herein.

6. Offeror ☒ is ☐ is not the sole party in interest in this offer and lease, if issued. (If not the sole party in interest, statements should be filed as prescribed in Item 6 of the Special Instructions.)

7. Offeror's signature to this offer shall also constitute offeror's signature to, and acceptance of, this lease and any amendment thereto that may cover any land described in this offer open to lease application at the time the offer was filed but omitted from this lease for any reason, or signature to, or acceptance of, any separate lease for such land. The offeror further agrees that (a) this offer cannot be withdrawn, either in whole or in part, unless the withdrawal is received by the land office before this lease, an amendment to this lease, or a separate lease, whichever covers the land described in the withdrawal, has been signed in behalf of the United States, and (b) this offer and lease shall apply only to lands not within a known geologic structure of a producing oil or gas field.

8. If this lease form does not contain all of the terms and conditions of the lease form in effect at the date of filing, the offeror further agrees to be bound by the terms and conditions contained in that form.

9. It is hereby certified that the statements made herein are complete and correct to the best of offeror's knowledge and belief and are made in good faith.

Offeror duly executed this instrument this 1st day of March, 1971

(Lessee signature)

(Lessee signature)

(Attorney-in-fact)

This lease for the lands described in item 3 above is hereby issued, subject to the provisions of the offer and on the reverse side hereof.

THE UNITED STATES OF AMERICA

By John L. Perilla
Acting Chief, Branch of Lands
and Minerals Operations

Effective date of lease July 1, 1971

THIS OFFER MAY BE REJECTED AND RETURNED TO THE OFFEROR AND WILL AFFORD THE OFFEROR NO PRIORITY IF IT IS NOT PROPERLY FILLED IN AND EXECUTED OR IF IT IS NOT ACCOMPANIED BY THE REQUIRED DOCUMENTS OR PAYMENTS.

18 U. S. C. sec. 1001 makes it a crime for any person knowingly and willfully to make to any Department or agency of the United States any false, fictitious or fraudulent statements or representations as to any matter within its jurisdiction.

This document is prepared and printed by the Bureau of Land Management, Department of the Interior, and is available to the public at a special price of \$0.50 per copy.

UNITED STATES
DEPARTMENT OF THE INTERIOR
BUREAU OF LAND MANAGEMENT

943h

LEASE STIPULATIONS
BUREAU OF RECLAMATION

The lessee agrees to maintain, if required by the lessor during the period of this lease, including any extension thereof, an additional bond with qualified sureties in such sum as the lessor, if it considers that the bond required under Section 2(a) is insufficient, may at any time require:

(a) to pay for damages sustained by any reclamation homestead entryman to his crops or improvements caused by drilling or other operations of the lessee, such damages to include the reimbursement of the entryman by the lessee, when he uses or occupies the land of any homestead entryman, for all construction and operation and maintenance charges becoming due during such use or occupation upon any portion of the land so used and occupied;

(b) to pay any damage caused to any reclamation project or water supply thereof by the lessee's failure to comply fully with the requirements of this lease; and

(c) to recompense any nonmineral applicant, entryman, purchaser under the Act of May 16, 1930 (46 Stat. 367), or patentee for all damages to crops or to tangible improvements caused by drilling or other prospecting operations, where any of the lands covered by this lease are embraced in any non-mineral application, entry, or patent under rights initiated prior to the date of this lease, with a reservation of the oil deposits, to the United States pursuant to the Act of July 17, 1914 (38 Stat. 509).

As to any lands covered by this lease within the area of any Government reclamation project, or in proximity thereto, the lessee shall take such precautions as required by the Secretary to prevent any injury to the lands susceptible to irrigation under such project or to the water supply thereof; *provided* that drilling is prohibited on any constructed works or right-of-way of the Bureau of Reclamation, and *provided, further*, that there is reserved to the lessor, its successors and assigns, the superior and prior right at all times to construct, operate, and maintain dams, dikes, reservoirs, canals, wasteways, laterals, ditches, telephone and telegraph lines, electric transmission lines, roadways, appurtenant irrigation structures, and reclamation works, in which construction, operation, and maintenance, the lessor, its successors and assigns, shall have the right to use any or all of the lands herein described without making compensation therefor, and shall not be responsible for any damage from the presence of water thereon or on account of ordinary, extraordinary, unexpected, or unprecedented floods. That nothing shall be done under this lease to increase the cost of, or interfere in any manner with, the construction, operation, and maintenance of such works. It is agreed by the lessee that, if the construction of any or all of said dams, dikes, reservoirs, canals, wasteways, laterals, ditches, telephone or telegraph lines, electric transmission lines, roadways, appurtenant irrigation structures or reclamation works across, over, or upon said lands should be made more expensive by reason of the existence of the improvements and workings of the lessee thereon, said additional expense is to be estimated by the

Secretary of the Interior, whose estimate is to be final and binding upon the parties hereto, and that within thirty (30) days after demand is made upon the lessee for payment of any such sums, the lessee will make payment thereof to the United States, or its successors, constructing such dams, dikes, reservoirs, canals, wasteways, laterals, ditches, telephone and telegraph lines, electric transmission lines, roadways, appurtenant irrigation structures, or reclamation works, across, over, or upon said lands; *provided, however*, that subject to advance written approval by the United States, the location and course of any improvements or works and appurtenances may be changed by the lessee; *provided, further*, that the reservations, agreements, and conditions contained in the within lease shall be and remain applicable notwithstanding any change in the location or course of said improvements or works of lessee. The lessee further agrees that the United States, its officers, agents, and employees, and its successors and assigns shall not be held liable for any damage to the improvements or workings of the lessee resulting from the construction, operation, and maintenance of any of the works hereinabove enumerated. Nothing in this paragraph shall be construed as in any manner limiting other reservations in favor of the United States contained in this lease.

THE LESSEE FURTHER AGREES That there is reserved to the lessor, its successors and assigns, the prior right to use any of the lands herein leased, to construct, operate, and maintain dams, dikes, reservoirs, canals, wasteways, laterals, ditches, telephone and telegraph lines, electric transmission lines, roadways, or appurtenant irrigation structures, and also the right to remove construction materials therefrom, without any payment made by the lessor or its successors for such right, with the agreement on the part of the lessee that if the construction of any or all of such dams, dikes, reservoirs, canals, wasteways, laterals, ditches, telephone and telegraph lines, electric transmission lines, roadways, or appurtenant irrigation structures across, over, or upon said lands or the removal of construction materials therefrom, should be made expensive by reason of the existence of improvements or workings of the lessee thereon, such additional expense is to be estimated by the Secretary of the Interior, whose estimate is to be final and binding upon the parties hereto, and that within thirty (30) days after demand is made upon the lessee for payment of any such sums, the lessee will make payment thereof to the United States or its successors constructing such dams, dikes, reservoirs, canals, wasteways, laterals, ditches, telephone and telegraph lines, electric transmission lines, roadways, or appurtenant irrigation structures across, over, or upon said lands or removing construction materials therefrom. The lessee further agrees that the lessor, its officers, agents, and employees and its successors and assigns shall not be held liable for any damage to the improvements or workings of the lessee resulting from the construction, operation, and maintenance of any of the works herein above enumerated. Nothing contained in this paragraph shall be construed as in any manner limiting other reservations in favor of the lessor contained in this lease.

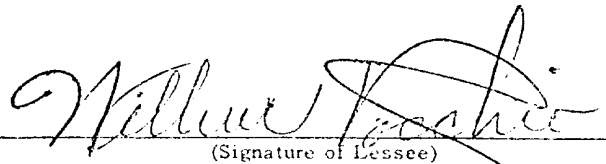
(Signature of Lessee)

(over) (Wilbur Rocchio)

RECEIVED
BUREAU OF RECLAMATION
LAND OFFICE - SALT LAKE, U. S. M.
JUN 4 - 1971

R5-43
(2-11-64)

Special Stipulations

HOUR: 10:00 AM

1. All rights under this lease are subordinate to the right of the United States to flood and submerge the lands, permanently or intermittently, in connection with the operation and maintenance of the Alamogordo dam and reservoir project.

2. All surface work performed by the lessee on the lands shall be under the general supervision of the Regional Director, Bureau of Reclamation, in direct charge of the project, and subject to such conditions and regulations as he may prescribe. The plans and location for all structures, appurtenances thereto, and surface work on the leased lands shall be submitted to the said Regional Director for approval in advance of commencement of any surface work on the said leased lands. All oil or gas drilling and producing operations shall be under the supervision of the Regional Oil and Gas Supervisor, U. S. Geological Survey, in accordance with 30 CFR, Part 221. The authorized representatives of the Bureau of Reclamation and of the Geological Survey shall have the right to enter on the leased premises at any time to inspect both the installation and operational activities of the lessee.

3. No wells shall be drilled for oil or gas below the conservation pool elevation of 4275.0 * feet, except upon written permission of the Regional Director, provided, however, that there will be no objection to such drilling by directional methods from adjacent areas above the 4275.0 * foot elevation, on the condition that such drilling operations are subject to appropriate restrictions to prevent pollution of the reservoir, with operation and maintenance of the reservoir and to prevent interference.

4. All storage tanks shall be constructed above elevation 4297.0 ** feet, mean sea level, and shall be protected by firewalls or dikes of sufficient capacity to protect the reservoir from pollution.

5. Drilling a well for oil or gas is prohibited within 200 feet of any dam, dike, or other major structure, unless otherwise approved by the Regional Director.

6. All drilling operations shall be conducted in accordance with the applicable State laws relative to municipal water supplies.

* Conservation pool elevation for the appropriate reservoir

**Maximum water surface of the appropriate reservoir

Address: Regional Director
Bureau of Reclamation
P. O. Box 1609
Amarillo, Texas

Address: Regional Oil and Gas Supervisor
Geological Survey



United States Department of the Interior

BUREAU OF LAND MANAGEMENT
STATE OFFICE

P. O. Box 1449
Santa Fe, New Mexico 87501

IN REPLY REFER TO

NM 13340
Oil & Gas

943h

• Certified Mail
Return Receipt Requested

JUN 10 1971

DECISION

Wilbur Rocchio

:

Oil and Gas

Offer to Lease Rejected in Part Special Stipulations Required

Oil and gas lease offer NM 13340 is hereby rejected to the extent and for the reason set out below:

The NW $\frac{1}{4}$ SE $\frac{1}{4}$, Sec. 7, T. 5 N., R. 24 E., NMPM is embraced in State Grant Patent No. 30710033 approved on February 4, 1971, without minerals reserved to the United States.

Offer NM 13340 also includes Lots 2, 3, 4, Sec. 1, T. 4 N., R. 24 E., NMPM, which are included in Secretary's Order of March 8, 1937, Withdrawal for Carlsbad Project and Lots 1, 2, 3, NE $\frac{1}{4}$ SW $\frac{1}{4}$, NW $\frac{1}{4}$ SE $\frac{1}{4}$ Sec. 2, T. 4 N., R. 24 E., NMPM, which are included in Secretary's Order of March 31, 1921, Withdrawal for the Alamogordo Reservoir Site. Therefore, all copies of the attached stipulations must be executed and returned to this office within thirty days after this decision is received. In the event of non-compliance with this decision, the offer will be rejected as to those lands without further notice and a lease will issue for the balance of the lands not included in the withdrawals.

NM 13340
Oil and Gas

943h

The right of appeal to the Board of Land Appeals, Office of the Secretary, is allowed in accordance with the regulations in 43 CFR Part 1840. See enclosed Form 1842-1 and Circular 2276. If an appeal is taken, the notice of appeal must be filed in this office so that the case file can be transmitted to the Board. To avoid summary dismissal of the appeal, there must be strict compliance with the regulations.

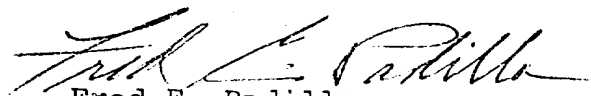

Fred E. Padilla
Acting Chief, Branch of Lands
and Minerals Operations

Enclosures

cc: O&G Supv. (2), Roswell

COUNTY GUADALUPE FIELD Wildcat STATE NM 30-019-20005
 OPR CONTINENTAL OIL CO. MAP
1 Williams - Federal "A"
Sec 25, T-5-N, R-23-E CO-ORD
660' FSL, 660' FEL of Sec

Cmp 12-22-71	CLASS		EL	
	FORMATION	DATUM	FORMATION	DATUM
CSG & SX - TUBING				
LOGS EL GR RA IND HC A				
	TD 1311'			

PLUGGED & ABANDONED

Distribution limited and publication prohibited by subscribers' agreement.
 Reproduction rights reserved by Williams & Lee Scouting Service, Inc.

CONT. PROP DEPTH 1400' TYPE RT
 DATE

F.R. 1-18-72; Opr's Elev. 4425' GL
 PD 1400' RT (Glorieta)
 1-17-72 TD 1311'; P&A (Tight)
 2-27-72 TD 1311'; PLUGGED & ABANDONED
 Well Drilled Tight, Will Amend if information
 is released.
 4-1-72 COMPLETION REPORTED