

NO. OF COPIES RECEIVED	
DISTRIBUTION	
SANTA FE	✓
FILE	
U.S.G.S.	
LAND OFFICE	
OPERATOR	

NEW MEXICO OIL CONSERVATION COMMISSION

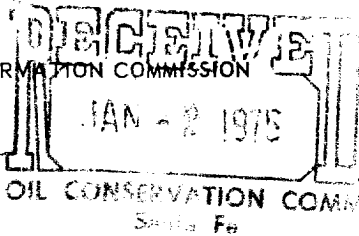

Form C-101  
Revised 1-1-65

API# 30-019-20012

5A. Indicate Type of Lease STATE <input type="checkbox"/> FEE <input checked="" type="checkbox"/>
5. State Oil & Gas Lease No.
7. Unit Agreement Name
8. Farm or Lease Name T-4 Cattle Co.
9. Well No. #2
10. Field and Pool, or Wildcat Wildcat
12. County Guadalupe
19. Proposed Depth 1500'
19A. Formation San Andres
20. Rotary or C.T. C.T.
21. Elevations (Show whether DF, RT, etc.) 4773 GR
21A. Kind & Status Plug. Bond Blanket
21B. Drilling Contractor R. C. Ames, Jr.
22. Approx. Date Work will start Immediately on approval

APPLICATION FOR PERMIT TO DRILL, DEEPEN, OR PLUG BACK

1a. Type of Work DRILL <input checked="" type="checkbox"/> DEEPEN <input type="checkbox"/> PLUG BACK <input type="checkbox"/>
b. Type of Well OIL WELL <input checked="" type="checkbox"/> GAS WELL <input type="checkbox"/> OTHER <input type="checkbox"/>
2. Name of Operator Bruce A. Wilbanks
3. Address of Operator P. O. Box 763, Midland, Texas 79701
4. Location of Well UNIT LETTER G LOCATED 1980 FEET FROM THE North LINE AND 1960 FEET FROM THE East LINE OF SEC. 18 TWP. 11N RGE. 26E NMPM
23.

PROPOSED CASING AND CEMENT PROGRAM

SIZE OF HOLE	SIZE OF CASING	WEIGHT PER FOOT	SETTING DEPTH	SACKS OF CEMENT	EST. TOP
15"	13 3/4"	48#	60'	25	Circ- Surface
8"	5 1/2"	14#	1500'	100	Circ- Surface

APPROVAL FOR  
FOR THE STATE OF NEW MEXICO  
DEPARTMENT OF ENERGY  
EXPIRES 4/2/75

IN ABOVE SPACE DESCRIBE PROPOSED PROGRAM: IF PROPOSAL IS TO DEEPEN OR PLUG BACK, GIVE DATA ON PRESENT PRODUCTIVE ZONE AND PROPOSED NEW PRODUCTIVE ZONE. GIVE BLOWOUT PREVENTER PROGRAM, IF ANY.

I hereby certify that the information above is true and complete to the best of my knowledge and belief.

Signed Louis M. Cerbasi Title Office Manager Date 12/27/74  
(This space for State Use)

APPROVED BY Carl Ulloa TITLE Oil and Gas Conservation DATE 1/2/75  
CONDITIONS OF APPROVAL, IF ANY:

## WELL LOCATION AND ACREAGE

SION  
N PLAT

RECEIVED

C-102  
Supersedes C-128  
Effective 1-1-65

All distances must be from the outer boundary.

JAN - 2 1974

Operator <b>Bruce A. Wilbanks</b>		Lease <b>T-4 Cattle Co. OIL CONSERVATION CO. 2</b>		Well No. <b>2</b>
Unit Letter	Section <b>18</b>	Township <b>11N</b>	Range <b>26E</b>	County <b>Guadalupe</b>
Actual Footage Location of Well: <b>1980</b> feet from the <b>north</b> line and <b>1960</b> feet from the <b>east</b> line				
Ground Level Elev. <b>4773</b>	Producing Formation		Pool <b>Wildcat</b>	Dedicated Acreage: <b>40</b> Acres

1. Outline the acreage dedicated to the subject well by colored pencil or hachure marks on the plat below.
2. If more than one lease is dedicated to the well, outline each and identify the ownership thereof (both as to working interest and royalty).
3. If more than one lease of different ownership is dedicated to the well, have the interests of all owners been consolidated by communitization, unitization, force-pooling, etc?

☐ Yes ☐ No If answer is "yes," type of consolidation \_\_\_\_\_

If answer is "no," list the owners and tract descriptions which have actually been consolidated. (Use reverse side of this form if necessary.) \_\_\_\_\_

No allowable will be assigned to the well until all interests have been consolidated (by communitization, unitization, forced-pooling, or otherwise) or until a non-standard unit, eliminating such interests, has been approved by the Commission.

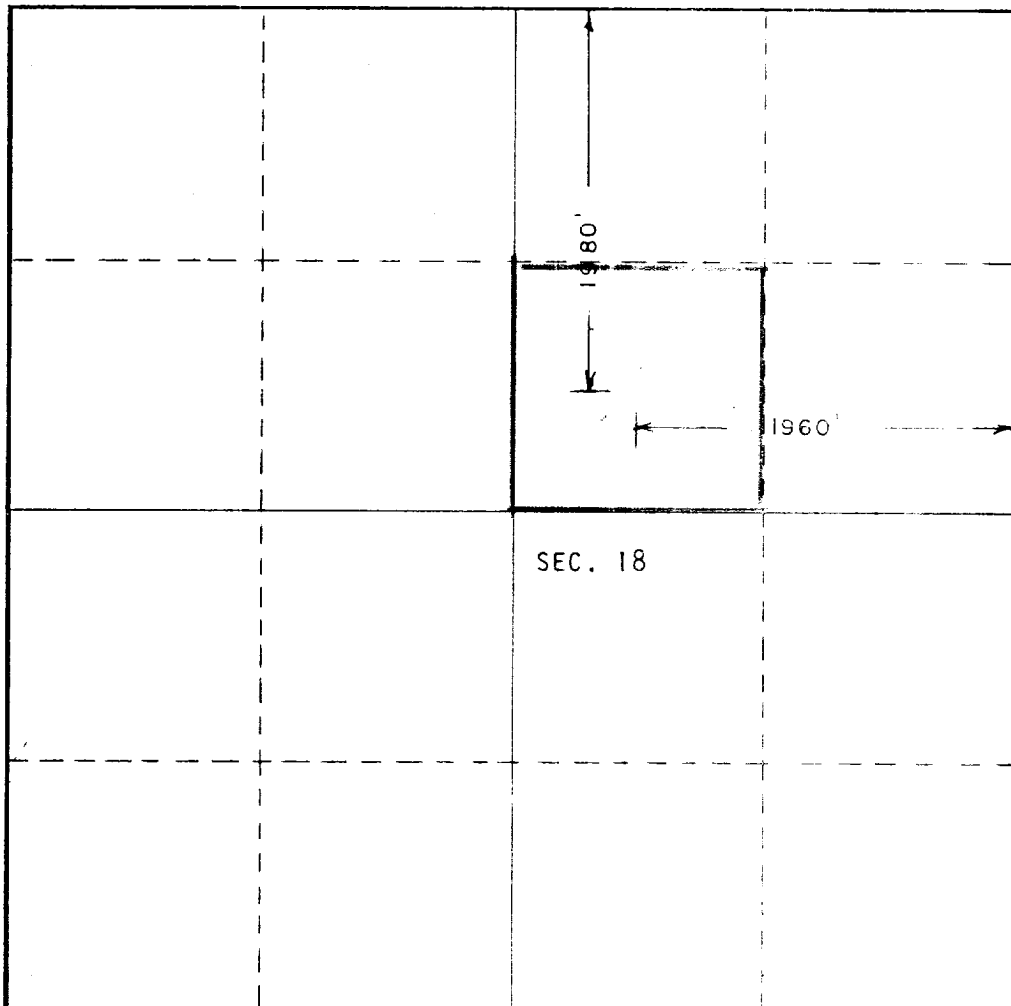

## CERTIFICATION

I hereby certify that the information contained herein is true and complete to the best of my knowledge and belief.

*Lugh M. Curboskas*  
Name  
*Office Manager*  
Position  
*Bruce A. Wilbanks*  
Company

Date  
*12/27/74*

I hereby certify that the well location shown on this plat was plotted from field notes of actual surveys made by me or under my supervision, and that the same is true and correct to the best of my knowledge and belief.

Date Surveyed  
*10/5/74*

Registered Professional Engineer (E) and/or Land Surveyor

*J. E. Balliew Jr.*

Certificate No.

L. S. #3948

0 330 660 990 1320 1650 1980 2310 2640 2970 3300 3630 3960 4290 4620 4950 5280 5610 5940 6270 6600