

NEW MEXICO LAND CONSERVATION COMMISSION
WELL LOCATION AND ACREAGE DEDICATION PLAT

Form C-128
Superseeds C-128
Effective 1-1-65

All distances must be from the outer boundaries of the Section.

Operator Public Land Exploration Co., Inc.			Lease State		Well No. #12
Unit Letter A	Section 15	Township 11 North	Range 25 East	County Guadalupe	
Actual Footage Location of Well: 512 feet from the North line and 832 feet from the East line					
Ground Level Elev. 4571.9	Producing Formation Chinle	Pool Wildcat	Dedicated Acreage: 40 Acres		

1. Outline the acreage dedicated to the subject well by colored pencil or hachure marks on the plat below.
2. If more than one lease is dedicated to the well, outline each and identify the ownership thereof (both as to working interest and royalty).
3. If more than one lease of different ownership is dedicated to the well, have the interests of all owners been consolidated by communitization, unitization, force-pooling, etc?

☐ Yes ☐ No If answer is "yes," type of consolidation _____

If answer is "no," list the owners and tract descriptions which have actually been consolidated. (Use reverse side of this form if necessary.) _____

No allowable will be assigned to the well until all interests have been consolidated (by communitization, unitization, forced-pooling, or otherwise) or until a non-standard unit, eliminating such interests, has been approved by the Commission.

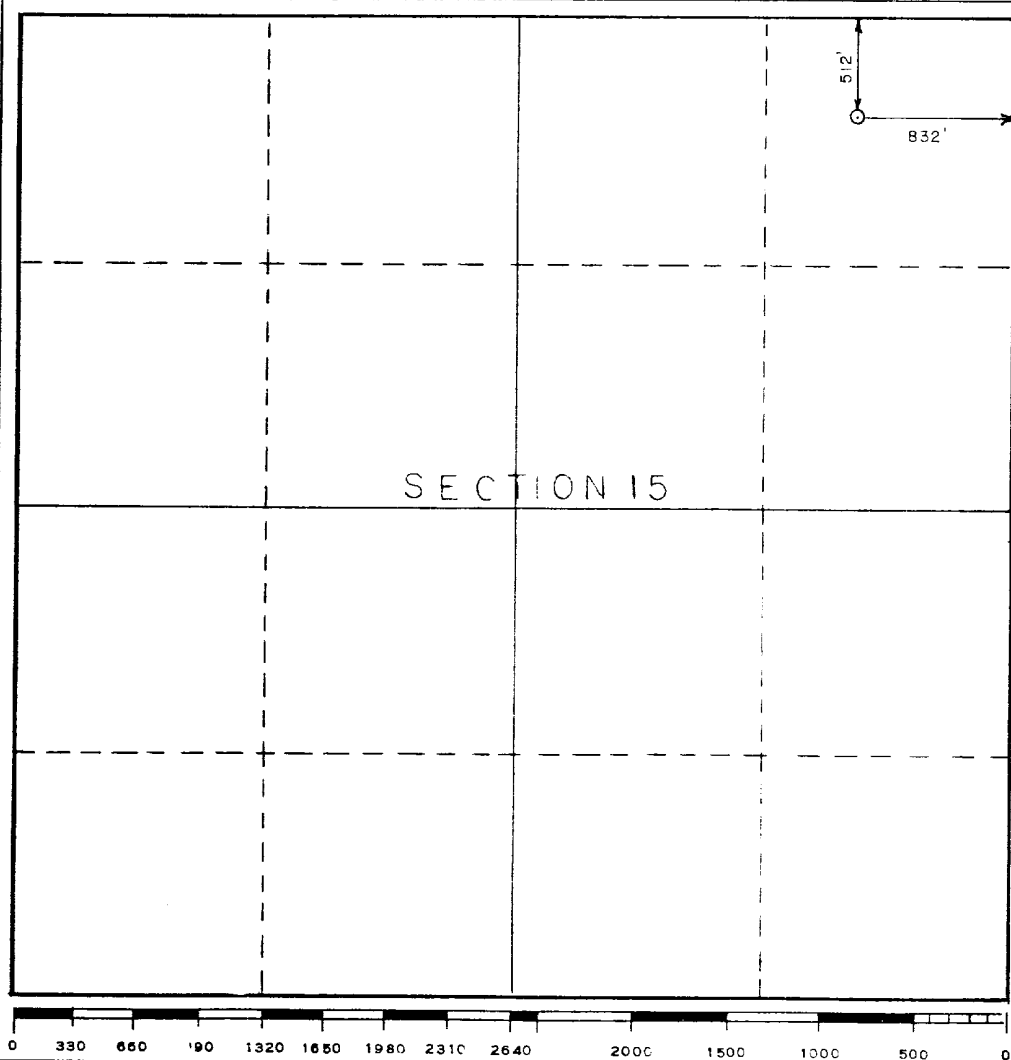

CERTIFICATION

I hereby certify that the information contained herein is true and complete to the best of my knowledge and belief.

Name
Charles C. Joy
Position
Agent
Company
Public Lands Exploration Co., Inc.
Date
12-7-1980

I hereby certify that the well location shown on this plat was plotted from field notes of actual surveys made by me or under my supervision, and that the same is true and correct to the best of my knowledge.

Date Surveyed
December 7, 1980
R. Pettigrew
Richard R. Pettigrew
Registered Professional Engineer
and of the State of New Mexico
Certificate No.
3276

TYPE OR PRINT NAME **Ramon Elias**

(This space for State Use)

APPROVED BY

DISTRICT SUPERVISOR

DATE

6-12-92

CONDITIONS OF APPROVAL IF ANY:

Submit 3 Copies
 to Appropriate
 District Office

State of New Mexico
 Energy, Minerals and Natural Resources Department

Form C-102
 Revised 1-1-89

OIL CONSERVATION DIVISION

P.O. Box 1688
 Santa Fe, New Mexico 87504-2088

DISTRICT I
 P.O. Box 1940, Hobbs, NM 88240

DISTRICT II
 P.O. Drawer DD, Artesia, NM 88210

DISTRICT III
 1000 Rio Brazos Rd., Aztec, NM 87410

WELL API NO.
5. Indicate Type of Lease STATE <input checked="" type="checkbox"/> FEE <input type="checkbox"/>
6. State Oil & Gas Lease No. L 6331
7. Lease Name or Unit Agreement Name O'Connell Ranch (Enhanced Recovery) Unit
8. Well No. ORU # 7
9. Pool Name or Wildcat Wildcat, White

SUNDRY NOTICES AND REPORTS ON WELLS (DO NOT USE THIS FORM FOR PROPOSALS TO DRILL OR TO DEEPEN OR PLUG BACK TO A DIFFERENT RESERVOIR. USE "APPLICATION FOR PERMIT" (FORM C-101) FOR SUCH PROPOSALS.)	
1. Type of Well: OIL WELL <input checked="" type="checkbox"/> GAS WELL <input type="checkbox"/> OTHER <input type="checkbox"/>	
2. Name of Operator Enercap Corporation	
3. Address of Operator 16945 Northchase Dr., Ste. 1700 Houston, TX 77060	
4. Well Location Unit Later A : 512 Feet From The N Line and 832 Feet From The E Line Section 12 Township 11 N Range 05 E T11N R05E 10. Elevation (Show whether OF, RGS, RT, GR, etc.) 4571.9' Gr	

11. Check Appropriate Box to Indicate Nature of Notice, Report, or Other Data NOTICE OF INTENTION TO:		SUBSEQUENT REPORT OF:	
PERFORM REMEDIAL WORK <input type="checkbox"/>	PLUG AND ABANDON <input checked="" type="checkbox"/>	REMEDIAL WORK <input type="checkbox"/>	ALTERING Casing <input type="checkbox"/>
TEMPORARILY ABANDON <input type="checkbox"/>	CHANGE PLANS <input type="checkbox"/>	COMMENCE DRILLING OPNS. <input type="checkbox"/>	PLUG AND ABANDONMENT <input type="checkbox"/>
PULL OR ALTER CASING <input type="checkbox"/>		CASING TEST AND CEMENT JOB <input type="checkbox"/>	
OTHER: <input type="checkbox"/>		OTHER: <input type="checkbox"/>	

12. Describe Proposed or Completed Operations (Clearly state all pertinent details, and give pertinent dates, including estimated date of starting any proposed work) SEE RULE 1103.

Run open ended tubing to 492'. Equilibrate 15.5 # cement to a minimum depth of 347'. Pull tubing. Fill remainder of hole with water. Set 20' surface plug. Set dry hole marker.

I hereby certify that the information above is true and accurate to the best of my knowledge and belief.

SIGNATURE Ramon Elias TITLE V. P. of Operations DATE 6/8/92
 TYPE OR PRINT NAME Ramon Elias TELEPHONE NO. (713) 816-0171

(This space for State Use)

APPROVED BY Ry E. [Signature] DISTRICT SUPERVISOR DATE 6-12-92
 CONDITIONS OF APPROVAL, IF ANY: