

OIL CONSERVATION DIVISION

P. O. BOX 2088

SANTA FE, NEW MEXICO 87501

API # 30-019-20056

Form C-101

Revised 10-1-78

NO. OF COPIES RECEIVED	
DISTRIBUTION	
SANTA FE	
FILE	
U.S.G.S.	
LAND OFFICE	
OPERATOR	

5A. Indicate Type of Lease
STATE ☒ FEE ☐

5. State Oil & Gas Lease No.

LG 1896

APPLICATION FOR PERMIT TO DRILL, DEEPEN, OR PLUG BACK

1a. Type of Work

b. Type of Well

DRILL ☒

DEEPEN ☐

PLUG BACK ☐

OIL WELL ☒

GAS WELL ☐

OTHER

SINGLE ZONE ☒

MULTIPLE ZONE ☐

2. Name of Operator

Public Lands Exploration Co., Inc.

3. Address of Operator

4835 LBJ Freeway, Suite 635, Dallas, Texas 75234

4. Location of Well

UNIT LETTER D

LOCATED 660

FEET FROM THE North

LINE

AND 990

FEET FROM THE West

LINE OF SEC. 16

TWP. 11N

RGE. 26E

NMPM

7. Unit Agreement Name

8. Farm or Lease Name

Joan - State

9. Well No.

1

10. Field and Pool, or Wildcat

Wildcat

12. County

Guadalupe

19. Proposed Depth

900'

19A. Formation

Chinle

20. Rotary or C.T.

Rotary

21. Elevations (Show whether DF, RT, etc.)

4757.3' GL

21A. Kind & Status Plug. Bond

Blanket

21B. Drilling Contractor

F. Rhynes Drilling Co.

22. Approx. Date Work will start

December 10, 1980

PROPOSED CASING AND CEMENT PROGRAM

SIZE OF HOLE	SIZE OF CASING	WEIGHT PER FOOT	SETTING DEPTH	SACKS OF CEMENT	EST. TOP
11"	8 5/8"	24	30	14	Surface
7 7/8"	4 1/2"	11.6	900	360	Surface

This well will be drilled with air. Blowout preventers will not be installed as a number of wells have been drilled in the field and no high pressure zones have been encountered. Oil zones encountered were saturated with an inactive oil that tested 15 degrees API gravity.

APPROVAL VALID FOR 90 DAYS
PERMIT DE LIES 4-13-81
UNLESS DRILLING UNDERWAY

NOTIFICATION OF BEGINNING OF OPERATIONS

ABOVE SPACE DESCRIBE PROPOSED PROGRAM: IF PROPOSAL IS TO DEEPEN OR PLUG BACK, GIVE DATA ON PRESENT PRODUCTIVE ZONE AND PROPOSED NEW PRODUCTIVE ZONE. GIVE BLOWOUT PREVENTER PROGRAM, IF ANY.

I hereby certify that the information above is true and complete to the best of my knowledge and belief.

Signature: Charles C. Joy Title: Agent Date: December 8, 1980
(This space for State Use)

PROVED BY: Carl Ulvog TITLE: DATE: 1-13-81
CONDITIONS OF APPROVAL, IF ANY:

NEW MEXICO OIL CONSERVATION COMMISSION
WELL LOCATION AND ACREAGE DEDICATION PLAT

Form 1-1982
Supersedes C-128
Effective 1-1-85

All distances must be from the outer boundaries of the Section.

Operator Public Lands Exploration Co., Inc.			Lease Joan-State		Well No. #1
Unit Letter D	Section 16	Township 11 North	Range 26 East	County Guadalupe	
Actual Footage Location of Well: 660 feet from the North line and 990 feet from the West line					
Ground Level Elev. 4757.3'	Producing Formation Chinle	Pool Wildcat	Dedicated Acreage: 40 Acres		

1. Outline the acreage dedicated to the subject well by colored pencil or hachure marks on the plat below.
2. If more than one lease is dedicated to the well, outline each and identify the ownership thereof (both as to working interest and royalty).
3. If more than one lease of different ownership is dedicated to the well, have the interests of all owners been consolidated by communitization, unitization, force-pooling, etc?

☐ Yes ☐ No If answer is "yes," type of consolidation _____

If answer is "no," list the owners and tract descriptions which have actually been consolidated. (Use reverse side of this form if necessary.) _____

No allowable will be assigned to the well until all interests have been consolidated (by communitization, unitization, forced-pooling, or otherwise) or until a non-standard unit, eliminating such interests, has been approved by the Commission.

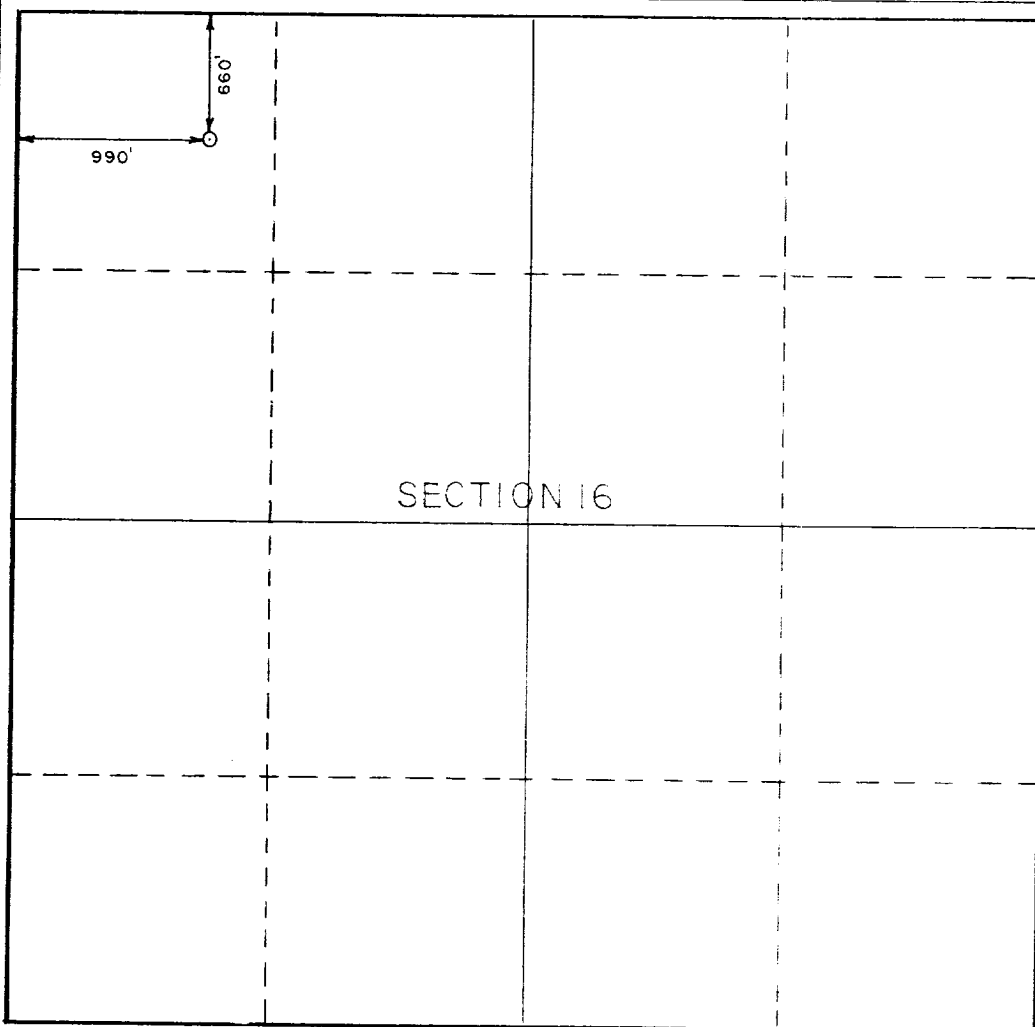

CERTIFICATION

I hereby certify that the information contained herein is true and complete to the best of my knowledge and belief.

Name
Charles C Joy
Position
Agent
Company
Public Lands Exploration Co., Inc
Date
12-11-1980

I hereby certify that the well location shown on this plat was plotted from field notes of actual surveys made by me or under my supervision, and that the same is true and correct to the best of my knowledge and belief.

Date Surveyed
December 11, 1980
Richard RICHARD M. LECHE
Registered Professional Engineer
and/or Land Surveyor

[Signature]
Certified by the State Engineer
and Surveyor