

| | |
|------------------------|--|
| NO. OF COPIES RECEIVED | |
| DISTRIBUTION | |
| SANTA FE | |
| FILE | |
| U.S.G.S. | |
| LAND OFFICE | |
| OPERATOR | |

NEW MEXICO OIL CONSERVATION COMMISSION

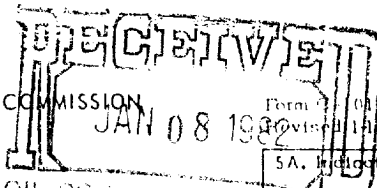

~~AMENDED AS TO LOCATION ONLY~~

API # 30-019-20067

| | | | |
|---|--|---|--|
| APPLICATION FOR PERMIT TO DRILL, DEEPEN, OR PLUG BACK | | | |
| 1a. Type of Work | | 7. Unit Agreement Name | |
| b. Type of Well OIL WELL <input type="checkbox"/> GAS WELL <input checked="" type="checkbox"/> OTHER <input type="checkbox"/> | | Pooling Application Pending | |
| 2. Name of Operator Dalton H. Cobb | | 8. Farm or Lease Name Tucumcari FNB | |
| 3. Address of Operator 370 One Marienfeld Place, Midland, Texas 79701 | | 9. Well No. 1-X | |
| 4. Location of Well UNIT LETTER P LOCATED 660 FEET FROM THE South LINE AND 710 FEET FROM THE East LINE OF SEC. 20 TWP. 8-N RGE. 22-E NMPM | | 10. Field and Pool, or Wildcat Wildcat | |
| 12. County Guadalupe | | | |
| 19. Proposed Depth 3400' | | 19A. Formation Abo | |
| 20. Rotary or C.T. Rotary | | | |
| 21. Elevations (Show whether DF, RT, etc.) 4199 GL | | 21A. Kind & Status Plug. Bond Blanket | |
| 21B. Drilling Contractor Vision Drilling Co. | | 22. Approx. Date Work will start 1 December 1981 | |

| 23. PROPOSED CASING AND CEMENT PROGRAM | | | | | |
|--|----------------|-----------------|---------------|-----------------|----------|
| SIZE OF HOLE | SIZE OF CASING | WEIGHT PER FOOT | SETTING DEPTH | SACKS OF CEMENT | EST. TOP |
| | | | | | |
| | | | | | |
| | | | | | |

Tucumcari FNB #1: 5-1/2" landed @ 3486'; string parted during cementing @ 1236'; dropped 30'. Squeezed 400 sx @ 400# in 5-1/2" casing for protection.

Amending location due to Tucumcari FNB #1 hole junked, moved location 50' due west per verbal permission from Carl Ulvog; please refer to C-102 originally filed to cover Tucumcari FNB #1 which shall now cover Tucumcari FNB #1-X. We will set 8-5/8" surface casing; circulate cement; rig up Blow-out preventer Shaeffer 10" series, 800 LWS, 3000# working pressure and 5000# test to oil string casing point @ 3400'; Log well and run 5-1/2" oil string and cement to surface.

OIL CONSERVATION COMMISSION TO BE NOTIFIED
WITHIN 20 DAYS OF BEGINNING OPERATIONS

COLLECT AND PACK SAMPLES FOR
NEW MEXICO DEPT. OF MINES, SOCORRO
AT AT LEAST TEN FOOT INTERVALS

IN ABOVE SPACE DESCRIBE PROPOSED PROGRAM; IF PROPOSAL IS TO DEEPEN OR PLUG BACK, GIVE DATA ON PRESENT PRODUCTIVE ZONE AND PROPOSED NEW PRODUCTIVE ZONE; GIVE BLOWOUT PREVENTER PROGRAM, IF ANY.

I hereby certify that the information above is true and complete to the best of my knowledge and belief.
Signed Carl Ulvog Title Agent for Operator Date 5 January 1981

(This space for State Use)
APPROVED BY Carl Ulvog TITLE SENIOR PETROLEUM GEOLOGIST DATE Jan. 11, 1982

CONDITIONS OF APPROVAL, IF ANY:
APPROVAL VALID FOR 90 DAYS
PERMIT EXPIRES 4-11-82
UNLESS DRILLING UNDERWAY

JAN 08 1982

All distances must be from the outer boundaries of the Section.

| | | | | | | |
|----------------------------|---------------|-----------------|------------------------|---------------------|---------------------------------------|---------------|
| Operator Dalton H. Cobb | | | Lease Tucumcari FNB | | CIL CONSERVATION DIVISION SANTA FE | Well No. 1 |
| Unit Letter P | Section 20 | Township 8-N | Range 22-E | County Guadalupe | | |

Actual Footage Location of Well:

| | | | | | | | |
|-------------------------------|----------------------------|-------|-----------------|-----|---------------|---------------------------------|------|
| 660 | feet from the | South | line and | 660 | feet from the | East | line |
| Ground Level Elev. 4799 GL | Producing Formation Abo | | Pool Wildcat | | | Dedicated Acreage: 160 Acres | |

1. Outline the acreage dedicated to the subject well by colored pencil or hatchure marks on the plat below.
2. If more than one lease is dedicated to the well, outline each and identify the ownership thereof (both as to working interest and royalty).
3. If more than one lease of different ownership is dedicated to the well, have the interests of all owners been consolidated by communitization, unitization, force-pooling, etc?

☐ Yes ☐ No If answer is "yes," type of consolidation _____

If answer is "no," list the owners and tract descriptions which have actually been consolidated. (Use reverse side of this form if necessary.) _____

No allowable will be assigned to the well until all interests have been consolidated (by communitization, unitization, forced-pooling, or otherwise) or until a non-standard unit, eliminating such interests, has been approved by the Division.

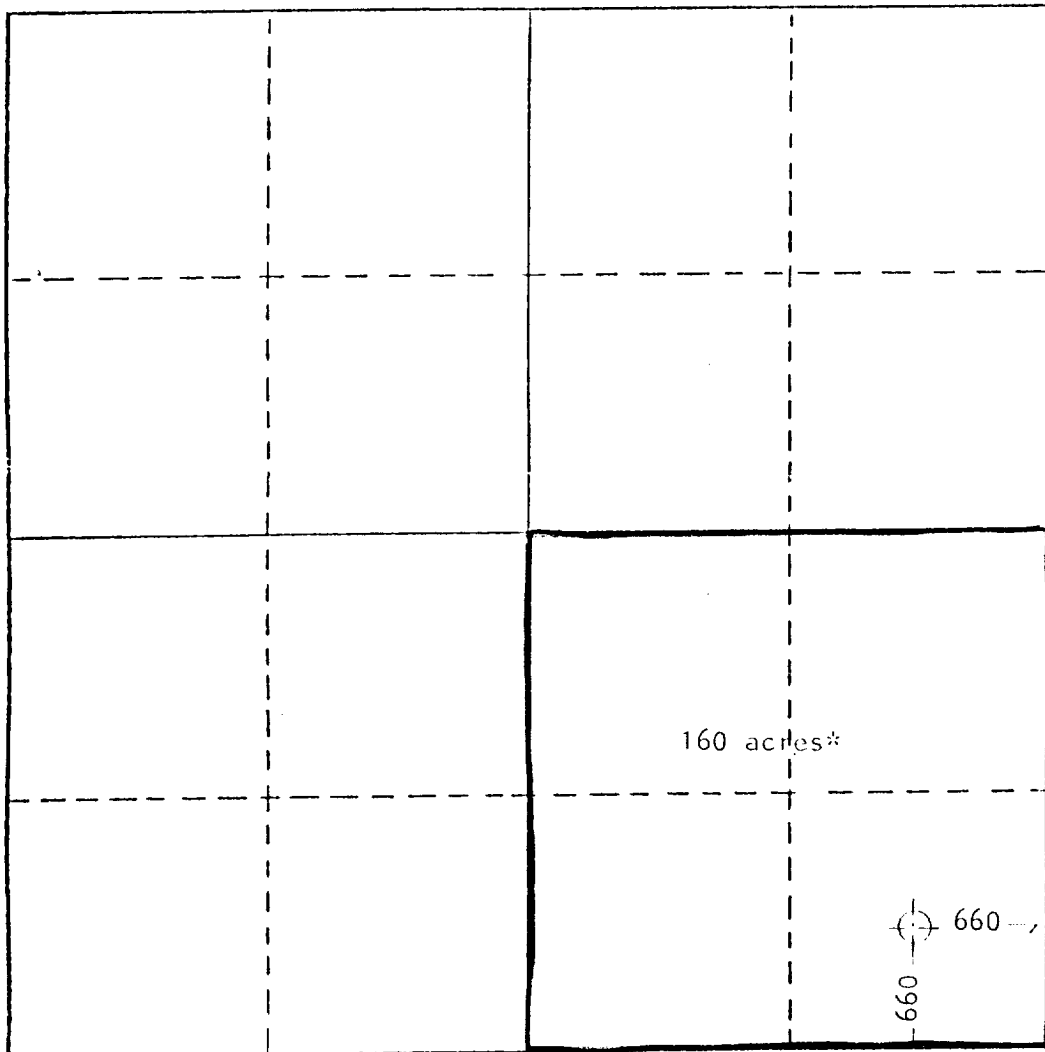

CERTIFICATION

I hereby certify that the information contained herein is true and complete to the best of my knowledge and belief.

Dalton H. Cobb
Name Dalton H. Cobb

Operator
Position
Dalton H. Cobb

Company
7 December 1981

Date

I hereby certify that the well location shown on this plat was plotted from field notes of actual surveys made by me or under my supervision, and that the same is true and correct to the best of my knowledge and belief.

Date Surveyed

Registered Professional Engineer and/or Land Surveyor

Certificate No.