

All distances must be from the outer boundaries of the Section.

Lessor TRANS-PECOS RESOURCES, INC.		Lease LATIGO RANCH BLOCK A		Well No. 1
Section G	Section 2	Township 9N	Range 23E	County GUADALUPE
Actual Postage Location of Well:				
1980	feet from the	NORTH	line and	1980
				feet from the
				EAST
Ground Level Elev. 4871	Producing Formation Penn	Pool Wildcat	Dedicated Acreage: 40 Acres	

1. Outline the acreage dedicated to the subject well by colored pencil or hatchure marks on the plat below.
2. If more than one lease is dedicated to the well, outline each and identify the ownership thereof (both as to working interest and royalty).
3. If more than one lease of different ownership is dedicated to the well, have the interests of all owners been consolidated by communitization, unitization, force-pooling, etc?

☐ Yes ☐ No If answer is "yes," type of consolidation _____

If answer is "no," list the owners and tract descriptions which have actually been consolidated. (Use reverse side of this form if necessary.) _____

No allowable will be assigned to the well until all interests have been consolidated (by communitization, unitization, forced-pooling, or otherwise) or until a non-standard unit, eliminating such interests, has been approved by the Division.

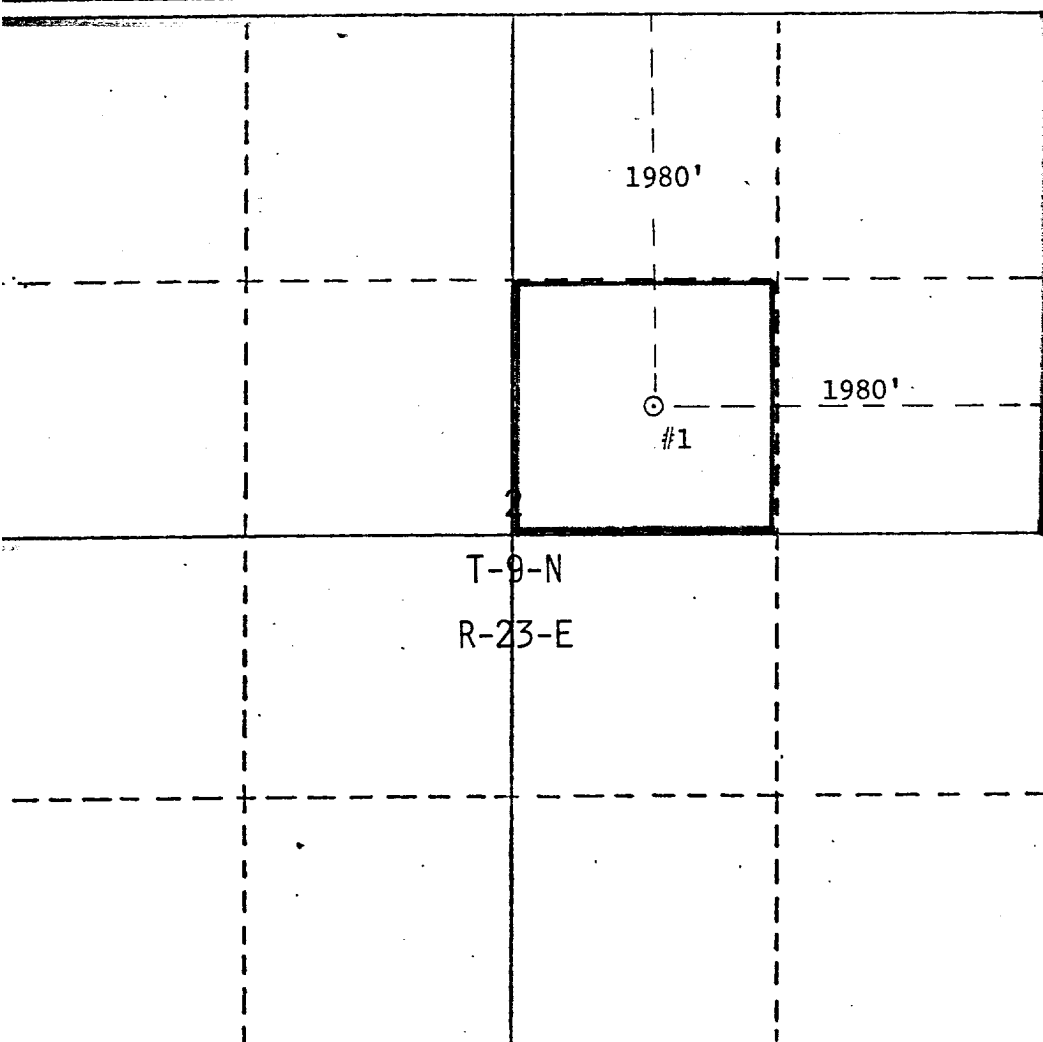

CERTIFICATION

I hereby certify that the information contained herein is true and complete to the best of my knowledge and belief.

Sue Vanderford
Name

Sue Vanderford
Position

Operations Analyst
Company

Trans-Pecos Resources, Inc.
Date

January 15, 1982

I have examined the well location shown on this plat was located from field notes and surveys made by me or under my supervision and that the same is true and correct to the best of my knowledge and belief.

January 15, 1982
Date Surveyed

W.D. Watson, Jr.
Registered Professional Engineer and/or Land Surveyor

W.D. Watson, Jr.
Certificate No.

3959