

OIL CONSERVATION DIVISION

P. O. BOX 2088

SANTA FE, NEW MEXICO 87501

Form C-101
Revised 10-1-78

NO. OF COPIES RECEIVED	
DISTRIBUTION	
SANTA FE	<input checked="" type="checkbox"/>
FILE	<input checked="" type="checkbox"/>
U.S.G.S.	
LAND OFFICE	
OPERATOR	

API # 30-019-20090

5A. Indicate Type of Lease
STATE ☐ REC ☒

5. State Oil & Gas Lease No.
Fee

APPLICATION FOR PERMIT TO DRILL, DEEPEN, OR PLUG BACK

a. Type of Work
DRILL ☒ DEEPEN ☐ PLUG BACK ☐

b. Type of Well
OIL WELL ☒ GAS WELL ☐ OTHER ☐

c. Name of Operator
McClellan Oil Corporation

7. Unit Agreement Name

8. Farm or Lease Name
Burner Fee

d. Address of Operator
P.O. Drawer 730, Roswell, NM 88201

e. Location of Well
UNIT LETTER I LOCATED 1980 FEET FROM THE South LINE

9. Well No.
2

10. Field and Pool, or Wildcat
Wildcat

NO 660 FEET FROM THE East LINE OF SEC. 31 TWP. 11-N RGE. 22-E NMPM

12. County
Guadalupe

19. Proposed Depth
5500'

19A. Formation
Granite Wash

13. Rotary or C.T.
Cable Tool to 1300
Rotary 1300-TD

1. Elevations (Show whether DT, KT, etc.)
4854' G.L.

21A. Kind & Status Plug. Bond
Statewide

21B. Drilling Contractor
Cortez Drilling

22. Approx. Date Work will start
4/15/84

PROPOSED CASING AND CEMENT PROGRAM

SIZE OF HOLE	SIZE OF CASING	WEIGHT PER FOOT	SETTING DEPTH	SACKS OF CEMENT	EST. TOP
18"	16"	48	40'	5 yds.	Circ.
12"	10-3/4"	40.5	700'	600	Circ.
7-7/8"	4-1/2"	10.5	5500'	500	2400

Propose to drill to the basement and test for production. Cable tools will be used to drill from surface to 50 feet into San Andres and 10-3/4" casing set and cemented. Will drill out with cable tools to approximately 1300 feet through Glorieta and then continue drilling with rotary rig to total depth.

Geologic Tops: Santa Rosa 160' Abo 2429'
San Andres 633' Penn 4510'
Glorieta 1074' Granite Wash 5259'
Yeso 1328'

COLLECT AND SAVE SAMPLES FOR
NEW MEXICO DEPT. OF MINES, SOCORRO
AT AT LEAST TEN FOOT INTERVALS

APPROVAL
PERMIT # 90
7-17-84
UNLESS DRILLING UNDERWAY

ABOVE SPACE DESCRIBE PROPOSED PROGRAM: IF PROPOSAL IS TO DEEPEN OR PLUG BACK, GIVE DATA ON PRESENT PRODUCTIVE ZONE AND PROPOSED NEW PRODUCTION ZONE. GIVE SLOWDOWN PREVENTER PROGRAM, IF ANY.

I hereby certify that the information above is true and complete to the best of my knowledge and belief.

Signed Paul Kargale Title Operations Manager Date 4/12/84

(This space for State Use)

PROVED BY Paul Kargale TITLE Operations Manager DATE 4-18-84

CONDITIONS OF APPROVAL, IF ANY:

OIL CONSERVATION COMMISSION TO BE NOTIFIED
WITHIN 24 HOURS OF BEGINNING OPERATIONS

All distances must be from the outer boundaries of the Section.

Operator McClellan Oil Corp...		Lease Burner Fee		Well No. 2
Unit Letter I	Section 31	Township 11 North	Range 22 East	County Guadalupe
Actual Postage Location of Well: 1980 feet from the South line and 660 feet from the East line				
Ground Level Elev. 4854	Producing Formation Granite Wash		Paul Wildcat	Dedicated Acreage 40 Acres

1. Outline the acreage dedicated to the subject well by colored pencil or hatchure marks on the plat below.
2. If more than one lease is dedicated to the well, outline each and identify the ownership thereof (both as to working interest and royalty).
3. If more than one lease of different ownership is dedicated to the well, have the interests of all owners been consolidated by communitization, unitization, force-pooling, etc?
☐ Yes ☐ No If answer is "yes," type of consolidation _____

If answer is "no," list the owners and tract descriptions which have actually been consolidated. (Use reverse side of this form if necessary.) _____

No allowable will be assigned to the well until all interests have been consolidated (by communitization, unitization, forced-pooling, or otherwise) or until a non-standard unit, eliminating such interests, has been approved by the Division

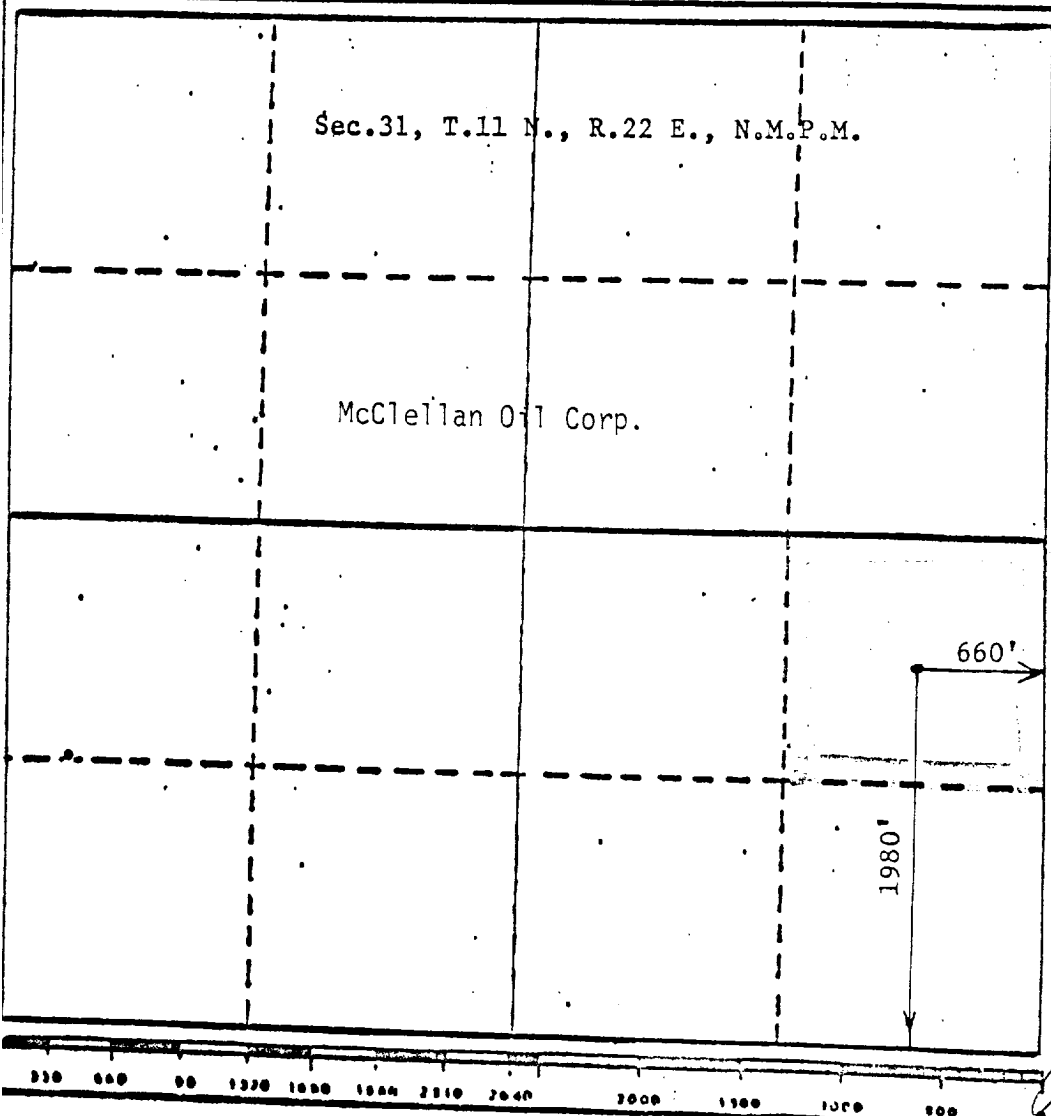

CERTIFICATION

I hereby certify that the information contained herein is true and complete to the best of my knowledge and belief.

Name

Paul Ragsdale

Position

Operations Manager

Company

McClellan Oil Corp.

Date

4/12/84

I hereby certify that the well location shown on this plat was plotted from field notes of actual surveys made by me or under my supervision, and that the same is true and correct to the best of my knowledge and belief.

Date Surveyed

April 5, 1984

Registered Professional Engineer and/or Land Surveyor

John D. Jacques, P.E. & L.S.

Crested, N.M. 6290