

| | | |
|------------------------|--|-------------------------------------|
| NO. OF COPIES RECEIVED | | |
| DISTRIBUTION | | |
| SANTA FE | | |
| FILE | | <input checked="" type="checkbox"/> |
| U.S.G.S. | | |
| LAND OFFICE | | |
| OPERATOR | | |

NEW MEXICO OIL CONSERVATION COMMISSION

Form C-101
Revised 1-1-65

| | |
|---|------------------------------|
| 5A. Indicate Type of Lease | |
| STATE <input checked="" type="checkbox"/> | FEE <input type="checkbox"/> |
| 5. State Oil & Gas Lease No. | |

APPLICATION FOR PERMIT TO DRILL, DEEPEN, OR PLUG BACK

| | | | |
|---|--|--|--|
| 1a. Type of Work | | 7. Unit Agreement Name | |
| b. Type of Well OIL WELL <input type="checkbox"/> GAS WELL <input checked="" type="checkbox"/> CO ₂ OTHER <input type="checkbox"/> | | 8. Form or Lease Name State GW | |
| 2. Name of Operator Amoco Production Company | | 9. Well No. 1 | |
| 3. Address of Operator P.O. Drawer "A", Levelland, TX 79336 | | 10. Field and Pool, or Well Unit Und. Tubb | |
| 4. Location of Well UNIT LETTER <u>K</u> LOCATED <u>1980</u> FEET FROM THE <u>South</u> LINE AND <u>1980</u> FEET FROM THE <u>West</u> LINE OF SEC. <u>4</u> TWP. <u>20-N</u> RGE. <u>32-E</u> NMPM | | 11. County Harding | |
| 12. Proposed Depth 2370' | | 13. Formation Tubb | |
| 14. Kind & Status Plug. Bond Blanket-on-File | | 15. Rotary or C.T. Rotary | |
| 21. Elevation (show whether DI, KI, etc.) 4766.50 GR | | 22. Approx. Date Work will start May 28, 1979 | |

23.

PROPOSED CASING AND CEMENT PROGRAM

| SIZE OF HOLE | SIZE OF CASING | WEIGHT PER FOOT | SETTING DEPTH | SACKS OF CEMENT | EST. TOP |
|--------------|----------------|-----------------|---------------|----------------------------|---------------|
| 12 1/4" | 9 5/8" | 40# | 350' | Circ to Surf | Surface |
| 8 3/4" | 7" | 23-26# | 2140' | Tie back to 9 5/8" csg. | Btm of 9 5/8" |

After drilling well, logs will be run and evaluation made. Perforating and/or stimulating as necessary in attempting commercial production.

Mud Program: 0 - 350' Native mud and water.
350' - 2370' Commercial mud to maintain good hole conditions.

BOP program is attached.
Gas is not dedicated.

IN ABOVE SPACE DESCRIBE PROPOSED PROGRAM; IF PROPOSAL IS TO DEEPEN OR PLUG BACK, GIVE DATA ON PRESENT PRODUCTIVE ZONE AND PROPOSED NEW PRODUCTIVE ZONE. GIVE BLOWOUT PREVENTER PROGRAM, IF ANY.

I hereby certify that the information above is true and complete to the best of my knowledge and belief.

Signed Randy Atkins Title Administrative Analyst Date May 4, 1979
(This space for State Use)

APPROVED BY Carl Wilcox TITLE DATE 5/9/79
CONDITIONS OF APPROVAL, IF ANY:

0+5-NMOCD,SF 1-Susp 1-JA
1-Houston 1-RWA

OIL COMMISSION WILL REVIEW THIS APPLICATION TO PERMIT TO DRILL WITHIN 24 HOURS OF RECEIVING COMPLETE APPLICATION.

90
8-7-79

NEW MEXICO OIL CONSERVATION COMMISSION
WELL LOCATION AND ACREAGE DEDICATION PLAT

Form C-132
Supersedes C-128
Effective 1-1-65

All distances must be from the outer boundaries of the Section

| | | | | |
|--|----------------------------------|-----------------------------|-------------------------|--------------------------|
| Owner AMOCO PRODUCTION COMPANY | | State STATE G. W. | | Page 1 |
| Section K | Section 4 | Range 20 NORTH | Range 32 EAST | County HARDING |
| 1980 | | 1980 | | WEST |
| Ground Level Elev 4766.50 | Forming Formation Tubb | Undesignated Tubb | | Section 160 |

1. Outline the acreage dedicated to the subject well by colored pencil or hatchure marks on the plat below.
2. If more than one lease is dedicated to the well, outline each and identify the ownership thereof (both as to working interest and royalty).
3. If more than one lease of different ownership is dedicated to the well, have the interests of all owners been consolidated by communitization, unitization, force-pooling, etc?

☐ Yes ☐ No If answer is "yes," type of consolidation _____

If answer is "no," list the owners and tract descriptions which have actually been consolidated (on reverse side of this form if necessary.) _____

No allowable will be assigned to the well until all interests have been consolidated (by communitization, unitization, forced-pooling, or otherwise) or until a non-standard unit, eliminating such interests, has been approved by the Commission.

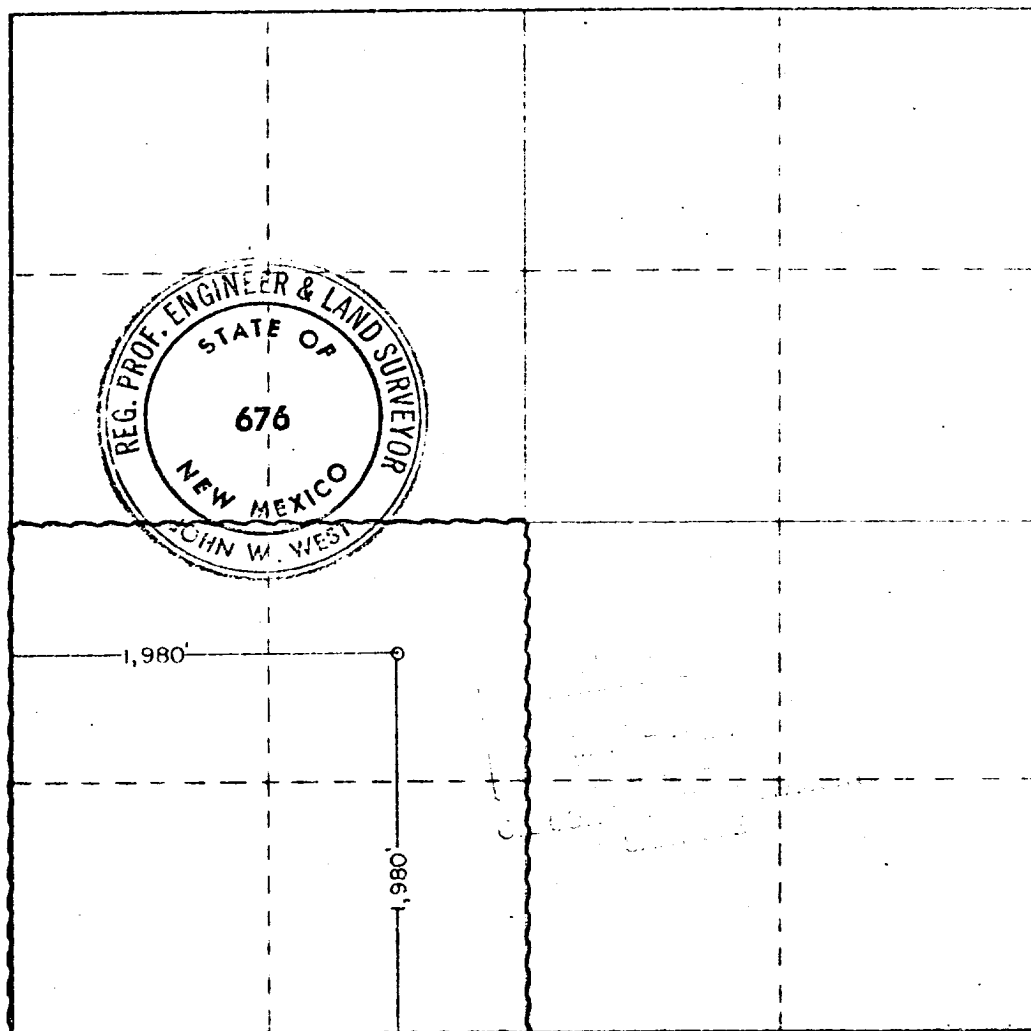

CERTIFICATION

I hereby certify that the information contained herein is true and complete to the best of my knowledge and belief.

Randy Atkins

Administrative Analyst

Amoco Production Company

May 4, 1979

I hereby certify that the well location shown on this plat was plotted from field notes of actual surveys made by me or under my supervision and that the same is true and correct to the best of my knowledge and belief.

APRIL 27TH, 1979.

Date Surveyed

Registered Professional Engineer and/or Land Surveyor

John W. West

Certificate No. John W. West 676

Ronald J. Eldon 3239

ATTACHMENT "B"
NOTES

1. Blow-out preventers and master valve to be fluid operated and oil fittings must be in good condition, 3,000# W.P. (6,000 p.s.i. test), minimum.
2. Equipment through which bit must pass shall be as large as the inside diameter of the casing that is being drilled through.
3. Nipple above blow-out preventer shall be same size as casing being drilled through.
4. Kelly cock required, 3,000# W.P. (6,000 p.s.i. test) minimum.
5. OMSCO or comparable safety valve must be available on rig floor at all times with proper connection or sub, 3,000# W.P. (6,000 p.s.i. test), minimum.
6. Blow-out preventers and master valve while drilling intermediate hole to 6000' may be 2,000# W.P. (4,000 p.s.i. test), minimum.
7. Choke assembly, beyond second valve from cross, may be positioned (Optional) outside of derrick foundation.
8. Spool or cross may be eliminated if connections are available in the lower part of the blow-out preventer body.
9. Plug valves - gate valves are optional. Valves shown as 2" are minimum size.
10. Casing head and casing head spool, including attached valves, to be furnished by Amoco.
11. Rams in preventers will be installed as follows:
 When drilling, use:
 Top Preventer - Drill pipe rams
 Bottom Preventer - Blind rams or master valve
 When running casing, use:
 Top Preventer - Casing rams
 Bottom Preventer - Blind rams or master valve

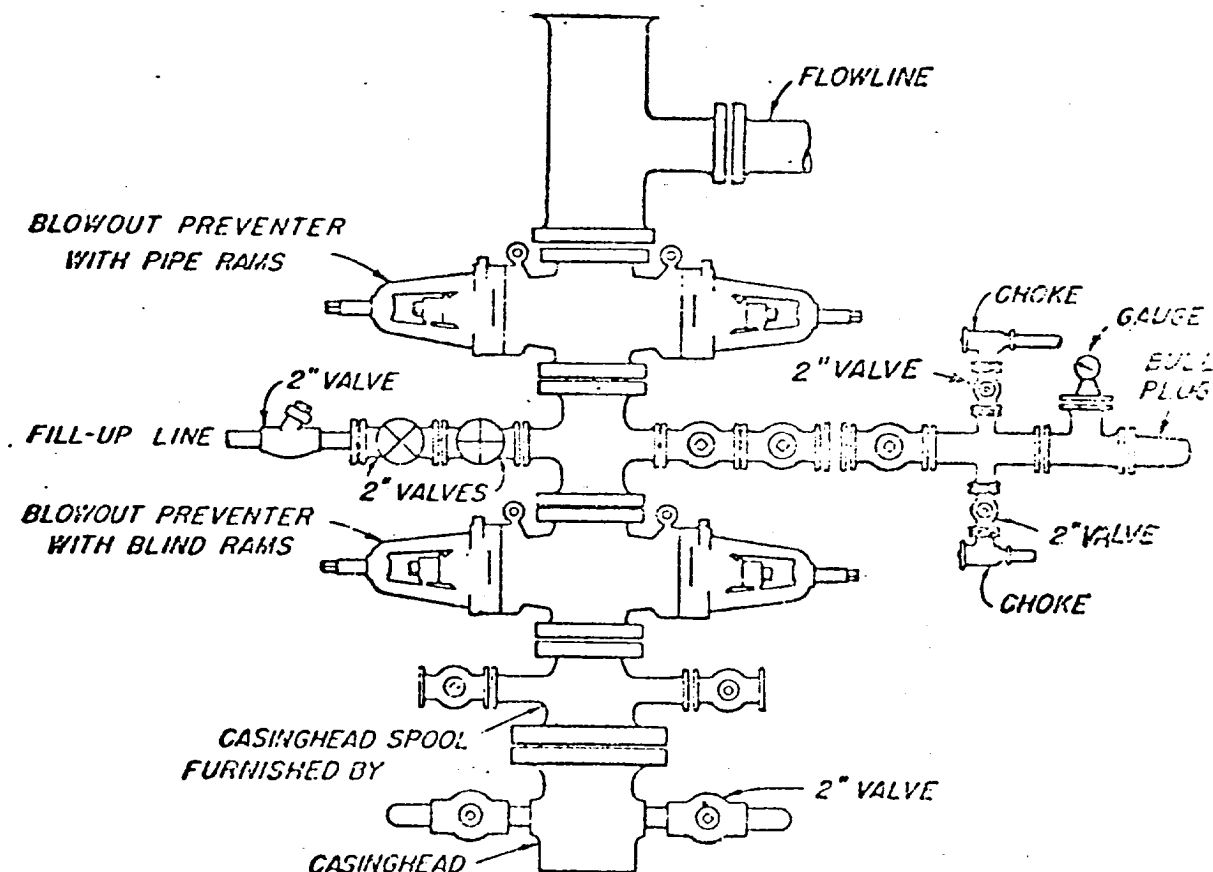

BLOWOUT PREVENTER HOOK-UP

AMOCO PREVENTION SERVICE

EXHIBIT D-1 MODIFIED

JUNE 1, 1962