

NO. OF COPIES RECEIVED	
DISTRIBUTION	
SANTA FE	
FILE	
U.S.G.S.	
LAND OFFICE	
OPERATOR	

NEW MEXICO OIL CONSERVATION COMMISSION

API # 30-021-20070

Form C-101  
Revised 1-4-85

5A. Indicate Type of Lease	
STATE <input checked="" type="checkbox"/>	FEE <input type="checkbox"/>
5. State Oil & Gas Lease No.	

APPLICATION FOR PERMIT TO DRILL, DEEPEN, OR PLUG BACK

1a. Type of Work		7. Unit Agreement Name	
b. Type of Well DRILL <input checked="" type="checkbox"/> DEEPEN <input type="checkbox"/> PLUG BACK <input type="checkbox"/>		8. Farm or Lease Name State JP	
OIL WELL <input type="checkbox"/> GAS WELL <input checked="" type="checkbox"/> CO <sub>2</sub> OTHER <input type="checkbox"/> SINGLE ZONE <input checked="" type="checkbox"/> MULTIPLE ZONE <input type="checkbox"/>		9. Well No. 1	
2. Name of Operator Amoco Production Company		10. Field and Pool, or Wildcat Und. Tubb	
3. Address of Operator P. O. Box 68, Hobbs, New Mexico 88240		12. County Harding	
4. Location of Well UNIT LETTER K LOCATED 1980 FEET FROM THE South LINE AND 1980 FEET FROM THE West LINE OF SEC. 23 TWP. 21-N RGE. 33-E NMPM			
19. Proposed Depth 2780'		19A. Formation Tubb	
20. Rotary or C.T. Rotary			
21. Elevations (Show whether DT, RT, etc.) 4886 GL		21A. Kind & Status Plug. Bond Blanket-On-File	
21B. Drilling Contractor NA		22. Approx. Date Work will start 12-10-80	

PROPOSED CASING AND CEMENT PROGRAM

SIZE OF HOLE	SIZE OF CASING	WEIGHT PER FOOT	SETTING DEPTH	SACKS OF CEMENT	EST. TOP
11" or 12 1/4"	8 5/8"	24#	700'	Circ	Surf
7 7/8"	5 1/2"	14#	2780'	Tie back to 8 5/8"	BTM to 8 5/8"

Propose to drill and equip well in the Tubb formation. After reaching TD logs will be run and evaluated. Perforate and stimulate as necessary in attempting commercial production.

Mud Program: 0'-700' Native mud and fresh water  
700'-TD Commercial mud and brine water with minimum properties for safe hole conditions.

BOP Program Attached

Gas is not dedicated

APPROVAL VALID FOR 90 DAYS  
PERMIT EXPIRES 3-9-81  
UNLESS DRILLING UNDERWAY

0 + 2NMCD -SF 1-Hou 1-Susp 1-BD

IN ABOVE SPACE DESCRIBE PROPOSED PROGRAM: IF PROPOSAL IS TO DEEPEN OR PLUG BACK, GIVE DATA ON PRESENT PRODUCTIVE ZONE AND PROPOSED NEW PRODUCTIVE ZONE. GIVE BLOWOUT PREVENTER PROGRAM, IF ANY.

I hereby certify that the information above is true and complete to the best of my knowledge and belief.

Signed Bob Davis Title Admin. Analyst Date 12-1-80

(This space for State Use)

APPROVED BY Carl Hilwig TITLE SENIOR PLANNING ENGINEER DATE 12/2/80

CONDITIONS OF APPROVAL, IF ANY:

OIL CONSERVATION COMMISSION TO BE NOTIFIED  
WITHIN 24 HOURS OF BEGINNING OPERATIONS

All distances must be from the outer boundaries of the Section.

Operator <b>AMOCO</b>			Lease <b>STATE OF NEW MEXICO</b>		Well No. <b>JP 1</b>
Unit Letter <b>K</b>	Section <b>23</b>	Township <b>T 21 N</b>	Range <b>R 33E</b>	County <b>HARDING</b>	
Actual Postage Location of Well: 1980 feet from the <b>SOUTH</b> line and 1980 feet from the <b>WEST</b> line					
Ground Level Elev. <b>4886</b>	Producing Formation <b>Tubb</b>		Pool <b>Und. Tubb</b>	Dedicated Acreage: <b>160</b> Acres	

1. Outline the acreage dedicated to the subject well by colored pencil or hachure marks on the plat below.
2. If more than one lease is dedicated to the well, outline each and identify the ownership thereof (both as to working interest and royalty).
3. If more than one lease of different ownership is dedicated to the well, have the interests of all owners been consolidated by communitization, unitization, force-pooling, etc?

☐ Yes ☐ No If answer is "yes," type of consolidation \_\_\_\_\_

If answer is "no," list the owners and tract descriptions which have actually been consolidated. (Use reverse side of this form if necessary.) \_\_\_\_\_

No allowable will be assigned to the well until all interests have been consolidated (by communitization, unitization, forced-pooling, or otherwise) or until a non-standard unit, eliminating such interests, has been approved by the Division.

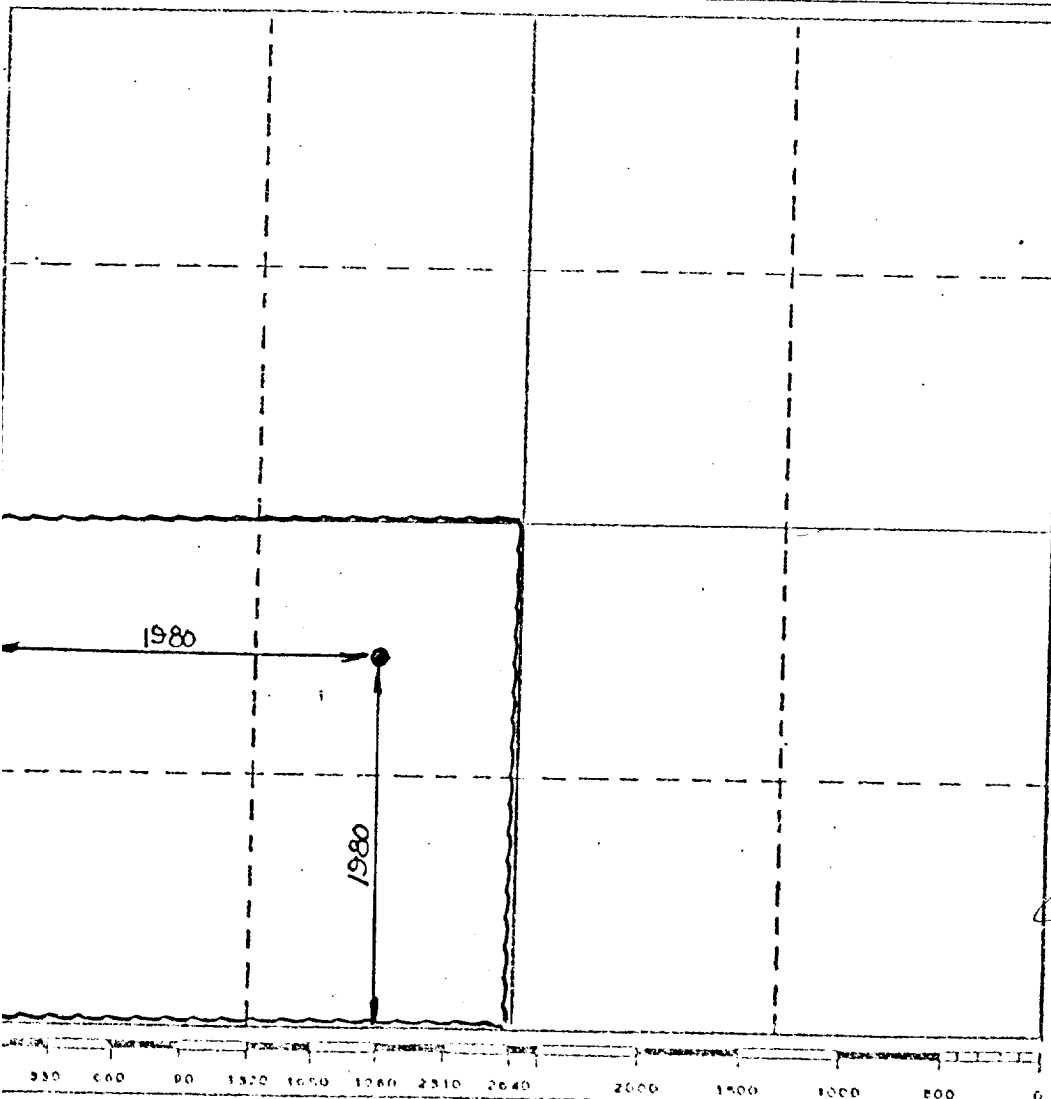

CERTIFICATION

I hereby certify that the information contained herein is true and complete to the best of my knowledge and belief.

Name **Bob Davis**  
Position **Admin. Analyst**  
Company **Amoco Production Company**  
Date **12-1-80**

I hereby certify that the well location shown on this plat was plotted from field notes of actual surveys made by me or under my supervision, and that the same is true and correct to the best of my knowledge and belief.

NOV. 19, 1980

Date Surveyed  
**5103**  
Registered Professional Engineer  
and/or Land Surveyor  
**N.M.L.S. NO. 5103**

Certificate No. **2**

ATTACHMENT "B"  
NOTES

1. Blow-out preventers and master valve to be fluid operated and oil fittings must be in good condition, 3,000# W.P. (6,000 p.s.i. test), minimum.
2. Equipment through which bit must pass shall be as large as the inside diameter of the casing that is being drilled through.
3. Nipple above blow-out preventer shall be same size as casing being drilled through.
4. Kelly cock required, 3,000# W.P. (6,000 p.s.i. test) minimum.
5. OHSCO or comparable safety valve must be available on rig floor at all times with proper connection or sub, 3,000# W.P. (6,000 p.s.i. test), minimum.
6. Blow-out preventers and master valve while drilling intermediate hole to 6000' may be 2,000# W.P. (4,000 p.s.i. test), minimum.
7. Choke assembly, beyond second valve from cross, may be positioned (Optional) outside of derrick foundation.
8. Spool or cross may be eliminated if connections are available in the lower part of the blow-out preventer body.
9. Plug valves - gate valves are optional. Valves shown as 2" are minimum size.
10. Casing head and casing head spool, including attached valves, to be furnished by Amoco.
11. Rams in preventers will be installed as follows:
 

When drilling, use:	When running casing, use:
Top Preventer - Drill pipe rams	Top Preventer - Casing rams
Bottom Preventer - Blind rams or master valve	Bottom Preventer - Blind rams or master valve

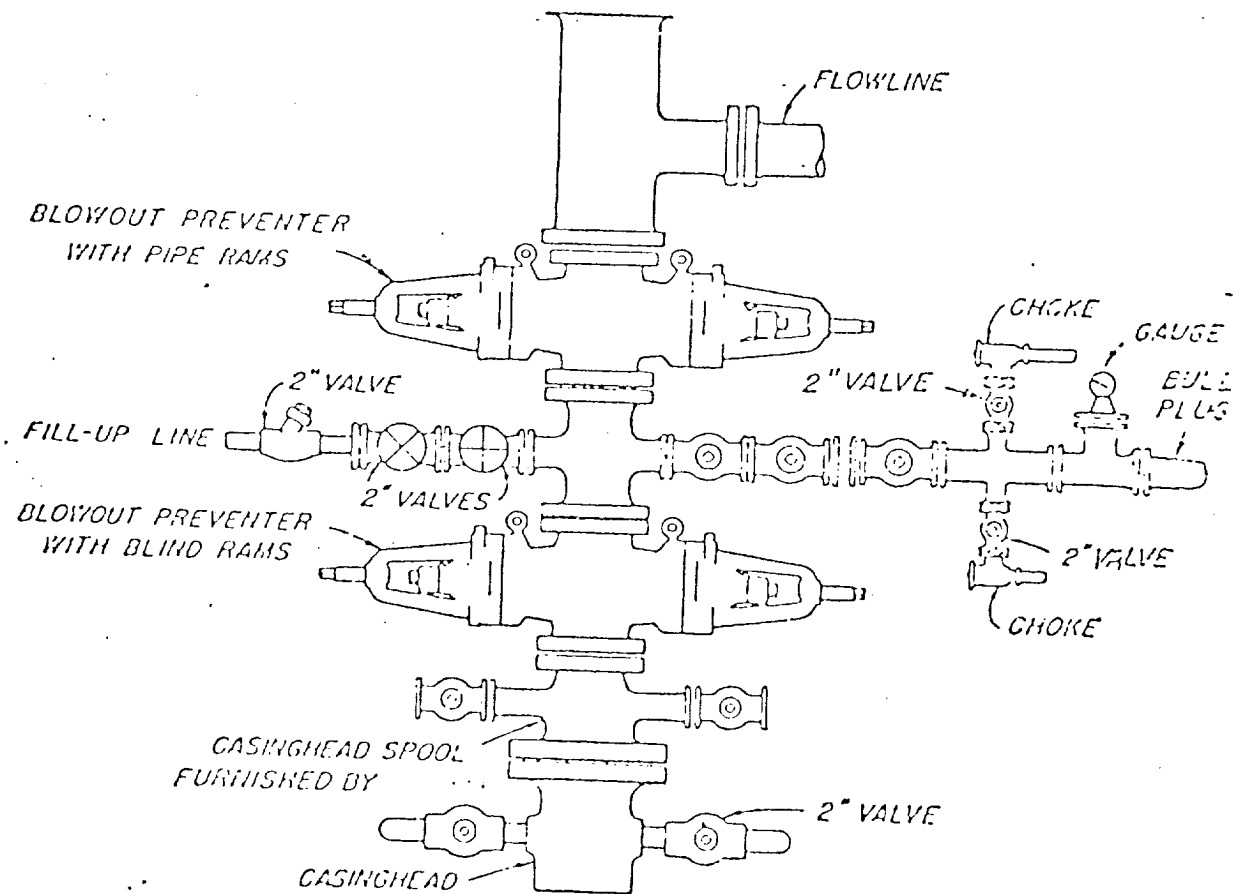

BLOWOUT PREVENTER HOOK-UP

AMOCO PRODUCTION COMPANY

EXHIBIT D-1 MODIFIED

JUNE 1 1962