

NO. OF COPIES RECEIVED	
DISTRIBUTION	
SANTA FE	
FILE	<input checked="" type="checkbox"/>
U.S.G.S.	
LAND OFFICE	
OPERATOR	

# NEW MEXICO OIL CONSERVATION COMMISSION

Form C-101  
Revised 1-1-65

API #30-021-20082

## APPLICATION FOR PERMIT TO DRILL, DEEPEN, OR PLUG BACK

1a. Type of Work		7. Unit Agreement Name	
b. Type of Well DRILL <input checked="" type="checkbox"/> DEEPEN <input type="checkbox"/> PLUG BACK <input type="checkbox"/> OIL WELL <input type="checkbox"/> GAS WELL <input checked="" type="checkbox"/> CO2 OTHER <input type="checkbox"/> SINGLE ZONE <input checked="" type="checkbox"/> MULTIPLE ZONE <input type="checkbox"/>		8. Farm or Lease Name State LF	
2. Name of Operator Amoco Production Company		9. Well No. 1	
3. Address of Operator P. O. Box 68 Hobbs, NM 88240		10. Field and Pool, or Wildcat Und. Tubb	
4. Location of Well UNIT LETTER <u>F</u> LOCATED <u>1780</u> FEET FROM THE <u>North</u> LINE AND <u>1980</u> FEET FROM THE <u>West</u> LINE OF SEC. <u>18</u> TWP. <u>18-N</u> RGE. <u>31-E</u> NMPM		12. County Harding	
18. Proposed Depth 2215'		19A. Formation Tubb	
20. Rotary or C.T. Rotary		21. Elevations (Show whether DF, RT, etc.) 4455' GL	
21A. Kind & Status Plug. Bond Blanket-on-file		21B. Drilling Contractor NA	
22. Approx. Date Work will start 12-30-80			

## PROPOSED CASING AND CEMENT PROGRAM

SIZE OF HOLE	SIZE OF CASING	WEIGHT PER FOOT	SETTING DEPTH	SACKS OF CEMENT	EST. TOP
11" or 12-1/4"	8-5/8"	24#	700'	Circ.	Surf.
7-7/8"	5-1/2"	14#	2215'	Tie back to 8-5/8"	BTM 8-5/8"

Propose to drill and equip well in the Tubb formation. After reaching TD logs will be run and evaluated. Perforate and stimulate as necessary in attempting commercial production.

MUD PROGRAM: 0'-700' Native mud and fresh water  
700'-TD Commercial mud and brine water with minimum properties for safe hole conditions.

BOP PROGRAM ATTACHED  
Gas is not dedicated.

APPROVAL VALID FOR 180 DAYS  
PERMIT EXPIRES 6-25-81  
UNLESS DRILLING UNDERWAY

0+2-NMOCD, SF 1-Hou 1-Susp 1-BD

IN ABOVE SPACE DESCRIBE PROPOSED PROGRAM: IF PROPOSAL IS TO DEEPEN OR PLUG BACK, GIVE DATA ON PRESENT PRODUCTIVE ZONE AND PROPOSED NEW PRODUCTIVE ZONE. GIVE BLOWOUT PREVENTER PROGRAM, IF ANY.

I hereby certify that the information above is true and complete to the best of my knowledge and belief.

Signed Bob Davis Title Admin. Analyst Date 12-19-80

(This space for State Use)

APPROVED BY Carl Ullberg TITLE SENIOR PETROLEUM GEOLOGIST DATE 12/29/80

CONDITIONS OF APPROVAL, IF ANY:

OIL CONSERVATION COMMISSION TO BE NOTIFIED  
WITHIN 24 HOURS OF BEGINNING OPERATIONS

All distances must be from the outer boundaries of the Section.

Operator AMOCO		Lease STATE OF NEW MEXICO		Well No. LF 1
Unit Letter F	Section 18	Township T18N	Range R31E	County HARDING

Actual Footage Location of Well:				
1780	feet from the NORTH	line and	1980	feet from the WEST
Ground Level Elev. 4455	Producing Formation Tubb	Pool Und. Tubb	Dedicated Acreage: 160 Acres	

1. Outline the acreage dedicated to the subject well by colored pencil or hachure marks on the plat below.
2. If more than one lease is dedicated to the well, outline each and identify the ownership thereof (both as to working interest and royalty).
3. If more than one lease of different ownership is dedicated to the well, have the interests of all owners been consolidated by communitization, unitization, force-pooling, etc?

☐ Yes ☐ No If answer is "yes," type of consolidation \_\_\_\_\_

If answer is "no," list the owners and tract descriptions which have actually been consolidated. (Use reverse side of this form if necessary.) \_\_\_\_\_

No allowable will be assigned to the well until all interests have been consolidated (by communitization, unitization, forced-pooling, or otherwise) or until a non-standard unit, eliminating such interests, has been approved by the Division.

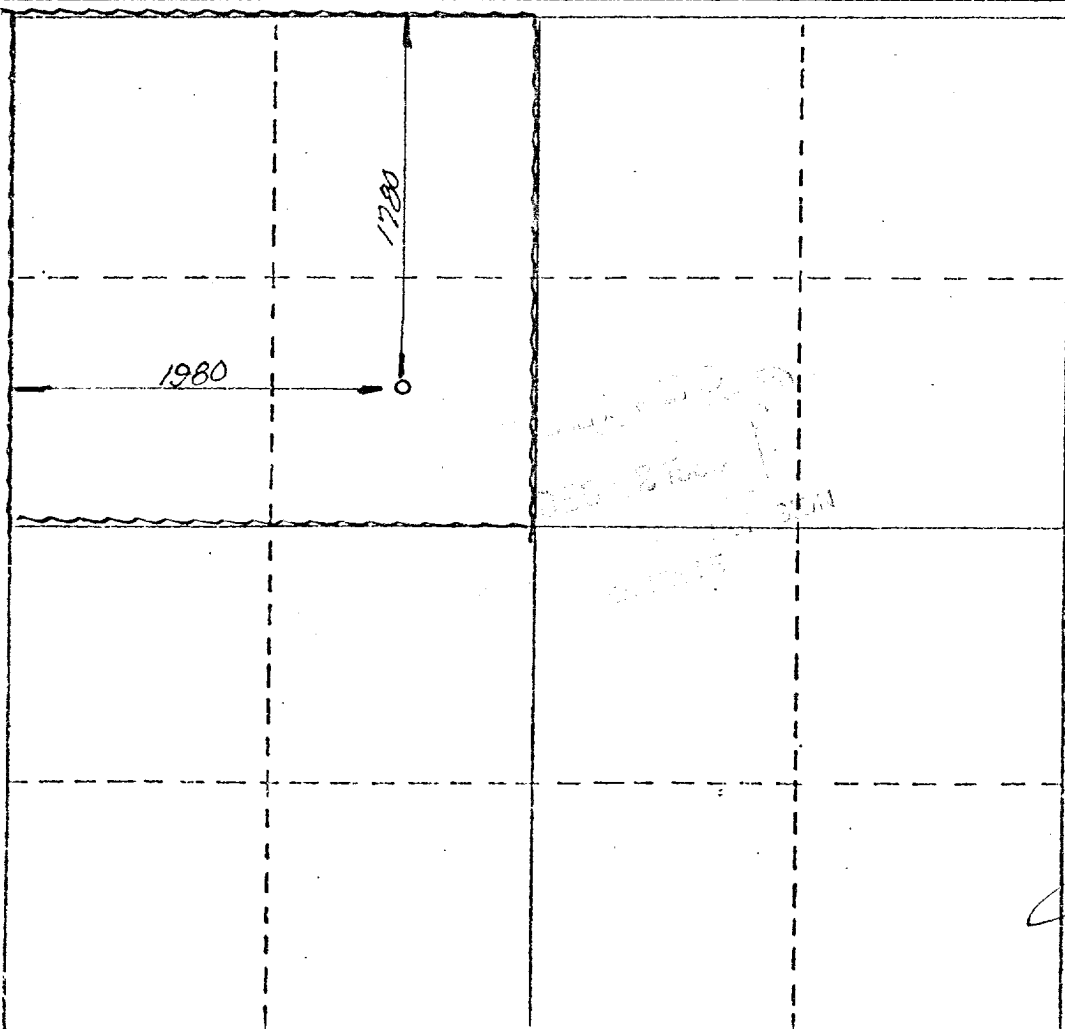

CERTIFICATION

I hereby certify that the information contained herein is true and complete to the best of my knowledge and belief.

Name Bob Davis  
Position Admin. Analyst  
Company Amoco Production Company  
Date 12-19-80

I hereby certify that the well location shown on this plat was plotted from field notes of actual surveys made by me or under my supervision, and that the same is true and correct to the best of my knowledge and belief.

DEC 31 1980  
Date Surveyed  
[Signature]  
Registered Professional Engineer  
and/or Land Surveyor

N.M.L.S. NO. 5103  
Certificate No. \_\_\_\_\_

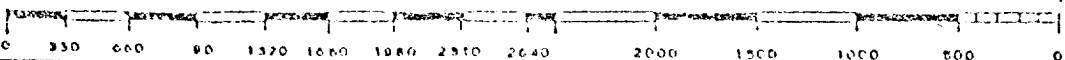

ATTACHMENT "B"  
NOTES

1. Blow-out preventers and master valve to be fluid operated and oil fittings must be in good condition, 3,000# W.P. (6,000 p.s.i. test), minimum.
2. Equipment through which bit must pass shall be as large as the inside diameter of the casing that is being drilled through.
3. Nipple above blow-out preventer shall be same size as casing being drilled through.
4. Kelly cock required, 3,000# W.P. (6,000 p.s.i. test) minimum.
5. OMSCO or comparable safety valve must be available on rig floor at all times with proper connection or sub, 3,000# W.P. (6,000 p.s.i. test), minimum.
6. Blow-out preventers and master valve while drilling intermediate hole to 6000' may be 2,000# W.P. (4,000 p.s.i. test), minimum.
7. Choke assembly, beyond second valve from cross, may be positioned (Optional) outside of derrick foundation.
8. Spool or cross may be eliminated if connections are available in the lower part of the blow-out preventer body.
9. Plug valves - gate valves are optional. Valves shown as 2" are minimum size.
10. Casing head and casing head spool, including attached valves, to be furnished by Amoco.
11. Rams in preventers will be installed as follows:  

When drilling, use:	When running casing, use:
Top Preventer - Drill pipe rams	Top Preventer - Casing rams
Bottom Preventer - Blind rams or master valve	Bottom Preventer - Blind rams or master valve

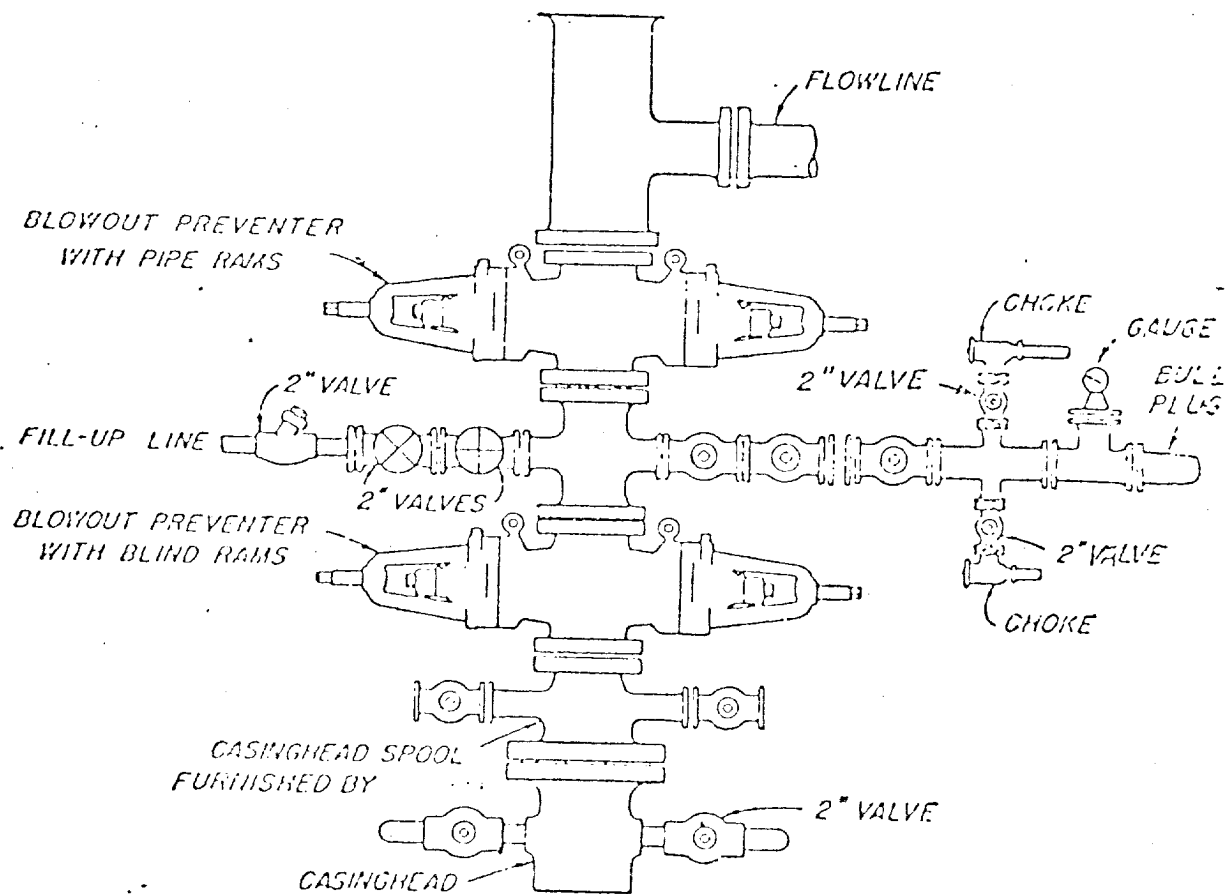

### BLOWOUT PREVENTER HOOK-UP

AMOCO PRODUCTION COMPANY

EXHIBIT D-1 MODIFIED

JUNE 1, 1962