

NO. OF COPIES RECEIVED	
DISTRIBUTION	
SANTA FE	
FILE	
U.S.G.S.	
LAND OFFICE	
OPERATOR	

# NEW MEXICO OIL CONSERVATION COMMISSION

Form C-101  
Revised 1-1-65

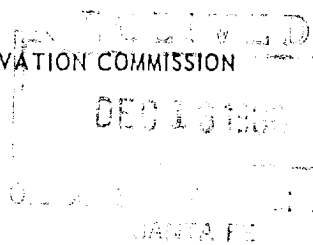

5A. Indicate Type of Lease	
STATE <input checked="" type="checkbox"/>	FEE <input type="checkbox"/>
14. State Oil & Gas Lease No.	

API # 30-021-20095

## APPLICATION FOR PERMIT TO DRILL, DEEPEN, OR PLUG BACK

1a. Type of Work		7. Unit Agreement Name	
b. Type of Well OIL WELL <input type="checkbox"/> GAS WELL <input checked="" type="checkbox"/> CO2 OTHER <input type="checkbox"/>		8. Farm or Lease Name State KC	
2. Name of Operator Amoco Production Company		9. Well No. 1	
3. Address of Operator P. O. Box 68 Hobbs, NM 88240		10. Field and Pool, or Wildcat Und. Tubb	
4. Location of Well UNIT LETTER <u>G</u> LOCATED <u>1980</u> FEET FROM THE <u>North</u> LINE AND <u>1980</u> FEET FROM THE <u>East</u> LINE OF SEC. <u>26</u> TWP. <u>20-N</u> RGE. <u>31-E</u> NMPM		12. County Harding	
11. Proposed Depth 2360'		15A. Formation Tubb	
11A. Kind & Status Plan, Bond Blanket-on-file		20. Rotary or C.T. Rotary	
21. Elevations (Show whether DF, RL, etc.) 4700.7		22. Approx. Date Work will start 12-15-80	

## PROPOSED CASING AND CEMENT PROGRAM

SIZE OF HOLE	SIZE OF CASING	WEIGHT PER FOOT	SETTING DEPTH	SACKS OF CEMENT	EST. TOP
11" or 12-1/4"	8-5/8"	24#	700'	Circ.	Surf.
7-7/8"	5-1/2"	14#	2360'	Tie back to 8-5/8"	BTM 8-5/8"

Propose to drill and equip well in the Tubb formation. After reaching TD logs will be run and evaluated. Perforate and stimulate as necessary in attempting commercial production.

MUD PROGRAM: 0'-700' Native mud and fresh water  
700'-TD Commercial mud and brine water with minimum properties for safe hole conditions.

BOP Program Attached  
Gas is not dedicated

APPROVAL VALID FOR 180 DAYS  
PERMIT EXPIRES 6-25-81  
UNLESS DRILLING UNDERWAY

0+2-NMOCD, SF 1-Hou 1-Susp 1-BD

IN ABOVE SPACE DESCRIBE PROPOSED PROGRAM; IF PROPOSAL IS TO DEEPEN OR PLUG BACK, GIVE DATA ON PRESENT PRODUCTIVE ZONE AND PROPOSED NEW PRODUCTIVE ZONE. GIVE BLOWOUT PREVENTER PROGRAM, IF ANY.

I hereby certify that the information above is true and complete to the best of my knowledge and belief.

Signed Bob Laws Title Admin. Analyst Date 12-10-80

(This space for State Use)

APPROVED BY Carl Uhlig TITLE  DATE 12/29/80

CONDITIONS OF APPROVAL, IF ANY:

OIL CONSERVATION COMMISSION TO BE NOTIFIED  
WITHIN 60 DAYS OF COMMENCING OPERATIONS

**NEW MEXICO OIL CONSERVATION COMMISSION  
WELL LOCATION AND ACREAGE DEDICATION PLAT**

Form C-102  
Supersedes C-128  
Effective 1-1-65

All distances must be from the outer boundaries of the Section

Operator <b>Amoco Production Co.</b>			Lease <b>State "KC"</b>		Well No. <b>1</b>
Unit Letter <b>G</b>	Section <b>26</b>	Township <b>20 North</b>	Range <b>31 East</b>	County <b>SANTA FE</b>	
Actual Footage Location of Well: <div style="display: flex; justify-content: space-between;"> <span>1980 feet from the <b>North</b> line and</span> <span>1980 feet from the <b>East</b> line</span> </div>					
Ground Level Elev. <b>4700.7</b>	Producing Formation <b>Tubb</b>		Pool <b>Und. Tubb</b>	Dedicated Acreage: <b>160</b> Acres	

1. Outline the acreage dedicated to the subject well by colored pencil or hatchure marks on the plat below.
2. If more than one lease is dedicated to the well, outline each and identify the ownership thereof (both as to working interest and royalty).
3. If more than one lease of different ownership is dedicated to the well, have the interests of all owners been consolidated by communitization, unitization, force-pooling, etc?

☐ Yes   ☐ No   If answer is "yes," type of consolidation \_\_\_\_\_

If answer is "no," list the owners and tract descriptions which have actually been consolidated. (Use reverse side of this form if necessary.) \_\_\_\_\_

No allowable will be assigned to the well until all interests have been consolidated (by communitization, unitization, forced-pooling, or otherwise) or until a non-standard unit, eliminating such interests, has been approved by the Commission.

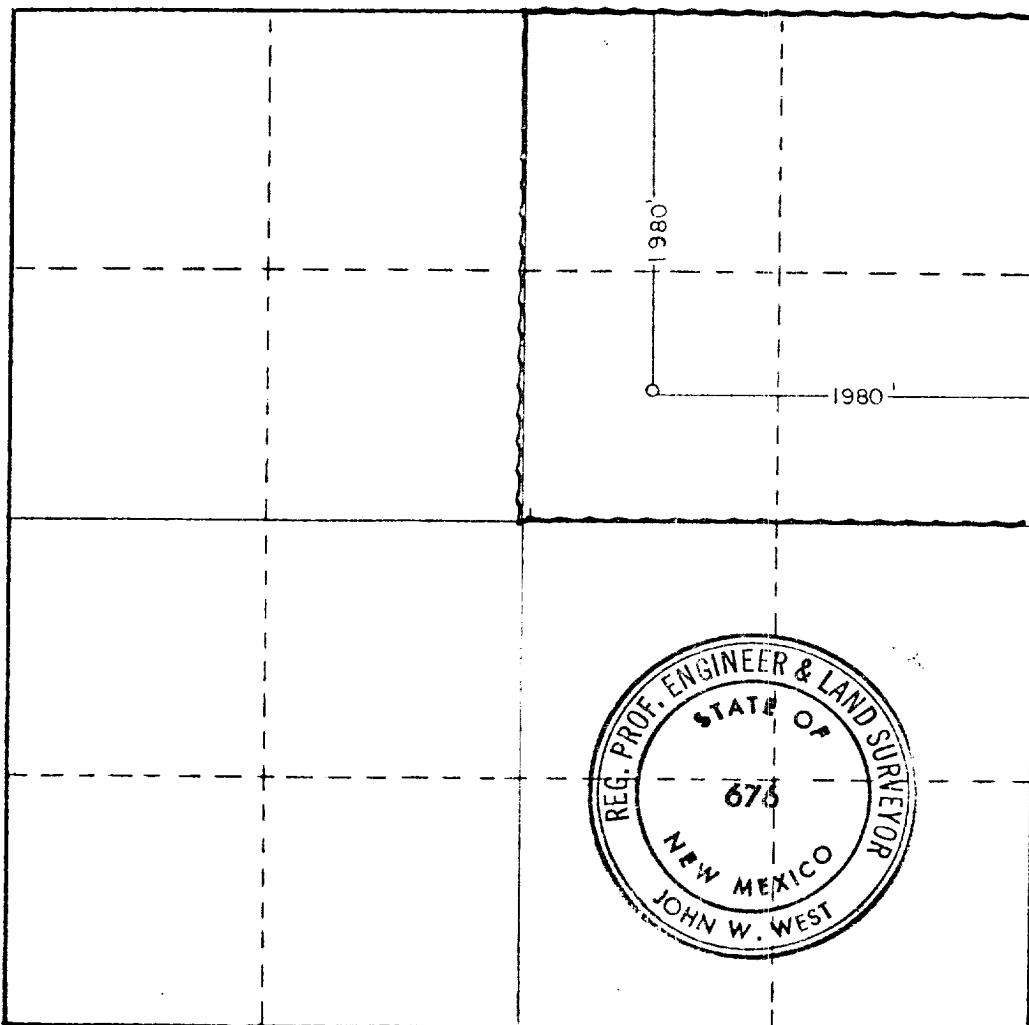

**CERTIFICATION**

*I hereby certify that the information contained herein is true and complete to the best of my knowledge and belief.*

Name **Bob Davis**  
 Position **Admin. Analyst**  
 Company **Amoco Production Company**  
 Date **12-10-80**

*I hereby certify that the well location shown on this plat was plotted from field notes of actual surveys made by me or under my supervision, and that the same is true and correct to the best of my knowledge and belief.*

Date Surveyed **12-4-80**  
 Registered Professional Engineer and/or Land Surveyor

*John W. West*  
 Certificate No **JOHN W. WEST 676**  
**PATRICK A. ROMERO 6663**  
**Ronald J. Eidson 3239**

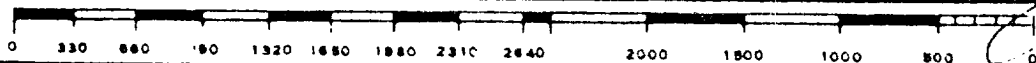

ATTACHMENT "B"  
NOTES

1. Blow-out preventers and master valve to be fluid operated and oil fittings must be in good condition, 3,000# W.P. (6,000 p.s.i. test), minimum.
2. Equipment through which bit must pass shall be as large as the inside diameter of the casing that is being drilled through.
3. Nipple above blow-out preventer shall be same size as casing being drilled through.
4. Kelly cock required, 3,000# W.P. (6,000 p.s.i. test) minimum.
5. OHSCO or comparable safety valve must be available on rig floor at all times with proper connection or sub, 3,000# W.P. (6,000 p.s.i. test), minimum.
6. Blow-out preventers and master valve while drilling intermediate hole to 6000' may be 2,000# W.P. (4,000 p.s.i. test), minimum.
7. Choke assembly, beyond second valve from cross, may be positioned (Optional) outside of derrick foundation.
8. Spool or cross may be eliminated if connections are available in the lower part of the blow-out preventer body.
9. Plug valves - gate valves are optional. Valves shown as 2" are minimum size.
10. Casing head and casing head spool, including attached valves, to be furnished by Amoco.
11. Rams in preventers will be installed as follows:  

When drilling, use:	When running casing, use:
Top Preventer - Drill pipe rams	Top Preventer - Casing rams
Bottom Preventer - Blind rams or master valve	Bottom Preventer - Blind rams or master valve

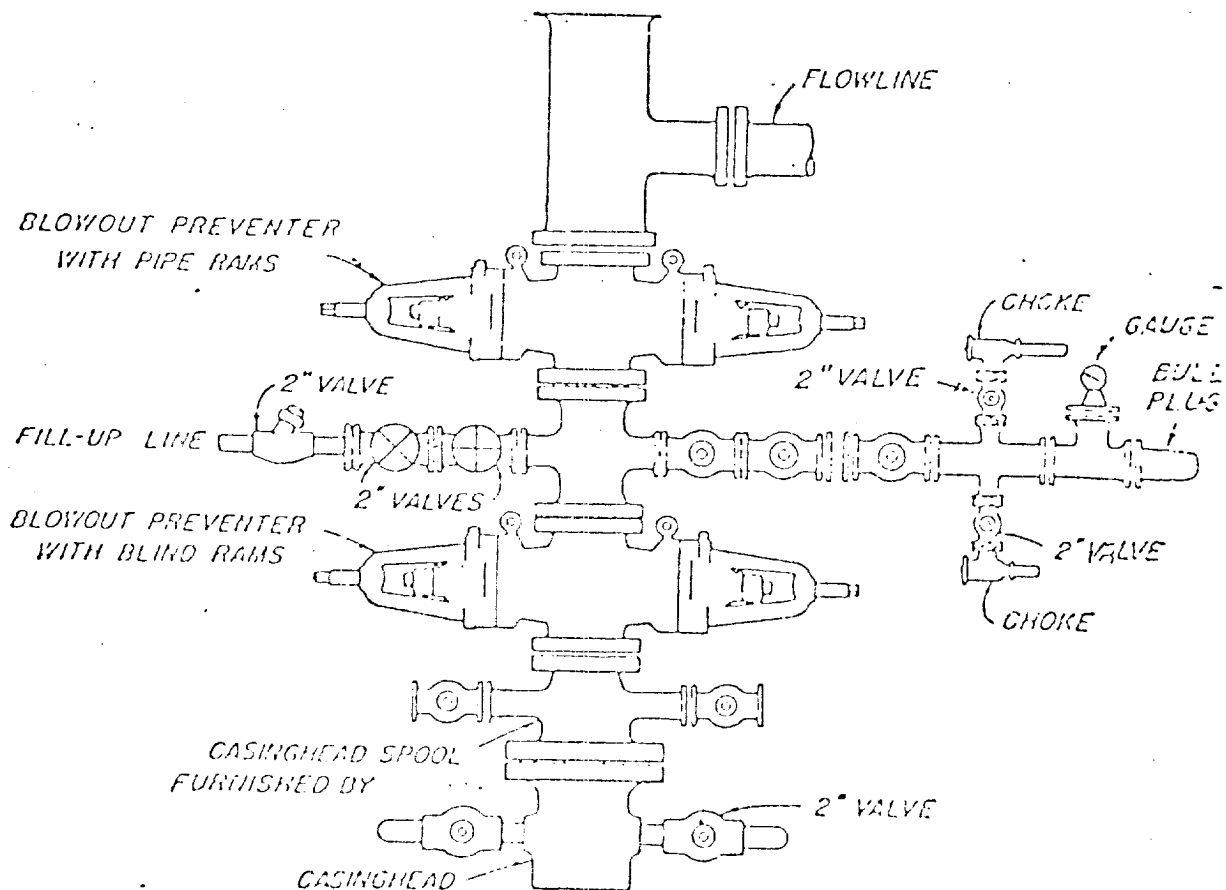

### BLOWOUT PREVENTER HOOK-UP

AMOCO FIELD SERVICE COMPANY

### EXHIBIT D-1 MODIFIED

JUNE 1, 1962