

NO. OF COPIES RECEIVED	
DISTRIBUTION	
SANTA FE	
FILE	✓
U.S.G.S.	
LAND OFFICE	
OPERATOR	

NEW MEXICO OIL CONSERVATION COMMISSION

API # 30-021-20118

Form C-101  
Revised 1-1-65

5A. Indicate Type of Lease	
STATE <input checked="" type="checkbox"/>	FEE <input type="checkbox"/>
5. State Oil & Gas Lease No.	
L-5853	

APPLICATION FOR PERMIT TO DRILL, DEEPEN, OR PLUG BACK

1a. Type of Work		7. Unit Agreement Name	
b. Type of Well DRILL <input type="checkbox"/> DEEPEN <input type="checkbox"/> PLUG BACK <input type="checkbox"/> OIL WELL <input type="checkbox"/> GAS WELL <input type="checkbox"/> OTHER CO <sub>2</sub> Supply SINGLE ZONE <input checked="" type="checkbox"/> MULTIPLE ZONE <input type="checkbox"/>		8. Farm or Lease Name STATE DF	
2. Name of Operator Cities Service Company		9. Well No. 1	
3. Address of Operator Box 1919, Midland, TX 79702		10. Field and Pool, or Wildcat Bravo Dome Area	
4. Location of Well UNIT LETTER G LOCATED 1980 FEET FROM THE North LINE AND 1980 FEET FROM THE East LINE OF SEC. 6 TWP. 18N RGE. 30E NMPM		12. County Harding	
10. Proposed Depth 2500'		19A. Formation Tubb	
21. Elevations (Show whether DF, RT, etc.) Not Available		20. Rotary or C.T. Rotary	
21A. Kind & Status Plug. Bond Required/Approved		21B. Drilling Contractor Not Released	
22. Approx. Date Work will start Feb. 15--May 1, 1981			

23. PROPOSED CASING AND CEMENT PROGRAM

SIZE OF HOLE	SIZE OF CASING	WEIGHT PER FOOT	SETTING DEPTH	SACKS OF CEMENT	EST. TOP
12 1/4"	8-5/8"	24#	700'	400	Circulate
7-7/8"	5 1/2"	14#	2500'	600	Circulate

It is proposed to drill this well to a total depth of 2,500' to test the Tubb formation. The blowout prevention program is as follows:

1. one set of blind rams
2. one set of drill pipe rams

The acreage assigned to this well is not dedicated to any CO<sub>2</sub> purchaser.

APPROVAL FOR 90 DAYS  
FEBRUARY 1981  
UNLESS DRILLING UNDERWAY

IN ABOVE SPACE DESCRIBE PROPOSED PROGRAM: IF PROPOSAL IS TO DEEPEN OR PLUG BACK, GIVE DATA ON PRESENT PRODUCTIVE ZONE AND PROPOSED NEW PRODUCTIVE ZONE. GIVE BLOWOUT PREVENTER PROGRAM, IF ANY.

I hereby certify that the information above is true and complete to the best of my knowledge and belief.

Signed [Signature] Title Region Oper. Mgr. Date 2/6/81

(This space for State Use)

APPROVED BY [Signature] TITLE SENIOR ENGINEER DATE 2/10/81

CONDITIONS OF APPROVAL, IF ANY:

NEW MEXICO OIL CONSERVATION COMMISSION  
WELL LOCATION AND ACREAGE DEDICATION PLAT

Form C-102  
Supersedes C-128  
Effective 1-1-65

All distances must be from the water boundaries of the Section

Operator Cities Service Oil Company		Lease State of DE		Well No. 1	
Unit Letter G	Section 6	Township 18 North	Range 30 East	County Harding	
Actual Footage Location of Well: 1980 feet from the North line and 1980 feet from the East line					
Ground Level Elev.	Producing Formation Tubb	Pool Bravo Dome Area	Dedicated Acreage: 40 Acres		

1. Outline the acreage dedicated to the subject well by colored pencil or hatchure marks on the plat below.
2. If more than one lease is dedicated to the well, outline each and identify the ownership thereof (both as to working interest and royalty).
3. If more than one lease of different ownership is dedicated to the well, have the interests of all owners been consolidated by communitization, unitization, force-pooling, etc?

☐ Yes ☐ No If answer is "yes," type of consolidation \_\_\_\_\_

If answer is "no," list the owners and tract descriptions which have actually been consolidated. (Use reverse side of this form if necessary.) \_\_\_\_\_

No allowable will be assigned to the well until all interests have been consolidated (by communitization, unitization, forced-pooling, or otherwise) or until a non-standard unit, eliminating such interests, has been approved by the Commission.

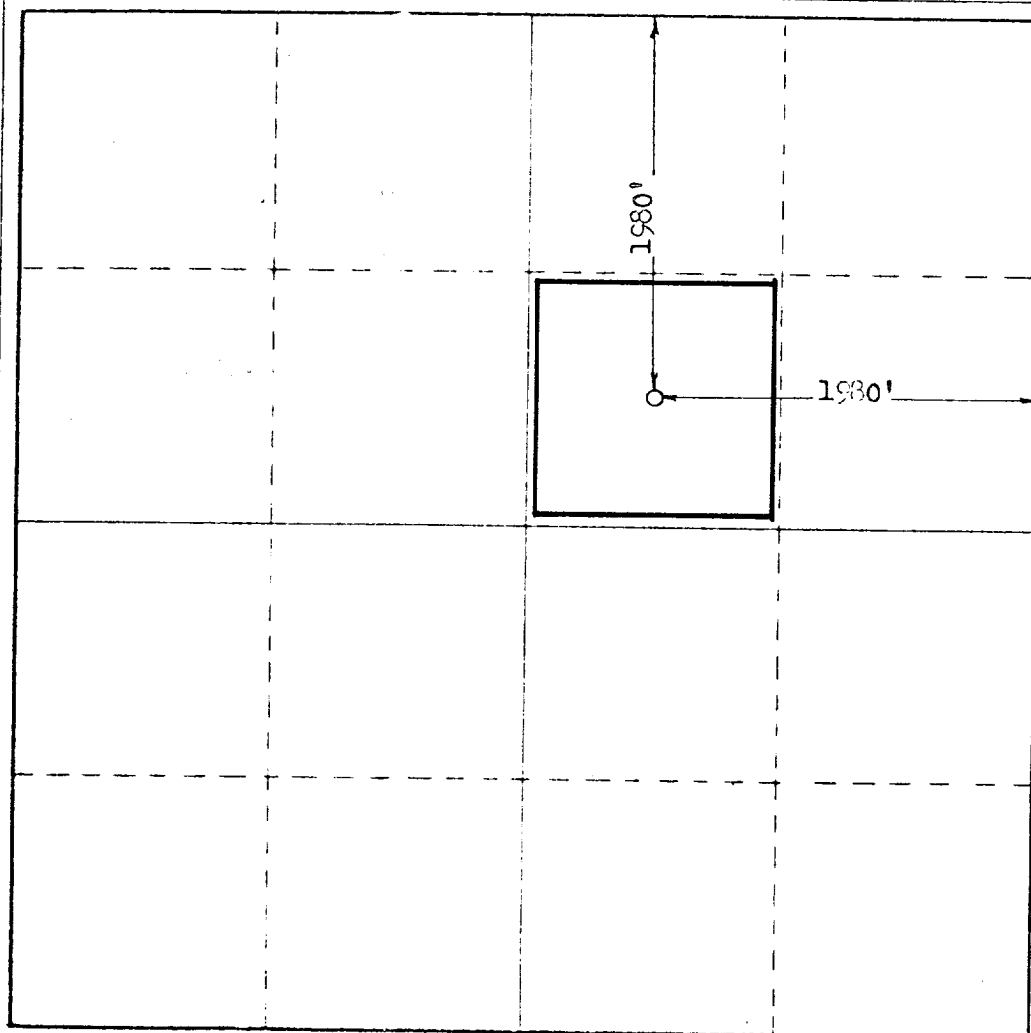

CERTIFICATION

I hereby certify that the information contained herein is true and complete to the best of my knowledge and belief.

Name R. J. Eidson  
Position  
Region Oper. Mgr.  
Company  
Cities Service Co.  
Date  
2/6/81

I hereby certify that the well location shown on this plat was plotted from field notes of actual surveys made by me or under my supervision, and that the same is true and correct to the best of my knowledge and belief.

No. 3239  
Date Surveyed  
Registered Professional Engineer and Land Surveyor  
Ronald J. Eidson  
Certificate No. John W. West 676  
Ronald J. Eidson 3239

