

NO. OF COPIES RECEIVED	
DISTRIBUTION	
SANTA FE	
FILE	✓
U.S.G.S.	
LAND OFFICE	
OPERATOR	

NEW MEXICO OIL CONSERVATION COMMISSION

API # 30-021-20122

Form C-101
Revised 1-1-65

5A. Indicate Type of Lease	
STATE <input checked="" type="checkbox"/>	FEE <input type="checkbox"/>
5. State Oil & Gas Lease No.	
L-5814	
7. Unit Agreement Name	
8. Farm or Lease Name	
STATE DI	
9. Well No.	
1	
10. Field and Pool, or Wildcat	
Bravo Dome Area	
12. County	
Harding	
19. Proposed Depth	19A. Formation
2500'	Tubb
20. Rotary or C.T.	
Rotary	
21. Elevations (Show whether DF, RT, etc.)	21A. Kind & Status Plug. Bond
Not Available	Required/Approved
21B. Drilling Contractor	
Not Released	
22. Approx. Date Work will start	
Feb. 15 - May 1, 1981	

1a. Type of Work	
b. Type of Well	
DRILL <input type="checkbox"/>	DEEPEN <input type="checkbox"/>
OIL WELL <input type="checkbox"/>	GAS WELL <input type="checkbox"/>
OTHER CO ₂ Supply	
2. Name of Operator	
Cities Service Company	
3. Address of Operator	
Box 1919, Midland, TX 79702	
4. Location of Well	
UNIT LETTER J	LOCATED 1980
FEET FROM THE South LINE	
AND 1980	FEET FROM THE East
LINE OF SEC. 3 TWP. 19N -6E. 29E NMPM	
19. Proposed Depth	
2500'	
19A. Formation	
Tubb	
20. Rotary or C.T.	
Rotary	
21. Elevations (Show whether DF, RT, etc.)	21A. Kind & Status Plug. Bond
Not Available	Required/Approved
21B. Drilling Contractor	
Not Released	
22. Approx. Date Work will start	
Feb. 15 - May 1, 1981	

23. PROPOSED CASING AND CEMENT PROGRAM

SIZE OF HOLE	SIZE OF CASING	WEIGHT PER FOOT	SETTING DEPTH	SACKS OF CEMENT	EST. TOP
12 1/4"	8-5/8"	24#	700'	400	Circulate
7-7/8"	5 1/2"	14#	2500'	600	Circulate

It is proposed to drill this well to a total depth of 2,500' to test the Tubb formation. The blowout prevention program is as follows:

1. one set of blind rams
2. one set of drill pipe rams

The acreage assigned to this well is not dedicated to any CO₂ purchaser.

APPROVAL VALID FOR 90 DAYS
PERMIT EXPIRES 5-12-81
UNLESS DRILLING UNDERWAY

IN ABOVE SPACE DESCRIBE PROPOSED PROGRAM; IF PROPOSAL IS TO DEEPEN OR PLUG BACK, GIVE DATA ON PRESENT PRODUCTIVE ZONE AND PROPOSED NEW PRODUCTIVE ZONE. GIVE BLOWOUT PREVENTER PROGRAM, IF ANY.

I hereby certify that the information above is true and complete to the best of my knowledge and belief.

Signed E. Spiller Title Region Oper. Mgr. Date 2/6/81
(This space for State Use)

APPROVED BY Carl Ulvog TITLE SENIOR REGIONAL SUPERVISOR DATE 2-11-81
CONDITIONS OF APPROVAL, IF ANY:

**NEW MEXICO OIL CONSERVATION COMMISSION
WELL LOCATION AND ACREAGE DEDICATION PLAT**

Form C-102
Supersedes C-128
Effective 1-1-65

All distances must be from the outer boundaries of the Section.

Operator Cities Service Oil Company			Lease State DI		Well-No. 1
Unit Letter J	Section 3	Township 19North	Range 29 East	County Harding	
Actual Footage Location of Well: 1980 feet from the South line and 1980 feet from the East line					
Ground Level Elev.	Producing Formation Tubb	Pool Bravo Dome Area		Dedicated Acreage: 40 Acres	

1. Outline the acreage dedicated to the subject well by colored pencil or hachure marks on the plat below.
2. If more than one lease is dedicated to the well, outline each and identify the ownership thereof (both as to working interest and royalty).
3. If more than one lease of different ownership is dedicated to the well, have the interests of all owners been consolidated by communitization, unitization, force-pooling, etc?

☐ Yes ☐ No If answer is "yes," type of consolidation _____

If answer is "no," list the owners and tract descriptions which have actually been consolidated. (Use reverse side of this form if necessary.) _____

No allowable will be assigned to the well until all interests have been consolidated (by communitization, unitization, forced-pooling, or otherwise) or until a non-standard unit, eliminating such interests, has been approved by the Commission.

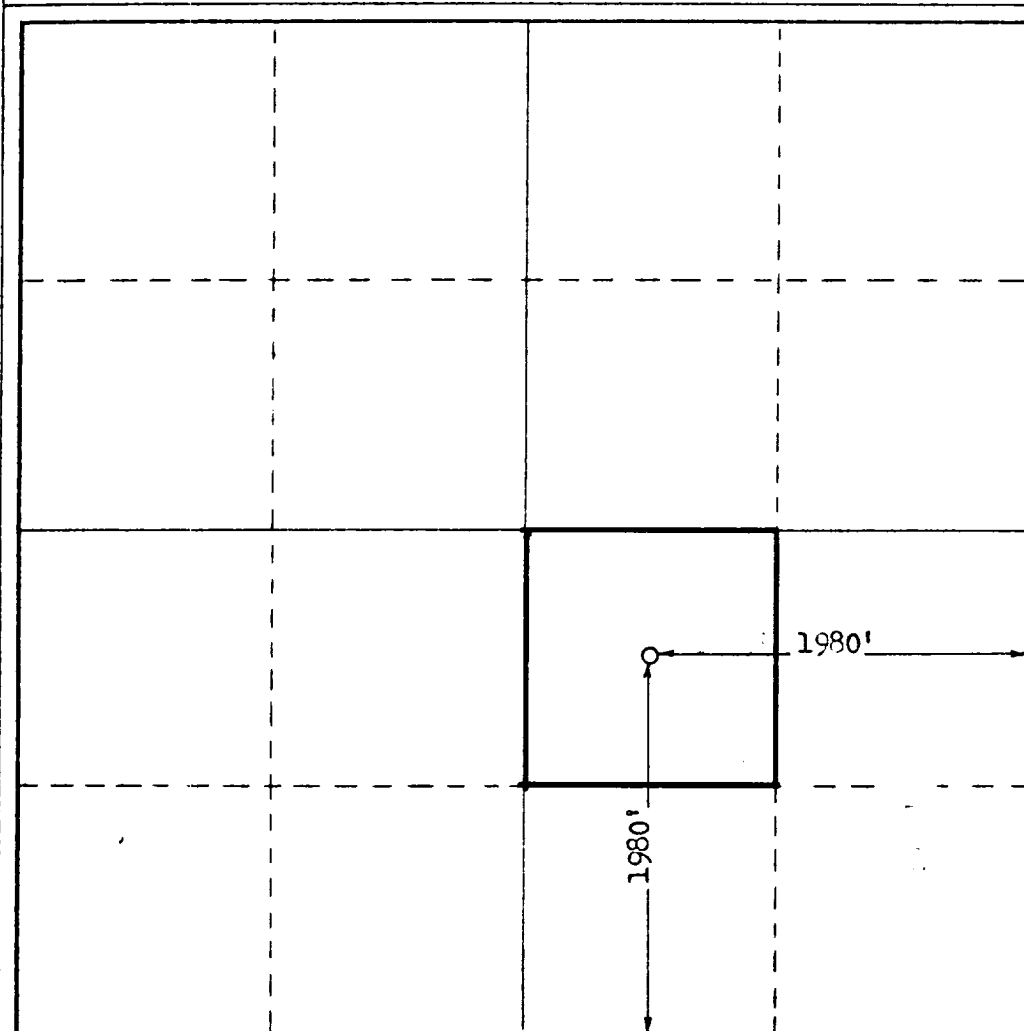

CERTIFICATION

I hereby certify that the information contained herein is true and complete to the best of my knowledge and belief.

Name **E. J. Knicker**

Position
Region Oper. Mgr.

Company
Cities Service Co.

Date
2/6/81

I hereby certify that the well location shown on this plat was plotted from field notes of actual surveys made by me or under my supervision, and that the same is true and correct to the best of my knowledge and belief.

Date Surveyed No. **3333**

Registered Professional Engineer and/or Land Surveyor

Ronald J. Eidson

Certificate No. **John W. West 676**
Ronald J. Eidson 3239

