

NO. OF COPIES RECEIVED	
DISTRIBUTION	
SANTA FE	
FILE	<input checked="" type="checkbox"/>
U.S.G.S.	
LAND OFFICE	
OPERATOR	

NEW MEXICO OIL CONSERVATION COMMISSION

Form C-101
Revised 1-4-65

API #
30-021-20154

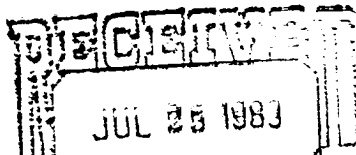

5A. Indicate Type of Lease	
STATE <input type="checkbox"/>	FEE <input checked="" type="checkbox"/>
5. State Oil & Gas Lease No.	

APPLICATION FOR PERMIT TO DRILL, DEEPEN, OR PLUG BACK OIL CONSERVATION DIVISION

1a. Type of Work b. Type of Well OIL WELL <input type="checkbox"/> GAS WELL <input checked="" type="checkbox"/> CO2 OTHER <input type="checkbox"/>		DRILL <input checked="" type="checkbox"/> DEEPEN <input type="checkbox"/> PLUG BACK <input type="checkbox"/>		7. Unit Agreement Name BDCDGU	
2. Name of Operator Amoco Production Company		SINGLE ZONE <input checked="" type="checkbox"/> MULTIPLE ZONE <input type="checkbox"/>		8. Farm or Lease Name BDCDGU	
3. Address of Operator P. O. Box 68, Hobbs, New Mexico 88240				9. Well No. 2033 121G	
4. Location of Well UNIT LETTER <u>G</u> LOCATED <u>1980</u> FEET FROM THE <u>North</u> LINE AND <u>1980</u> FEET FROM THE <u>East</u> LINE OF SEC. <u>12</u> TWP. <u>20-N</u> RGE. <u>33-E</u> NMPM				10. Field and Pool, or Wildcat Und. Tubb	
				12. County Harding	
		19. Proposed Depth 2580'		19A. Formation Tubb	
21. Deviations (Show whether DL, KL, etc.) 4880' GL		21A. Kind & Status Plug. Bond Blanket on File		20. Rotary or C.C.T. Rotary	
		21B. Drilling Contractor N/A		22. Approx. Date Work will start 3rd Quarter-1983	

PROPOSED CASING AND CEMENT PROGRAM

SIZE OF HOLE	SIZE OF CASING	WEIGHT PER FOOT	SETTING DEPTH	SACKS OF CEMENT	EST. TOP
12-1/4"	9-5/8"	32.30#	700'	Circ.	Surface
8-3/4"	7"	20.#	2580'	Tieback to 9-5/8"	Surface

Propose to drill and equip well in the Tubb formation. After reaching TD logs will be run and evaluated. Perforate and stimulate as necessary in attempting commercial production.

Mud Program: 0-700' Native Spud Mud
700'-TD Stable Foam using KCL water and foamer

BOP program attached
Gas is not dedicated
COLLECT AND SACK SAMPLES FOR
NEW MEXICO BUREAU OF MINES, SOCORRO
AT AT LEAST TEN FOOT INTERVALS

APPROVAL VALID FOR 90 DAYS
PERMIT EXPIRES 10-22-83
UNLESS DRILLING UNDERWAY

0+2-NMOCD, SF; 1-HOU R. E. Ogden Rm 21.150; 1-SUSP; 1-PJS 1-Amerada; 1-Amerigas;
1-Cities Service; 1-Conoco; 1-CO2 in Action; 1-Excelsior; 1-Sun. Tex.; 1-Exxon;
1-Jim Russell, Clayton; 1-F. J. Nash, HOU Rm 4.206

IN ABOVE SPACE DESCRIBE PROPOSED PROGRAM; IF PROPOSAL IS TO DEEPEN OR PLUG BACK, GIVE DATA ON PRESENT PRODUCTIVE ZONE AND PROPOSED NEW PRODUCTION ZONE. GIVE BLOWOUT PREVENTER PROGRAM, IF ANY.

I hereby certify that the information above is true and complete to the best of my knowledge and belief.

Signed [Signature] Title Assistant Administrative Analyst Date 7-21-83

(This space for State Use)

APPROVED BY [Signature] TITLE DISTRICT SUPERVISOR DATE 7/25/83

CONDITIONS OF APPROVAL, IF ANY:

OIL CONSERVATION COMMISSION TO BE NOTIFIED
WITHIN 24 HOURS OF BEGINNING OPERATIONS

NEW MEXICO OIL CONSERVATION COMMISSION
WELL LOCATION AND ACREAGE DEDICATION PLAT

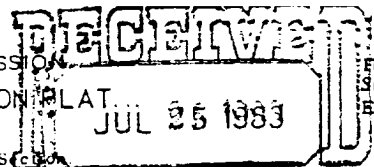

Form C-102
Supersedes C-128
Effective 1-1-65

All distances must be from the outer boundaries of the Section

Operator AMOCO PRODUCTION COMPANY			Lease Bravo Dome CO2 Gas Unit SANTA FE			OIL CONSERVATION DIVISION 2033121G		
Unit Letter G	Section 12	Township T20N	Range R33E	County HARDING				
Actual Footage Location of Well: 1980 feet from the NORTH line and 1980 feet from the EAST line								
Ground Level Elev. 4880	Producing Formation Tubb		Pool Und. Tubb			Dedicated Acreage: 160 Acres		

1. Outline the acreage dedicated to the subject well by colored pencil or hachure marks on the plat below.
2. If more than one lease is dedicated to the well, outline each and identify the ownership thereof (both as to working interest and royalty).
3. If more than one lease of different ownership is dedicated to the well, have the interests of all owners been consolidated by communitization, unitization, force-pooling, etc?

☐ Yes ☐ No If answer is "yes," type of consolidation _____

If answer is "no," list the owners and tract descriptions which have actually been consolidated. (Use reverse side of this form if necessary.) _____

No allowable will be assigned to the well until all interests have been consolidated (by communitization, unitization, forced-pooling, or otherwise) or until a non-standard unit, eliminating such interests, has been approved by the Commission.

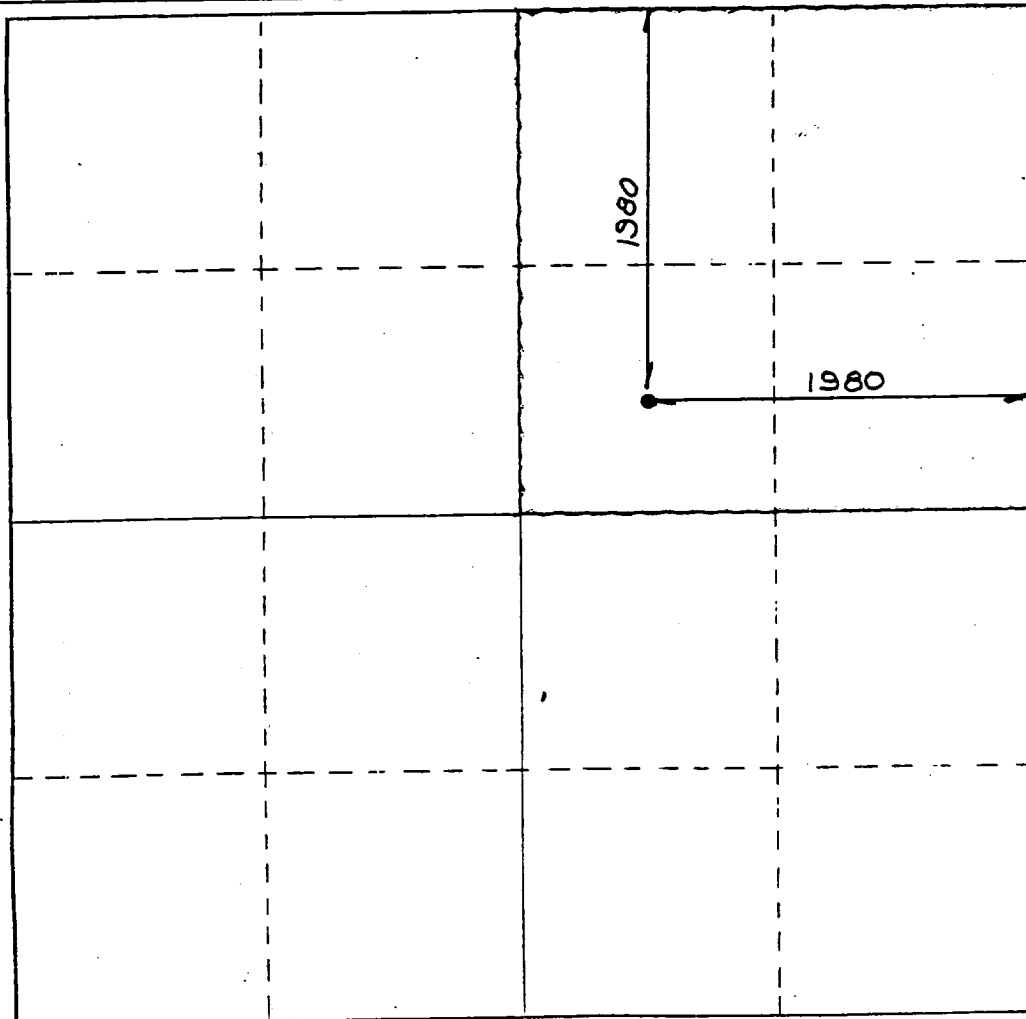

CERTIFICATION

I hereby certify that the information contained herein is true and complete to the best of my knowledge and belief.

Name
Assist. Admin. Analyst
Position
Amoco Production Company
Company
7-22-83

Date

I hereby certify that the well location shown on this plat was plotted from field notes of actual surveys made by me or under my supervision, and that the same is true and correct to the best of my knowledge and belief.

JUNE 1983
Date Surveyed
REGISTERED LAND SURVEYOR
STATE OF NEW MEXICO
No. 5100
LEE ENSHIELDS
N.M.L.S. 103
Certificate No.

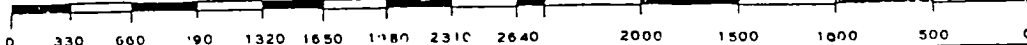

STANDARD 2000 PSI W.P. BOP STACK

1. Blow-out preventers may be manually operated.
2. All equipment must be in good condition, 2,000 psi W.P. (4,000 psi test) minimum.
3. Bell nipple above blow-out preventer shall be same size as casing being drilled through.
4. Kelly cock to be installed on kelly.
5. Full opening safety valve 2,000 psi w.p. (4,000 psi test) minimum must be available on rig floor at all times with proper connection or subs to fit any tool joint in string.
6. Spool or cross may be eliminated if connections are available in the lower part of the blow-out preventer body.
7. Double or space saver type preventers may be used in lieu of two single preventers.
8. BOP rams to be installed as follows:

Top preventer	-	Drill pipe or casing rams
Bottom preventer	-	Blind rams

*Amoco District Superintendent may reverse location of rams.
9. Extensions and hand wheels to be installed and braced at all times.
10. Manifold valves may be gate or plug metal to metal seal 2" minimum.

