

NO. OF COPIES RECEIVED	
DISTRIBUTION	
SANTA FE	
FILE	
U.S.G.S.	
LAND OFFICE	
OPERATOR	

NEW MEXICO OIL CONSERVATION COMMISSION

APT #

30-021-20158

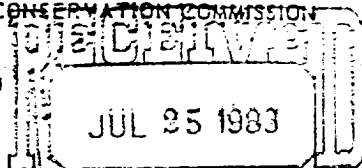

OIL CONSERVATION DIVISION

Form C-101
Revised 1-1-65

5A. Indicate Type of Lease	
STATE <input checked="" type="checkbox"/>	FEE <input type="checkbox"/>
5. State Oil & Gas Lease No.	
LG-2971-2	

APPLICATION FOR PERMIT TO DRILL, DEEPEN, OR PLUG BACK

1a. Type of Work		7. Unit Agreement Name	
		BDCDGU	
b. Type of Well OIL WELL <input type="checkbox"/> GAS WELL <input checked="" type="checkbox"/> CO2 OTHER <input type="checkbox"/>		8. Form or Lease Name	
DEEPEN <input type="checkbox"/> PLUG BACK <input type="checkbox"/>		BDCDGU	
2. Name of Operator		9. Well No.	
Amoco Production Company		2033 161G	
3. Address of Operator		10. Field and Pool, or Wildcat	
P. O. Box 68, Hobbs, New Mexico 88240		Und. Tubb	
4. Location of Well UNIT LETTER <u>G</u> LOCATED <u>1980</u> FEET FROM THE <u>North</u> LINE AND <u>1980</u> FEET FROM THE <u>East</u> LINE OF SEC. <u>16</u> TWP. <u>20-N</u> RGE. <u>33-E</u> NMPM		12. Country	
		Harding	
19. Proposed Depth		19A. Formation	
2683'		Tubb	
20. Rotary or C.L.		Rotary	
1. Deviations (Show whether DL, KL, etc.)		21A. Kind & Status Plug. Bond	
5033' GL		Blanket on file	
21B. Drilling Contractor		22. Approx. Date Work will start	
NA		3rd quarter-1983	

PROPOSED CASING AND CEMENT PROGRAM

SIZE OF HOLE	SIZE OF CASING	WEIGHT PER FOOT	SETTING DEPTH	SACKS OF CEMENT	EST. TOP
12-1/4"	9-5/8"	32.30#	700'	Circ.	Surface
8-3/4"	7"	20#	2683'	Tieback to 9-5/8"	Surface

Propose to drill and equip well in the Tubb formation. After reaching TD logs will be run and evaluated. Perforate and stimulate as necessary in attempting commercial production.

Mud Program: 0 - 700' Native Spud Mud
700'- TD Stable foam using KCL water and foamer.

BOP Program attached.
Gas is not dedicated

0+2-NMOCD,SF 1-HOU R. E. Ogden RM 21.150 1-SUSP. 1-PJS 1-Amerada 1-Amerigas
1- Cities Service 1-Conoco 1-CO2 in Action 1-Excelsior 1-Sun. Tex. 1-Exxon
1- Jim Russell, Clayton 1-F. J. Nash, HOU RM 4.206

COLLECT AND SACK SAMPLES FOR
NEW MEXICO BUREAU OF MINES, SOCORRO
AT AT LEAST TEN FOOT INTERVALS

APPROVAL VALID FOR 90 DAYS
PERMIT EXPIRES 10-22-83
UNLESS DRILLING UNDERWAY

IN ABOVE SPACE DESCRIBE PROPOSED PROGRAM: IF PROPOSAL IS TO DEEPEN OR PLUG BACK, GIVE DATA ON PRESENT PRODUCTIVE ZONE AND PROPOSED NEW PRODUCTIVE ZONE. GIVE BLOWOUT PREVENTER PROGRAM, IF ANY.

I hereby certify that the information above is true and complete to the best of my knowledge and belief.

Signed Patricia L. Sauer Title Assist. Admin. Analyst Date 7-20-83

(This space for State Use)

Carl W. Wong

APPROVED BY Carl W. Wong TITLE DISTRICT SUPERVISOR DATE 7/25/83

CONDITIONS OF APPROVAL, IF ANY:

OIL CONSERVATION COMMISSION TO BE NOTIFIED
WITHIN 24 HOURS OF BEGINNING OPERATIONS

NEW MEXICO OIL CONSERVATION COMMISSION
WELL LOCATION AND ACREAGE DEDICATION PLAT

Form C-102
Supersedes C-128
Effective 1-1-65

All distances must be from the outer boundaries of the Section

Operator AMOCO PRODUCTION COMPANY			Lease Bravo Dome CO2 Gas Unit		Well No. 2033161G
Unit Letter G	Section 16	Township T20N	Range R33E	County HARDING	
Actual Footage Location of Well: 1980 feet from the NORTH line and 1980 feet from the EAST line					
Ground Level Elev. 5033	Producing Formation Tubb		Pool Und. Tubb		Dedicated Acreage: 160 Acres

1. Outline the acreage dedicated to the subject well by colored pencil or hachure marks on the plat below.
2. If more than one lease is dedicated to the well, outline each and identify the ownership thereof (both as to working interest and royalty).
3. If more than one lease of different ownership is dedicated to the well, have the interests of all owners been consolidated by communitization, unitization, force-pooling, etc?

☐ Yes ☐ No If answer is "yes," type of consolidation _____

If answer is "no," list the owners and tract descriptions which have actually been consolidated. (Use reverse side of this form if necessary.) _____

No allowable will be assigned to the well until all interests have been consolidated (by communitization, unitization, forced-pooling, or otherwise) or until a non-standard unit, eliminating such interests, has been approved by the Commission.

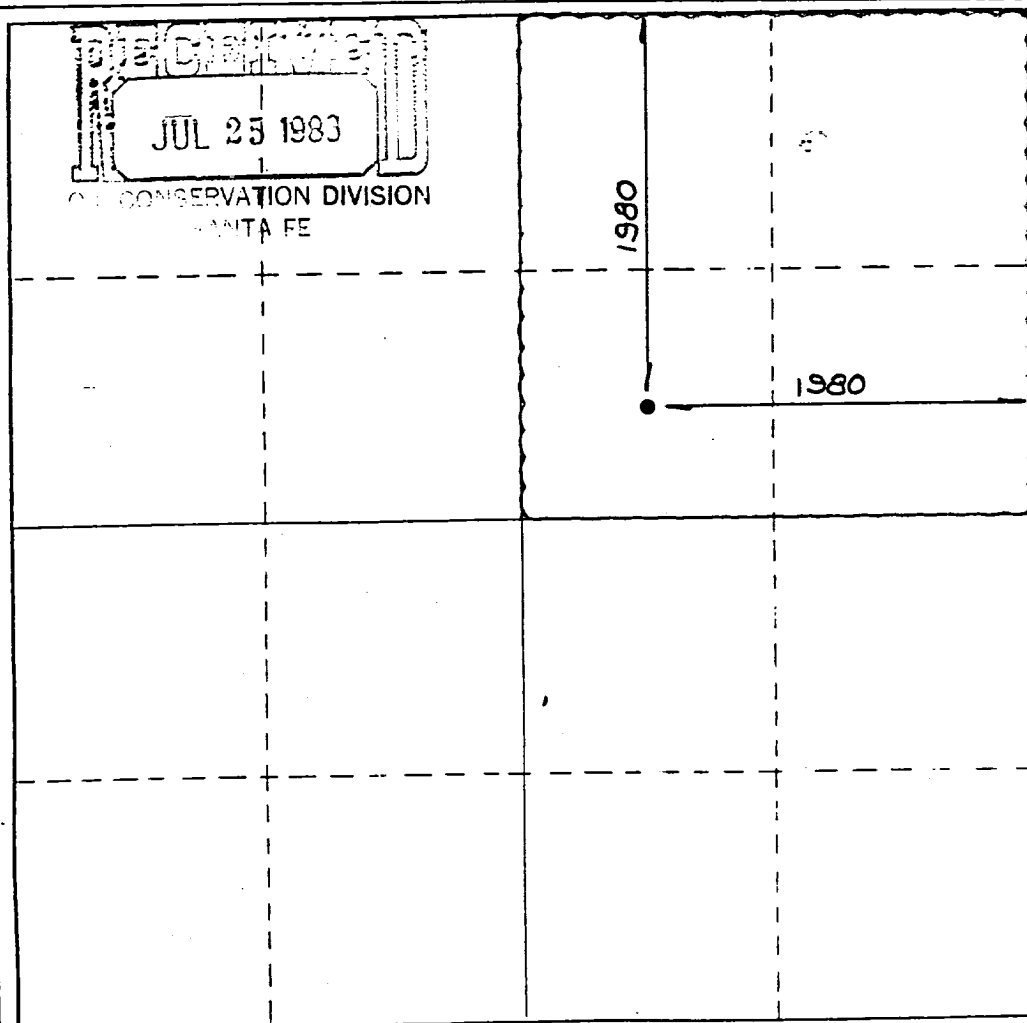

CERTIFICATION

I hereby certify that the information contained herein is true and complete to the best of my knowledge and belief.

Name _____
 Position
Assist. Admin. Analyst
 Company
Amoco Production Company
 Date
7-22-83

I hereby certify that the well location shown on this plat was plotted from field notes of actual surveys made by me or under my supervision, and that the same is true and correct to the best of my knowledge and belief.

JUNE _____
 Date Surveyed
 Registered Professional Engineer and/or Land Surveyor
STATE OF NEW MEXICO
NO. 5183
E. SHIELDS
 Certificate No. _____

0 330 660 990 1320 1650 1980 2310 2640 2970 3300 3630 3960 4290 4620 4950 5280 5610 5940 6270 6600

STANDARD 2000 PSI W.P. BOP STACK

1. Blow-out preventers may be manually operated.
2. All equipment must be in good condition, 2,000 psi W.P. (4,000 psi test) minimum.
3. Bell nipple above blow-out preventer shall be same size as casing being drilled through.
4. Kelly cock to be installed on kelly.
5. Full opening safety valve 2,000 psi w.p. (4,000 psi test) minimum must be available on rig floor at all times with proper connection or subs to fit any tool joint in string.
6. Spool or cross may be eliminated if connections are available in the lower part of the blow-out preventer body.
7. Double or space saver type preventers may be used in lieu of two single preventers.
8. BOP rams to be installed as follows:

Top preventer	-	Drill pipe or casing rams
Bottom preventer	-	Blind rams

*Amoco District Superintendent may reverse location of rams.
9. Extensions and hand wheels to be installed and braced at all times.
10. Manifold valves may be gate or plug metal to metal seal 2" minimum.

