

OIL CONSERVATION DIVISION

P. O. BOX 2088

SANTA FE, NEW MEXICO 87501

Form C-101
Revised 10-1-78

NO. OF COPIES RECEIVED	
DISTRIBUTION	
SANTA FE	1
FILE	1
U.S.G.S.	2
LAND OFFICE	1
OPERATOR	1

API # 30-021-20198

5A. Indicate Type of Lease
STATE ☐ FEE ☒
5. State Oil & Gas Lease No.

APPLICATION FOR PERMIT TO DRILL, DEEPEN, OR PLUG BACK

1a. Type of Work b. Type of Well OIL WELL <input type="checkbox"/> GAS WELL <input checked="" type="checkbox"/> CO2 OTHER <input type="checkbox"/> DRILL <input checked="" type="checkbox"/> DEEPEN <input type="checkbox"/> PLUG BACK <input type="checkbox"/> SINGLE ZONE <input checked="" type="checkbox"/> MULTIPLE ZONE <input type="checkbox"/>		7. Unit Agreement Name BDCDGU
2. Name of Operator Amoco Production Company		8. Farm or Lease Name BDCDGU
3. Address of Operator P. O. Box 606, Clayton, New Mexico 88415		9. Well No. 1833-141G
4. Location of Well UNIT LETTER G LOCATED 1650 FEET FROM THE North LINE AND 1650 FEET FROM THE East LINE OF SEC. 14 TWP. 18N R. 33E		10. Field and Pool, or Wildcat Bravo Dome 640 Acre Area
11. Elevation (show whether DT, H, etc.) 4745' GL		17. County Harding
21A. Kind & Status Plug. Bond Blanket-on-file	19. Proposed Depth 2900'	15A. Formation Tubb
21B. Drilling Contractor N/A	20. Rotary or C.T. Rotary	22. Approx. Date Work will start August, 1984

PROPOSED CASING AND CEMENT PROGRAM

SIZE OF HOLE	SIZE OF CASING	WEIGHT PER FOOT	SETTING DEPTH	SACKS OF CEMENT	EST. TOP
12-1/4"	9-5/8"	32.30#	700'	Circulate	surface
8-3/4"	7"	15, 20#	2900'	Tieback to 9-5/8"	surface

Propose to drill and equip well in the Tubb formation. After reaching TD logs will be run and evaluated. Perforate and stimulate as necessary in attempting commercial production.

Mud Program: 0 - 700' Native Spud Mud
700 - TD KCL Salt Water Gel-Starch

BOP Diagram attached.

APPROVAL VALID FOR 180 DAYS
PERMIT EXPIRES 2-2-85
UNLESS DRILLING UNDERWAY.

0+5-NMOCD, SF 1-J. R. Barnettt, HOU Rm. 21.156 1-F. J. Nash, HOU Rm. 4.206 1-WF, C 1-WF,
1-Susp, 1-JSM, 1-Amerada 1-Amerigas 1-Cities Service 1-Conoco 1-CO2 in Action 1-Sun
1-Excelsior 1-Tex 1-Exxon

IN ABOVE SPACE DESCRIBE PROPOSED PROGRAM IF PROPOSAL IS TO DEEPEN OR PLUG BACK, GIVE DATA ON PRESENT PRODUCTIVE ZONE AND PROPOSED NEW PRO-
DUCTIVE ZONE. GIVE BLOWOUT PREVENTER PROGRAM, IF ANY.

hereby certify that the information above is true and complete to the best of my knowledge and belief.

Signed John S. McEllya Title Assist. Admin. Analyst Date 8-3-84
(This space for State Use)

APPROVED BY [Signature] TITLE DISTRICT SUPERVISOR DATE 8-6-84
CONDITIONS OF APPROVAL, IF ANY:

NEW MEXICO OIL CONSERVATION COMMISSION
WELL LOCATION AND ACREAGE DEDICATION PLAT

Form C-102
Supersedes C-125
Effective 1-1-65

All distances must be from the outer boundaries of the Section.

Operator AMOCO		Lease Bravo Dome Carbon Dioxide Gas Unit		Well No. 1833 141G
Unit Letter G	Section 14	Township T18N	Range R33E	County HARDING
Actual Footage Location of Well:				
1650 feet from the NORTH line and		1650 feet from the EAST line		
Ground Level Elev. 4745	Producing Formation Tubb	Pool Bravo Dome 640-acre area	Dedicated Acreage: 640 Acres	

1. Outline the acreage dedicated to the subject well by colored pencil or hachure marks on the plat below.
2. If more than one lease is dedicated to the well, outline each and identify the ownership thereof (both as to working interest and royalty).
3. If more than one lease of different ownership is dedicated to the well, have the interests of all owners been consolidated by communitization, unitization, force-pooling, etc?

☒ Yes ☐ No If answer is "yes," type of consolidation Pooling Declaration

If answer is "no," list the owners and tract descriptions which have actually been consolidated. (Use reverse side of this form if necessary.)

No allowable will be assigned to the well until all interests have been consolidated (by communitization, unitization, forced-pooling, or otherwise) or until a non-standard unit, eliminating such interests, has been approved by the Commission.

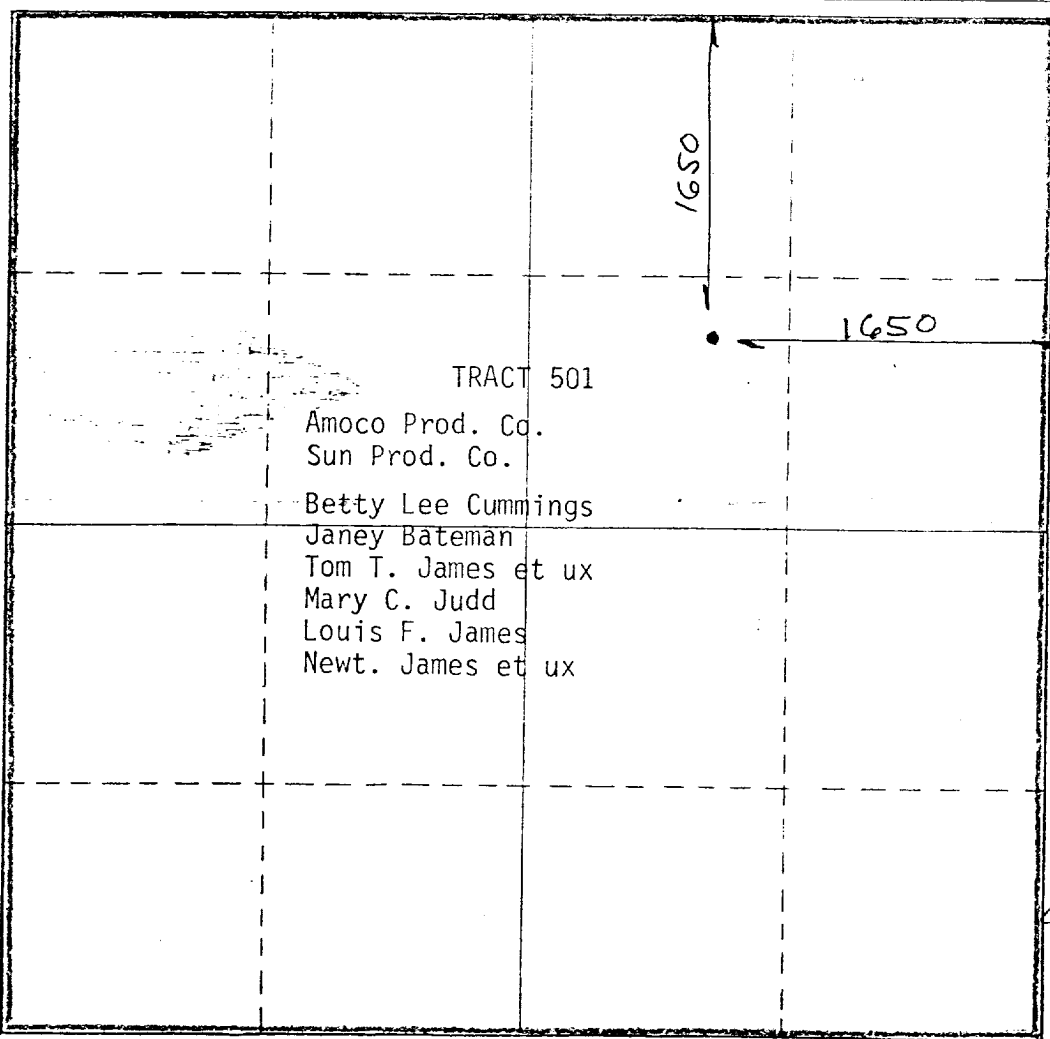

CERTIFICATION

I hereby certify that the information contained herein is true and complete to the best of my knowledge and belief.

Name John S. McElya
Position Assist. Admin. Analyst
Company Amoco Production Company
Date 7-20-84

I hereby certify that the well location shown on this plat was plotted from field notes of actual surveys made by me or under my supervision, and that the same is true and correct to the best of my knowledge and belief.

OCT. 17, 1983
Date Surveyed
[Signature]
Registered Professional Engineer
and/or Land Surveyor
N.M.L.S. NO. 5103
Certificate No. 1833 141G

STANDARD 2000 PSI W.P. BOP STACK

1. Blow-out preventers may be manually operated.
2. All equipment must be in good condition. 2,000 psi W.P. (4,000 psi test) minimum.
3. Bell nipple above blow-out preventer shall be same size as casing being drilled through.
4. Kelly cock to be installed on kelly.
5. Full opening safety valve 2,000 psi w.p. (4,000 psi test) minimum must be available on rig floor at all times with proper connection or subs to fit any tool joint in string.
6. Spool or cross may be eliminated if connections are available in the lower part of the blow-out preventer body.
7. Double or space saver type preventers may be used in lieu of two single preventers.
8. BOP rams to be installed as follows:

Top preventer	-	Drill pipe or casing rams
Bottom preventer	-	Blind rams

*Amoco District Superintendent may reverse location of rams.
9. Extensions and hand wheels to be installed and braced at all times.
10. Manifold valves may be gate or plug metal to metal seal 2" minimum.

