

OIL CONSERVATION DIVISION

P. O. BOX 2088

SANTA FE, NEW MEXICO 87501

Form C-101
Revised 10-1-78

NO. OF COPIES RECEIVED	
DISTRIBUTION	
SANTA FE	1
FILE	1
U.S.G.S.	2
LAND OFFICE	1
OPERATOR	1

API # 30-021-26205

5A. Indicate Type of Lease	
STATE <input type="checkbox"/>	FEE <input checked="" type="checkbox"/>
5. State Oil & Gas Lease No.	

APPLICATION FOR PERMIT TO DRILL, DEEPEN, OR PLUG BACK

1a. Type of Work		7. Well Name	
1b. Type of Well		8. Farm or Lease Name	
DRILL <input checked="" type="checkbox"/>	DEEPEN <input type="checkbox"/>	Bravo Dome Carbon Dioxide Gas Unit	
OIL WELL <input type="checkbox"/>	GAS WELL <input checked="" type="checkbox"/>	9. Well No.	
OTHER <input type="checkbox"/>	C02	1833 091G	
2. Name of Operator		10. Field and Pool, or Wildcat	
Amoco Production Company		Bravo Dome Carbon Dioxide Gas Unit 640-Acre Area	
3. Address of Operator		12. County	
P.O. Box 606, Clayton, New Mexico 88415		Harding	
4. Location of Well		19. Proposed Depth	
UNIT LETTER G	LOCATED 1650	2900'	
FEET FROM THE North	LINE	19A. Formation	
AND 1650	FEET FROM THE East	Tubb	
LINE OF SEC. 9	TWP. 18-N	20. Rotary or C.T.	
ACC. 33-E	M.L.P.M.	Rotary	
1. Elevations (Show whether Dr., H.I., etc.)		21B. Drilling Contractor	
4740' GL	21A. Kind & Status Plug. Bond	N/A	
Blanket-on-file	22. Approx. Date Work will start		
September , 1984			

PROPOSED CASING AND CEMENT PROGRAM

SIZE OF HOLE	SIZE OF CASING	WEIGHT PER FOOT	SETTING DEPTH	SACKS OF CEMENT	EST. TOP
12-1/4"	9-5/8"	32.30#	700'	circulate	surface
8-3/4"	7"	15, 20#	2900'	Tieback to 9-5/8"	surface

Propose to drill and equip well in the Tubb formation. After reaching TD logs will be run and evaluated. Perforate and stimulate as necessary in attempting commercial production.

Mud Program:

0 - 700' Native Spud Mud
700 - TD KCL Salt Water Gel-Starch

BOP Diagram attached.

APPROVAL VALID FOR 180 DAYS

PERMIT EXPIRES 3-18-85

DATE OF APPROVAL 9-17-84

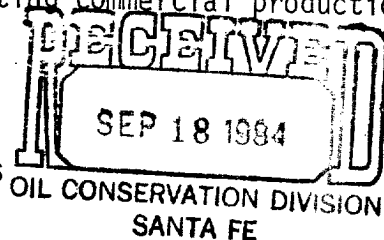

0+5-NMOCD,SF 1-J.R.Barnett,HOU Rm 21.156 1-F.J.Nash,HOU Rm.4.206 1-WF,C 1-WF,H 1-Susp
1-JSM 1-Amerada 1-Amerigas 1-Cities Service 1-Conoco 1-C02 in Action 1-Sun
1-Excelsior 1-Tex 1-Exxon

ABOVE SPACE DESCRIBE PROPOSED PROGRAM; IF PROPOSAL IS TO DEEPEN OR PLUG BACK, GIVE DATA ON PRESENT PRODUCTIVE ZONE AND PROPOSED NEW PRODUCTION ZONE. GIVE BLOWOUT PREVENTER PROGRAM, IF ANY.

I hereby certify that the information above is true and complete to the best of my knowledge and belief.

by John S. McElroy Title Asst. Adm. Analyst Date 9-17-84
(This space for State Use)

PROVED BY David R. Catarack TITLE OIL AND GAS INSPECTOR DATE 9-18-84
NOTATIONS OF APPROVAL, IF ANY:

NEW MEXICO OIL CONSERVATION COMMISSION
WELL LOCATION AND ACREAGE DEDICATION PLAT

Form C-102
Supersedes C-128
Effective 1-1-61

All distances must be from the outer boundaries of the Section.

Operator AMOCO			Lease Bravo Dome Carbon Dioxide Gas Unit		Well No. 1833 091G
Unit Letter G	Section 9	Township T18N	Range R33E	County HARDING	
Actual Footage Location of Well: 1650 feet from the NORTH line and 1650 feet from the EAST line					
Ground Level Elev. 4740	Producing Formation Tubb	Pool Bravo Dome 640-acre area		Dedicated Acreage: 640 Acres	

1. Outline the acreage dedicated to the subject well by colored pencil or hachure marks on the plat below.
2. If more than one lease is dedicated to the well, outline each and identify the ownership thereof (both as to working interest and royalty).
3. If more than one lease of different ownership is dedicated to the well, have the interests of all owners been consolidated by communitization, unitization, force-pooling, etc?

☒ Yes ☐ No If answer is "yes," type of consolidation unitization

If answer is "no," list the owners and tract descriptions which have actually been consolidated. (Use reverse side of this form if necessary.)

No allowable will be assigned to the well until all interests have been consolidated (by communitization, unitization, forced-pooling, or otherwise) or until a non-standard unit, eliminating such interests, has been approved by the Commission.

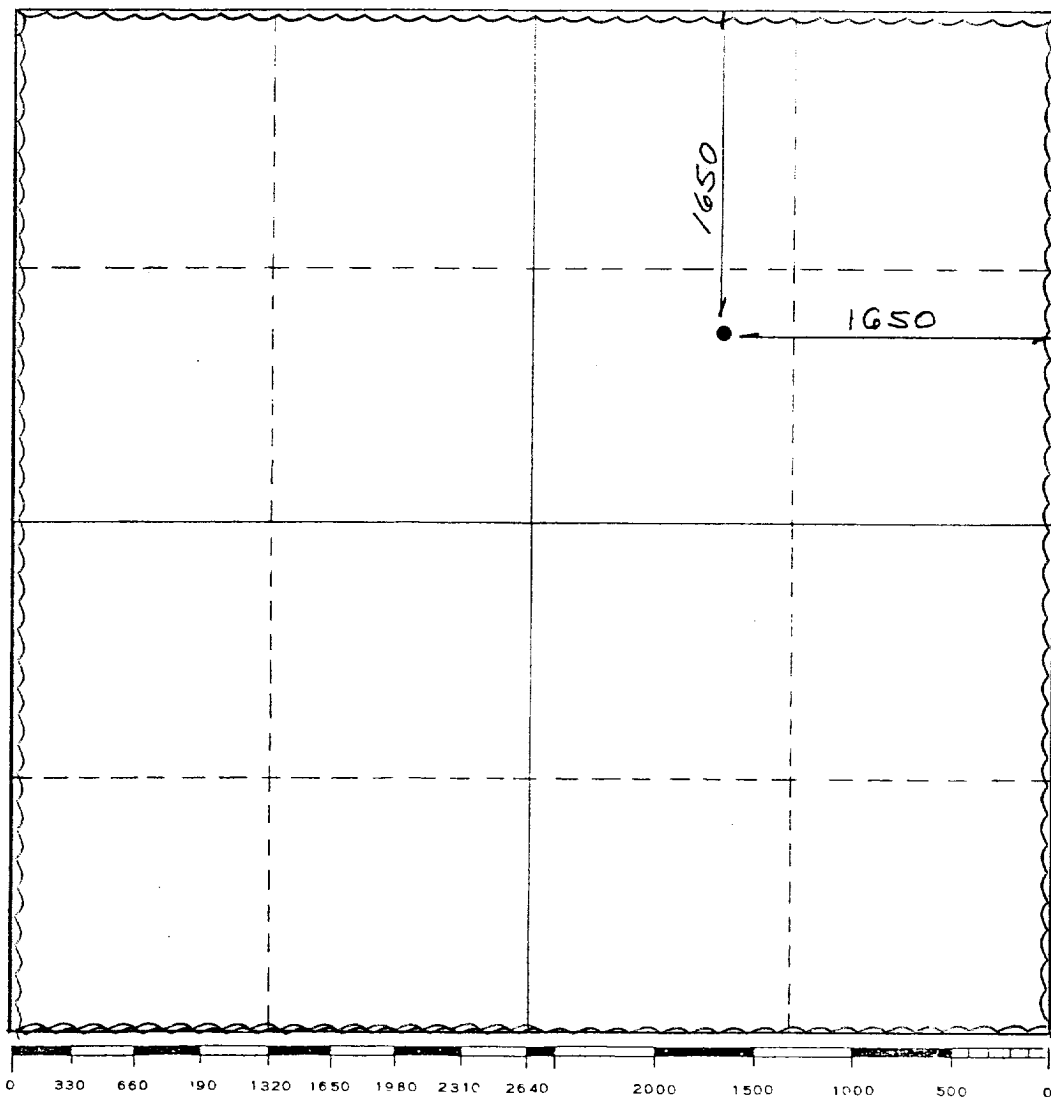

CERTIFICATION

I hereby certify that the information contained herein is true and complete to the best of my knowledge and belief.

Name John S. McElroy
Position Asst. Administrative Analyst
Company Amoco Production Company
Date 7-20-84

I hereby certify that the well location shown on this plat was plotted from field notes of actual surveys made by me or under my supervision, and that the same is true and correct to the best of my knowledge and belief.

OCT. 14, 1983

Date Surveyed 7-20-84
Registered Professional Engineer and Land Surveyor
No. 5103
Certificate No. 5103
MEXICO

STANDARD 2000 PSI W.P. BOP STACK

1. Blow-out preventers may be manually operated.
2. All equipment must be in good condition, 2,000 psi W.P. (4,000 psi test) minimum.
3. Bell nipple above blow-out preventer shall be same size as casing being drilled through.
4. Kelly cock to be installed on kelly.
5. Full opening safety valve 2,000 psi w.p. (4,000 psi test) minimum must be available on rig floor at all times with proper connection or subs to fit any tool joint in string.
6. Spool or cross may be eliminated if connections are available in the lower part of the blow-out preventer body.
7. Double or space saver type preventers may be used in lieu of two single preventers.
8. BOP rams to be installed as follows:
 - Top preventer - Drill pipe or casing rams
 - Bottom preventer - Blind rams

*Amoco District Superintendent may reverse location of rams.
9. Extensions and hand wheels to be installed and braced at all times.
10. Manifold valves may be gate or plug metal to metal seal 2" minimum.

