

Submit to Appropriate
District Office
State Lease - 6 copies
Fee Lease - 5 copies

State of New Mexico
Energy, Minerals and Natural Resources Department

Form C-101
Revised 1-1-89

OIL CONSERVATION DIVISION
P.O. Box 2088
Santa Fe, New Mexico 87504-2088

DISTRICT I
P.O. Box 1980, Hobbs, NM 88240

DISTRICT II
P.O. Drawer DD, Artesia, NM 88210

DISTRICT III
1000 Rio Brazos Rd., Aztec, NM 87410

API NO. (assigned by OCD on New Wells)

30-021-20230

5. Indicate Type of Lease

STATE ☒

FEE ☐

6. State Oil & Gas Lease No.

L5852

APPLICATION FOR PERMIT TO DRILL, DEEPEN, OR PLUG BACK

1a. Type of Work:

DRILL ☒

RE-ENTER ☐

DEEPEN ☐

PLUG BACK ☐

b. Type of Well:

OIL
WELL ☐

GAS
WELL ☐

OTHER CO2 Supply

SINGLE
ZONE ☒

MULTIPLE
ZONE ☐

7. Lease Name or Unit Agreement Name

West BDCDGU

2. Name of Operator

OXY USA Inc.

8. Well No.

19

3. Address of Operator

P.O. Box 50250 Midland, TX. 79710

9. Pool name or Wildcat

West Bravo Dome

4. Well Location

Unit Letter

F

: 1650

Feet From The

North

Line and

1650

Feet From The

West

Line

Section

7

Township

18N

Range

29E

NMPM

Harding

County

10. Proposed Depth

3020'

11. Formation

Tubb

12. Rotary or C.T.

Rotary

13. Elevations (Show whether DF, RT, GR, etc.)

5419.3'

14. Kind & Status Plug. Bond

Required/Approved

15. Drilling Contractor

Unknown

16. Approx. Date Work will start

After permit approval

17. PROPOSED CASING AND CEMENT PROGRAM

SIZE OF HOLE	SIZE OF CASING	WEIGHT PER FOOT	SETTING DEPTH	SACKS OF CEMENT	EST. TOP
12-1/4"	9-5/8"	36#	600'	500	Surface
8-3/4"	5-1/2"	15.5#	3020'	650	Surface

It is proposed to drill this well to a TD of 3020' and test the Tubb formation. The blowout prevention program is as follows:

- 1) One set fo 3000# WP Blind Rams
- 2) One set of 3000# WP Drill pipe rams

OIL CONSERVATION COMMISSION TO BE NOTIFIED
WITHIN 24 HOURS OF BEGINNING OPERATIONS

APPROVAL VALID FOR 90 DAYS
PERMIT EXPIRES 1-19-91
UNLESS DRILLING UNDERWAY

IN ABOVE SPACE DESCRIBE PROPOSED PROGRAM: IF PROPOSAL IS TO DEEPEN OR PLUG BACK, GIVE DATA ON PRESENT PRODUCTIVE ZONE AND PROPOSED NEW PRODUCTIVE ZONE. GIVE BLOWOUT PREVENTER PROGRAM, IF ANY.

I hereby certify that the information above is true and complete to the best of my knowledge and belief.

SIGNATURE

Scott E. Gengler

TITLE

Senior Petroleum Engineer

DATE

10/12/90

TYPE OR PRINT NAME

Scott E. Gengler

(Prepared by David Stewart)

TELEPHONE NO. 9156855717

(This space for State Use)

APPROVED BY

R. E. Phum

TITLE

DISTRICT SUPERVISOR

DATE

10-19-90

CONDITIONS OF APPROVAL, IF ANY:

WELLHEAD AND MANTLE SAMPLING WILL
BE PERFORMED AT 100' INTERVALS
AT 10' INTERVALS FOR FIRST 1000'

NEW MEXICO OIL CONSERVATION COMMISSION
WELL LOCATION AND ACREAGE DEDICATION PLAT

Form C-102
Supersedes C-128
Effective 1-1-65

All distances must be from the outer boundaries of the Section

Operator OXY USA Inc.		Lease West BDCDGU		Well No. 19	
Unit Letter F	Section 7	Township T18N	Range R 29E	County HARDING	
Actual Footage Location of Well: 1650 feet from the NORTH line and 1650 feet from the WEST line					
Ground Level Elev. 5419.3	Producing Formation Tubb		Pool West Bravo Dome	Dedicated Acreage: 640 Acres	

1. Outline the acreage dedicated to the subject well by colored pencil or hachure marks on the plat below.
2. If more than one lease is dedicated to the well, outline each and identify the ownership thereof (both as to working interest and royalty).
3. If more than one lease of different ownership is dedicated to the well, have the interests of all owners been consolidated by communitization, unitization, force-pooling, etc?

☒ Yes ☐ No If answer is "yes," type of consolidation Unitization

If answer is "no," list the owners and tract descriptions which have actually been consolidated. (Use reverse side of this form if necessary.)

No allowable will be assigned to the well until all interests have been consolidated (by communitization, unitization, forced-pooling, or otherwise) or until a non-standard unit, eliminating such interests, has been approved by the Commission.

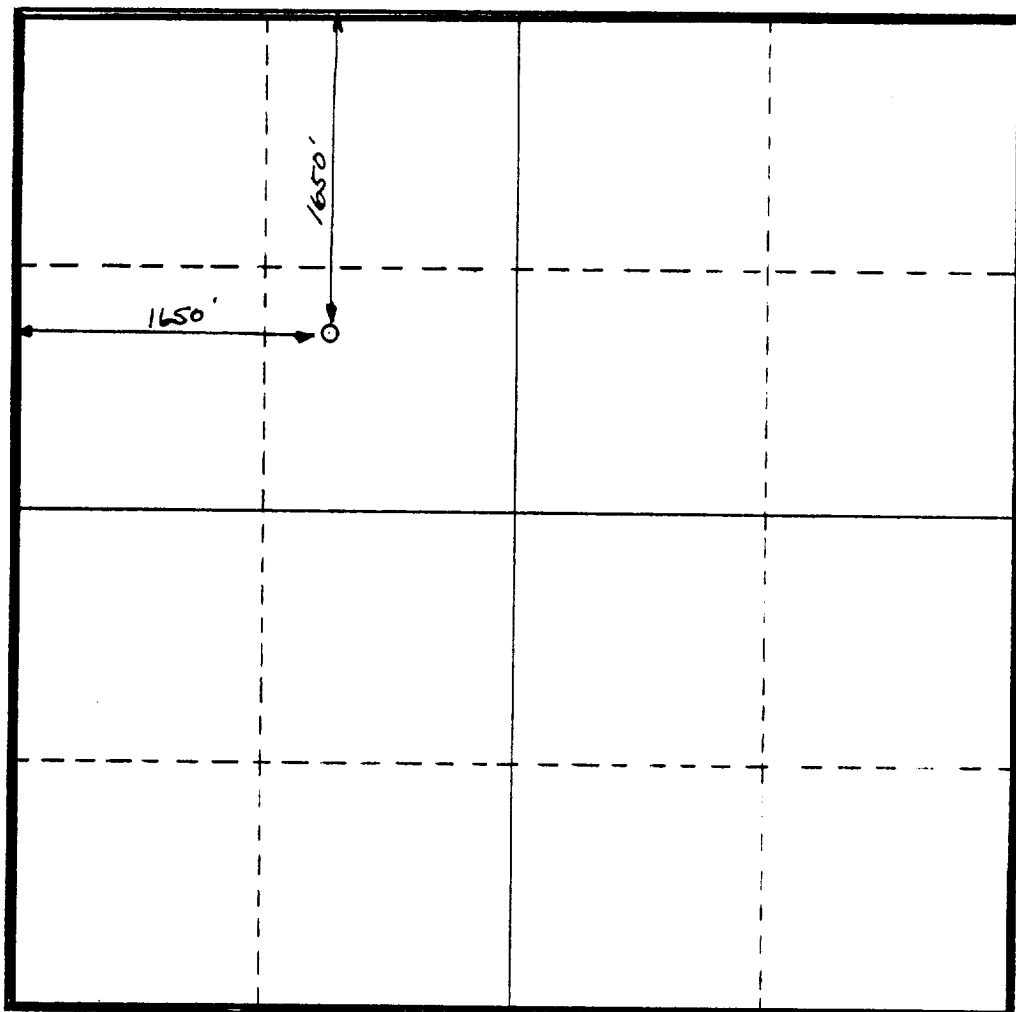

CERTIFICATION

I hereby certify that the information contained herein is true and complete to the best of my knowledge and belief.

Scott E. Gengler
Name

Scott E. Gengler

Position
Senior Petroleum Engineer

Company
OXY USA Inc.

Date
10/12/90

I hereby certify that the well location shown on this plat was plotted from field notes of actual surveys made by me or under my supervision, and that the same is true and correct to the best of my knowledge and belief.

REGISTERED LAND SURVEYOR

Date of Survey

Registered Professional Engineer and/or Land Surveyor

N.M. LES NO. 103

Certificate No.

0 330 660 990 1320 1650 1980 2310 2640 2970 3300 3630 3960 4290 4620 4950 5280 5610 5940 6270 6600